

BENCHMARK:

BM #1 City of Wichita Disc located NE Corner of Traffic Signal Light Pole Base at NW Corner of Womer and 37th Street North. Elev. = 1324.06 MSL.

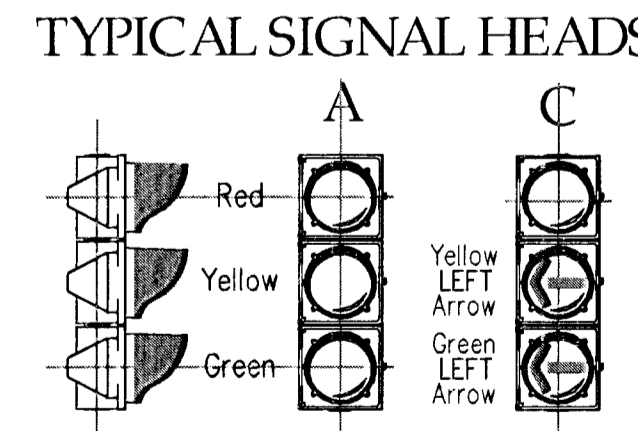
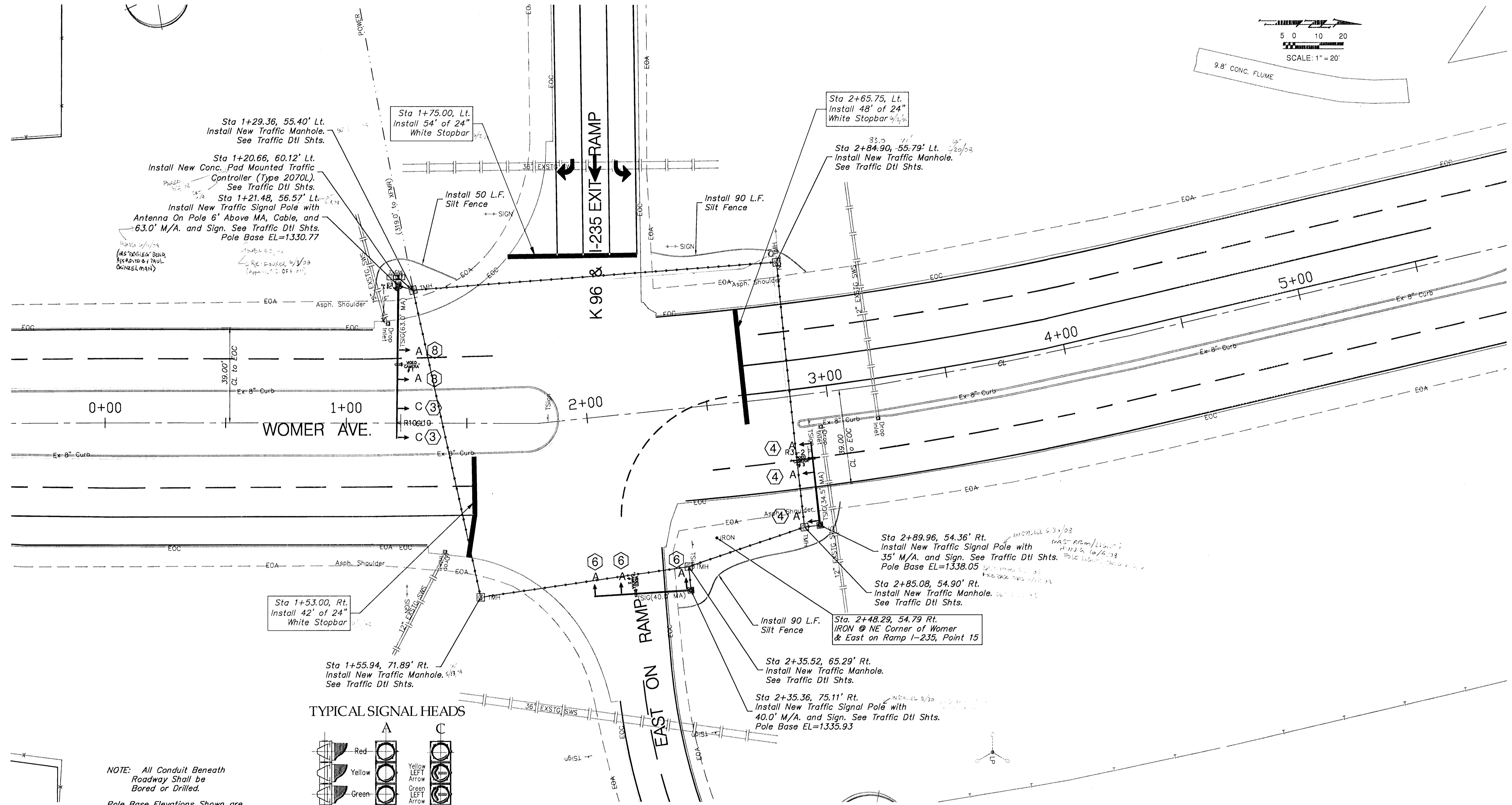
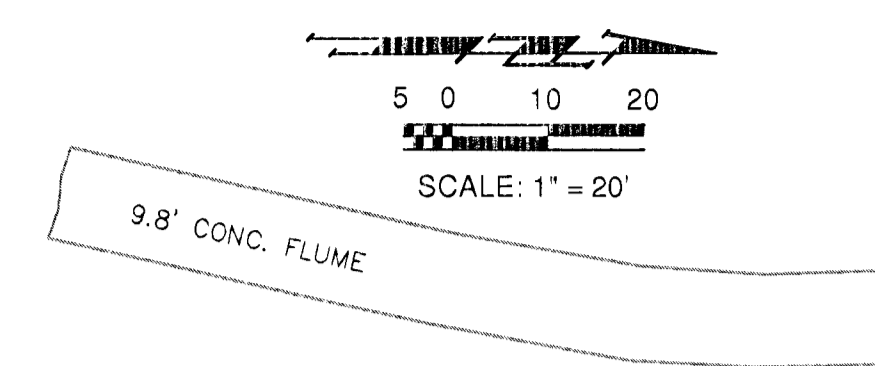

NOTE: All Conduit Beneath Roadway Shall be Bored or Drilled.
Pole Base Elevations Shown are Based on Required Clearances. See Signal Pole Detail Sheet for Additional Information.

Contractor to Remove Stop Sign when Signal is Put into Operation.

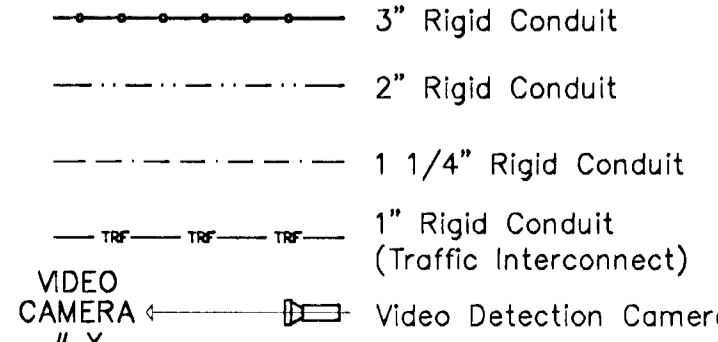
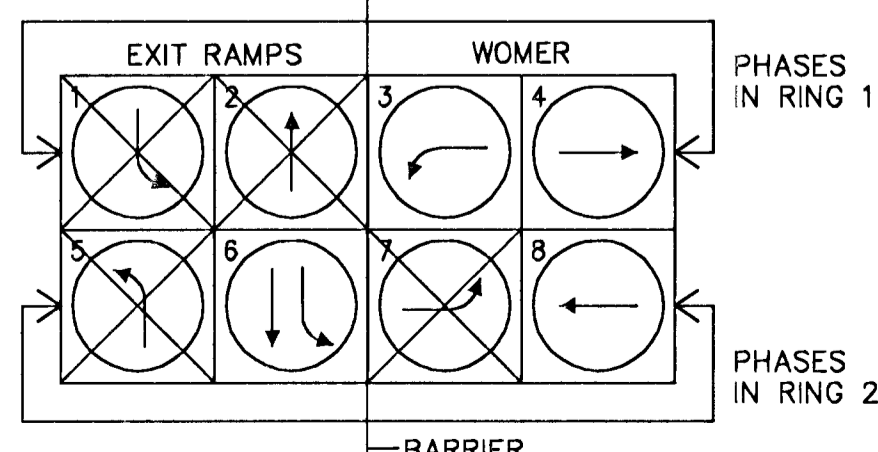

Drawing File: E:\Eng\1235 and meridian\signalization\land\bae\layou1.dwg
 Design: ICA
 Create: ICA
 Approved: ENGINEER
 Scale: NOTED
 Project No. 07-02-0758 CAPITAL IMPROVEMENT PROJECT
I-235 & MERIDIAN SIGNALIZATION
WOMER & EAST ON RAMP
 PROJECT DESCRIPTION

Baughman Company, P.A.
 315 Ella St. Wichita, KS 67211 P 316-262-7271 F 316-262-0149
 ENGINEERING | SURVEYING | PLANNING | LANDSCAPE ARCHITECTURE