

BENCHMARK:
 BM #2 "B" Cut Top of West Curb of Median, 41'
 East of NE Corner SE 1/4 Sec. 25, Twp 26, R.1W.
 Elev. = 1335.54 MSL

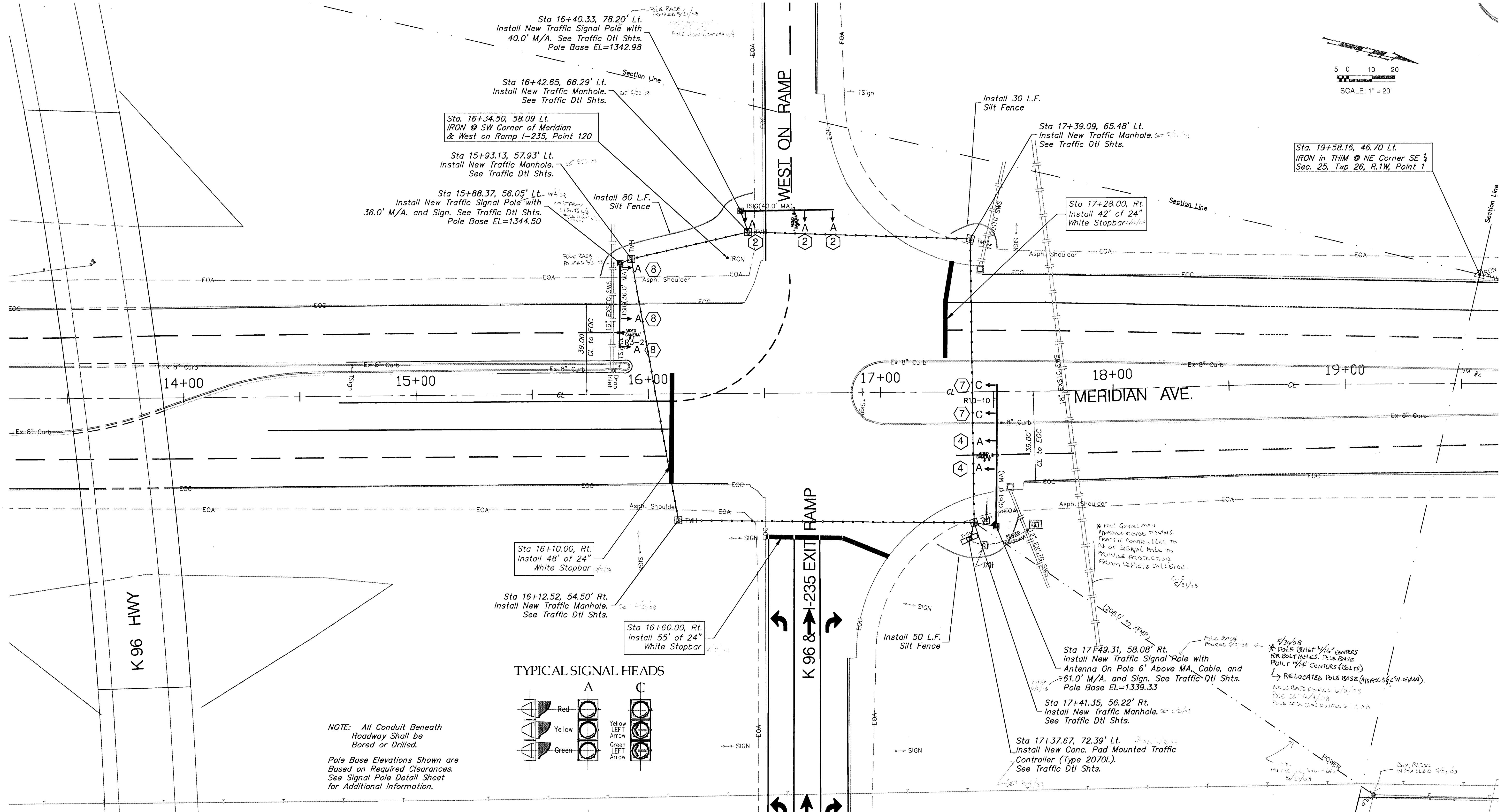

TYPICAL SIGNAL HEADS

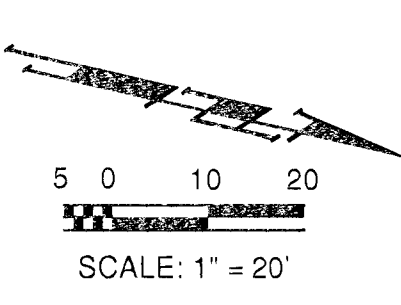
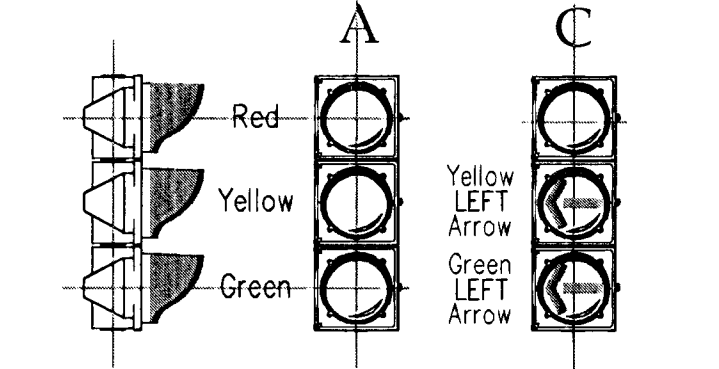

NOTE: All Conduit Beneath Roadway Shall be Bored or Drilled.
 Pole Base Elevations Shown are Based on Required Clearances. See Signal Pole Detail Sheet for Additional Information.

Contractor to Remove Stop Sign when Signal is Put into Operation.

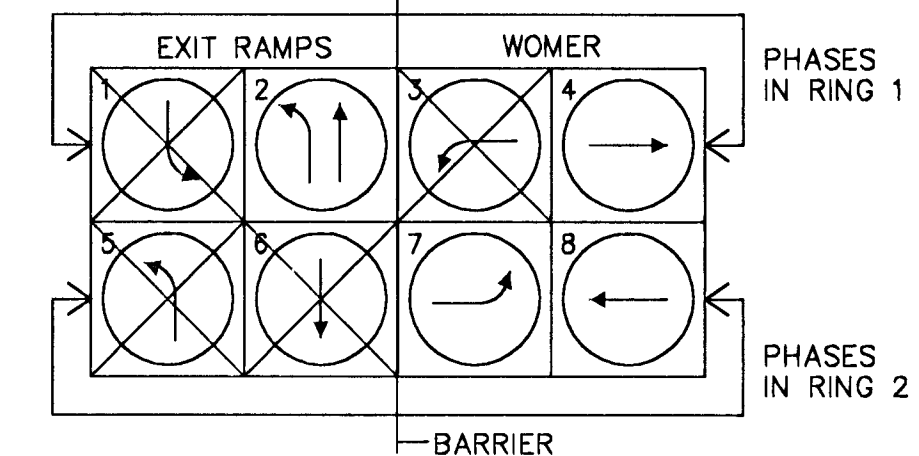

- 3" Rigid Conduit
- 2" Rigid Conduit
- 1 1/4" Rigid Conduit
- 1" Rigid Conduit (Traffic Interconnect)
- VIDEO CAMERA # X
- Video Detection Camera

Drawing File: E:\Eng\1235 and meridian signalization\land\bar\landcut1.dwg
 Project No. 07-02-EP-58 CAPITAL IMPROVEMENT PROJECT

Design: TCA	Project: I-235 & MERIDIAN SIGNALIZATION
Drawn: TCA	Project: MERIDIAN WEST ON RAMP
Approved: ENGINEER	
Scale: NOTED	

Baughman Company, P.A.
 315 Ella St., Wichita, KS 67211 P 316-262-7271 F 316-262-0149
 ENGINEERING | SURVEYING | PLANNING | LANDSCAPE ARCHITECTURE

December, 2007	SHEET
	4
	OF
	8