

**INLET CONNECTION:**  
 REMOVE FLOOR SHAPING AS NECESSARY. INSTALL NEW PIPE, CUT FLUSH WITH INSIDE WALL OF INLET, AND GROUT IN PLACE WITH NON-SHRINK GROUT. INSTALL NEW FLOOR SHAPING.  
 THIS WORK SHALL BE PAID FOR AS THE LUMP SUM ITEM "INLET CONNECTION", WHICH SHALL BE FULL COMPENSATION FOR ALL MATERIALS, TOOLS, EQUIPMENT, LABOR, AND ANY INCIDENTALS NECESSARY TO COMPLETE THE CONNECTION.

NOTE (A): COORDINATE INSTALLATION OF STORM SEWER PIPE AND RIP RAP IN THE POND WITH GEORGE LAHAM (PH: 316-292-3950)

STORM WATER SEWER LINE NO. 3

STORM WATER SEWER LINE NO. 4

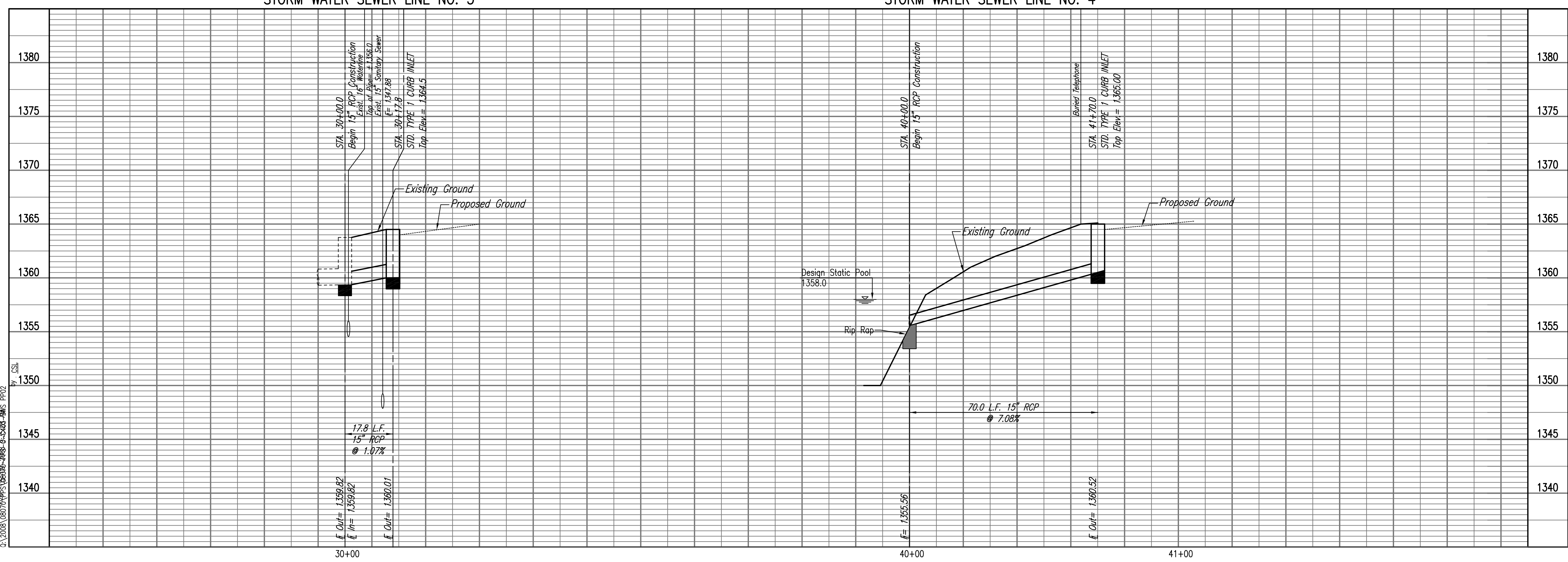

Sheet 05-09-2008 8:05:24 AM by CSL  
 Plot Scale  
 2/2/2008 08:07:49 PPS 06000-0006-0-3500-AMS PPOZ

CITY OF WICHITA PRIVATE PROJECT NO. 1861 PPS (607861)



ISSUE	DATE
PRICING	21 FEB 08
SITE PERMIT	27 MAR 08
FOR PERMIT	17 APR 08
CONSTRUCTION	08 MAY 08

**STORM WATER SEWER LINE PLAN / PROFILE**

**C-403**

© 2008 Shelden Architecture, Inc.



Professional Engineering Consultants, P.A.  
 303 S. TOPEKA - WICHITA, KANSAS 67202 - 316 262 2691  
 www.pcc.com • design@pcc.com