

STORM WATER DRAIN #344
THE MOORINGS TENTH
ADDITION

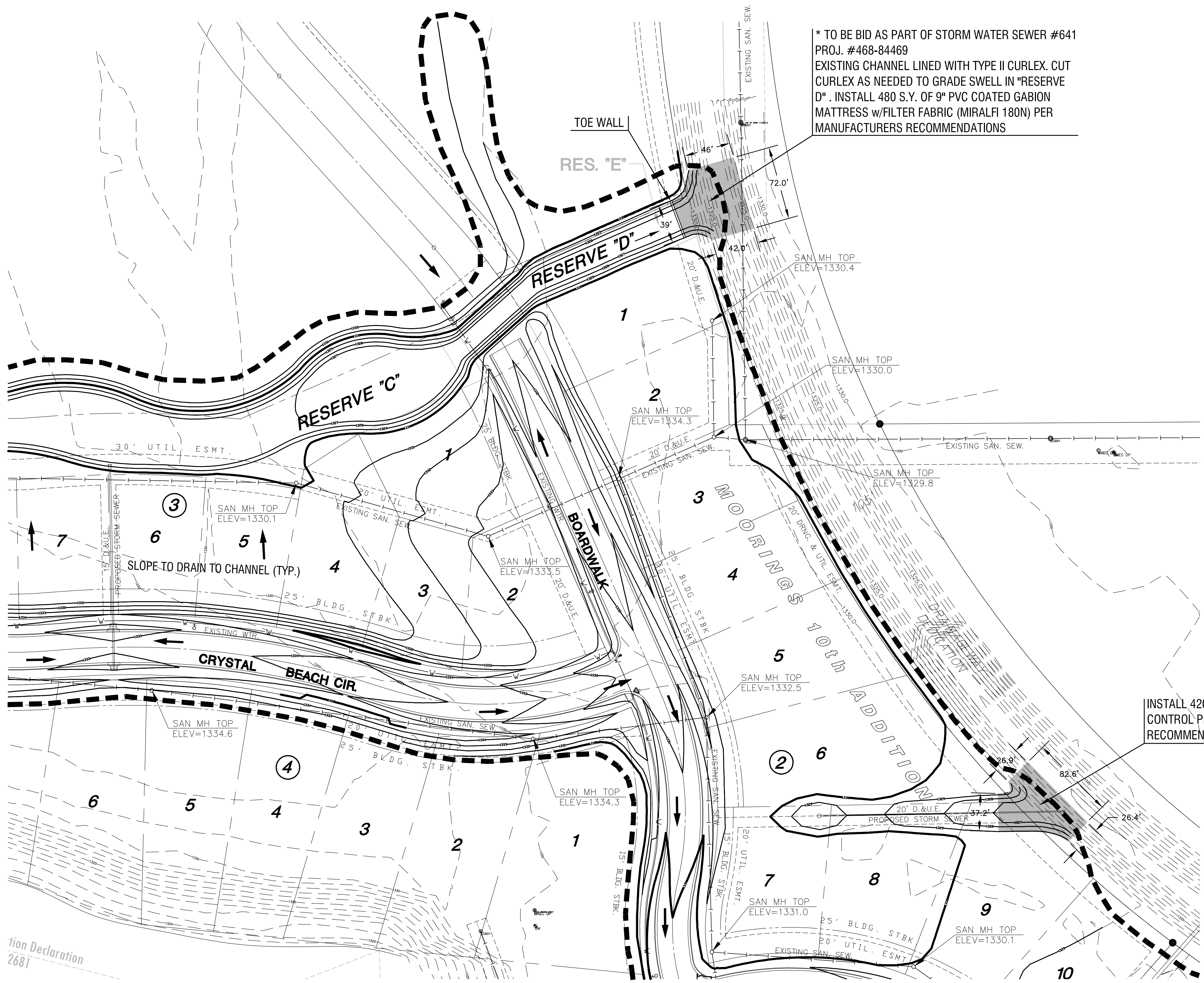
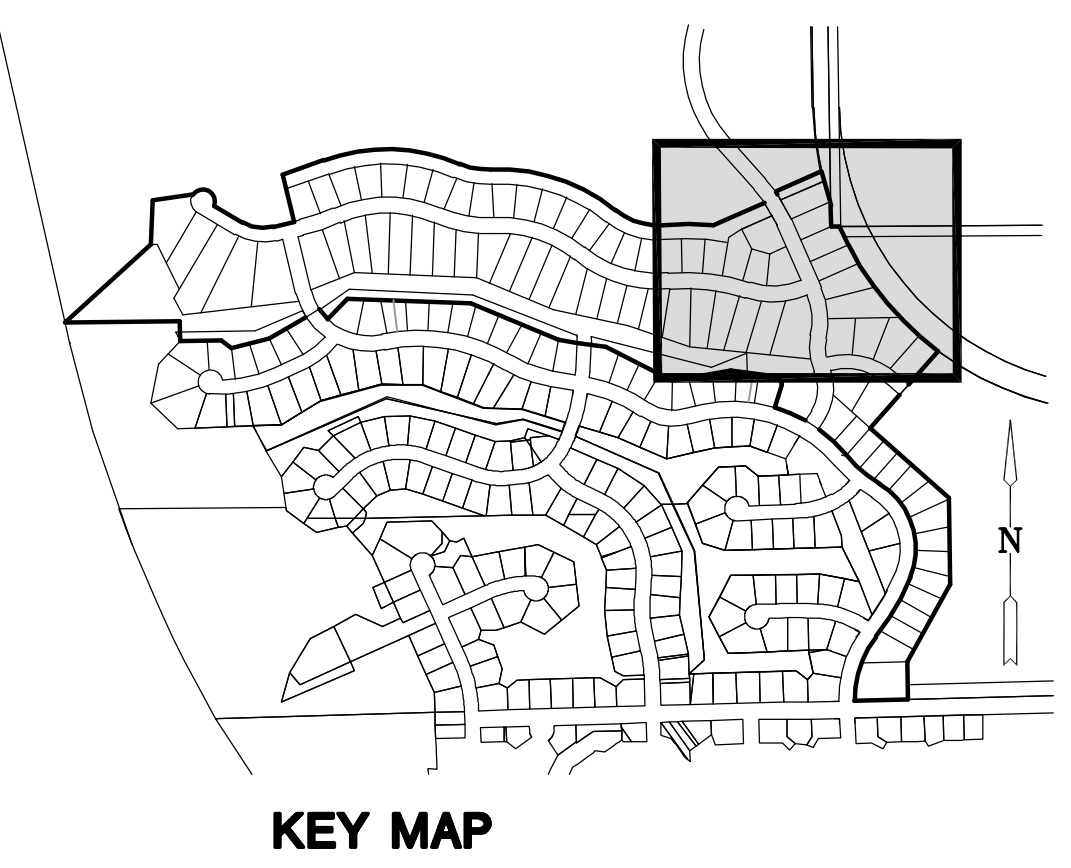

* TO BE BID AS PART OF STORM WATER SEWER #641
PROJ. #468-84469
EXISTING CHANNEL LINED WITH TYPE II CURLEX. CUT
CURLEX AS NEEDED TO GRADE SWELL IN "RESERVE
D". INSTALL 480 S.Y. OF 9" PVC COATED GABION
MATTRESS w/FILTER FABRIC (MIRALFI 180N) PER
MANUFACTURERS RECOMMENDATIONS

INSTALL 420 S.Y. OF C-350 EROSION
CONTROL PER MANUFACTURERS
RECOMMENDATIONS

- LEGEND**
- v — - EXISTING WATER LINE
 - — — - EXISTING SANITARY SEWER
 - - - 1373 - - EXISTING CONTOUR
 - - - 1375 - - PROPOSED CONTOUR
 - - - - - LIMITS OF GRADING
 - - FLOW ARROW

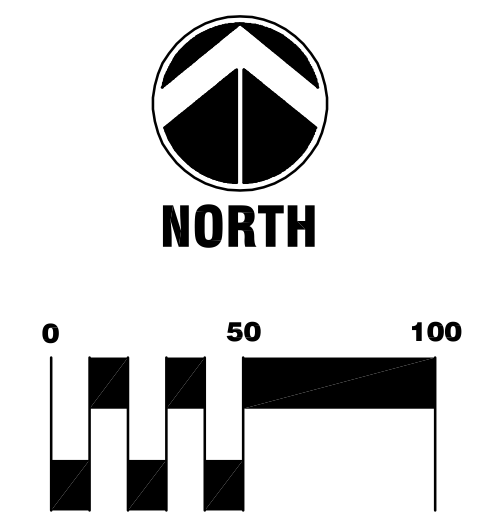

tion Declaration
2681

GRADING PLANS
SHEET TITLE
468-84468
PROJECT NUMBER

MKEC
DESIGN BY
RKO
DRAWN BY
GJA
CHECKED BY

ISSUED
August 2008
REVISED

SHEET NO.
4 of 17

PLOTTED: Wednesday, August 27, 2008 @ 12:30PM

J:\CIVIL\06608\DWG\GRADE\10THADDITION\06608_G3.DWG