

McDONALDS OF: WICHITA, KANSAS

2616 W. 53RD ST. N.
PART OF LOT 3,
NORTHGATE COMMERCIAL PARK 1ST ADDITION

PRIVATE STORM SEWER IMPROVEMENTS
TO SERVE: McDONALDS

CITY ENGINEER: JAMES ARMOUR, P.E., CITY ENGINEER
1892 PPS OCA: 607861

NOTE TO CONTRACTOR:

Required inspections:

- Reinforcing steel or structural framework of any part of any building or structure shall not be covered or concealed without receiving inspection approval by The Office of Central Inspection. In addition to required electrical, mechanical and plumbing inspections, the building permit holder or his agent shall request The Office of Central Inspection to make the following called building construction inspections:
 - Foundation inspection prior to the pouring of concrete
 - Frame inspection after pipes, chimneys and vents are installed but prior to concealing the framework
 - Insulation and wallboard inspection
 - Final Inspection prior to occupancy of the building
- Approved Plans:
A set of building plans and specifications approved by The Office of Central Inspection and marked "FIELD COPY" shall be kept on the project during construction until final inspection approval has been made.
- Plan Modifications:
Changes made, during construction of a project, that affect exiting, wall configuration and structural elements that are not just "cosmetic", require revised plans to be submitted to The Office of Central Inspection for review and approval. If a licensed Architect or Engineer sealed the original plans, the revised plans must also be sealed.
- Door Hardware:
All doors required for egress (exit doors) shall be installed with approved hardware as listed below:
 - Exit doors shall be operable from the inside without the use of a key or any special knowledge or effort. For exception on the main exterior exit see 2000 IBC Section 1003.3.1.8.
 - Manually operated edge or surface mounted flush bolts and surface bolts are prohibited. See 2000 IBC 1003.3.1.8.
 - Handles, pulls, latches, locks, and all other operating devices, on accessible doors shall be easy to grasp with one hand and shall not require tight grasping, tight pinching, or twisting of the wrist to operate. Lever operated mechanisms, push type mechanisms, and U-shaped mechanisms are acceptable designs.



STATE LOCATION MAP

APPROVED AS NOTED BY CITY ENGINEER OF WICHITA

STORM SEWER *Julian Kallman 7-15-08*

NOTE TO CONTRACTORS

INSTALLATION, INSPECTION AND TESTING FOR THIS PROJECT IS TO BE PROVIDED BY A LICENSED CONSULTING ENGINEERING FIRM UNDER CONTRACT WITH THE OWNER/DEVELOPER. SAID INSPECTION TO BE IN ACCORDANCE WITH THE CITY OF WICHITA STANDARD CONSTRUCTION ENGINEERING PRACTICES AND CERTIFIED BY A LICENSED PROFESSIONAL ENGINEER. NO WORK SHALL BE PERFORMED IN DEDICATED EASEMENTS OR PUBLIC RIGHT-OF-WAY BY THE CONTRACTOR WITHOUT SUCH INSPECTION NOR SHALL ANY WORK BE COMMENCED WITHOUT WRITTEN AUTHORIZATION BY THE CITY ENGINEER. ALL CONSTRUCTION AND MATERIALS SHALL COMPLY WITH THE CITY OF WICHITA SPECIFICATIONS AND STANDARDS (ON FILE AND AVAILABLE IN THE CITY ENGINEERS OFFICE).

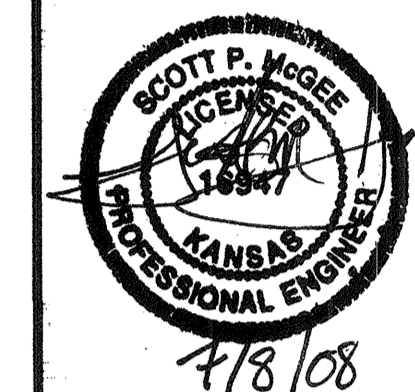

Czark
Civil Engineering Inc.
Bentonville • Kansas City • Austin

As Built Plans:

CONTRACTOR: McCullough Excavation
INSPECTOR: Tom Jones, K E Miller Engineering
PDF by: NWS, 09-24-08

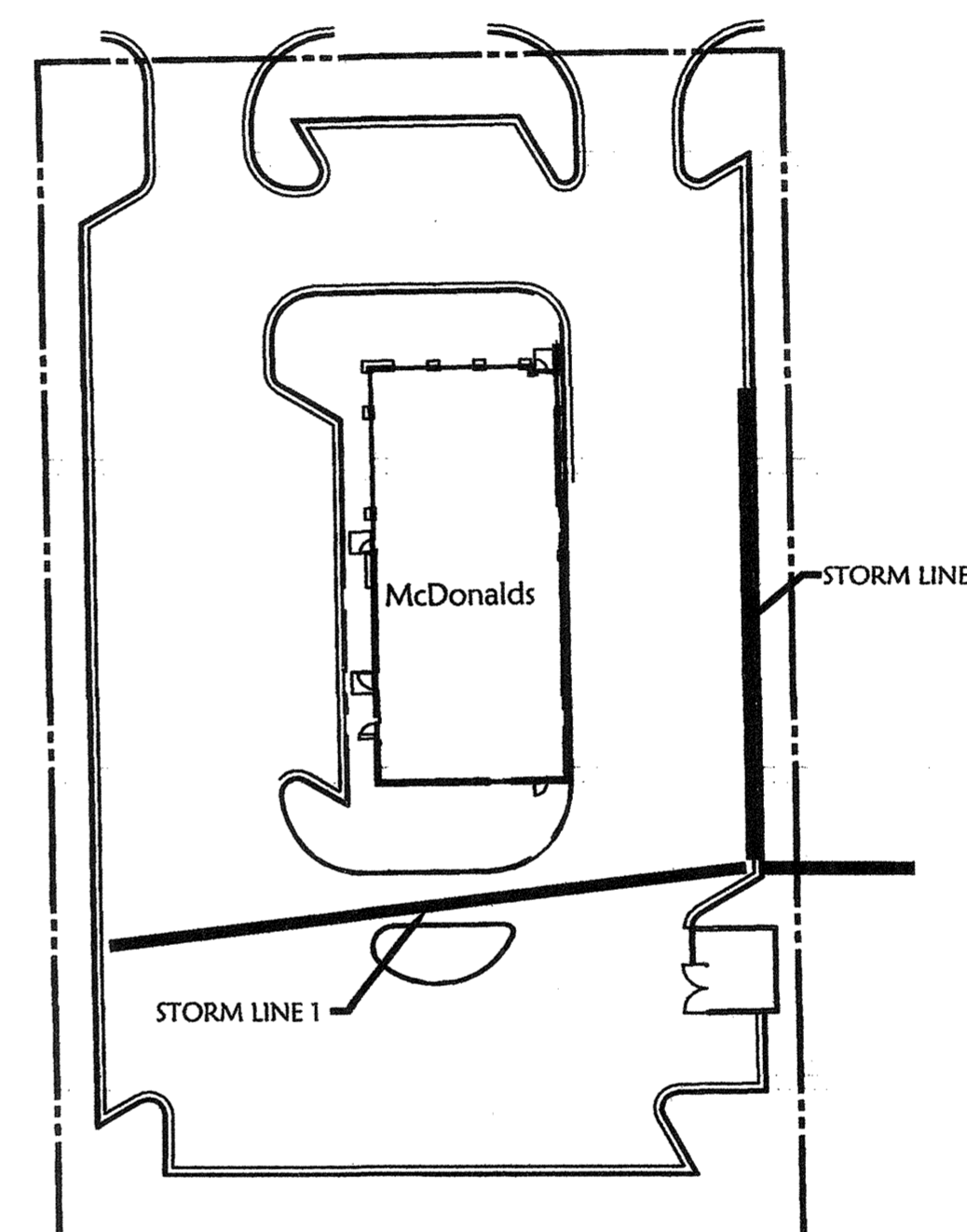

W. 53RD ST. N.

DRAWING INDEX:

	DATE	REV/BID/CO/ADD
C-1	07-08-08	CITY COMMENTS
C-2	06-26-08	CITY COMMENTS
C-3	DATE	
C-4	06-26-08	CITY COMMENTS
C-5	07-08-08	CITY COMMENTS
C-6	07-08-08	CITY COMMENTS
C-7	06-26-08	CITY COMMENTS
C-8	06-26-08	CITY COMMENTS
SD1	06-26-08	CITY COMMENTS
SD2	06-26-08	CITY COMMENTS
SD3	06-26-08	CITY COMMENTS
SD4	06-26-08	CITY COMMENTS
SD5	06-26-08	CITY COMMENTS
SD6	06-26-08	CITY COMMENTS
SD7	06-26-08	CITY COMMENTS
SD8	06-26-08	CITY COMMENTS
SD9	06-26-08	CITY COMMENTS
SD10	06-26-08	CITY COMMENTS

COVER GENERAL NOTES:

INFORMATION CONCERNING UNDERGROUND UTILITIES WAS OBTAINED FROM AVAILABLE RECORDS AND EXISTING FIELD CONDITIONS WHEN POSSIBLE. THE CONTRACTOR MUST DETERMINE THE EXACT LOCATION AND ELEVATION OF ALL EXISTING UTILITIES BY HAND DIGGING TEST PITS AT ALL UTILITY CROSSINGS IN ADVANCE OF TRENCHING WITH ANY MECHANICAL DEVICE. CLEARANCES LESS THAN SPECIFIED ON THESE PLANS OR 18", WHICHEVER IS LESS, CONTRACTOR SHALL CONTACT OZARK CIVIL ENGINEERING, INC. @ 913-310-0470 PRIOR TO ANY FURTHER CONSTRUCTION.

CONTRACTOR SHALL BE RESPONSIBLE FOR RELOCATION OR REMOVAL OF EXISTING UNDERGROUND UTILITIES SHOWN OR NOT SHOWN AT NO ADDITIONAL COST TO THE OWNER.

CONTRACTOR SHALL INCLUDE IN CONTRACT THE PRICE FOR THE REMOVAL AND DISPOSAL OF ANY EXCESS TOPSOIL THE DETERMINES IS NOT NEEDED TO ESTABLISH THE FINAL GRADES AND LANDSCAPING.

CONTRACTOR SHALL BE RESPONSIBLE FOR THE DESIGN AND USE OF ANY AND ALL REQUIRED OR NECESSARY SHORING, SHEETING, BRACING AND SPECIAL EXCAVATION MEASURES REQUIRED ON THIS PROJECT THAT WILL MEET OR EXCEED OSHA, FEDERAL, STATE AND LOCAL REGULATIONS DURING CONSTRUCTION. OZARK CIVIL ENGINEERING, INC. AND THE DEVELOPER/OWNER ACCEPTS NO RESPONSIBILITY FOR THE CONTRACTORS FAILURE TO COMPLY WITH THESE REGULATIONS.

ALL UTILITIES, INCLUDING STORM SEWER, SHOWN WITHIN PUBLIC EASEMENTS OR RIGHT OF WAYS SHALL BE CONSTRUCTED TO THE GOVERNING AGENCY'S SPECIFICATIONS. ALL OTHER UTILITIES SHALL BE CONSTRUCTED TO THE CLIENT'S OR THE GOVERNING AGENCY'S SPECIFICATIONS, WHICHEVER IS MORE STRINGENT. IF THERE IS A QUESTION AS TO WHICH SPECIFICATIONS SHOULD APPLY THE CONTRACTOR SHALL CONTACT THE ENGINEER OF RECORD.

IT IS THE RESPONSIBILITY OF THE CONTRACTOR TO FOLLOW ALL RECOMMENDATIONS SET FORTH IN THE GEOTECHNICAL STUDY. WHERE A CONFLICT EXISTS BETWEEN THE HIGHWAY DEPARTMENT / CITY STANDARDS, OR THE GEOTECH STUDY, THE MOST STRINGENT SHALL APPLY.

FURTHERMORE IT IS THE RESPONSIBILITY OF THE CONTRACTOR TO MAINTAIN THE EROSION CONTROL MEASURES AS SHOWN ON THESE PLANS. CONTRACTOR SHALL KEEP THESE MAINTAINED THROUGHOUT ALL PHASES OF CONSTRUCTION. CONTRACTOR SHALL ALSO BE RESPONSIBLE FOR IMPLEMENTING THE SWPPP.

ALL PHASES OF CONSTRUCTION SHALL MEET OR EXCEED THE OWNER / DEVELOPER SITE WORK SPECIFICATIONS.

SEE ARCHITECTURAL PLANS FOR THE EXACT DIMENSIONS AND LOCATIONS OF ANY RAMPS, VESTIBULE, PORCHES, SLOPED PAVING, BUILDING UTILITY ENTRANCE LOCATIONS, TRUCK DOCKS OR WELLS, AND PRECISE BUILDING DIMENSIONS.

CONTRACTOR SHALL REMOVE AND DISPOSE OF ALL DEBRIS, RUBBISH AND OTHER MATERIALS RESULTING FROM PREVIOUS AND CURRENT DEMOLITION PROCEDURES. DISPOSAL SHALL BE IN ACCORDANCE WITH ALL LOCAL, STATE AND/OR FEDERAL REGULATIONS GOVERNING SUCH OPERATIONS.

OZARK CIVIL ENGINEERING INC. AND ITS ASSOCIATES WILL NOT BE HELD RESPONSIBLE FOR THE ACCURACY OF THE SURVEY OR FOR DESIGN ERRORS OR OMISSIONS RESULTING FROM SURVEY INACCURACIES. IT IS THE RESPONSIBILITY OF THE CONTRACTOR TO FIELD VERIFY ALL EXISTING FEATURES AS SHOWN ON THE SURVEY AND NOTIFY THE SURVEYOR AND THE ENGINEER OF RECORD OF ANY INACCURACIES FOUND ON THE SURVEY PRIOR TO BEGINNING CONSTRUCTION.

THE GENERAL CONTRACTOR SHALL BE HELD SOLELY RESPONSIBLE FOR AND SHALL TAKE ALL PRECAUTIONS NECESSARY TO AVOID PROPERTY DAMAGE TO ADJACENT PROPERTIES DURING THE CONSTRUCTION PHASES OF THIS PROJECT.

ALL CONSTRUCTION IN THE STATE RIGHT-OF-WAY SHALL BE COORDINATED WITH THE HIGHWAY DEPARTMENT.

THE CONTRACTOR SHALL BE SOLELY AND COMPLETELY RESPONSIBLE FOR CONDITIONS OF THE JOB SITE, INCLUDING SAFETY OF ALL PERSONS AND PROPERTY DURING ALL PHASES OF CONSTRUCTION OF THIS SITE. THIS REQUIREMENT SHALL APPLY CONTINUOUSLY AND SHALL NOT BE LIMITED TO CONSTRUCTION WORKING HOURS.

WARRANTY / DISCLAIMER

THE DESIGNS REPRESENTED IN THESE PLANS ARE IN ACCORDANCE WITH ESTABLISHED PRACTICES OF CIVIL ENGINEERING FOR DESIGN FUNCTION AND USE INTENDED BY THE OWNER AT THIS TIME. HOWEVER, NEITHER THE ENGINEER NOR HIS PERSONNEL CAN OR DO WARRANT THESE DESIGNS OR PLANS AS CONSTRUCTED EXCEPT IN THE SPECIFIC CASES WHERE THE ENGINEER INSPECTS AND CONTROLS THE PHYSICAL CONSTRUCTION AT THE SITE.

SITE UTILITY CONTACTS CITY OF WICHITA, KS.

CITY OF WICHITA, KS. PAUL HAYS 455 N. MAIN WICHITA, KS. 67202-1688 316-268-4477 (V) 316-268-4663 (F)	SANITARY SEWER STEVE KING 455 N. MAIN WICHITA, KS. 67202-1688 316-268-4501 (V) 316-268-4114 (F)	GAS (KGE) ED KOEHLER 1021 E 26TH NORTH WICHITA, KS 67219 316-832-3177 (V) 316-832-3175 (F)
CITY ENGINEER CURTIS BOWEN 455 N. MAIN WICHITA, KS. 67202-1688 316-268-4292 (V) 316-268-4663 (F)	TELEPHONE (AT&T) CHARLES OFFICER 154 N BROADWAY, RM # 210 WICHITA, KS 67202 316-268-2222 (V)	SIGNAGE JR COX 455 N. MAIN WICHITA, KS. 67202-1688 316-268-4479 (V) 316-268-4663 (F)
WATER STEVE KING 455 N. MAIN WICHITA, KS. 67202-1688 316-268-4501 (V) 316-268-4114 (F)	ELECTRIC (WESTAR ENERGY) BRANDON CHADD PO BOX 208 WICHITA, KS 67201 316-261-6734 (V) 316-261-6979 (F)	CIVIL ENGINEER OZARK CIVIL ENGINEERING C/O EARL HACKER 11285 STRANG LINE ROAD LENEXA, KS 66215 913-310-0470 (V)
FIRE RICK STUBBS 455 N. MAIN WICHITA, KS. 67202-1688 316-268-4477 (V) 316-858-7345 (F)		OWNER/DEVELOPER McDONALDS CORP. C/O JEFF PRUETTER 10801 MASTIN BLVD STE 400 OVERLAND PARK, KS 66210 913-217-3800 (V)

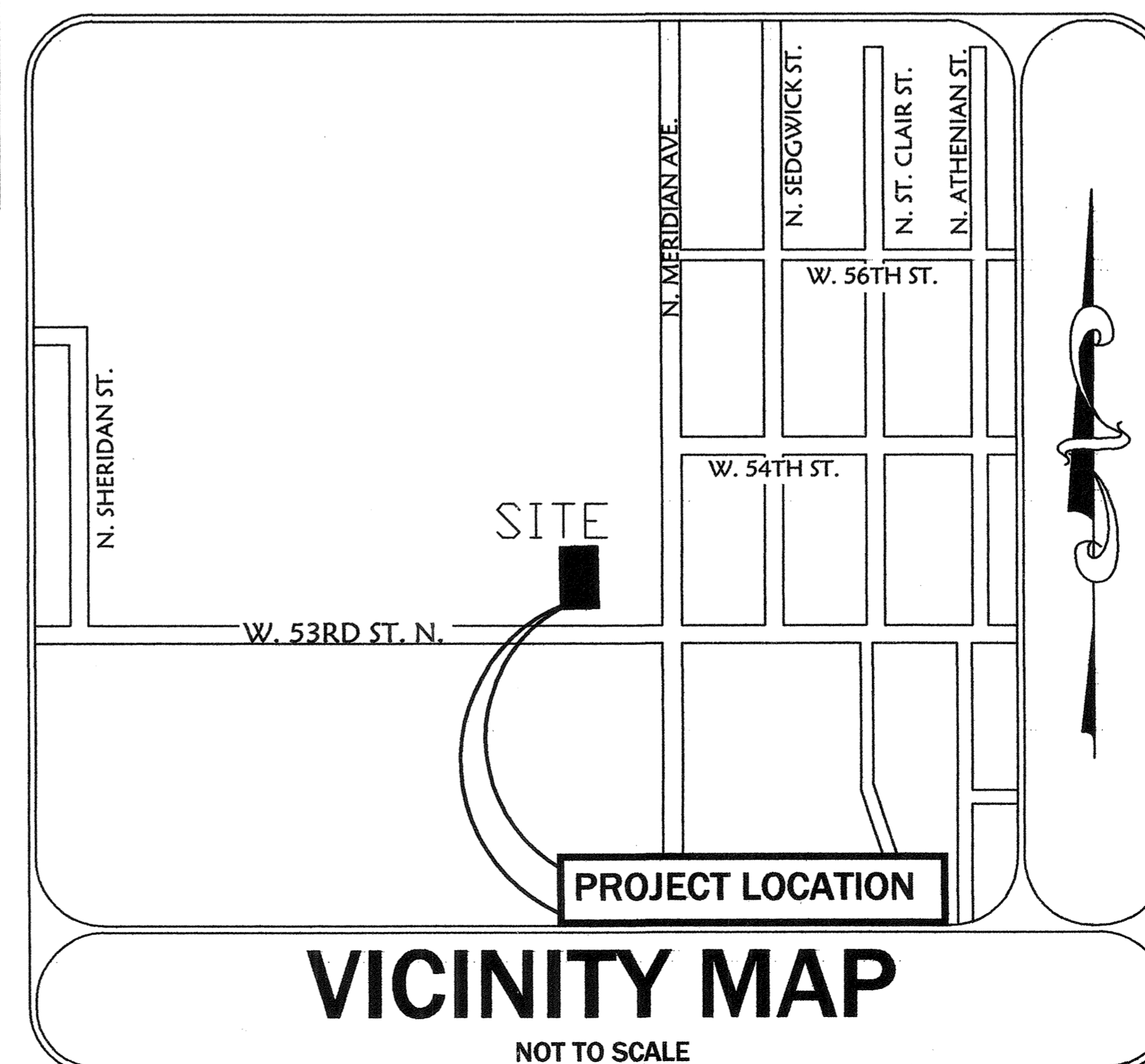

VICINITY MAP

NOT TO SCALE

STREET ADDRESS		STATUS	DATE	BY
2616 W. 53RD ST. N.		PRELIMINARY:	04/30/08	EDH
CITY	STATE	PLAN CHECKED:		SPM
WICHITA	KS	AS-BUILT:		
COUNTY	REGIONAL DWG. NO	JOB NO:	07-0738	
SEDGWICK	015-0353			
COVER SHEET				
				C-1