

STA. 31+95.33 BEGIN
 W.B. SHOOFLY = 39.33' RT.
 STA. 31+95.33 @ N. FTG. RD.
 SEE SH. 22 FOR GEOMETRIC DATA

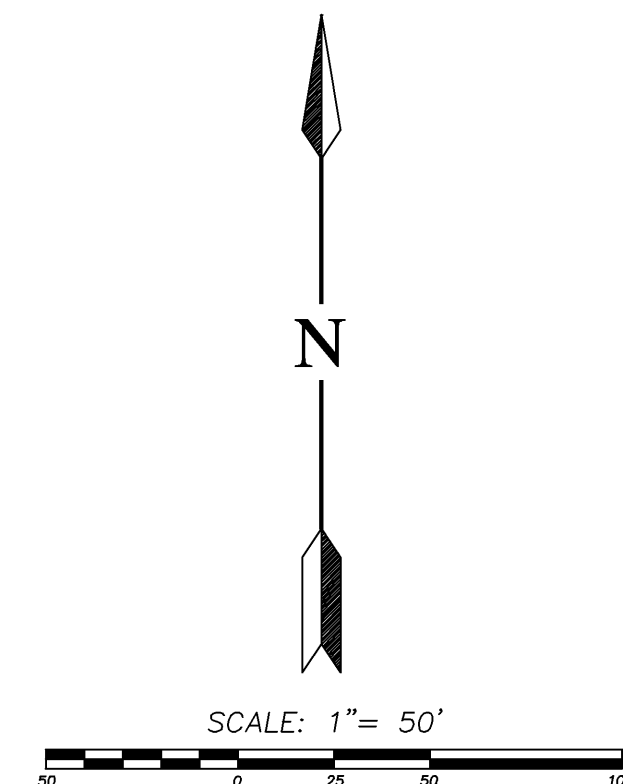





STA. 31+80.86 BEGIN
 E.B. SHOOFLY = 91.84' RT.
 STA. 31+80.86 @ N. FTG. RD.
 SEE SH. 22 FOR GEOMETRIC DATA

STA. 43+96.33 END
 W.B. SHOOFLY = 37.99' RT.
 STA. 43+96.33 @ N. FTG. RD.
 SEE SH. 22 FOR GEOMETRIC DATA

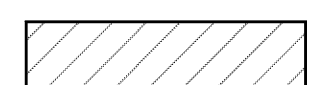
STA. 44+12.12 END
 E.B. SHOOFLY = 89.27' RT.
 STA. 44+12.12 @ N. FTG. RD.
 SEE SH. 22 FOR GEOMETRIC DATA

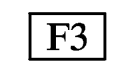

LEGEND

-  MEDIAN PAVING
-  AREA OF CONSTRUCTION THIS PHASE
-  AREAS CONSTRUCTED IN PREVIOUS PHASES
-  I.B. INERTIAL BARRIER
-  F3 TEMPORARY CONCRETE SAFETY BARRIER (TYPE F3)
-  CD20 CHANNELIZATION DEVICE (20' SPACING)
-  CD25 CHANNELIZATION DEVICE (25' SPACING)

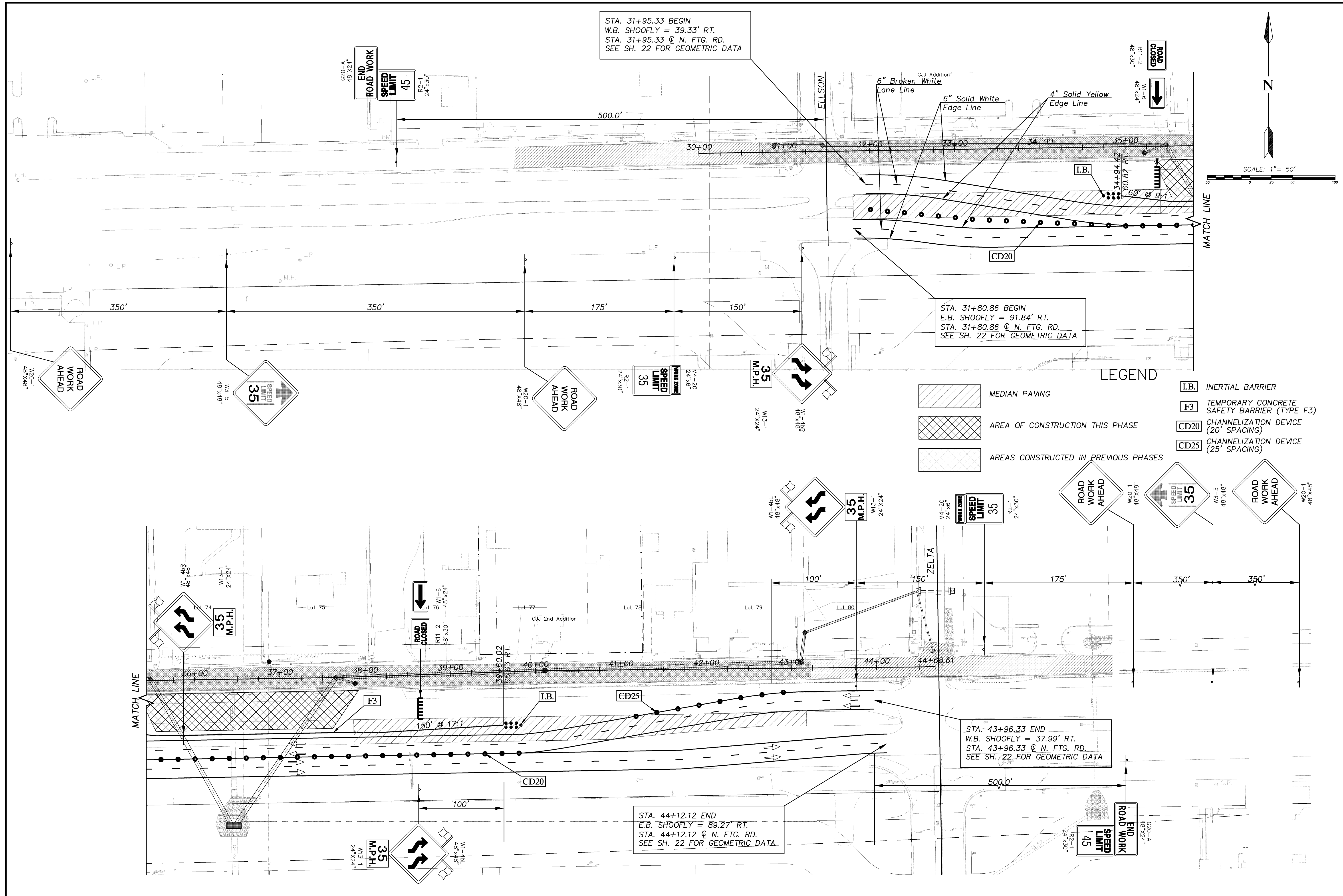

REVISED

SEAL:

Cook, Flatt & Strobel
 ENGINEERS, P.A.



CFS PROJECT NO:
 07-025

CITY OF WICHITA, KANSAS
STORMWATER IMPROVEMENTS
 ELLSON TO ZELTA

DESIGNED BY: _____ DRAWN BY: _____ CHECKED BY: _____

SHEET TITLE:
**TRAFFIC CONTROL
 PHASE I**

PROJECT NUMBER

OFFICE
 CHECK

SHEET NUMBER:
21 of 44

CFS PROJECT FILE: