

Benchmark:
 "□" Cut On Top of Curb, West Side of Forestview, East of Fire Hydrant, and Along Easterly Extension of the South Line of Lot 2, Block A, Liberty Park 2nd Addition.
 Elev. = 1347.62 NGVD29

City of Wichita Benchmark Southwest Corner of 13th St N and 135th St W 30' South and 35' West Intersection. East Side of Concrete Base for Highline Pole.
 Elev. = 1355.65 NGVD29

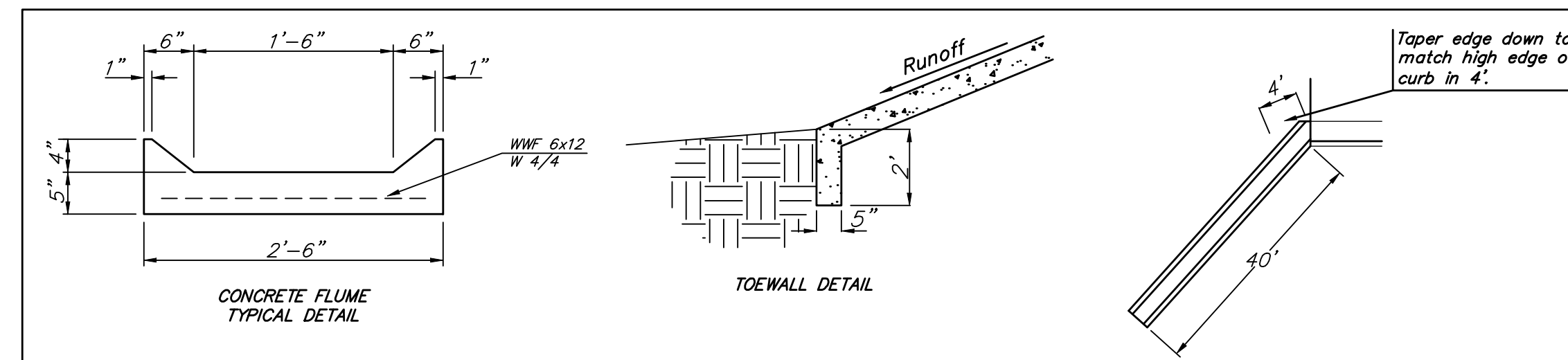
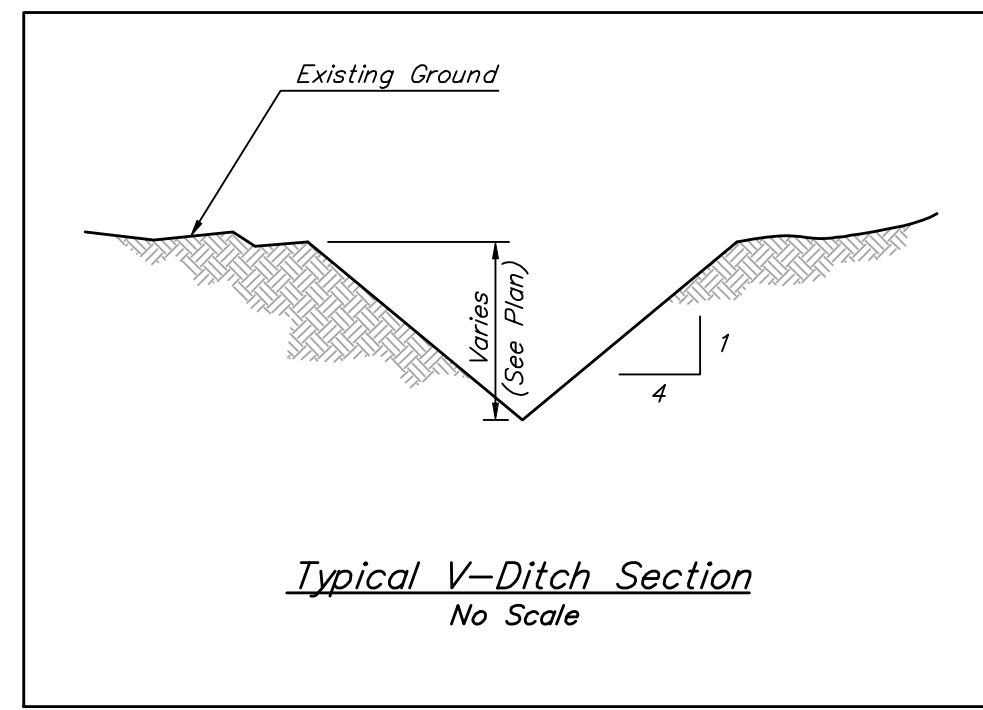
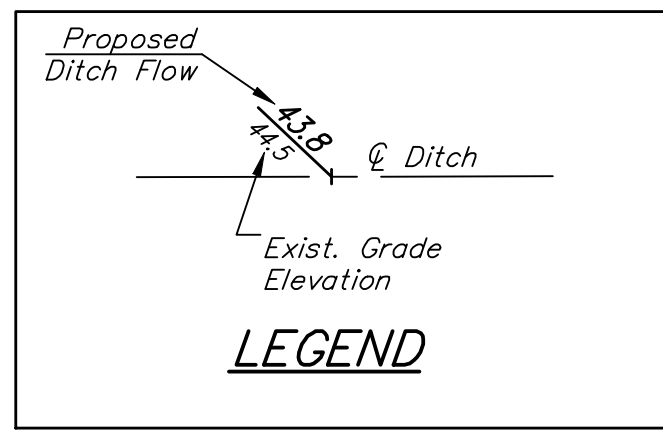
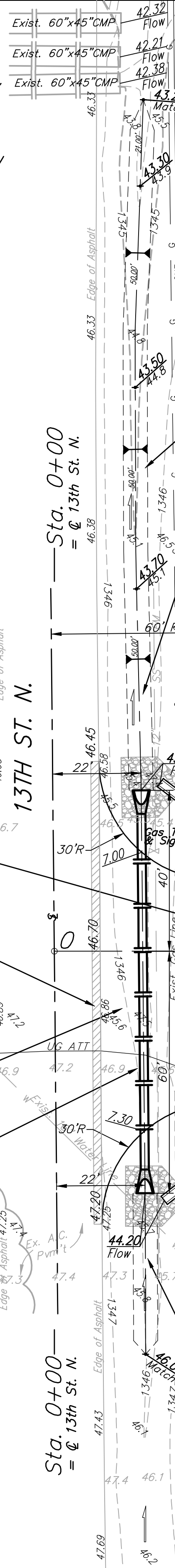

Scale: 1" = 20'
 • = Iron

Curve #1
 Curve Data Based on Centerline
 Rad. = 170.22' Delta = 28° 24' 45" Tangent = 43.09'
 Arc = 84.41' L.C. = 83.55' Def./Ft. = 10.09803 Min.

Station	Arc	FACE CHORD LENGTHS		Defl.	T. Defl.
		8' Lt.	8' Rt.		
3+78.61	-	-	-	0'00"00"	0'00"00"
4+00.00	21.39'	24.52'	18.24'	3'36"00"	3'36"00"
4+25.00	25.00'	28.65'	21.31'	4'12"27"	7'48"27"
4+27.01	2.01'	2.31'	1.71'	0'20"18"	8'08"45"
4+41.81	14.80'	16.97'	12.62'	2'29"27"	10'38"12"
4+63.02	21.21'	24.31'	18.08'	3'34"11"	14'12"23"

P.V.I.
 Elev. = 1351.50
 57.22' V.C.

+1.099%

BLATTNER ADDITION

+1.092%

CRYSTAL GARDENS ADDITION

N LIBERTY ST

W NANTUCKET ST

W HUNTERS VIEW ST

Regrade 171 L.F. Ditch @ 0.4% to Ensure Positive Drainage (See Detail, This Sheet). Cost of Regrading to be Incidental to "Site Clearing & Restoration"

Construct 40 L.F. Concrete Flume both sides per detail, this sheet.

Install 2 - 29' Long 4" PVC pipe (Left) & 2 - 27' long 4" PVC pipe (Right) under pavement. Cap each end. Mark End of Pipes with Wooden Stake Painted Pink. Cost subsidiary to Pavement Cost.

Const. full-height low edge medial curb & gutter. (6-5/8") (See detail, sheet 5) Median shall be filled with friable fill material

Construct 5" A.C. pavement W/ 5" reinf. rock base.

Construct std. comb. full height curb & gutter (6-5/8")

Trans. from Full-Height to Roll-Type Curb & Gutter in 5' (Both Sides)

Sta. 4+29.46, 17.25' Lt. Install subdivision benchmark (Flat survey marker No. 8134-08 3" top diameter) in top of curb. Cost shall be incidental to L.F. curb & gutter.

Sta. 4+57, 29' Lt. Install Std. D3 (SNS) Ass'y. "Liberty" & "Nantucket"

Sta. 4+88, 0' Lt./Rt. Install R6-1R (ONE WAY)

Sta. 5+01.44 = @ W. Nantucket St.

Sta. 0+60.00, Begin construction of 5" A.C. pmt. W/5" reinf. rock base.

Saw cut, remove and replace 2' existing pavement as shown. To be incidental to "Site Clearing & Restoration".

Construct 5" A.C. mat pavement W/ 5" reinf. rock base.

Install 100 L.F. 24" RCP w/ End Sections. Install 20 S.Y. Light Stone Rip-rap as Indicated (Each Side)

Sta. 0+50, 53' Rt. Install std. D3 (SNS) ass'y as per City specs. "13th St (13100 W)" & "Liberty (1400 N)"

Sta. 0+64, 11' Rt. & Sta. 0+96, 11' Rt. Install R4-7 (Keep Right) & OM-1 sign.

Sta. 2+78, 21' Rt. Install W2-6 (ALT) Sign, & W13-1 (15 M.P.H.) Sign

Sta. 4+61, 35' Rt. Install Std. D3 (SNS) Ass'y. "Liberty" & "Hunters View"

Regrade Ditch to Ensure Positive Drainage in 40'. Cost of Regrading to be Incidental to "Site Clearing & Restoration"

Curve #1A
 Curve Data Based on Face of Curb
 Rad. = 100' Delta = 19'27'47" Tangent = 17.15'
 Arc = 33.98' L.C. = 33.81' Def./Ft. = 17.18339 Min.

Station	Fc Arc	Face Chord Lengths		Defl.	Total Defl.
		8' Right	8' Left		
1+02.02	-	-	-	0'00"00"	0'00"00"
1+18.92	16.99'	18.32'	13.32'	4'51"57"	4'51"57"
1+35.34	16.99'	18.32'	13.32'	4'51"57"	9'43"54"

Curve #1B
 Curve Data Based on Centerline
 Rad. = 250' Delta = 19'27'47" Tangent = 42.87'
 Arc = 84.92' L.C. = 84.52' Def./Ft. = 6.87579 Min.

Station	Fc Arc	Face Chord Lengths		Defl.	Total Defl.
		8' Right	8' Left		
1+35.34	-	-	-	0'00"00"	0'00"00"
1+55.63	21.23'	20.55'	20.55'	2'25"58"	2'25"58"
1+76.38	21.23'	20.55'	20.55'	2'25"59"	4'51"57"
1+97.43	21.23'	20.55'	20.55'	2'25"58"	7'17"55"
2+18.64	21.23'	20.55'	20.55'	2'25"59"	9'43"54"

P.V.I.
 Elev. = 1351.50
 57.22' V.C.

Baughman Crystal Gardens Addition
N. LIBERTY ST.
 STA. 0+00 TO STA. 5+01.44

Engineering | Surveying | Planning | Landscape Architecture

PROJECT NUMBER: 472-84606
 REVISIONS:

DESIGN: JAK
 DRAWN: TMS
 APPROVED: [Signature]
 DATE: 9/09/08

SCALE: Noted
 SHEET: **6 OF 34**

E:\eng\Crystal Gardens\Str1.dwg 08-02-E066