

3" W 1316.43'

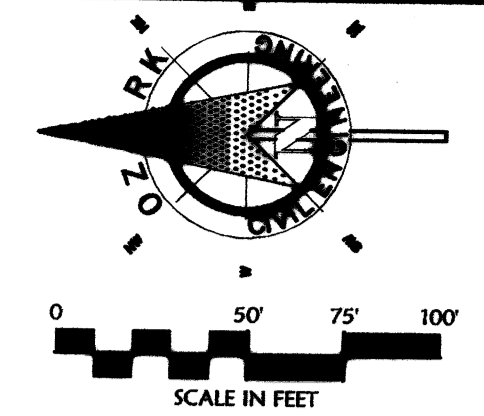

SYMBOL	DESCRIPTION
---	BOUNDARY LINE
- - - - -	RIGHT OF WAY LINE
----	EASEMENT LINE
=====	CONCRETE CURB AND GUTTER
----	FENCE
----	GUARD RAIL
----	RETAINING WALL
○	DROP INLETS (SEE GRADING PLAN FOR TYPE)
○	SANITARY SEWER MANHOLE
○	FIRE HYDRANT WITH GUARD POSTS
○	UTILITY POLE
○	CART CORRAL (FURNISHED AND INSTALLED BY LOWE'S)
○	WATER LINE TEE, BEND, VALVE, AND PLUG

REVISIONS	
DATE	DESCRIPTION

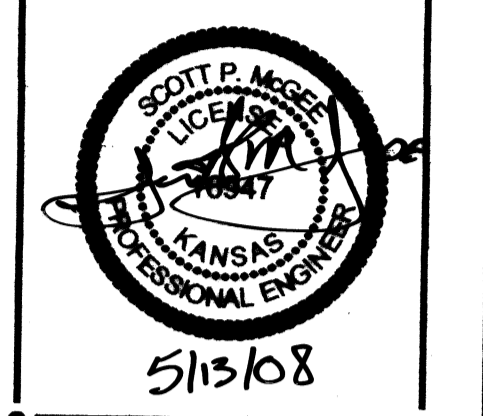

Civil Engineering Inc.
 State Office: 1008 N.W. 11th St., Ste. C, Bentonville, AR 72712
 (479) 464-8850 (V) / (479) 464-9040 (F)
 Regional Office: 11285 Strong Line, Rd. Lenexa, KS 66215
 (913) 310-0470 (V) / (913) 310-0261 (F)

LOWE'S HOME CENTERS, INC.
 HWY. 268 EAST, EAST DOCK
 N. WILKESBORO, NC 28650
 336.658.4000 (V) 336.658.3257 (F)

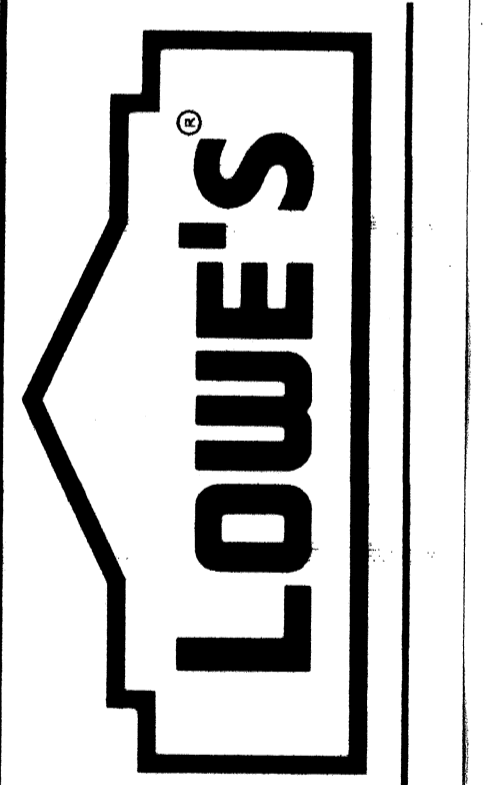

EASEMENT PLAN
 LOWE'S OF
N.W. WICHITA
 MAIZE RD. & CENTRAL PARK ST.
 WICHITA, KS.
 PROJECT No: 04-0460 DRAWN BY: JG CHECKED BY: SK

ORIGINAL ISSUE DATE:
 PERMIT SET ISSUE DATE:
 CONSTRUCTION SET ISSUE DATE: 8-17-07
DRAWING NUMBER:
5

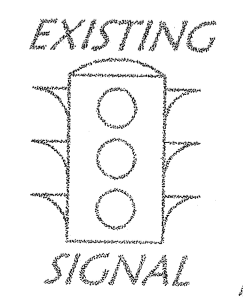
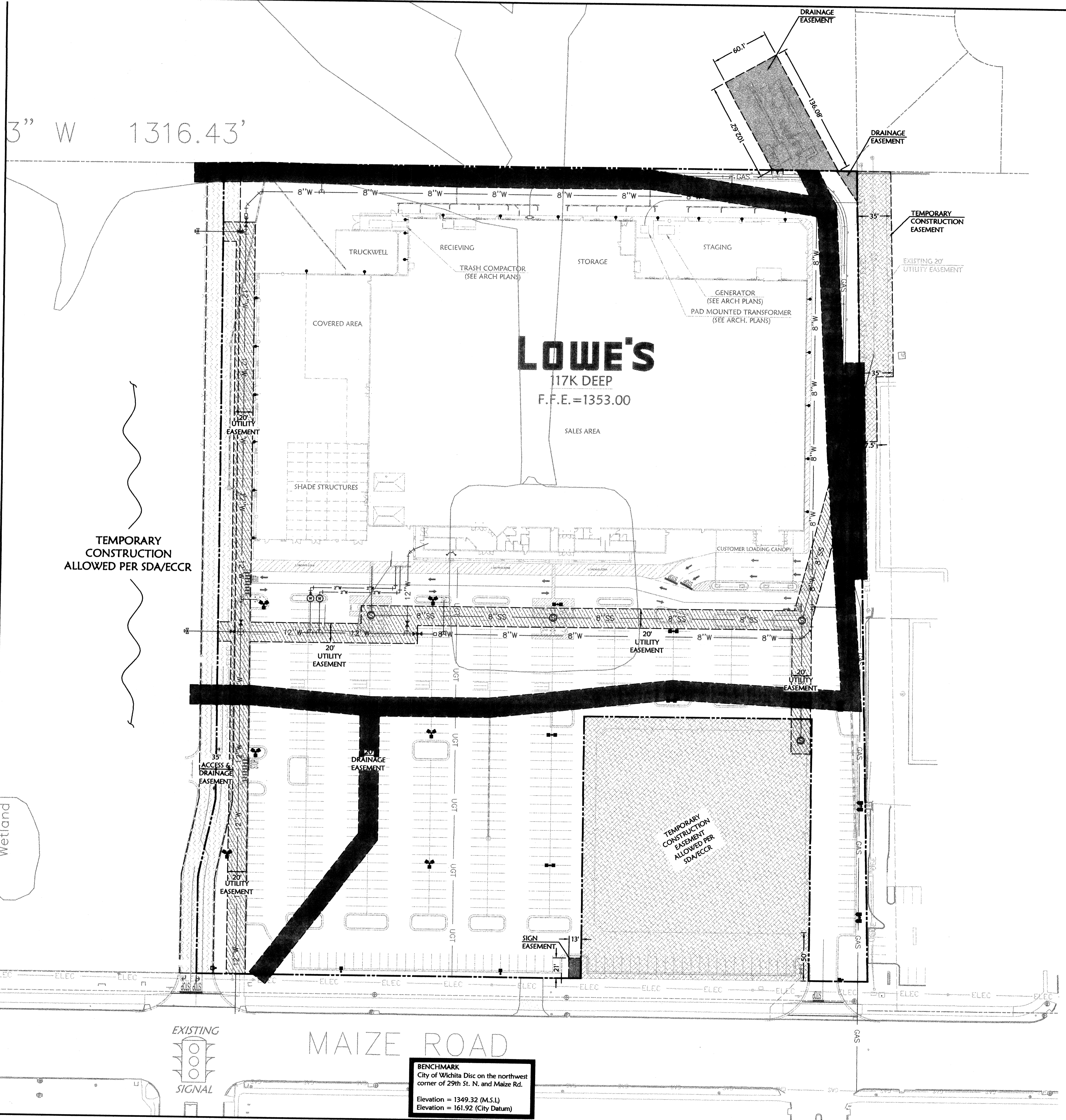

MAIZE ROAD

BENCHMARK
 City of Wichita Disc on the northwest corner of 29th St. N. and Maize Rd.
 Elevation = 1349.32 (M.S.L.)
 Elevation = 161.92 (City Datum)