

DSNR: JPS OPER: SVB SCALE: 1"=20'
 I:/2001/01616/PROFILE/PR142.DGN 3-30-2007 10:14:51 LAST REV: BY:

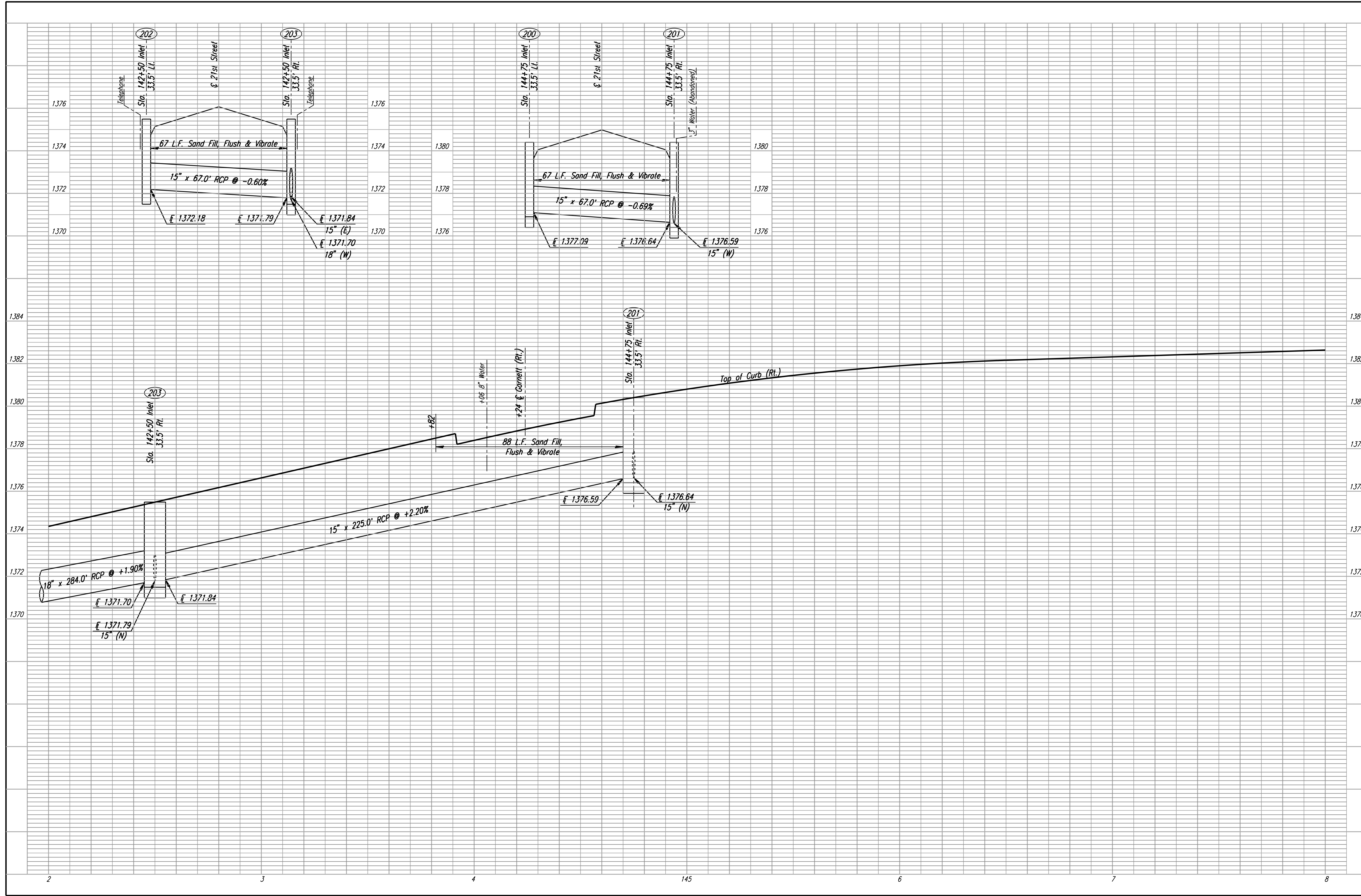

21ST STREET
STORM SEWER PROFILE
 STA. 142+00 TO STA. 148+00
 C.O.W. PROJ. NO. 472-84636

Professional Engineering Consultants, P.A.
 303 S. TOPEKA AVENUE, KANSAS CITY, MO 64108
 816.262.2291 • FAX 816.262.2600

Job No. 01616
 Date August, 2008

Designed by JPS
 Drawn by SVB