

DSNR: JPS OPER: DRP SCALE: 1"=20'
 I:\2001\01616\PLAN\BDR190.DGN 5-12-2004 14:36:46 LAST REV: 5-19-2008 BY: svb

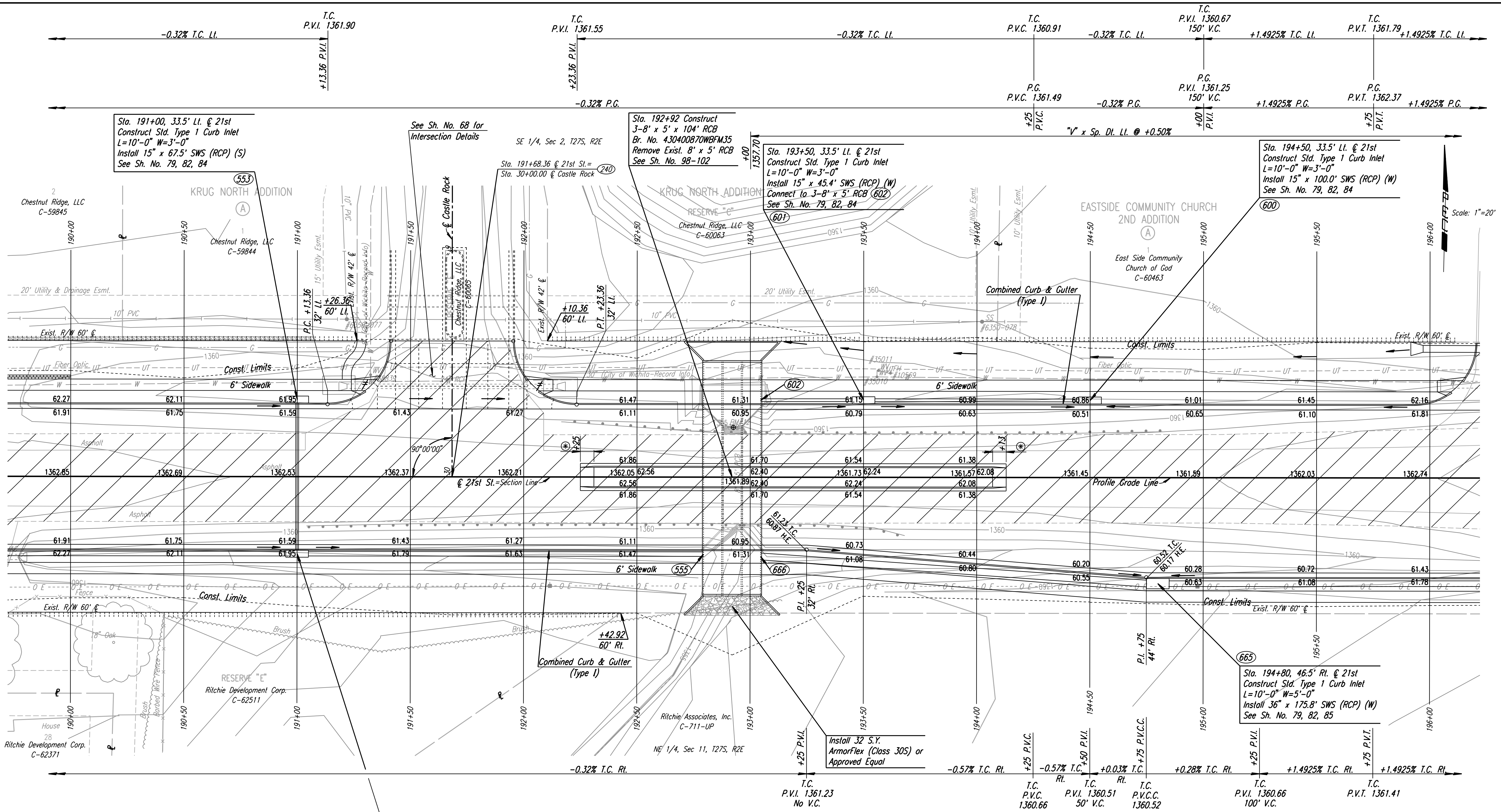

Sta. 191+00, 33.5' Lt. @ 21st
 Construct Std. Type 1 Curb Inlet
 L=10'-0" W=3'-0"
 Install 15" x 67.5' SWS (RCP) (S)
 See Sh. No. 79, 82, 84

See Sh. No. 68 for
 Intersection Details

Sta. 192+92 Construct
 3'-8" x 5' x 104' RCB
 Br. No. 430400870WBFM35
 Remove Exist. 8' x 5' RCB
 See Sh. No. 98-102

Sta. 193+50, 33.5' Lt. @ 21st
 Construct Std. Type 1 Curb Inlet
 L=10'-0" W=3'-0"
 Install 15" x 45.4' SWS (RCP) (W)
 Connect to 3'-8" x 5' RCB (602)
 See Sh. No. 79, 82, 84

Sta. 194+50, 33.5' Lt. @ 21st
 Construct Std. Type 1 Curb Inlet
 L=10'-0" W=3'-0"
 Install 15" x 100.0' SWS (RCP) (W)
 See Sh. No. 79, 82, 84

Sta. 194+80, 46.5' Rt. @ 21st
 Construct Std. Type 1 Curb Inlet
 L=10'-0" W=5'-0"
 Install 36" x 175.8' SWS (RCP) (W)
 See Sh. No. 79, 82, 85

REMOVAL OF EXISTING STRUCTURES *		
STATION	SIDE	ITEM
190+00	Rt.	44 L.F. Fence
191+04	Rt.	265 L.F. Guard Rail
191+68	Lt.	24" RCP with End Sections
192+17	Lt.	266 L.F. Guard Rail
192+92	Cln.	8'x5' RCB

* For Information Only

554
 Sta. 191+00, 34' Rt. @ 21st
 Construct Std. Type 1 Curb Inlet
 L=10'-0" W=4'-0"
 Install 24" x 179.4' SWS (RCP) (E)
 Connect to 3'-8" x 5' RCB (555)
 See Sh. No. 79, 82, 84

BM #12 Chis. "a" Center N. headwall RCB under 21st
 St. N., W of 143rd E.
 21.94' Lt. Sta. 192+92.51 Elev. 1360.68

- UTILITIES
- Gas Kansas Gas Service
 - Power Westar Energy
 - San. Sewer Wichita Water & Sewer Dept.
 - Telephone AT&T
 - Water Wichita Water & Sewer Dept.

- * 6' transition from Combined Curb & Gutter (Type III) to no curb.
- ≠ Wheelchair Ramp w/ Detectable Warning.

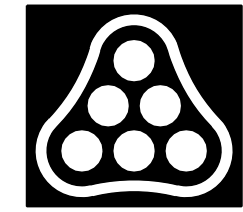

No.	Revision	By	Date
21ST ST. PLAN STA. 190+00 TO STA. 196+00 JAMES L. ARMOUR, P.E. - CITY ENGINEER CITY OF WICHITA PROJECT NO.			
Professional Engineering Consultants, P.A. 303 S. TOPKA • WICHITA, KANSAS 67202 316-262-2691 • FAX 316-262-3003			
Designed by	JPS	Job No.	01616
Drawn by	SVB	Date	August, 2008
			Sht. 24 of 282