

DSNR: JPS OPER: DRP SCALE: 1"=20'
 I:\2001\01616\PLAN\BDR208.DGN 5-12-2004 14:36:46 LAST REV: 5-19-2008 BY: svb

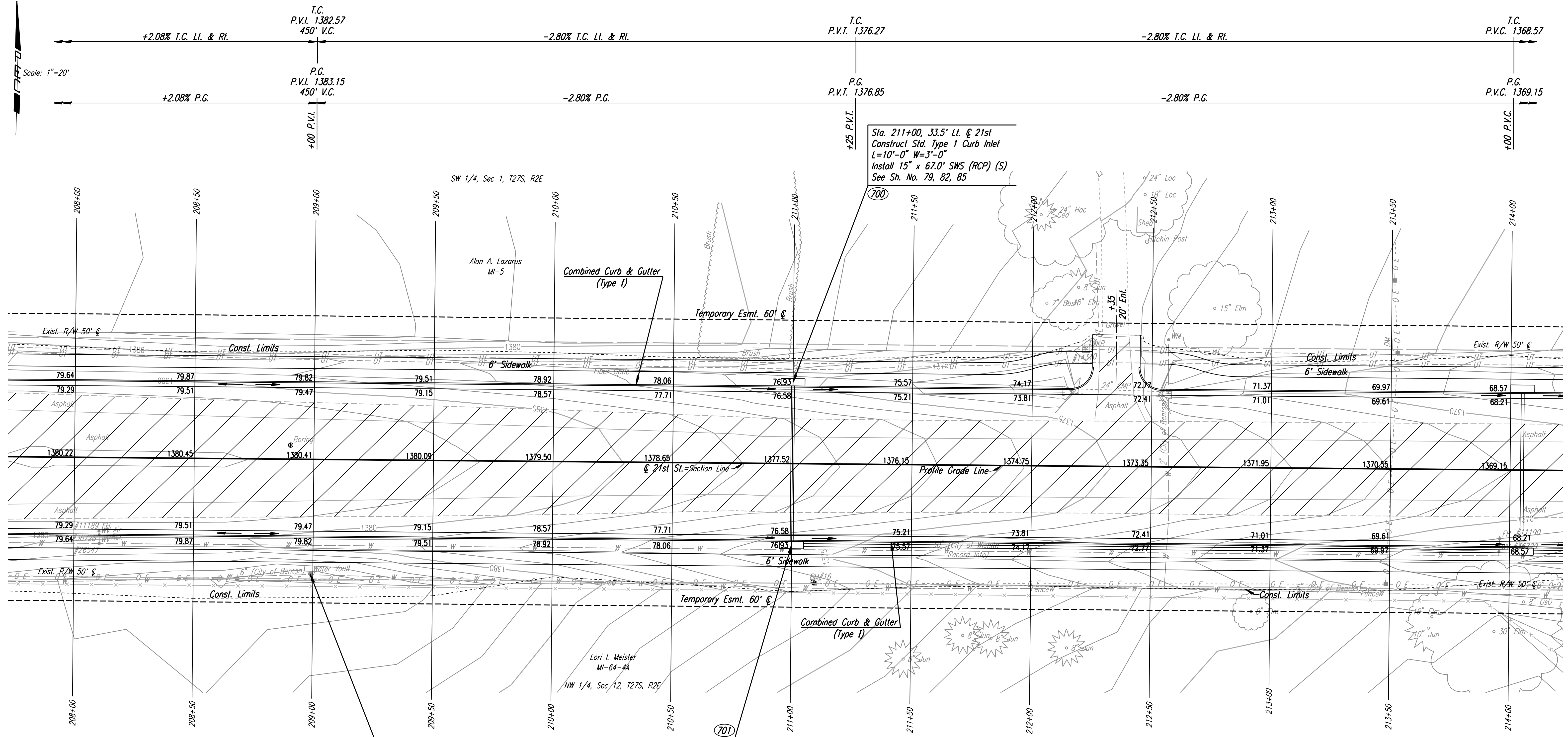

Sta. 211+00, 33.5' Lt. @ 21st
 Construct Std. Type 1 Curb Inlet
 L=10'-0" W=3'-0"
 Install 15" x 67.0' SWS (RCP) (S)
 See Sh. No. 79, 82, 85

Sta. 211+00, 33.5' Rt. @ 21st
 Construct Std. Type 1 Curb Inlet
 L=10'-0" W=3'-0"
 Install 15" x 305.0' SWS (RCP) (E)
 See Sh. No. 79, 82, 85

Sta. 208+99, 48' Rt.
 Adjust Water Vault
 (by City of Benton) from
 Elev. 1385.03 to Elev. 1381.02

REMOVAL OF EXISTING STRUCTURES *		
STATION	SIDE	ITEM
208+00	Rt.	175 L.F. Fence
212+36	Lt.	24" CMP with End Sections

* For Information Only

BM #16 RR spike in N. face Power Pole, S side. 21st
 St. N., 4th Pole E of 143rd E.
 49.52' Rt. Sta. 211+09.18 Elev. 1377.80

UTILITIES
 Power Westar Energy
 Telephone AT&T
 Water Wichita Water & Sewer Dept.
 Water City of Benton

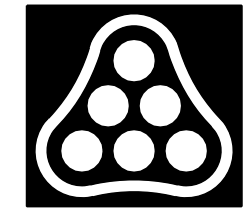

No.	Revision	By	Date
21ST ST. PLAN STA. 208+00 TO STA. 214+00 JAMES L. ARMOUR, P.E. - CITY ENGINEER CITY OF WICHITA PROJECT NO. 472-84636			
Professional Engineering Consultants, P.A. 303 S. TOPEKA • WICHITA, KANSAS 67202 316-262-2691 • FAX 316-262-3003			
Designed by	JPS	Job No.	01616
Drawn by	SVB	Date	August, 2008
			Sht. 30 of 282