

DSNR: JPS OPER: DRP SCALE: 1"=20'  
 I:/2001/01616/PLAN/BDR220.DGN 5-12-2004 14:36:46 LAST REV: 5-20-2008 BY: svb

-0.32% T.C. Lt. & Rt.

-0.32% P.G.

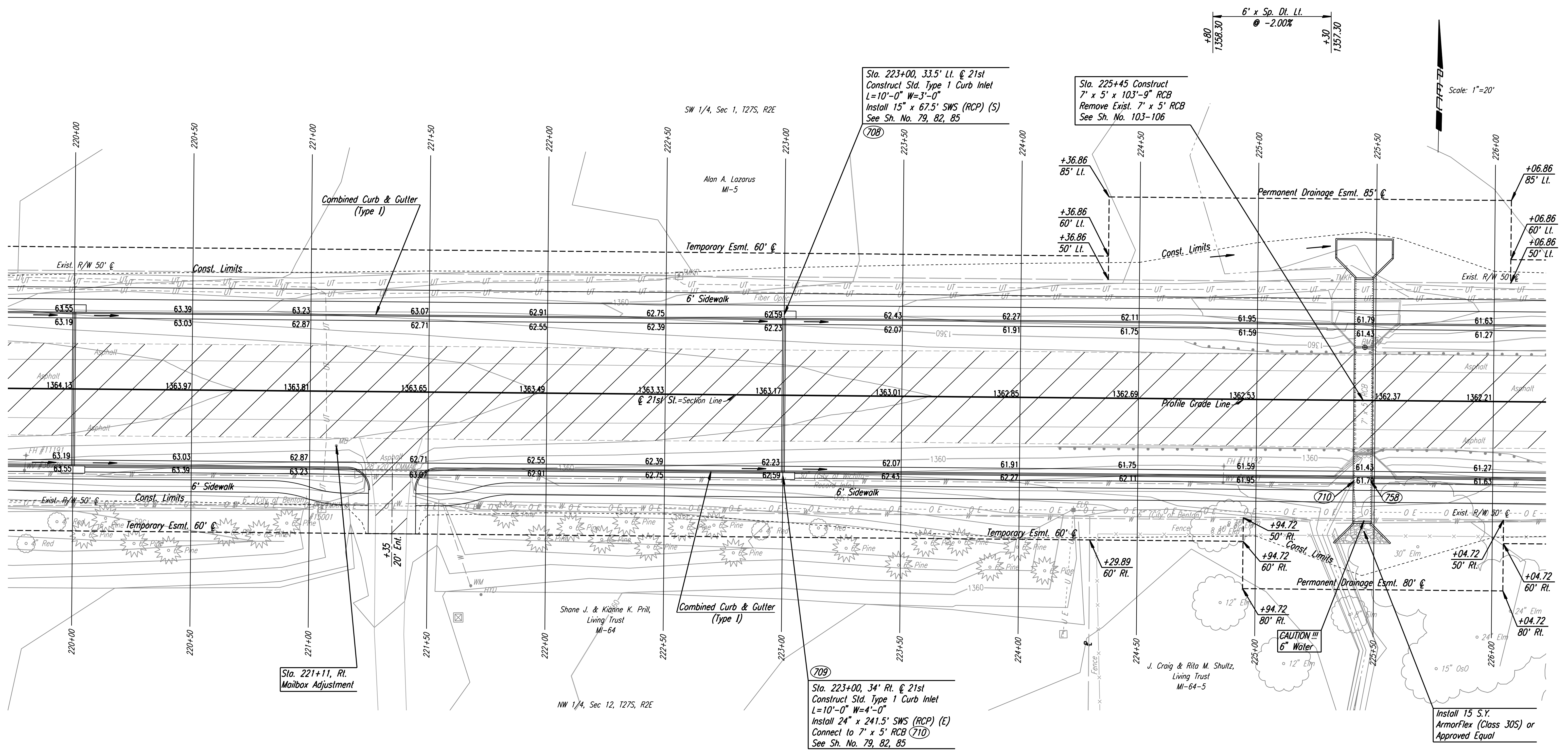

REMOVAL OF EXISTING STRUCTURES *		
STATION	SIDE	ITEM
221+34	Rt.	28"x20" CMMAC w/End Sections
224+16	Rt.	184 L.F. Guard Rail
224+33	Rt.	169 L.F. Fence
224+69	Lt.	131 L.F. Guard Rail
225+45	Cln.	7'x5' RCB

\* For Information Only

**UTILITIES**  
 Power Westar Energy  
 Telephone AT&T  
 Water Wichita Water & Sewer Dept.  
 Water City of Benton

BM #17 Chis. "a" Center N. headwall RCBC under 21st  
 St. N., just W. of S 1/4 cor., Sec. 1-127S-R2E.  
 22.41' Lt. Sta. 225+45.52 Elev. 1361.18

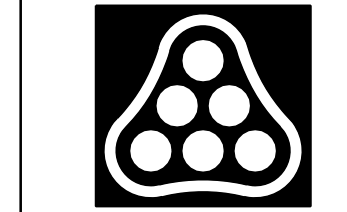

No.	Revision	By	Date
21ST ST. <b>PLAN</b> <b>STA. 220+00 TO STA. 226+00</b> JAMES L. ARMOUR, P.E.-CITY ENGINEER CITY OF WICHITA PROJECT NO. 472-84636 <b>Professional Engineering Consultants, P.A.</b> 303 S. TOPEKA • WICHITA, KANSAS 67202 316-262-2691 • FAX 316-262-3003			
Designed by	JPS	Job No.	01616
Drawn by	SVB	Date	August, 2008
			SH. 34 of 282