

DSNR: JPS OPER: DRP SCALE: 1"=20' 5-12-2004
 I:\2001\01616\PLAN\BDR232.DGN 5-12-2004 14:36:46 LAST REV: 5-20-2008 BY: svb

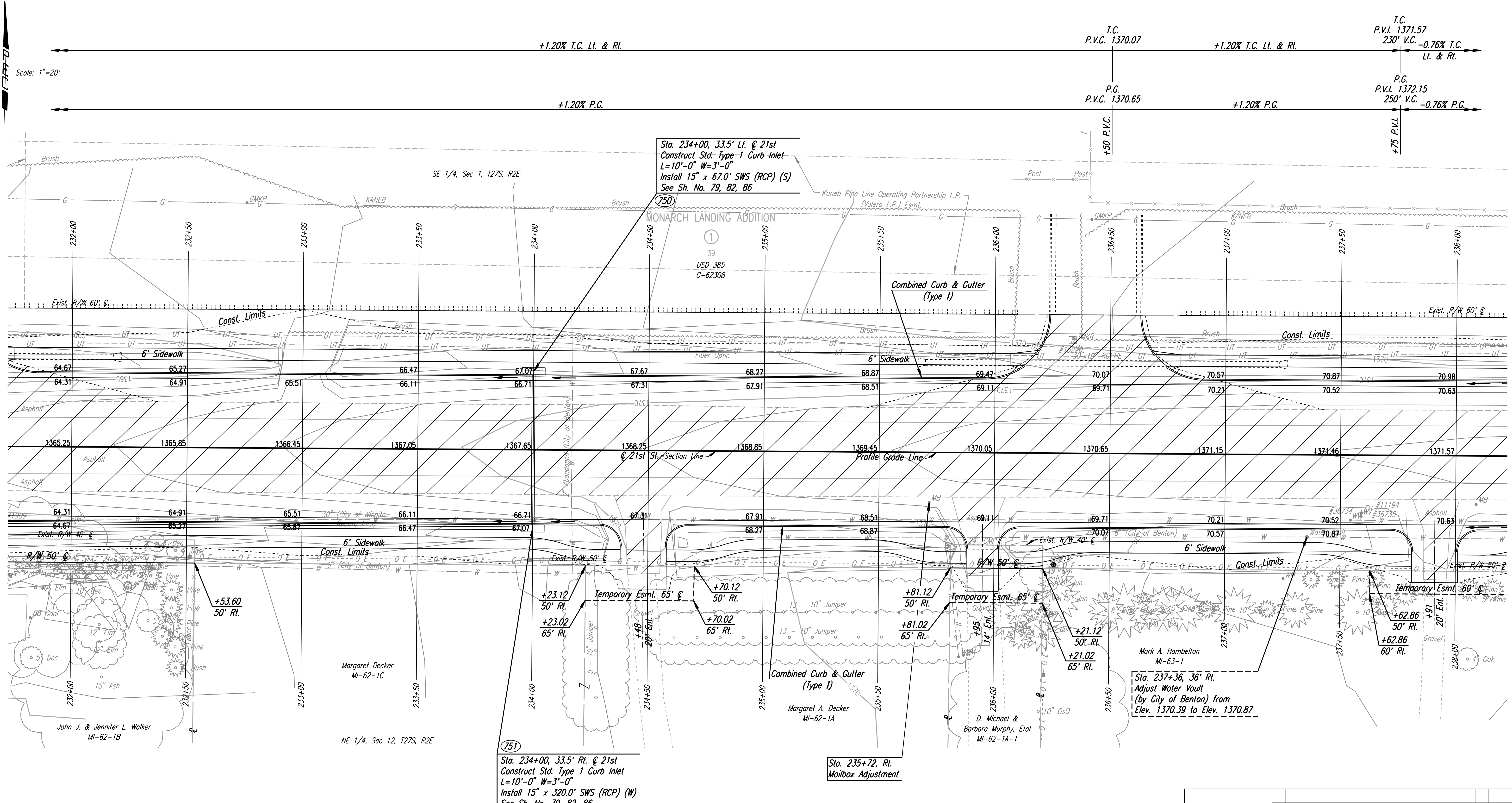

Scale: 1"=20'

+1.20% T.C. Lt. & Rt.

+1.20% P.G.

T.C.
P.V.C. 1370.07

+1.20% T.C. Lt. & Rt.

P.G.
P.V.C. 1370.65

+1.20% P.G.

T.C.
P.V.I. 1371.57
230' V.C. -0.76% T.C.
Lt. & Rt.

P.G.
P.V.I. 1372.15
250' V.C. -0.76% P.G.

Sta. 234+00, 33.5' Lt. @ 21st
Construct Std. Type 1 Curb Inlet
L=10'-0" W=3'-0"
Install 15" x 67.0' SWS (RCP) (S)
See Sh. No. 79, 82, 86

MONARCH LANDING ADDITION

Kaneb Pipe Line Operating Partnership L.P.
(Valero L.P.) Esmt.

Combined Curb & Cutter
(Type 1)

Const. Limits

Const. Limits

6' Sidewalk

6' Sidewalk

6' Sidewalk

6' Sidewalk

6' Sidewalk

Temporary Esmt. 65' @
50' Rt.

Temporary Esmt. 65' @
50' Rt.

Temporary Esmt. 65' @
50' Rt.

Temporary Esmt. 60' @
50' Rt.

Combined Curb & Cutter
(Type 1)

Sta. 237+36, 36' Rt.
Adjust Water Vault
(by City of Benton) from
Elev. 1370.39 to Elev. 1370.87

Sta. 235+72, Rt.
Mailbox Adjustment

(751)
Sta. 234+00, 33.5' Rt. @ 21st
Construct Std. Type 1 Curb Inlet
L=10'-0" W=3'-0"
Install 15" x 320.0' SWS (RCP) (W)
See Sh. No. 79, 82, 86

REMOVAL OF EXISTING STRUCTURES *		
STATION	SIDE	ITEM
235+95	Rt.	24" CMP with End Sections
236+47	Lt.	30"x19" RCPHE w/End Sections

* For Information Only

- UTILITIES
- Gas KANEb
 - Power Westar Energy
 - Telephone AT&T
 - Water Wichita Water & Sewer Dept.
 - Water City of Benton

BM #18 RR spike in N face Power Pole, S side 21st
St. N. just E of Ho. No. 15511 drive.
00' Lt. Sta. 000+00 Elev. 1372.00

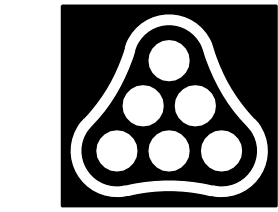

No.	Revision	By	Date
21ST ST.			
PLAN			
STA. 232+00 TO STA. 238+00			
JAMES L. ARMOUR, P.E. - CITY ENGINEER CITY OF WICHITA PROJECT NO. 472-84636			
Professional Engineering Consultants, P.A. 303 S. TOPKA • WICHITA, KANSAS 67202 316-262-2691 • FAX 316-262-3003			
Designed by	JPS	Job No.	01616
Drawn by	SVB	Date	August, 2008
			Sht. 38 of 282