

DSNR: JPS OPER: DRP SCALE: 1"=20' I:\2001\01616\PLAN\SR127TH1.DGN 5-18-2004 8:37:08 LAST REV: 5-20-2008 BY: svb

Scale: 1"=20'

SW 1/4, Sec 2, T27S, R2E  
**HAWTHORNE ADDITION**  
 ⑥  
 2  
 Twenty First Growth, LLC  
 C-58227

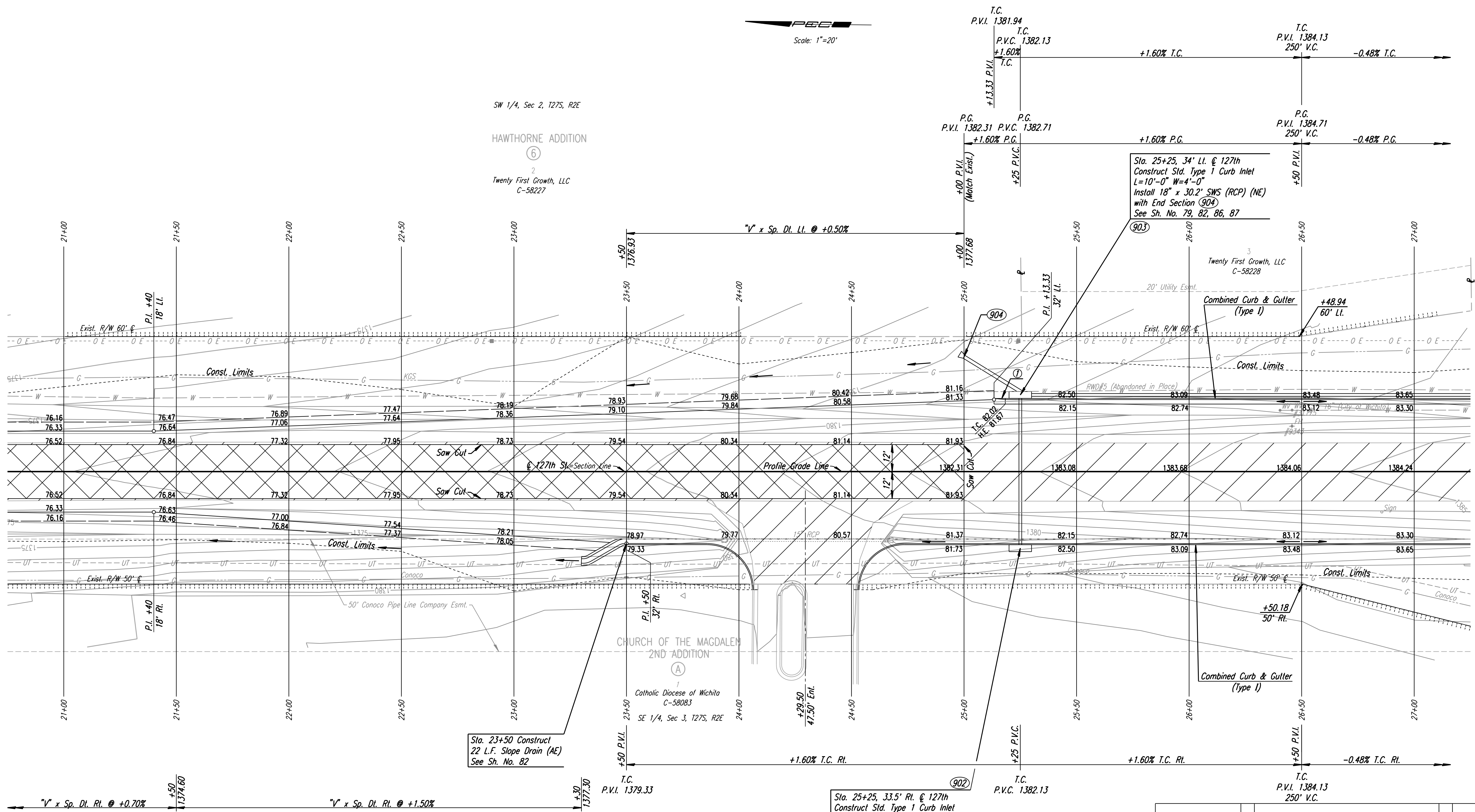

Sta. 25+25, 34' Lt. @ 127th  
 Construct Std. Type 1 Curb Inlet  
 L=10'-0" W=4'-0"  
 Install 18" x 30.2' SWS (RCP) (NE)  
 with End Section 904  
 See Sh. No. 79, 82, 86, 87

Sta. 23+50 Construct  
 22 L.F. Slope Drain (AE)  
 See Sh. No. 82

Sta. 25+25, 33.5' Rt. @ 127th  
 Construct Std. Type 1 Curb Inlet  
 L=10'-0" W=3'-0"  
 Install 15" x 67.5' SWS (RCP) (E)  
 See Sh. No. 79, 82, 86

REMOVAL OF EXISTING STRUCTURES *		
STATION	SIDE	ITEM
24+30	Rt.	15" RCP
26+86	Rt.	Sign

\* For Information Only

- UTILITIES**
- Gas Conoco
  - Gas Kansas Gas Service
  - Power Westor Energy
  - Telephone AT&T
  - Water Wichita Water & Sewer Dept.
  - Water RWD #5

① 5' transition from 6" curb to no curb.

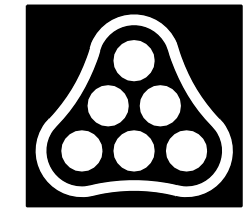

127TH ST. <b>PLAN</b> STA. 21+00 TO STA. 27+00 JAMES L. ARMOUR, P.E. - CITY ENGINEER CITY OF WICHITA PROJECT NO. 472-84636 <b>Professional Engineering Consultants, P.A.</b> 303 S. TOPEKA • WICHITA, KANSAS 67202 316-262-2691 • FAX 316-262-3003	No. _____ By _____ Date _____ Designed by JPS Job No. 01616 Drawn by SVB Date August, 2008
---	--