

GENERAL NOTES

All Signal Heads shall have 12" LED lenses.

All Pedestrian Signal Heads shall have 16" LED lenses.

Placement of Signal Poles, Service/Junction Boxes, Conduit runs and Controller are typical and may be adjusted as directed by the Engineer to facilitate installation.

Utility locations are approximate. The Contractor shall be responsible for locating all underground utilities prior to construction.

* The Contractor shall coordinate with Westar Energy for the exact location of the meter and disconnect box and for the connection of power for the traffic signal installation.

Joint Use luminaires are shown for information only. Luminaire, luminaire arm, and wiring to be provided and installed by Westar Energy. Joint Use lights to be served by overhead power lines.

Contractor is to coordinate Signal Installation so the intersection of 127th St. and 21st St. has a working Signal at all times. Work necessary to maintain a temporary signal during construction shall be included in Lump Sum Price for "Temporary Traffic Signal Installation".

DETECTOR SUMMARY							
CAMERA NO.	DETECTION ZONE	MODE	SIZE (LxW)	PHASE CALLED	PHASE EXTENDED	DELAY/STRETCH TIMER	INITIAL SETTING (SEC.)
1	D4-1	Pulse	6x6	4	4	S	1
1	D4-2	Pulse	6x6	4	4	S	1
1	D4-3	Presence	60x6	4	4	-	-
1	D4-4	Presence	60x6	4	4	-	-
1	D7-1	Presence	60x6	7	7	-	-
2	D2-1	Pulse	6x6	2	2	S	1
2	D2-2	Pulse	6x6	2	2	S	1
2	D2-3	Presence	60x6	2	2	-	-
2	D2-4	Pulse	6x6	2	2	S	1
2	D2-5	Pulse	6x6	2	2	S	1
2	D2-6	Presence	60x6	2	2	-	-
2	D5-1	Presence	60x6	5	5	-	-
3	D3-1	Presence	60x6	3	3	-	-
3	D8-1	Pulse	6x6	8	8	S	1
3	D8-2	Pulse	6x6	8	8	S	1
3	D8-3	Presence	60x6	8	8	-	-
3	D8-4	Presence	60x6	8	8	-	-
4	D1-1	Presence	60x6	1	1	-	-
4	D6-1	Pulse	6x6	6	6	S	1
4	D6-2	Pulse	6x6	6	6	S	1
4	D6-3	Presence	60x6	6	6	-	-
4	D6-4	Pulse	6x6	6	6	S	1
4	D6-5	Pulse	6x6	6	6	S	1
4	D6-6	Presence	60x6	6	6	-	-

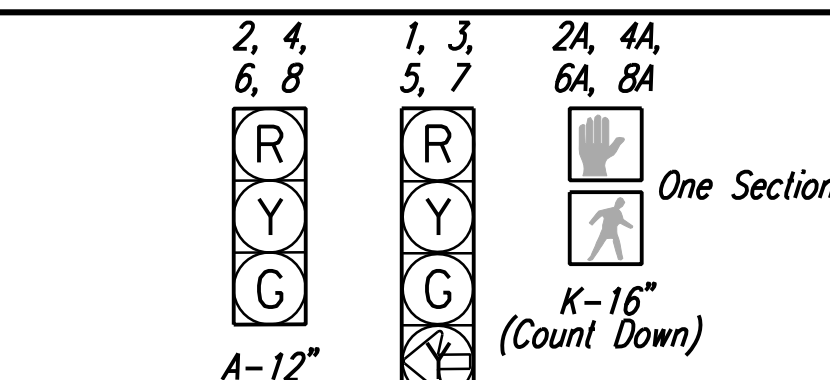

SIGNAL HEAD ARRANGEMENT

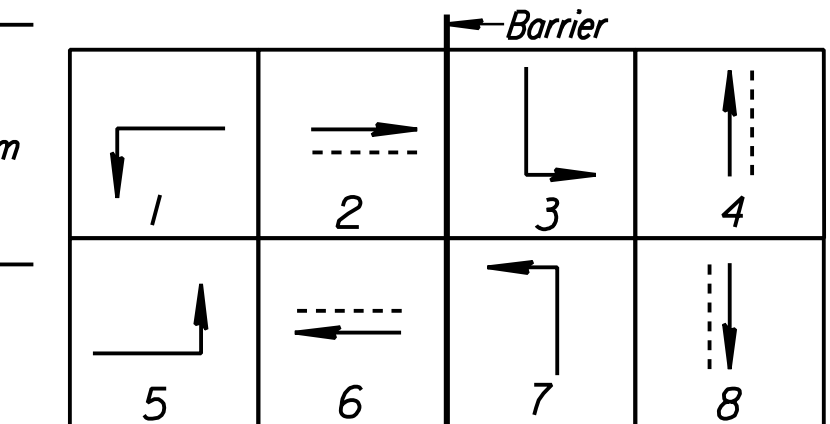

LEGEND

- Traffic Signal Pole with Mast Arm
- Traffic Signal Head
- Traffic Signal Head with Backplate
- Traffic Signal Camera
- Pedestrian Signal Head
- Pedestrian Push Button
- D(Phase)-# Detector Zone
- Controller with pad
- Service Box
- R10-12 Sign
- Rigid Galvanized Conduit (RGC)
- Signal Pole
- Signal Pole Reference Number
- Traffic Signal Camera Reference Number
- Street Name Sign
- Traffic Signal Interconnect

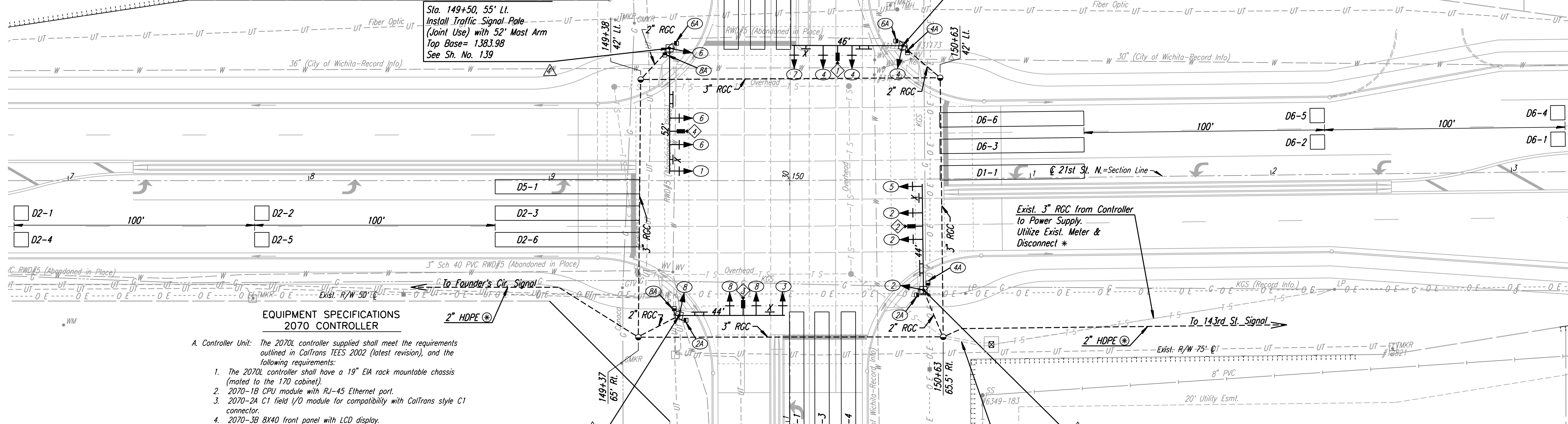

**EQUIPMENT SPECIFICATIONS
2070 CONTROLLER**

- A. Controller Unit: The 2070L controller supplied shall meet the requirements outlined in Caltrans TEES 2002 (latest revision), and the following requirements:
- The 2070L controller shall have a 19" EIA rack mountable chassis (mated to the 170 cabinet).
 - 2070-1B CPU module with RJ-45 Ethernet port.
 - 2070-2A C1 field I/O module for compatibility with Caltrans style C1 connector.
 - 2070-3B 8X40 front panel with LCD display.
 - 2070-4A 10 amp power supply.
 - 2070-7A asynchronous serial communications module (RS-232).
 - Any unused slot position shall have a cover plate.
- B. Conflict Monitor: The Conflict Monitor supplied shall be 2010 ECL conflict monitor.

FUNCTION TABLE

FUNCTION	PHASE							
	1	2	3	4	5	6	7	8
VEHICLE RECALL	-	X	-	-	-	X	-	-
PED RECALL	-	-	-	-	-	-	-	-
RED LOCK	-	-	-	-	-	-	-	-
YELLOW LOCK	-	-	-	X	-	-	-	X
PERMIT	X	X	X	X	X	X	X	X
PED PHASES	-	X	-	X	-	X	-	X
LEAD PHASES	X	-	X	-	X	-	X	-
DOUBLE ENTRY	-	X	-	X	-	X	-	X
SEQUENTIAL TIMING	-	-	-	-	-	-	-	-
START-UP YELLOW	-	-	X	-	-	-	-	X
OVERLAP A	-	-	-	-	-	-	-	-
OVERLAP B	-	-	-	-	-	-	-	-
OVERLAP C	-	-	-	-	-	-	-	-
OVERLAP D	-	-	-	-	-	-	-	-
EXCLUSIVE	-	-	-	-	-	-	-	-
SIMULTANEOUS GAP	-	-	-	-	-	-	-	-

PHASE TIMING

FUNCTION	PHASE							
	1	2	3	4	5	6	7	8
MAX. I	30	80	30	45	30	80	30	45
MAX. II/HFDW	30	80	30	45	30	80	30	45
WALK	-	7	-	7	-	7	-	7
FLASH DW	-	20	-	20	-	20	-	20
MAX. INITIAL	6	8	6	8	6	8	6	8
MIN. GREEN	4	8	4	8	4	8	4	8
T B R	-	-	-	-	-	-	-	-
T T R	-	-	-	-	-	-	-	-
OBSERVE GAP	-	-	-	-	-	-	-	-
PASSAGE	1	2	1	1	1	2	1	1
MIN. GAP	1	1	1	1	1	1	1	1
ADDED ACTUATION	1	2	1	2	1	2	1	2
YELLOW	3.2	3.9	3.2	3.9	3.2	3.9	3.2	3.9
RED CLEAR	1	1.5	1	1.5	1	1.5	1	1.5
RED REVERT	-	-	-	-	-	-	-	-
WALK II	-	-	-	-	-	-	-	-

Sta. 149+54, 56" Rt. Install Traffic Signal Pole with 44" Mast Arm Top Base= 1383.93 See Sh. No. 139

Sta. 150+55, 46" Rt. Install Traffic Signal Pole with 44" Mast Arm Top Base= 1383.90 See Sh. No. 139

Existing Pod, Cabinet and 2-3" RGC to Remain

Note: The contractor shall stockpile the existing traffic signal equipment at the job site for removal by others. Salvageable equipment (poles, cameras, etc.) shall remain the property of the City of Wichita. Contact the Signal Supervisor (268-4033) prior to removal. This work shall be Subsidiary to the Lump Sum Bid Item for Traffic Signals.

DSNR: WDH OPER: SVB SCALE: 20
 I:\2001\01616\SIGNALS\01616-SIGNAL 127TH.DGN 3-6-2007 16:00:00 LAST REV: 5-22-2008 BY: svb

21ST ST. & 127TH ST.

TRAFFIC SIGNAL PLAN

JAMES L. ARMOUR, P.E.-CITY ENGINEER
 CITY OF WICHITA PROJECT NO. 472-84636

Professional Engineering Consultants, P.A.
 303 S. TOPEKA • WICHITA, KANSAS 67202
 316-262-2691 • FAX 316-262-3003

Designed by WDH Job No. 01616
 Drawn by SVB Date August, 2008 SH. 133 of 282