

DSNR: WDH OPER: SVB SCALE: 1"=40' i:\2001\01616\Traffic Control\01616-T.C. Stage 2A 143rd.DCN 8-22-2007 14:36:46 LAST REV: 5-23-2008 BY: svb

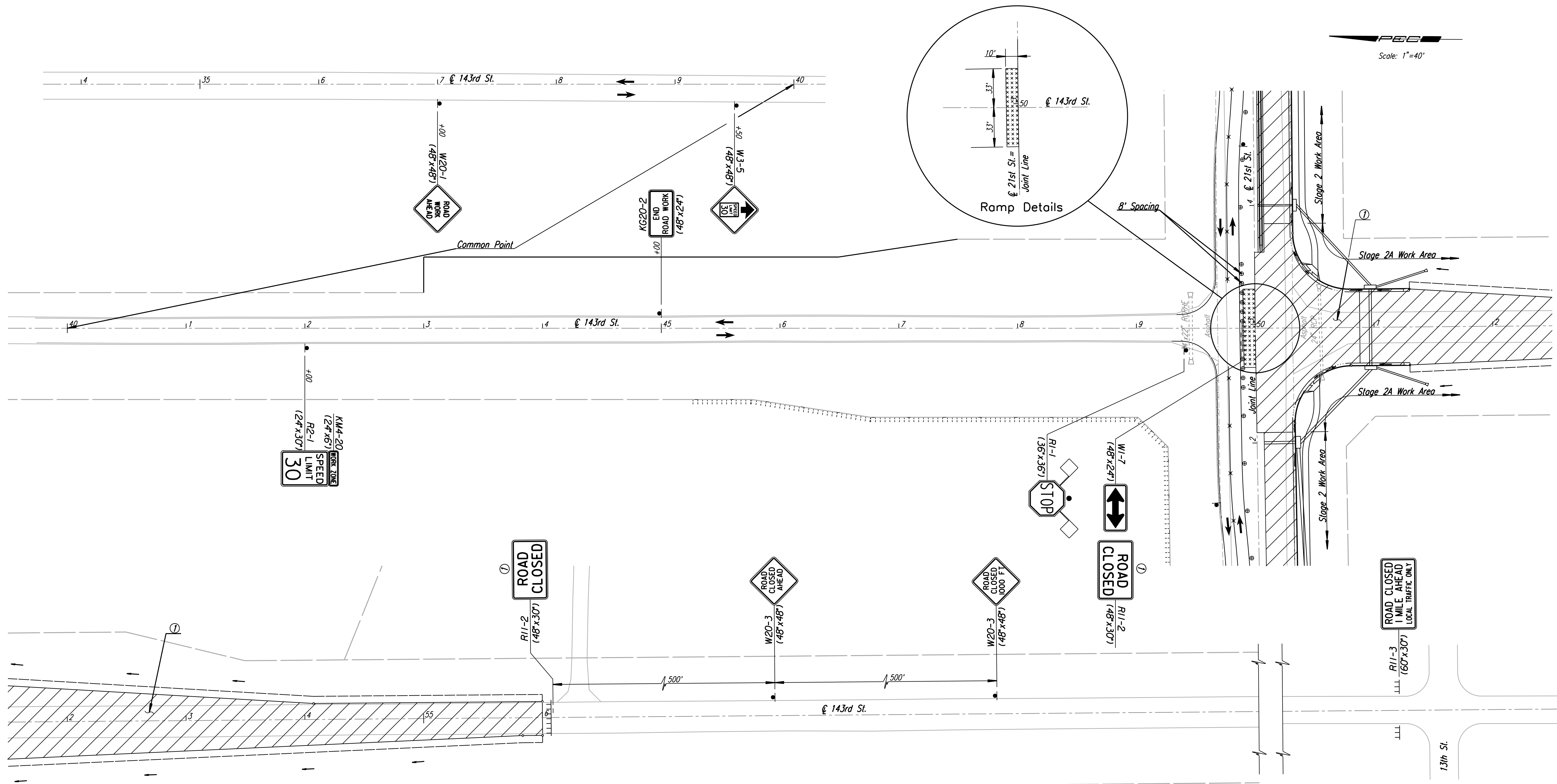

Scale: 1"=40'

Note: Utilities are not shown on Traffic Control Plans. The Contractor is responsible for verification as to type and location of underground utilities as may be necessary to avoid damage thereto. The Contractor is responsible for repairing any damage to underground utilities.

① Contractor is to coordinate construction so 143rd St. is not closed at the same time 159th St. is closed.

- LEGEND**
- Channelizing Device at 80' Spacing unless otherwise Noted.
 - Tubular Marker at 40' Spacing
 - Type III Barricade
 - Work Area (New Pavement)
 - Temporary bituminous pavement to ramp from new pavement to existing pavement. Remove existing pavement and place wedge pavement prior to shifting traffic. Pavement to be 6" plant mix bituminous mixture.
 - Direction of Traffic

No.	Revision	By	Date
143RD ST.			
TRAFFIC CONTROL PLAN			
STAGE 2A - STA. 34+00 TO STA. 56+00			
JAMES L. ARMOUR, P.E. - CITY ENGINEER CITY OF WICHITA PROJECT NO. 472-84636			
Professional Engineering Consultants, P.A. 303 S. TOPEKA • WICHITA, KANSAS 67202 316-262-2691 • FAX 316-262-3003			
Designed by	WDH	Job No.	01616
Drawn by	SVB	Date	August, 2008
			Sht. 169 of 282