

DSNR: WDH OPER: SVB SCALE: 1"=40' 8-22-2007 14:36:46 LAST REV: 5-23-2008 BY: svb
 I:/2001/01616/Traffic Control/01616-T.C. Stage 2A 159th.DCN

Scale: 1"=40'

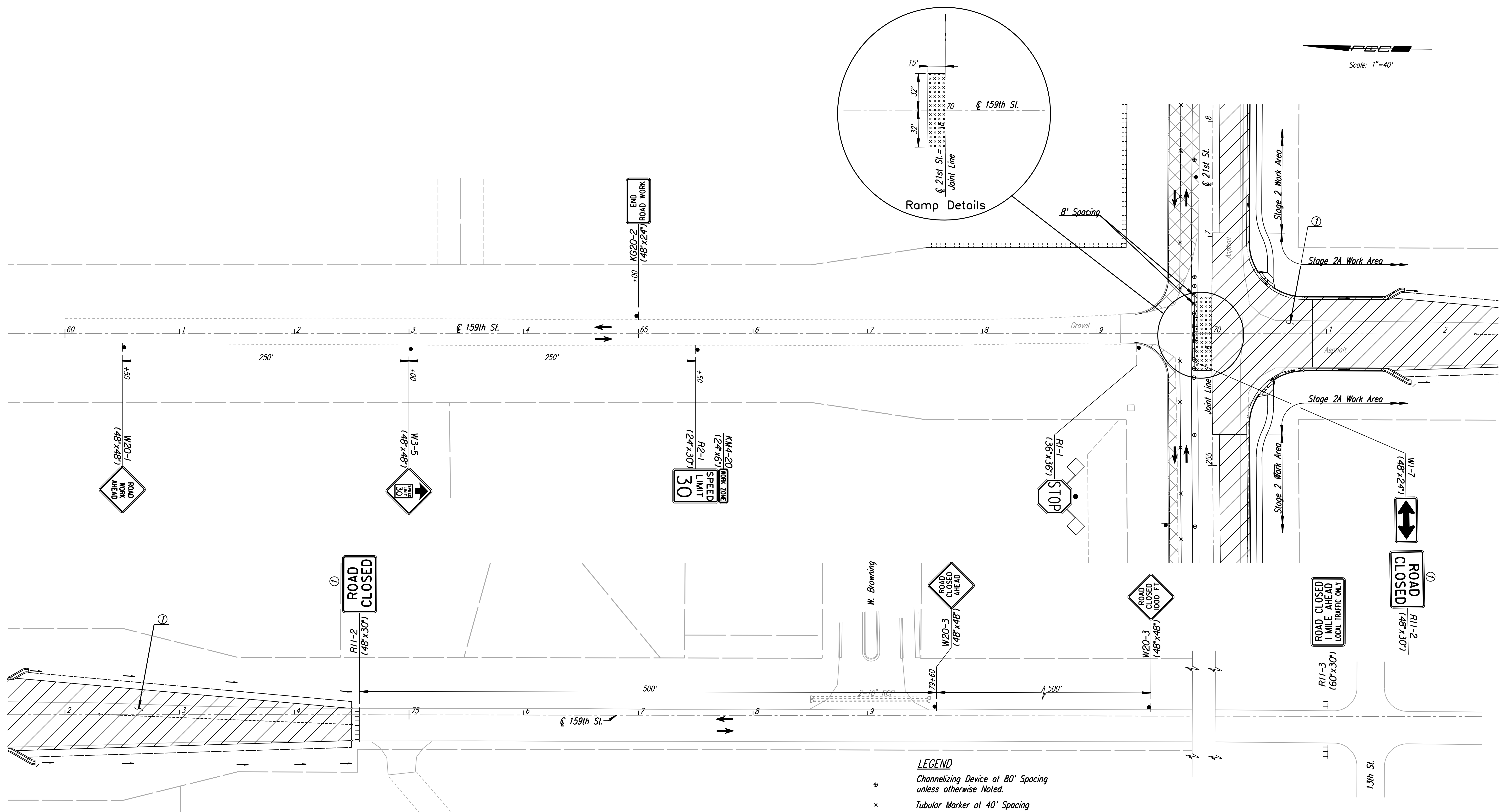

Note: Utilities are not shown on Traffic Control Plans. The Contractor is responsible for verification as to type and location of underground utilities as may be necessary to avoid damage thereto. The Contractor is responsible for repairing any damage to underground utilities.

① Contractor is to coordinate construction so 159th St. is not closed at the same time 143rd St. is closed.

- LEGEND**
- ⊙ Channelizing Device at 80' Spacing unless otherwise Noted.
 - × Tubular Marker at 40' Spacing
 - ▬ Type III Barricade
 - ▨ Work Area (New Pavement)
 - ▩ Temporary Pavement for Detours
 - ▨ Temporary bituminous pavement to ramp from new pavement to existing pavement. Remove existing pavement and place wedge pavement prior to shifting traffic. Pavement to be 6" plant mix bituminous mixture.
 - Direction of Traffic

No.	Revision	By	Date
159TH ST.			
TRAFFIC CONTROL PLAN			
STAGE 2A - STA. 60+00 TO STA. 79+00			
JAMES L. ARMOUR, P.E. - CITY ENGINEER CITY OF WICHITA PROJECT NO. 472-84636			
Professional Engineering Consultants, P.A. 303 S. TOPKA • WICHITA, KANSAS 67202 316-262-2691 • FAX 316-262-3003			
Designed by	WDH	Job No.	01616
Drawn by	SVB	Date	August, 2008
			SH. 170 of 282