

DSNR: WDH OPER: SVB SCALE: 1"=40'  
 I:/2001/01616/Traffic Control/01616-T.C. Stage 2B 159th.DGN 8-22-2007 14:36:46 LAST REV: 5-23-2008 BY: svb

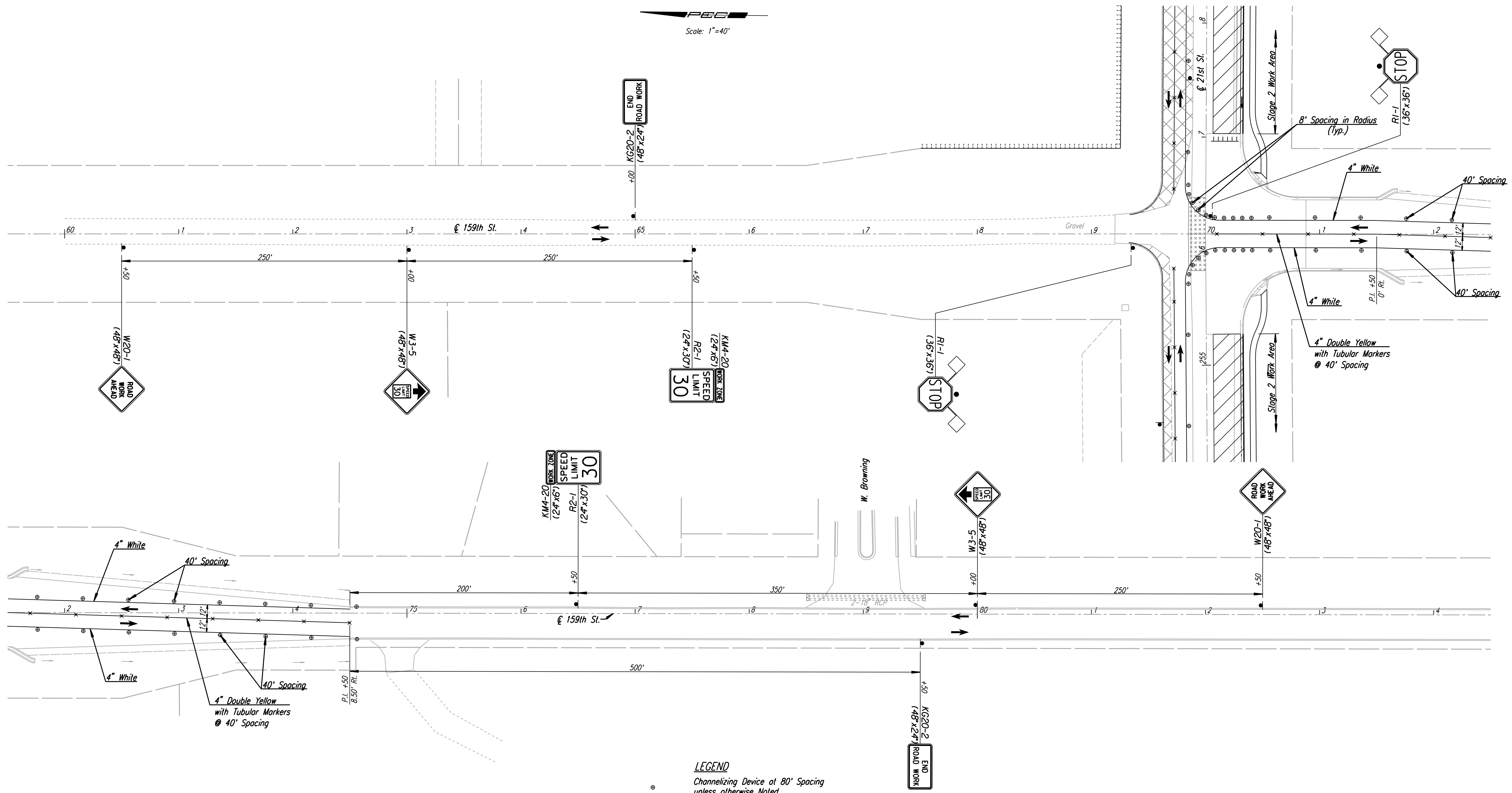

Note: Utilities are not shown on Traffic Control Plans. The Contractor is responsible for verification as to type and location of underground utilities as may be necessary to avoid damage thereto. The Contractor is responsible for repairing any damage to underground utilities.

- LEGEND**
- ⊕ Channelizing Device at 80' Spacing unless otherwise Noted.
  - × Tubular Marker at 40' Spacing
  - ▬ Type III Barricade
  - Red Type "B" High Intensity Warning Light
  - ▨ Work Area (New Pavement)
  - ⊠ Temporary Bituminous Pavement to Ramp from New Pavement to Existing Pavement.
  - Direction of Traffic

|  |          |         |                 |
|--|----------|---------|-----------------|
| No.  | Revision | By      | Date            |
| 159TH ST.  |          |         |                 |
| <b>TRAFFIC CONTROL PLAN</b>  |          |         |                 |
| STAGE 2B - STA. 60+00 TO STA. 84+00  |          |         |                 |
| JAMES L. ARMOUR, P.E. - CITY ENGINEER<br>CITY OF WICHITA PROJECT NO. 472-84636 |          |         |                 |
| <b>Professional Engineering Consultants, P.A.</b>                              |          |         |                 |
| 303 S. TOPEKA • WICHITA, KANSAS 67202<br>316-262-2691 • FAX 316-262-3003       |          |         |                 |
| Designed by  | WDH      | Job No. | 01616           |
| Drawn by   | SVB      | Date    | August, 2008    |
|  |          |         | Sht. 173 of 282 |