

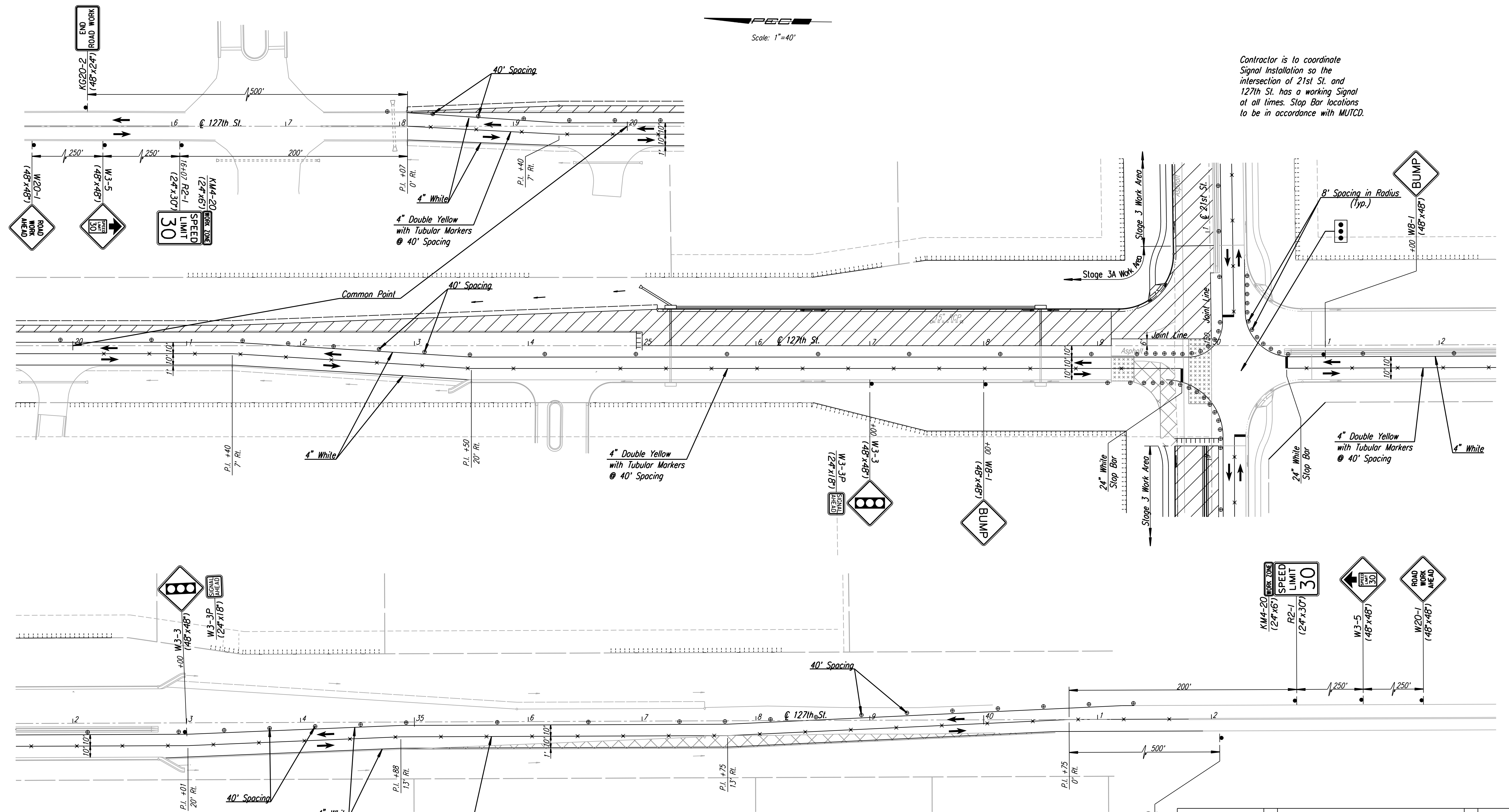







DSNR: WDH OPER: SVB SCALE: 1"=40' 10-3-2007 14:36:46 LAST REV: 5-23-2008 BY: svb
 I:/2001/01616/Traffic Control/01616-T.C. Stage 3A 127th.DCN

 Scale: 1"=40'

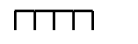
Contractor is to coordinate
 Signal installation so the
 intersection of 21st St. and
 127th St. has a working Signal
 at all times. Stop Bar locations
 to be in accordance with MUTCD.



Note: Utilities are not shown on Traffic Control Plans. The Contractor is responsible for verification as to type and location of underground utilities as may be necessary to avoid damage thereto. The Contractor is responsible for repairing any damage to underground utilities.

- LEGEND**
-  Channelizing Device at 80' Spacing unless otherwise Noted.
 -  Tubular Marker at 40' Spacing
 -  Type III Barricade
 -  Work Area (New Pavement)
 -  Temporary Pavement for Detours
 -  Temporary Bituminous Pavement to Ramp from New Pavement to Existing Pavement.
 -  Direction of Traffic
 -  Maintain Signalized Intersection

No.		Revision		By		Date	
127TH ST. TRAFFIC CONTROL PLAN STAGE 3A - STA. 16+00 TO STA. 42+00 JAMES L. ARMOUR, P.E. - CITY ENGINEER CITY OF WICHITA PROJECT NO. 472-84636 Professional Engineering Consultants, P.A. 303 S. TOPEKA • WICHITA, KANSAS 67202 316-262-2691 • FAX 316-262-3003							
Designed by	WDH	Job No.	01616	Sht. 180 of 282			
Drawn by	SVB	Date	August, 2008				