

GENERAL NOTES

MACHINE PREPARATION (1"): This item shall consist of preparing the deck for a Silica Fume Overlay, by removing the concrete from the roadway surface of the bridge deck to a depth of 1". See KDOT Specifications.

PARTIAL DEPTH PATCHING: This item shall consist of removing unsound concrete and bituminous patches from the bridge deck, cleaning reinforcing bars, filling the removed patched areas with concrete and preparing the entire area for Silica Fume Overlay. Quantities shown are an estimate of the areas involved. The exact areas shall be determined by tapping, before, during and after chipping operation to assure that all unsound concrete has been removed. See KDOT Specifications.

FULL DEPTH PATCHING: Forms shall be provided to enable the placement of concrete in areas of full depth removal of the bridge slab. The forms may be suspended from existing reinforcing bars by wire ties or a method approved by the Engineer may be used. See KDOT Specifications for method of measurement and basis of payment.

REINFORCING IN BRIDGE DECK: Care should be exercised to prevent cutting, stretching or damaging exposed reinforcing steel. Extreme care should be exercised to avoid breaking the bond between the reinforcing steel and concrete where bars are partially exposed yet remain anchored in sound concrete. Reinforcing steel damaged, cut or deteriorated shall be replaced as directed by the Engineer. See table on this sheet for minimum splice length required. Replacement of bars damaged by the Contractor shall be subsidiary to "Area Prepared for Patching".

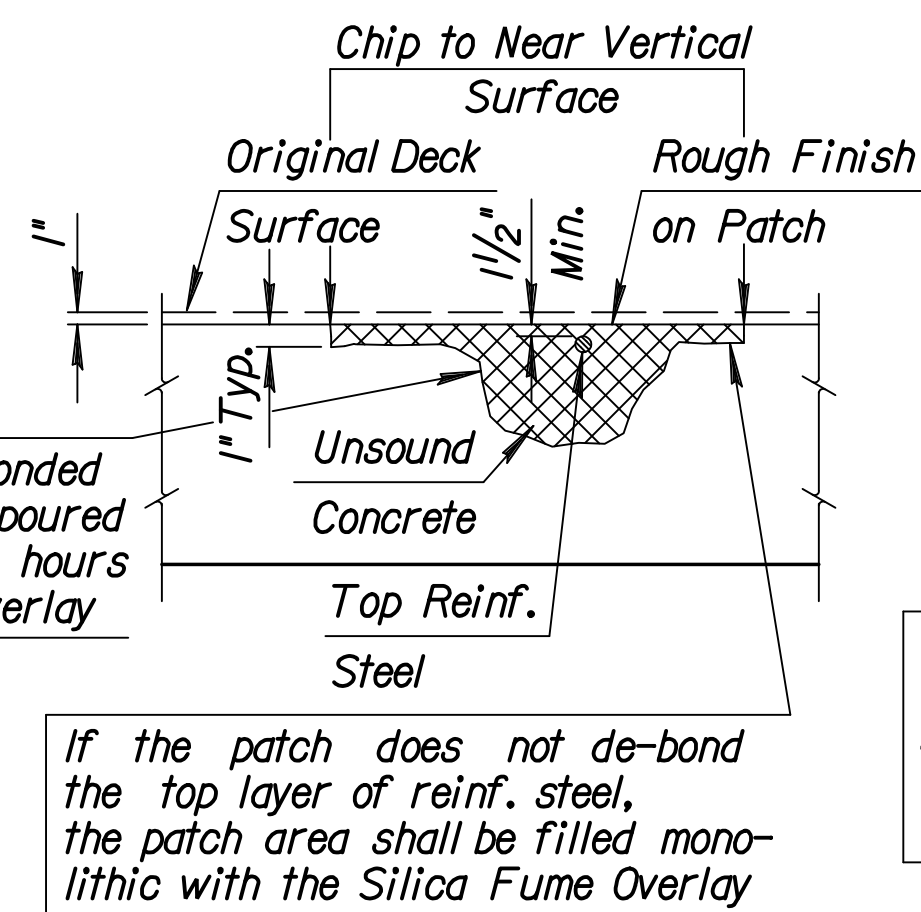
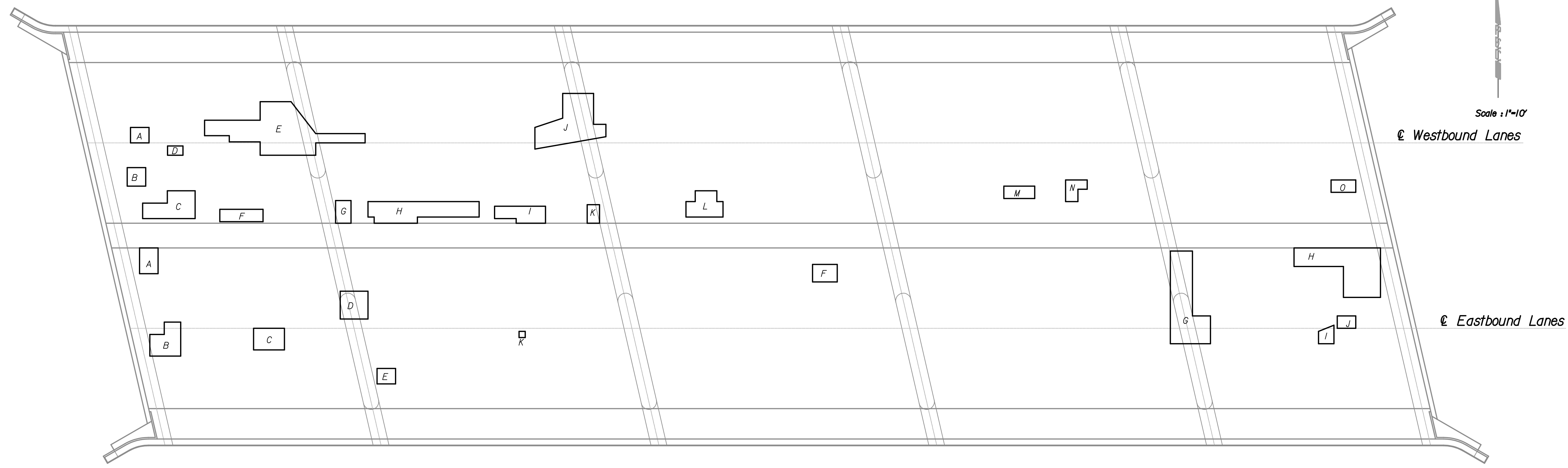

PARTIAL DEPTH DETAIL

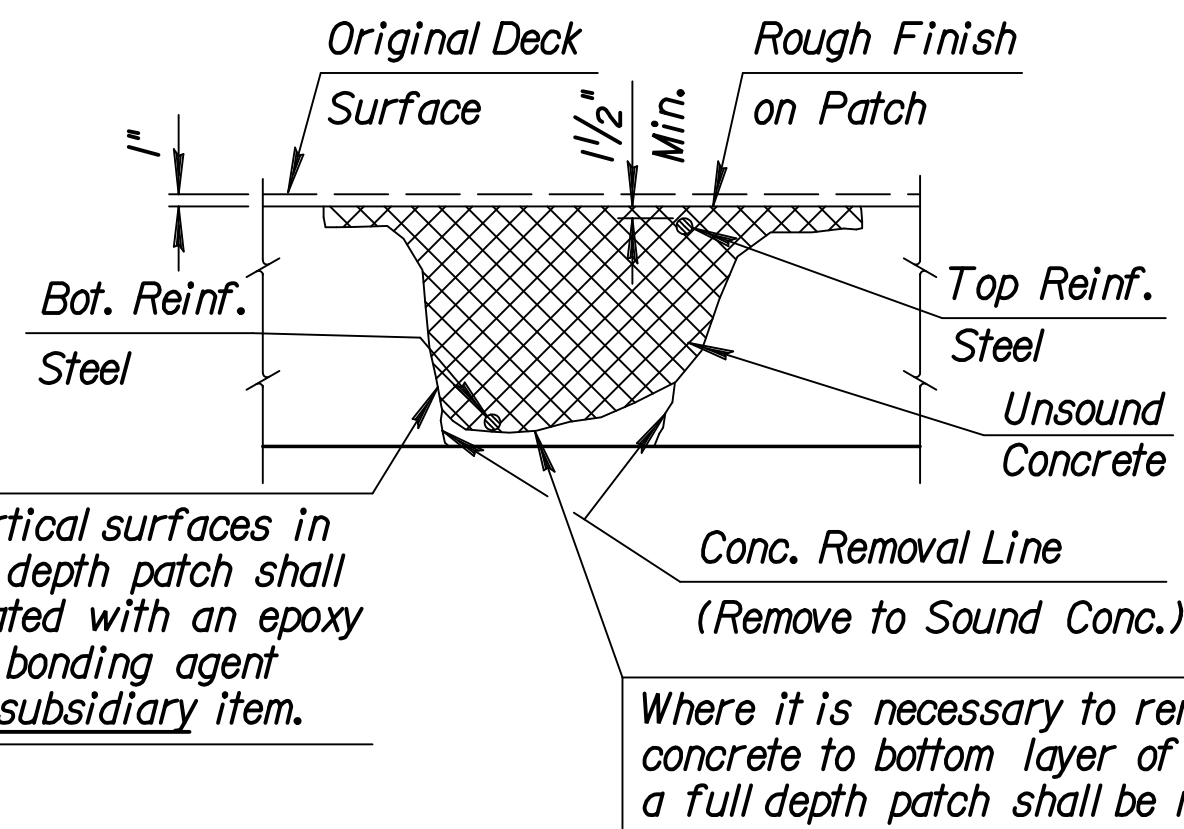

FULL-DEPTH DETAIL

All patch areas which have debonded reinf. shall be pre-poured. Pre-poured patches shall cure a min. of 24 hours prior to placing Silica Fume Overlay

If the patch does not de-bond the top layer of reinf. steel, the patch area shall be filled monolithic with the Silica Fume Overlay

All vertical surfaces in a full depth patch shall be coated with an epoxy resin bonding agent as a subsidiary item.

Where it is necessary to remove concrete to bottom layer of reinf. a full depth patch shall be required.

DECK PATCHING DETAILS

DECK DELAMINATION AREA			
Eastbound		Westbound	
Location	Area (S.F.)	Location	Area (S.F.)
A	12.5	A	7.5
B	22.8	B	9.0
C	17.5	C	30.3
D	20.3	D	3.8
E	7.5	E	107.2
F	11.3	F	14.0
G	66.9	G	9.2
H	72.0	H	52.0
I	6.3	I	20.1
J	6.0	J	60.6
K	1.0	K	6.0
		L	21.1
		M	10.0
		N	9.3
		O	8.0
Total	244.1	Total	368.1
Grand Total			612.2

MIN. REBAR SPLICE LENGTHS	
Bar Size	Min. Spl. Len.
#4	12"
#5	13"
#6	16"
#7	20"
#8	26"
#9	33"
#10	42"
#11	52"

SUMMARY OF QUANTITIES *				
ITEM	UNITS	E. B.	W. B.	TOTAL
Machine Preparation (1")	S.Y.	530	530	1060
Partial Depth Patching	S.Y.	23.1	34.8	57.9
Full Depth Patching	S.Y.	4.1	6.1	10.2
Silica Fume Overlay (1.50")	S.Y.	879.6	787.0	1666.6
Reinforcing Steel (Repair)(Grade 60)	Lbs.	104	157	261

* For Information Only

No.	Revisions	By	Date
CITY OF WICHITA BR. NO. 430400876500010 STA. 17+62.50 DECK DELAMINATION SURVEY 21ST STREET OVER LAR PROJECT NO. 472-84748 SEDGWICK COUNTY			
 Professional Engineering Consultants, P.A. 303 S. TOPEKA • WICHITA, KANSAS 67202 316-262-2691 • FAX 316-262-3003			
Designed by	M.S.N.	Checked by	R.A.S.
Drawn by	W.L.L.	Date	Feb. 2007 Job No. 06009