

STATE	PROJECT NO.	YEAR	SHEET NO.	TOTAL SHEETS
KANSAS	87 N-0360-01	2008	1	43

BH N036 (001)

BRIDGE  
CONCRETE PAVEMENT  
SODDING

**INDEX OF SHEETS**

- 1 Title Sheet
- 2 General Notes
- 3 Summary of Quantities
- 4 Existing Bridge Layout
- 5 Proposed Bridge Layout
- 6 Special Concrete West Approach Pavement
- 7 Special Concrete East Approach Pavement
- 8 Concrete Safety Barrier (Special) (AE) (Entrance End)
- 9 Concrete Safety Barrier (Special) (AE) (Exit End)
- 10 Miscellaneous Details for Concrete Bridge Approach Pavement
- 11 Bridge Approach Slab Exp. Jt. Details/Br. Appr. Slab Ftg.
- 12 Deck Delamination Survey
- 13 Proposed Typical Bridge Section
- 14 Existing Abutment Details
- 15 Existing Pier Details
- 16 Proposed Abutment Details
- 17 Proposed Pier Details
- 18 Pier Widening Details Pier #1 and Pier #4
- 19 Pier Widening Details Pier #2 and Pier #3
- 20 Proposed Superstructure Layout (Bottom Reinforcing)
- 21 Proposed Superstructure Layout (Top Reinforcing)
- 22 Proposed Superstructure Details
- 23 32" Kansas Corral Rail Detail R C Haunched Slab (Without Curb)
- 24 Bill of Reinforcing and Bending Diagrams
- 25 Handrail Details
- 26 Proposed Riprap
- 27 Bridge Excavation (BR100)
- 28 Supports and Spacers for Reinforcing Steel (BR120)
- 29 Electrical Layout
- 30 Pavement Marking Plan
- 31 Traffic Handling and Summary of Traffic Control Devices
- 32 General Traffic Control
- 33 Traffic Control Plan
- 34 Detour Plan
- 35 Channelizing Devices
- 36 Typical Traffic Control Road Closures
- 37 Permanent Seeding Summary of Seeding Quantities
- 38 Temporary Erosion & Pollution Control
- 39-43 Erosion Control - BMP's

STATE OF KANSAS  
**DEPARTMENT OF TRANSPORTATION**

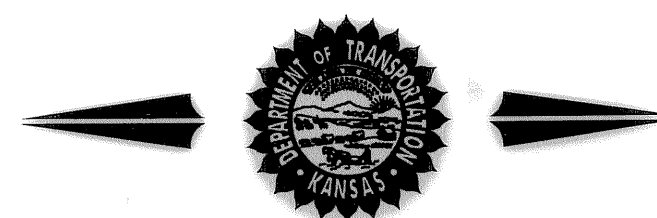

**PLAN AND PROFILE OF PROPOSED  
25TH STREET NORTH BRIDGE REHABILITATION  
OVER LITTLE ARKANSAS RIVER**

FEDERAL AID PROJECT

CITY OF WICHITA  
SEDGWICK COUNTY

POPULATION 344,631

CITY OF WICHITA PROJECT NO. 472-84595 OCA NO. 715715

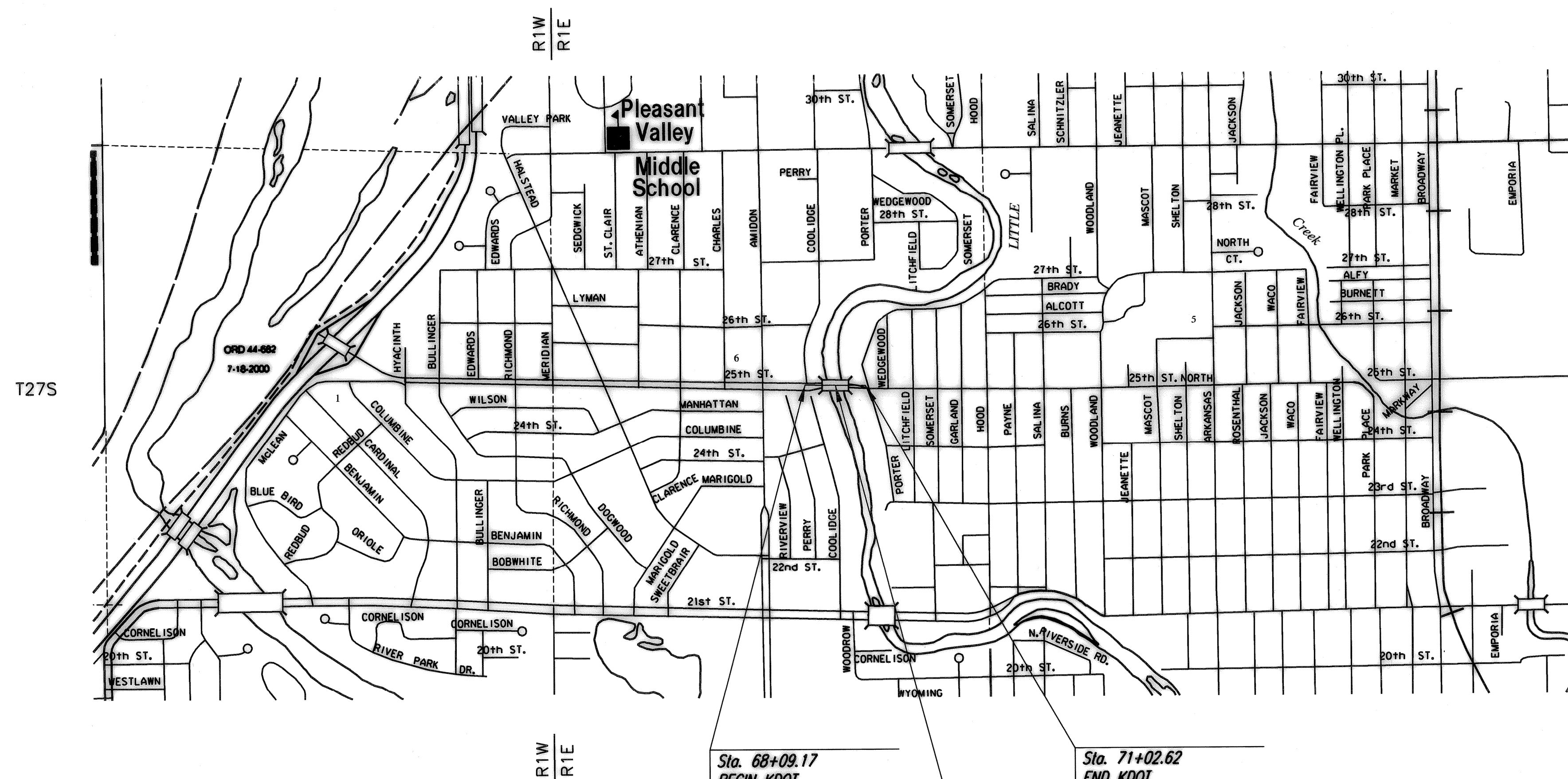

Scale: 1" = 1000'

Note:  
25th Street shall be closed locally during construction.

**DESIGN DESIGNATION**

AA DT (2005) 5400  
AA DT (2030) 17000  
T 3 %  
V 30 MPH  
C of A None  
Clear Zone 6.0 feet

**CONVENTIONAL SIGNS**

COUNTY LINE .....	CENTER LINE OF PROJECT .....	
CITY LIMITS .....	TERRACE .....	
STATE OR NATIONAL LINE .....	CULVERTS .....	
TOWNSHIP, SECTION or GRANT LINE .....	DROP INLET & STORM SEWER .....	
PROPERTY LINE .....	ACCESS CONTROL .....	
HIGHWAY FENCE .....	POWER POLE .....	
EXISTING FENCE .....	TELEPHONE POLE .....	
GUARD FENCE .....	MARSH .....	
CONSTRUCTION LIMITS .....	HEDGE .....	
RIGHT OF WAY LINE .....	TREES .....	
TRAVELED WAY .....	PROFILE ELEVATION .....	
RAILROADS .....	STREAM or CREEK .....	

GROSS LENGTH OF PROJECT	293.45	FT.
EXCEPTIONS		
ADDITIONS		
NET LENGTH OF PROJECT	293.45	FT. 0.056 MILES
NET LENGTH OF BRIDGES	207.63	FT. 0.039 MILES
NET LENGTH OF ROAD	85.82	FT. 0.017 MILES

PLANS PREPARED BY

**Professional Engineering Consultants, P.A.**  
303 S. TOPEKA • WICHITA, KANSAS 67202  
316-262-2691 • FAX 316-262-3003

APPROVED - DATE Sept 4, 2008  
*James L. Armour*  
JAMES L. ARMOUR CITY ENGINEER  
CITY OF WICHITA, SEDGWICK COUNTY, KANSAS  
CITY NO. 472-84595

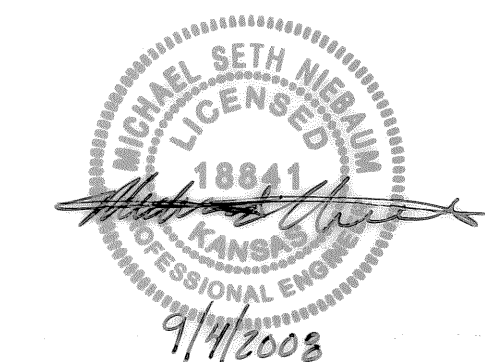

drawn by: wll  
 plotted by: ras 9-3-2008  
 1-2006-06008/1final/09\_02\_2008/06008-000-Titled.dgn