

LOWE'S OF: N.W. WICHITA MAIZE RD. & CENTRAL PARK ST. 1307 PPW, 1761 PPS

COVER GENERAL NOTES:

INFORMATION CONCERNING UNDERGROUND UTILITIES WAS OBTAINED FROM AVAILABLE RECORDS AND EXISTING FIELD CONDITIONS WHEN POSSIBLE. THE CONTRACTOR MUST DETERMINE THE EXACT LOCATION AND ELEVATION OF ALL EXISTING UTILITIES BY HAND DIGGING TEST PITS AT ALL UTILITY CROSSINGS IN ADVANCE OF TRENCHING WITH ANY MECHANICAL DEVICE. CLEARANCES LESS THAN SPECIFIED ON THESE PLANS OR 18", WHICHEVER IS LESS. CONTRACTOR SHALL CONTACT OZARK CIVIL ENGINEERING, INC. @ 479.464.8850 PRIOR TO ANY FURTHER CONSTRUCTION.

CONTRACTOR SHALL BE RESPONSIBLE FOR RELOCATION OR REMOVAL OF EXISTING UNDERGROUND UTILITIES SHOWN OR NOT SHOWN AT NO ADDITIONAL COST TO THE OWNER.

CONTRACTOR SHALL INCLUDE IN CONTRACT THE PRICE FOR THE REMOVAL AND DISPOSAL OF ANY EXCESS TOPSOIL HE DETERMINES IS NOT NEEDED TO ESTABLISH THE FINAL GRADES AND LANDSCAPING.

CONTRACTOR SHALL BE RESPONSIBLE FOR THE DESIGN AND USE OF ANY AND ALL REQUIRED OR NECESSARY SHORING, SHEETING, BRACING AND SPECIAL EXCAVATION MEASURES REQUIRED ON THIS PROJECT THAT WILL MEET OR EXCEED OSHA, FEDERAL, STATE AND LOCAL REGULATIONS DURING CONSTRUCTION. OZARK CIVIL ENGINEERING, INC. AND THE DEVELOPER/OWNER ACCEPTS NO RESPONSIBILITY FOR THE CONTRACTORS FAILURE TO COMPLY WITH THESE REGULATIONS.

ALL UTILITIES, INCLUDING STORM SEWER, SHOWN WITHIN PUBLIC EASEMENTS OR RIGHT OF WAYS SHALL BE CONSTRUCTED TO THE GOVERNING AGENCY'S SPECIFICATIONS. ALL OTHER UTILITIES SHALL BE CONSTRUCTED TO THE CLIENT'S OR THE GOVERNING AGENCY'S SPECIFICATIONS, WHICHEVER IS MORE STRINGENT. IF THERE IS A QUESTION AS TO WHICH SPECIFICATIONS SHOULD APPLY THE CONTRACTOR SHALL CONTACT THE ENGINEER OF RECORD.

IT IS THE RESPONSIBILITY OF THE CONTRACTOR TO FOLLOW ALL RECOMMENDATIONS SET FORTH IN THE GEOTECHNICAL STUDY, WHERE A CONFLICT EXISTS BETWEEN THE HIGHWAY DEPARTMENT / CITY STANDARDS, OR THE GEOTECH STUDY, THE MOST STRINGENT SHALL APPLY.

FURTHERMORE IT IS THE RESPONSIBILITY OF THE CONTRACTOR TO MAINTAIN THE EROSION CONTROL MEASURES AS SHOWN ON THESE PLANS. CONTRACTOR SHALL KEEP THESE MAINTAINED THROUGHOUT ALL PHASES OF CONSTRUCTION. CONTRACTOR SHALL ALSO BE RESPONSIBLE FOR IMPLEMENTING THE SWPPP.

ALL PHASES OF CONSTRUCTION SHALL MEET OR EXCEED THE OWNER / DEVELOPER SITE WORK SPECIFICATIONS.

SEE ARCHITECTURAL PLANS FOR THE EXACT DIMENSIONS AND LOCATIONS OF ANY RAMPS, VESTIBULE, PORCHES, SLOPED PAVING, BUILDING UTILITY ENTRANCE LOCATIONS, TRUCK DOCKS OR WELLS, AND PRECISE BUILDING DIMENSIONS.

CONTRACTOR SHALL REMOVE AND DISPOSE OF ALL DEBRIS, RUBBISH AND OTHER MATERIALS RESULTING FROM PREVIOUS AND CURRENT DEMOLITION PROCEDURES. DISPOSAL SHALL BE IN ACCORDANCE WITH ALL LOCAL, STATE AND/OR FEDERAL REGULATIONS GOVERNING SUCH OPERATIONS.

THE TOPOGRAPHIC AND BOUNDARY SURVEY, INCLUDING BUT NOT LIMITED TO PROPERTY LINES, LEGAL DESCRIPTIONS, EXISTING UTILITIES, SITE TOPOGRAPHY INCLUDING SPOT ELEVATIONS, EXISTING STRUCTURAL LOCATIONS AND OUTSTANDING PHYSICAL FEATURES HAS BEEN PROVIDED BY THE FOLLOWING COMPANY:

Poe & Associates
Tim Austin
5940 E. Central, Ste. 200
Wichita, KS. 67208
316-685-4114 (V)

OZARK CIVIL ENGINEERING INC. AND ITS ASSOCIATES WILL NOT BE HELD RESPONSIBLE FOR THE ACCURACY OF THE SURVEY OR FOR DESIGN ERRORS OR OMISSIONS RESULTING FROM SURVEY INACCURACIES. IT IS THE RESPONSIBILITY OF THE CONTRACTOR TO FIELD VERIFY ALL EXISTING FEATURES AS SHOWN ON THE SURVEY AND NOTIFY THE SURVEYOR AND THE ENGINEER OF RECORD OF ANY INACCURACIES FOUND ON THE SURVEY PRIOR TO BEGINNING CONSTRUCTION.

THE GENERAL CONTRACTOR SHALL BE HELD SOLELY RESPONSIBLE FOR AND SHALL TAKE ALL PRECAUTIONS NECESSARY TO AVOID PROPERTY DAMAGE TO ADJACENT PROPERTIES DURING THE CONSTRUCTION PHASES OF THIS PROJECT.

ALL CONSTRUCTION IN THE STATE RIGHT-OF-WAY SHALL BE COORDINATED WITH THE HIGHWAY DEPARTMENT.

THE CONTRACTOR SHALL BE SOLELY AND COMPLETELY RESPONSIBLE FOR CONDITIONS OF THE JOB SITE, INCLUDING SAFETY OF ALL PERSONS AND PROPERTY DURING ALL PHASES OF CONSTRUCTION OF THIS SITE. THIS REQUIREMENT SHALL APPLY CONTINUOUSLY AND SHALL NOT BE LIMITED TO CONSTRUCTION WORKING HOURS.

WARRANTY / DISCLAIMER
THE DESIGNS REPRESENTED IN THESE PLANS ARE IN ACCORDANCE WITH ESTABLISHED PRACTICES OF CIVIL ENGINEERING FOR DESIGN FUNCTION AND USE INTENDED BY THE OWNER AT THIS TIME. HOWEVER, NEITHER THE ENGINEER NOR HIS PERSONNEL CAN OR DO WARRANT THESE DESIGNS OR PLANS AS CONSTRUCTED EXCEPT IN THE SPECIFIC CASES WHERE THE ENGINEER INSPECTS AND CONTROLS THE PHYSICAL CONSTRUCTION AT THE SITE.

GOVERNING / UTILITY AGENCIES:

CITY OF WICHITA, KS.

CLIENT
Lowe's Companies, INC.
Robert Fiebig
1952 McDowell Rd. Ste. 101
Naperville, IL. 60563-6505
630-548-7514 (V)
630-527-8830 (F)

CITY
City Planning Department
Donna Goltry
455 N. Main
Wichita, KS. 67202-1688
316-268-4421 (V)
316-268-4390 (F)

City Planning Dept./Plan Approval
Dale Miller
455 N. Main
Wichita, KS. 67202-1688
316-268-4421 (V)
316-268-4390 (F)

WATER AND SEWER
City of Wichita, KS.
Bill Perkins/Paul Bryant
455 N. Main
Wichita, KS. 67202
316-368-4555 (V)
316-368-4514 (F)

ELECTRIC
Westar Energy
Randy Truitt
1900 E. Central
Wichita, KS. 67214
316-261-6215 (V)

TELEPHONE
SBC
Christopher Dieker
154 N. Broadway, Room 210
Wichita, KS. 67202
316-268-3180 (V)

GAS
Kansas Gas Service
John Stark
3845 W. Harry
Wichita, KS. 67213
316-941-1607 (V)

DEVELOPER
Classic Real Estate
Christian Ablah
8200 E. 32nd St. Ste. 150
Wichita, KS. 67226
316-634-2600 (V)
316-393-3456 (F)

GEOTECH
Klienfelder
Jeff Hoffman
7802 Barton
Lenexa, KS. 66214
913-632-0909 (V)
913-632-0924 (F)

ENVIRONMENTAL
Klienfelder
Rowley Tedlock
7802 Barton
Lenexa, KS. 66214
913-632-0909 (V)
913-632-0924 (F)

WETLANDS
Burns & McDonnell
Randy Root
9400 Ward Parkway
Kansas City, MO. 64114-3319
816-822-3961 (V)
816-822-3515 (F)

TRAFFIC
Poe & Associates
Tim Austin
5940 E. Central, Ste. 200
Wichita, KS. 67208
316-685-4114 (V)
316-685-4444 (F)

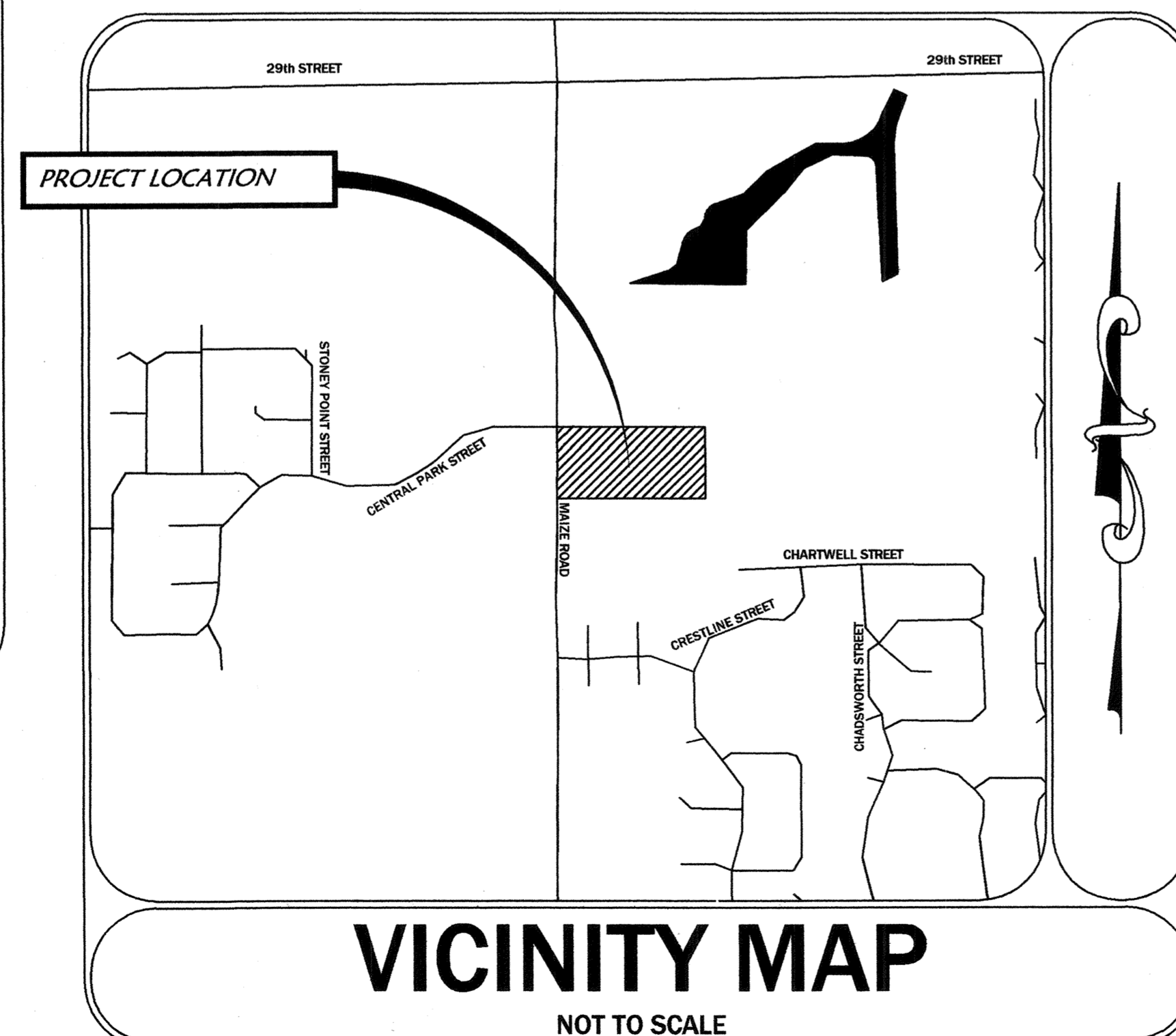

APPROVED: *LGG* 5/22/08
PUBLIC WORKS: *LGG* 5/30/08
WATER: *Julianne Kallman* 7-15-08
SEWER: *WFD/RLT* 6-2-08
FIRE: *WFD/RLT* 6-2-08

NOTE TO CONTRACTORS

INSTALLATION, INSPECTION AND TESTING FOR THIS PROJECT IS TO BE PROVIDED BY A LICENSED CONSULTING ENGINEERING FIRM UNDER CONTRACT WITH THE OWNER/DEVELOPER. SAID INSPECTION TO BE IN ACCORDANCE WITH THE CITY OF WICHITA STANDARD CONSTRUCTION ENGINEERING PRACTICES AND CERTIFIED BY A LICENSED PROFESSIONAL ENGINEER. NO WORK SHALL BE PERFORMED IN DEDICATED EASEMENTS OR PUBLIC RIGHT-OF WAY BY THE CONTRACTOR WITHOUT SUCH INSPECTION NOR SHALL ANY WORK BE COMMENCED WITHOUT WRITTEN AUTHORIZATION BY THE CITY ENGINEER. ALL CONSTRUCTION AND MATERIALS SHALL COMPLY WITH THE CITY OF WICHITA SPECIFICATIONS AND STANDARDS (ON FILE AND AVAILABLE IN THE CITY ENGINEERS OFFICE).



STATE LOCATION MAP

DRAWING INDEX:

		DATE	REV/BID/CO/ADD
1.W	WATER COVER SHEET	4-08-08	ADDENDUM 2
9.	UTILITY PLAN	4-08-08	ADDENDUM 2
9.1	WATER LINE FITTINGS NORTHING & EASTING PLAN	4-08-08	ADDENDUM 1
10.	SANITARY SEWER LINE A & B- PLAN & PROFILE	4-08-08	ADDENDUM 1
11.	WATER LINE A - PLAN & PROFILE	4-08-08	ADDENDUM 1
12.	WATER LINE B & C - PLAN & PROFILE	4-08-08	ADDENDUM 1
13.	WATER LINE D - PLAN & PROFILE	4-08-08	ADDENDUM 1
21.	DETAIL SHEET	4-08-08	BID
24.	CITY OF WICHITA WATER ASSEMBLY STANDARD DETAILS	4-08-08	BID
25.	CITY OF WICHITA WATER SERVICE STANDARD DETAILS	4-08-08	BID

Released: Sept. 11, 2008
:apr

As Built Plans:

CONTRACTOR: Haven Constuction
INSPECTOR: Larry Gann, K E Miller Engineering
.PDF by: LGG, 09/09/08

REVISIONS	
DATE	DESCRIPTION
9-27-07	ADDENDUM 2

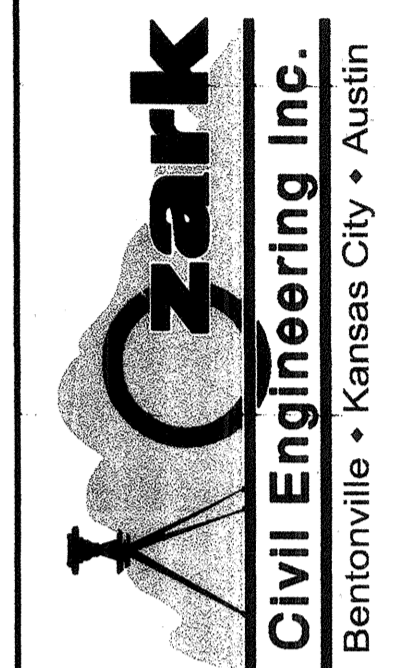
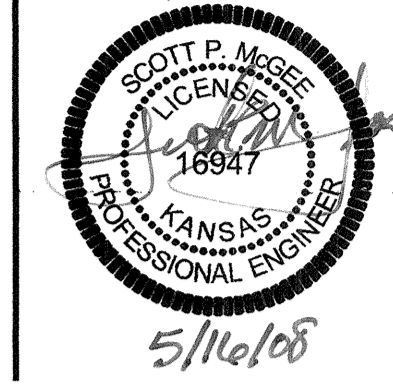

LOWE'S HOME CENTERS, INC.
1605 CURTIS BRIDGE ROAD
REEC DOCK
WILKESBORO, NC 28697
336.658.4000 (V) 336.658.3257 (F)

THIS DRAWING IS THE PROPERTY OF LOWE'S HOME CENTERS, INC. ANY USE OR REPRODUCTION IN WHOLE OR PART IS PROHIBITED WITHOUT THE EXPRESSED WRITTEN CONSENT OF LOWE'S HOME CENTERS, INC. COPYRIGHT 2003 ALL RIGHTS RESERVED.

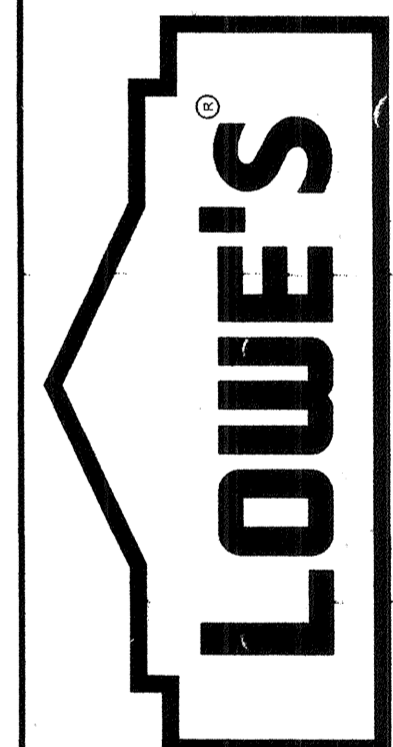

COVER SHEET
LOWE'S OF
N.W. WICHITA
MAIZE RD. & CENTRAL PARK ST.
WICHITA, KS.
DRAWN BY: LG
CHECKED BY: SK

ORIGINAL ISSUE DATE:	
PERMIT SET ISSUE DATE:	
CONSTRUCTION SET ISSUE DATE:	8-17-07
DRAWING NUMBER:	1.W

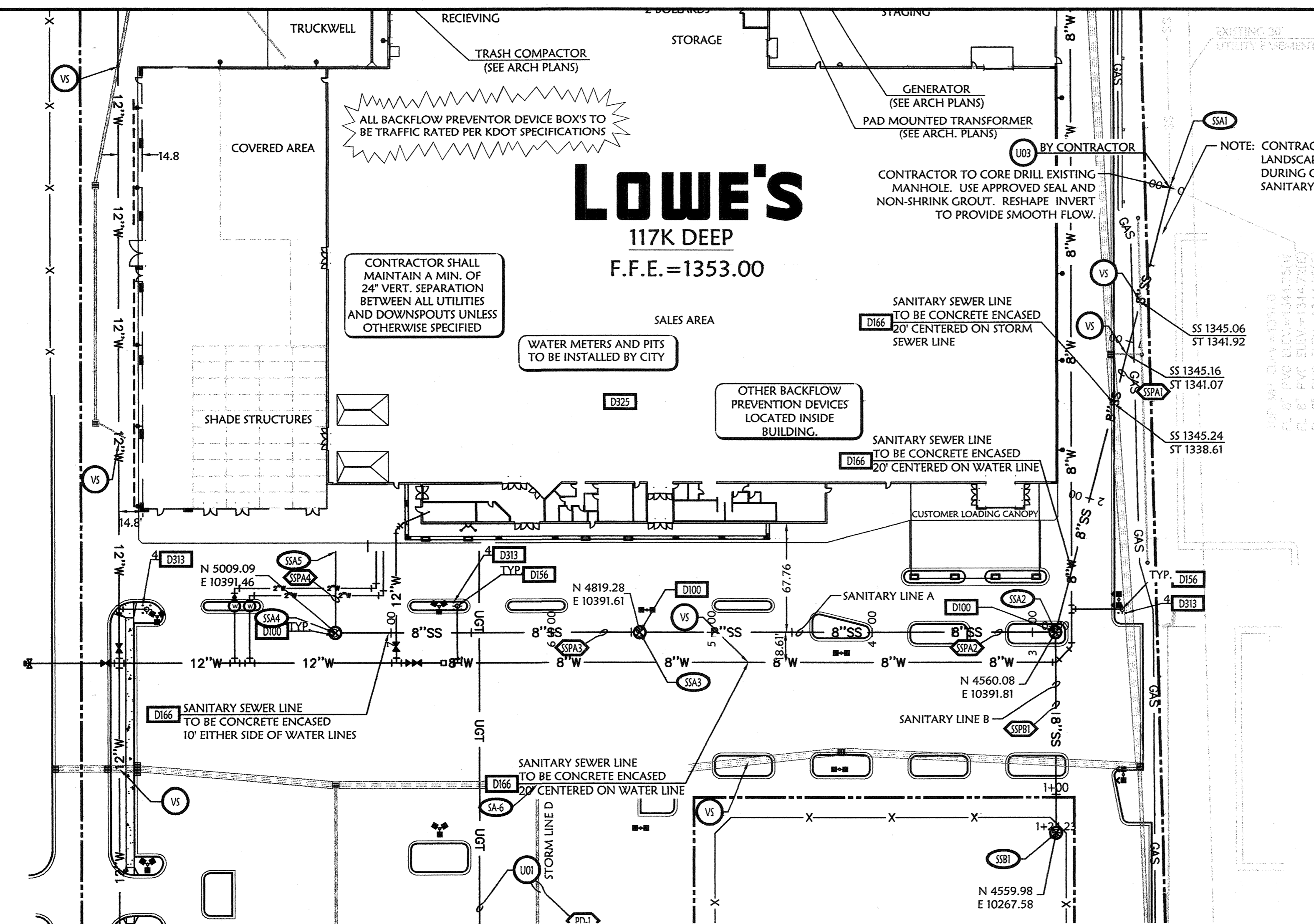

SANITARY SEWER SCHEDULE

STRUCTURE NUMBER	STRUCTURE TYPE	TOP OF LID	DETAIL NUMBER	INV. IN PIPE & INFECTION	INV. IN PIPE & INFECTION	INV. IN PIPE & INFECTION	INV. OUT PIPE & INFECTION	PIPE NUMBER	PIPE LENGTH & SLOPE
SSA3	CONNECTION TO BUILDING	-	-	-	-	-	1348.00	SSPA4	51 LF @ 0.00%
SSA4	PROPOSED MANHOLE	1351.68	D100	1347.66	1347.66	-	1347.36	SSPA3	700 LF @ 0.32%
SSA5	PROPOSED MANHOLE	1351.68	D100	1346.75	1346.75	-	1346.65	SSPA4	239 LF @ 0.32%
SSA2	PROPOSED MANHOLE	1352.18	D100	1345.82	1345.82	1345.82	1345.72	SSPA1	286 LF @ 0.52%
SSA1	EXISTING MANHOLE	1351.00	-	1344.82	1344.82	-	-	-	-
SSB1	PROPOSED MANHOLE	1350.56	D100	-	-	-	1346.51	SSPBI	124 LF @ 0.53%

UTILITY PROPOSED FEATURES

- BOUNDARY LINE
- RIGHT OF WAY LINE
- EASEMENT LINE
- CONCRETE CURB AND GUTTER
- FENCE
- GUARD RAIL
- RETAINING WALL
- STORM DRAIN (SEE GRADING PLAN FOR SIZE)
- SANITARY SEWER SERVICE
- WATER SERVICE
- UNDERGROUND ELECTRIC SERVICE
- UNDERGROUND TELEPHONE SERVICE
- OVERHEAD ELECTRIC SERVICE
- OVERHEAD TELEPHONE SERVICE
- FIBER OPTIC CABLE SERVICE
- GAS SERVICE
- DROP INLETS (SEE GRADING PLAN FOR TYPE)

UTILITY GENERAL NOTES:

ALL WATER LINES SHALL HAVE A MINIMUM OF 3'-6" COVER ABOVE TOP OF PIPE.
 ALL SANITARY SEWER LINES SHALL HAVE A MINIMUM COVER OF 3'-0" COVER ABOVE TOP OF PIPE.
 PROPOSED UTILITIES TO BE BURIED IN THE SAME TRENCH INSTALLATION SHALL BE COORDINATED AND APPROVED BY LOCAL UTILITY COMPANIES.
 VERIFY LOCATION AND DEPTH OF EXISTING UTILITY BEFORE CONSTRUCTING PROPOSED UTILITY.
 CONTRACTOR SHALL COORDINATE ANY DISRUPTIONS TO EXISTING UTILITY SERVICES WITH ADJACENT PROPERTY OWNERS.
 ALL ELECTRIC, TELEPHONE AND GAS EXTENSIONS INCLUDING SERVICE LINES SHALL BE CONSTRUCTED TO THE APPROPRIATE UTILITY COMPANY SPECIFICATIONS. ALL UTILITY DISCONNECTIONS SHALL BE COORDINATED WITH THE DESIGNATED UTILITY COMPANIES.
 CONSTRUCTION SHALL NOT START ON ANY PUBLIC UTILITY SYSTEM UNTIL WRITTEN APPROVAL HAS BEEN RECEIVED BY THE ENGINEER FROM THE APPROPRIATE GOVERNING AUTHORITY AND CONTRACTOR HAS BEEN NOTIFIED BY THE ENGINEER.
 THE MINIMUM HORIZONTAL SEPARATION BETWEEN THE CLOSEST TWO POINTS OF THE WATER AND SEWER LINE IS TEN FEET (10'). THE MINIMUM VERTICAL SEPARATION BETWEEN THE CLOSEST TWO POINTS OF THE WATER AND SEWER LINE IS TWENTY FOUR INCHES (24"). IF WATER IS NOT 24" ABOVE SEWER, THE SEWER SHALL BE CONCRETE ENCASED 10' EACH DIRECTION FROM WATERLINE.
 ALL TRENCHING, PIPE LAYING, AND BACK FILLING PROCEDURES SHALL BE IN ACCORDANCE WITH FEDERAL OSHA REGULATIONS.
 PRIOR TO THE CONSTRUCTION OF OR CONNECTION TO ANY STORM DRAIN, SANITARY SEWER, WATER MAIN OR ANY OF THE OTHER UTILITIES, THE CONTRACTOR SHALL LOCATE, VERIFY AND CALCULATE ALL POINTS OF CONNECTION AND ALL UTILITY CROSSINGS AND INFORM OZARK CIVIL ENGINEERING AND THE OWNER/DEVELOPER OF ANY CONFLICT OR REQUIRED DEVIATIONS FROM THE PLAN. NOTIFICATION SHALL BE MADE A MINIMUM OF 48 HOURS PRIOR TO CONSTRUCTION. OZARK CIVIL ENGINEERING AND ITS CLIENTS SHALL BE HELD HARMLESS IN THE EVENT THAT THE CONTRACTOR FAILS TO MAKE SUCH NOTIFICATION.
 ALL WATER LINE FITTINGS SHALL BE INSTALLED WITH THRUST BLOCKING PER DETAIL D128-ABE (DETAIL SHEETS), OR APPROVED EQUIVALENT ANCHOR.
 ALL WATER LINE PIPE BEDDING SHALL BE INSTALLED PER DETAIL D326 (SEE DETAIL SHEETS).
 ALL SANITARY SEWER PIPE BEDDING SHALL BE INSTALLED PER DETAIL D326 (SEE DETAIL SHEETS).
 CONTRACTOR SHALL BE RESPONSIBLE FOR NOTIFYING THE CITY CONSTRUCTION DIVISION TO SCHEDULE A PRE-CONSTRUCTION MEETING AT LEAST 48 HOURS PRIOR TO STARTING ANY WORK ON THE PROJECT. CONTRACTOR SHALL OBTAIN ALL NECESSARY PERMITS.
 EXISTING UTILITIES ACROSS OR ALONG THE LINE OF THE PROPOSED WORK ARE SHOWN ONLY IN AN APPROXIMATE LOCATION. CONTRACTOR SHALL CALL THE UTILITY COMPANIES TO LOCATE ALL UTILITIES OR DESIGNATED UTILITY COMPANY PRIOR TO CONSTRUCTION. CONTRACTOR SHALL ON HIS OWN INITIATIVE AND AT HIS OWN RISK LOCATE ALL UTILITIES AND STRUCTURES AS NECESSARY. CONTRACTOR SHALL BE RESPONSIBLE FOR ANY DAMAGE TO UNDERGROUND LINES OR STRUCTURES.
 FIRE HYDRANTS SHALL BE INSTALLED IN ACCORDANCE WITH THE CITY UTILITY DEPARTMENT STANDARD OR PER DETAIL D155-A (SEE DETAIL SHEETS).
 CONTRACTOR SHALL NOT TAP OR OTHERWISE PENETRATE EXISTING WATER AND SEWER MAIN LINES WITHOUT PRIOR APPROVAL FROM THE CITY ENGINEER. CONTRACTOR IS RESPONSIBLE FOR AVOIDING SPILLAGE OF RAW SEWAGE. CONTRACTOR SHALL PROVIDE ALL SEWER PLUGGING AND PLUMBING EQUIPMENT NECESSARY TO AVOID SPILLAGE. CONTRACTOR SHALL NOT CREATE VALVES ON EXISTING WATER MAINS.
 THE EXISTING UTILITIES AND OBSTRUCTIONS SHOWN ARE FROM THE BEST AVAILABLE RECORDS AND SHALL BE VERIFIED BY THE CONTRACTOR TO HIS SATISFACTION PRIOR TO CONSTRUCTION. NECESSARY PRECAUTIONS SHALL BE TAKEN BY THE CONTRACTOR TO PROTECT EXISTING SERVICES AND MAINS, AND ANY DAMAGE TO THEM SHALL BE REPAIRED IMMEDIATELY AT THE CONTRACTOR'S EXPENSE.
 IT SHALL BE DEEMED UNDERSTOOD THAT FAILURE TO SPECIFICALLY MENTION WORK WHICH IS REQUIRED TO COMPLETE THE PROJECT SHALL NOT RELIEVE THE CONTRACTOR OF HIS RESPONSIBILITY TO PERFORM SUCH WORK.
 CONTRACTOR SHALL MATCH TOP OF PROPOSED SANITARY SEWER MANHOLE TO PROPOSED GRADE. IF A DISCREPANCY OCCURS BETWEEN PROPOSED GRADE AND PROPOSED STRUCTURE TOP, THE GRADE SHALL GOVERN. IF THE DISCREPANCY IS MORE THAN 4 INCHES THE CONTRACTOR SHALL CONTACT THE ENGINEER OF RECORD.
 ALL UTILITIES, INCLUDING STORM SEWER, SHOWN WITHIN PUBLIC EASEMENTS OR RIGHT OF WAY SHALL BE CONSTRUCTED TO THE GOVERNING AGENCY'S SPECIFICATIONS. ALL OTHER UTILITIES SHALL BE CONSTRUCTED TO THE CLIENT'S OR THE GOVERNING AGENCY'S SPECIFICATIONS, WHICHEVER IS MORE STRINGENT. IF THERE IS A QUESTION AS TO WHICH SPECIFICATIONS SHOULD APPLY, THE CONTRACTOR SHALL CONTACT THE ENGINEER OF RECORD.
 IF SANITARY SEWER MANHOLE IS LOCATED IN A GRASS AREA OR ROPE, CONTRACTOR SHALL CONTACT MANHOLE TOP TO AN ELEVATION 6 INCHES HIGHER THAN THE PROPOSED GRADE. IF THIS CANNOT BE ACHIEVED THEN CONTRACTOR SHALL USE A WATER TIGHT MANHOLE COVER THAT MEETS OR EXCEEDS THE OWNER'S/DEVELOPER'S STANDARD SPECIFICATIONS.
 ALL WATER MAINS SHALL BE HYDROSTATICALLY TESTED AND DISINFECTED BEFORE ACCEPTANCE. SEE SITE WORK SPECIFICATIONS.
 CONTRACTOR SHALL COORDINATE WITH UTILITY COMPANIES ON ADJUSTING EXISTING UTILITY LINE AS REQUIRED BY CUT AND FILL AT NO ADDITIONAL COST TO THE OWNER.
 CONTRACTOR SHALL NOTIFY ENGINEER OF RECORD AND ARCHITECT SHOULD ANY LIGHT POLE OR SIGN FOUNDATIONS CONFLICT WITH ANY UTILITY AND/OR STORM SEWER SYSTEM.
 GENERAL CONTRACTOR SHALL PROVIDE 2' x 2' x 6" THICK CONCRETE APRON AT ALL CLEANOUTS, GATE VALVES, AND METER BOXES ETC. OUTSIDE OF BUILDING AND IN PAVED AREAS.
 GENERAL CONTRACTOR SHALL BE RESPONSIBLE FOR ALL TAP AND TIE ON FEES REQUIRED, AS WELL AS COST OF UNDERGROUND SERVICE CONNECTIONS TO THE BUILDING.
 ELECTRICAL SERVICE TO PAD MOUNTED TRANSFORMER SHALL BE RUN UNDERGROUND, FROM ROAD RIGHT-OF-WAY TO TRANSFORMER LOCATION. ASSOCIATED COST BY GENERAL CONTRACTOR.
 UTILITY CONTRACTOR SHALL FURNISH (2) - 4" TELEPHONE CONDUITS AS SHOWN ON PLAN. VERIFY LOCATION OF THE IN AT TELEPHONE COMPANIES SERVICE LINE. PROVIDE NYLON PULL CORD INSIDE CONDUIT.
 DIMENSIONS SHOWN ARE TO CENTERLINE OF PIPE OR FITTING UNLESS OTHERWISE NOTED.
 ALL WATER AND SANITARY LEADS TO BUILDING SHALL END OUTSIDE THE BUILDING LIMITS AS SHOWN ON PLAN AND SHALL BE PROVIDED WITH A TEMPORARY PLUG AT END. EXCEPT THE FIRE LINE SHOULD BE STUBBED UP 7' ABOVE F.F.E. IN SPRINKLER ROOM.
 ALL FIRE HYDRANTS SHALL BE PROVIDED WITH AN APPROVED GATE VALVE ANCHORED AT MAIN PER CITY DETAIL.
 REFER TO FIRE PROTECTION SHEETS FOR LOCATION AND DETAIL OF FIRE LINE LEAD IN FIRE LINE SHALL BE STUBBED UP 7' ABOVE F.F.E.
 REFER TO PLUMBING SHEETS FOR LOCATION OF SEWER, DOMESTIC, AND IRRIGATION CONNECTIONS.
 ALL WORK TO BE DONE IN STRICT ACCORDANCE WITH DIVISION 2 OF LOWE'S STANDARD SITE SPECIFICATIONS.

REVISIONS

DATE	DESCRIPTION
4-08-08	REVISION 2

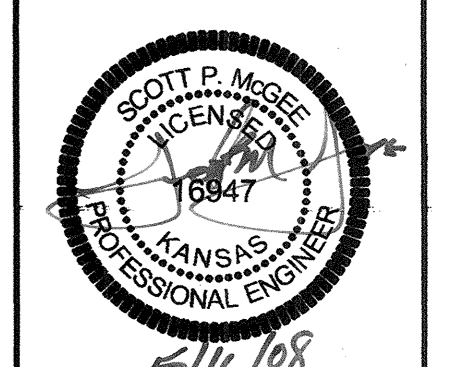

Ozark
 Civil Engineering Inc.
 Bentonville • Kansas City • Austin

LOWE'S HOME CENTERS, INC.
 1605 CURTIS BRIDGE ROAD
 REC DOCK
 WILKESBORO, NC 28687

336.658.4000 (V) 336.658.3257 (F)

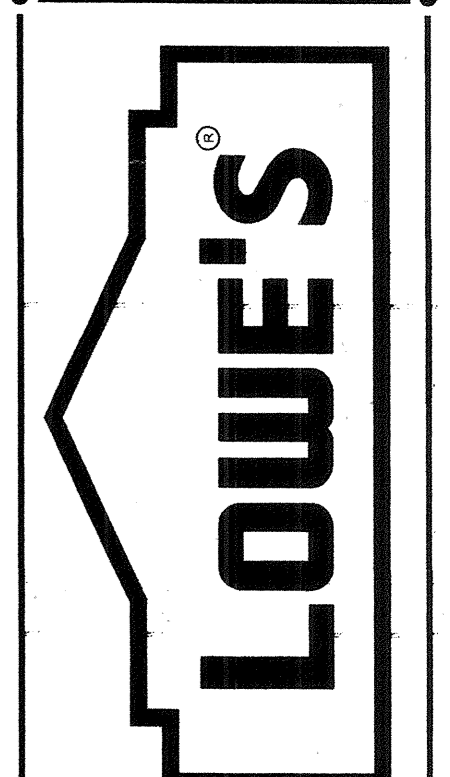

SANITARY SEWER PLAN & PROFILE
 LINE A
 LOWE'S OF
 N.W. WICHITA
 MAIZE RD. & CENTRAL PARK ST.
 WICHITA, KS.
 PROJECT No. 04-0460
 DRAWN BY: JG
 CHECKED BY: SW

ORIGINAL
 ISSUE DATE:
 PERMIT SET
 ISSUE DATE:
 CONSTRUCTION SET
 ISSUE DATE: 8-17-07
 DRAWING NUMBER:
10

