

**HANNAY & ASSOCIATES, ARCHITECTS**  
 1726 South Hillside, Wichita, Kansas, 67211  
 Phone (316) 683-5965  
 Fax (316) 684-1441

**STORM WATER SEWER IMPROVEMENTS**  
 FOR FIRE STATION #22 ADDITION  
 LOCATED AT 2659 S. HYDRAULIC  
 WICHITA, SEDGWICK COUNTY, KS  
 COW PRIV. PROJ. NO. 1875 PPS (607861)  
 JAMES L. ARMOUR, P.E., CITY ENGINEER  
 APRIL 2008

PRIVATELY OWNED AND MAINTAINED

**INDEX OF SHEETS**

C1.8	Title/Plan & Profile Sheet
<del>C1.9</del>	<del>RCP Detail (Intentionally Deleted)</del>
C1.10	Type 1 Inlet Detail
C1.11	Plat

**As Built Plans:**  
**CONTRACTOR:** Boardman  
**INSPECTOR:** Larry Gann & Tom Jones  
**COMPANY:** K E Miller Engineering  
**.PDF by:** NWS, 10-22-08

APPROVED AS NOTED  
 BY CITY ENGINEER OF WICHITA

Sanitary Sewers \_\_\_\_\_  
 Storm Sewers *Julian Kallman 7-16-08*  
 Driveway Approaches \_\_\_\_\_  
 Water Mains \_\_\_\_\_  
 Paving \_\_\_\_\_

**NOTE TO CONTRACTOR**

INSPECTION AND TESTING FOR THIS PROJECT IS TO BE PROVIDED BY A LICENSED CONSULTING ENGINEERING FIRM UNDER CONTRACT WITH THE OWNER/DEVELOPER. SAID INSPECTION TO BE IN ACCORDANCE WITH THE CITY OF WICHITA STANDARD CONSTRUCTION ENGINEERING PRACTICES AND CERTIFIED BY A LICENSED PROFESSIONAL ENGINEER. NO WORK SHALL BE PERFORMED IN DEDICATED EASEMENTS OR THE PUBLIC RIGHT-OF-WAY BY THE CONTRACTOR WITHOUT SUCH INSPECTION NOR SHALL ANY WORK BE COMMENCED IN DEDICATED EASEMENTS OR PUBLIC RIGHT-OF-WAY WITHOUT WRITTEN AUTHORIZATION BY THE CITY ENGINEER.

Benchmark: Square Cut on Top of Curb  
 6.3' west & 14.3' south of the S.E. corner  
 Lot 1, Este Cate Second Addition  
 Elevation = 1281.00 NAVD 88

**SURVEY DISCLAIMER:**  
 TOPOGRAPHIC SURVEY AND CONTOUR MAP USED IN PREPARING PLANS WAS PROVIDED BY SAVOY COMPANY PA, 535 S. EMPORIA ST., WICHITA, KS. THE ENGINEER DOES NOT GUARANTEE SURVEY ELEVATIONS FOR ACCURACY. CONTRACTOR SHALL VERIFY ELEVATIONS AND NOTIFY ENGINEER OF ANY DISCREPANCIES.

**DRAWINGS ISSUED**

NO.	DATE	ITEM	ISSUED
14			
13			
12			
11			
10			
9			
8			
7			
6			
5			
4			
3			
2			
1			

COMPUTER DRAWING

DATE: DECEMBER, 2007  
 DRAWN BY: CHECKED BY:

MRH, JP MRH  
 SHEET  
 OF - SHEETS

FIRE STATION #22 ADDITION  
**SWS PLAN & PROFILE**  
 WICHITA, SEDGWICK COUNTY, KANSAS  
 CED PROJ. NO. 20071568  
**CERTIFIED ENGINEERING DESIGN, P.A.**  
 810 WEST DOUGLAS, SUITE C  
 WICHITA, KANSAS 67203  
 PH.(316)262-8808 FAX.(316)262-1669

DESIGNED: HDF	SCALE: 1"=20'	SHEET
DRAWN: HDF	DATE: 4-23-08	1.8
CHECKED: HDF	CED FILE: Fire Station #22	TOTAL

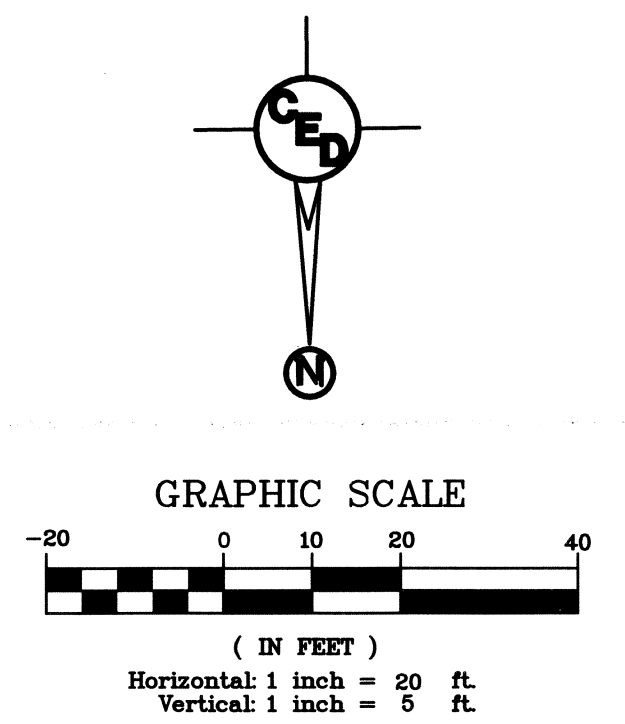
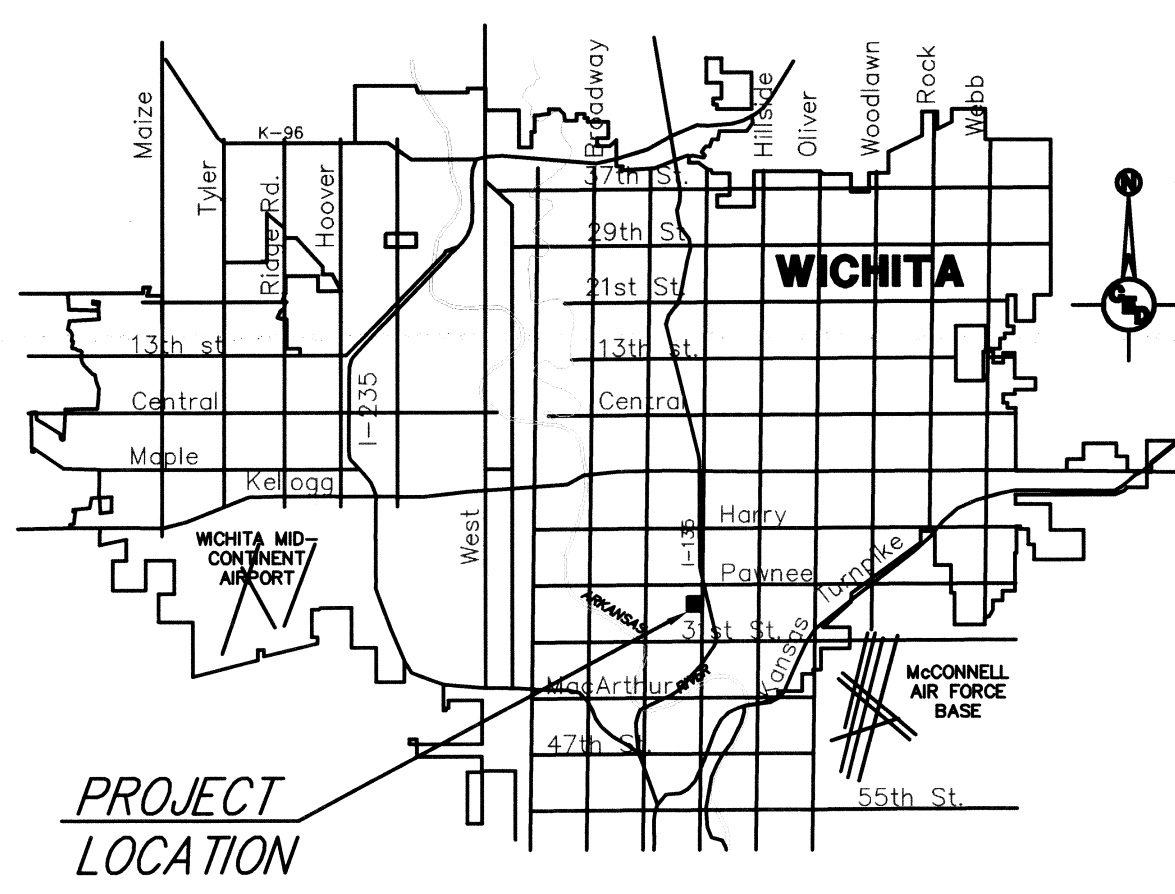

**LEGAL DESCRIPTION -**  
 LOT 1, & THE EAST 50.00 FEET  
 OF LOT 2, ESTE CATE SECOND  
 ADDITION, WICHITA, KS. EXCEPT THE  
 NORTH 15 FEET THEREOF.  
 NW COR, NE1/4 10-27S-2E

**HORIZONTAL CONTROL POINTS**

Number	Northing	Easting	Elevation	Raw Description
2001	233779.3982	235532.4137	n.a.	1/2" Rebar with Savoy Cap
2002	233781.0688	235762.8251	n.a.	1/2" Rebar with Savoy Cap
2003	233624.4707	235532.7028	n.a.	1/2" Rebar with Savoy Cap
2004	233626.0093	235763.0973	n.a.	3/4" IP
2005	233611.7243	235768.9273	1281.00	BM - cut square on top of curb

**STORM WATER SEWER STAKING POINTS**

Number	Northing	Easting	Raw Description
1001	233639.2041	235542.6753	PR-DI (NE COR., INSIDE FACE)
1002	233636.7111	235542.6800	PR-DI (CENTER, INSIDE FACE)
1003	233634.2111	235542.6847	PR-DI (SE COR., INSIDE FACE)
1004	233613.2467	235763.3143	EX-DI (CENTER, INSIDE FACE)

STA. 2+21.00 EXISTING STORM INLET  
 CONTRACTOR SHALL CORE EXISTING  
 STORM INLET. INSTALL AND SEAL 15"  
 RCP TO INLET W/QUICK SET  
 HYDRAULIC CEMENT. FILL ALL  
 IMPERFECTIONS W/HYDRAULIC CEMENT.  
 EXISTING TOP ELEV. = 1280.96  
 EXIST. FL (NE)=1277.96  
 PROP. FL (WNW) = 1278.00  
 CENTER INSIDE FACE  
 N 233613.2467  
 E 235763.3143

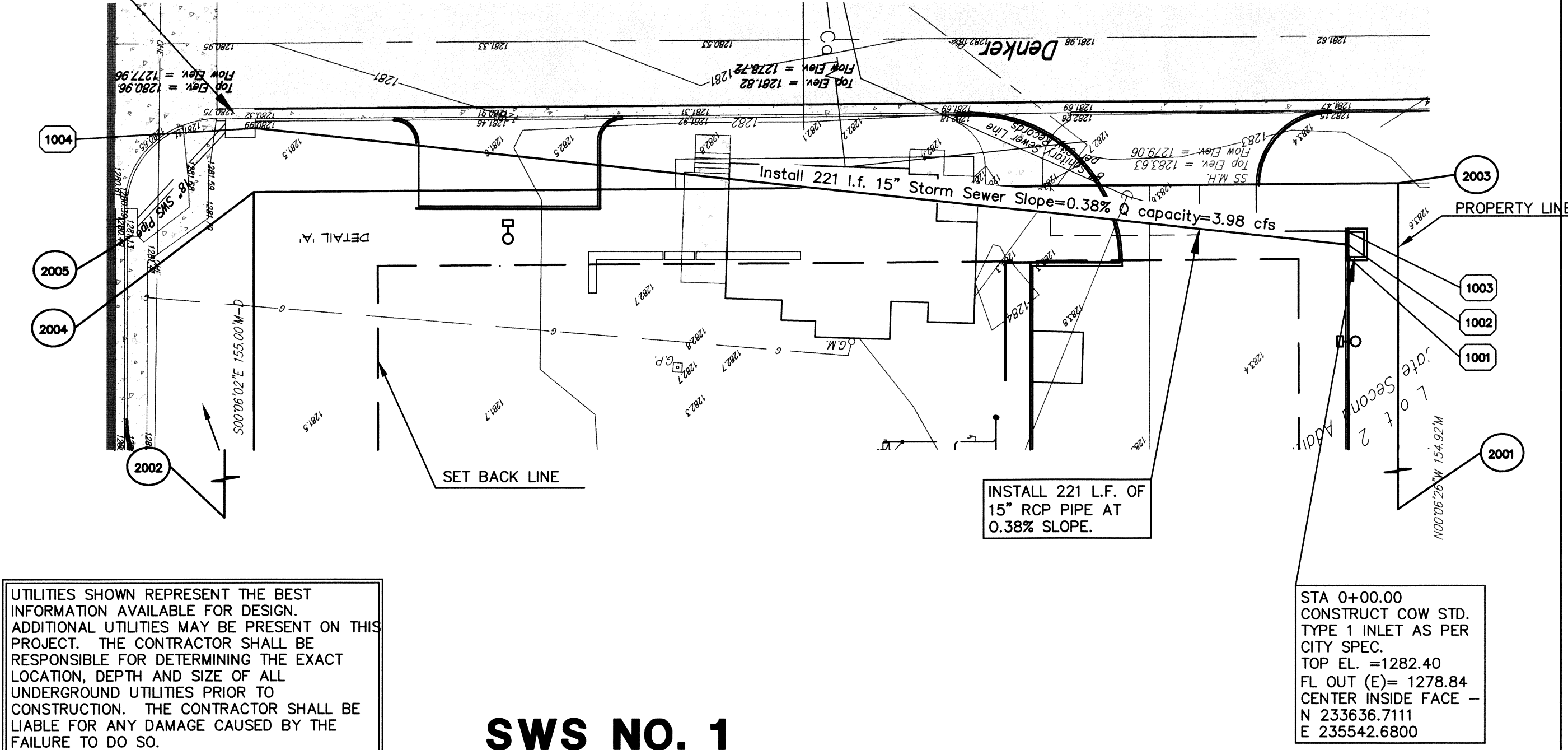

UTILITIES SHOWN REPRESENT THE BEST  
 INFORMATION AVAILABLE FOR DESIGN.  
 ADDITIONAL UTILITIES MAY BE PRESENT ON THIS  
 PROJECT. THE CONTRACTOR SHALL BE  
 RESPONSIBLE FOR DETERMINING THE EXACT  
 LOCATION, DEPTH AND SIZE OF ALL  
 UNDERGROUND UTILITIES PRIOR TO  
 CONSTRUCTION. THE CONTRACTOR SHALL BE  
 LIABLE FOR ANY DAMAGE CAUSED BY THE  
 FAILURE TO DO SO.

**SWS NO. 1**

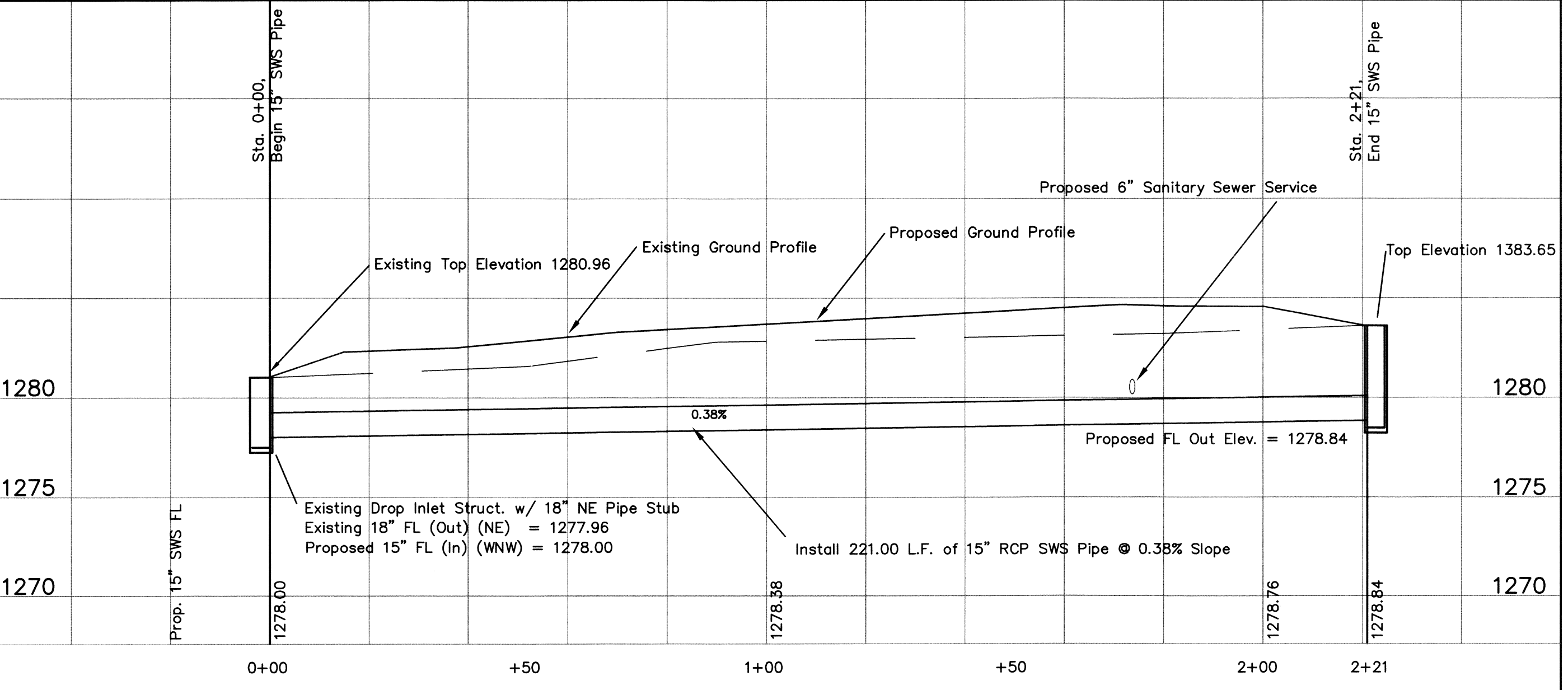

- GENERAL NOTES**
- ALL ELEVATIONS SHOWN ARE BASED ON MEAN SEA LEVEL DATUM.
  - CONTRACTOR WILL BE REQUIRED TO PROVIDE A MINIMUM ADVANCE NOTICE OF FORTY-EIGHT(48)HOURS TO UTILITY COMPANIES PRIOR TO STARTING ANY EXCAVATION AS FOLLOWS:  
 KANSAS ONE CALL 687-2470  
 THE CONTRACTOR MUST NOTIFY THE FOLLOWING IN CASE OF AN EMERGENCY:  
 Cox Communications 262-4270 or 263-2061  
 SBC 1-800-870-8590  
 Kansas Gas Service 1-888-482-4950  
 Westar 1-800-383-1183  
 Aquila 1-800-303-0752  
 City of Wichita(Water & Sewer) 268-4555
  - THE CONTRACTOR SHALL NOTIFY PIPELINE COMPANIES AT LEAST 24 HOURS IN ADVANCE OF ANY WORK BEING PERFORMED ACROSS AND/OR ADJACENT TO PIPELINES.
  - THE CONTRACTOR SHALL RESTORE ALL DITCHES, SWALES, ROAD SHOULDERS, ENTRANCES AND BANK LINES TO THEIR ORIGINAL SLOPES AND GRADES EXCEPT AS SHOWN OTHERWISE. ALL AREAS DISTURBED BY CONSTRUCTION UNINCLUDING STAGING AREAS, SHALL BE REPLANTED WITH GRASS SEED AT THE APPROPRIATE RATES APPROVED BY THE ENGINEER.
  - THE CONTRACTOR SHALL MAINTAIN TRAFFIC USING BARRICADES AND FLAGPERSONS WHILE WORKING WITHIN STREET RIGHT-OF-WAY. INTERURBAN TRAFFIC GENERATED OUTSIDE THE PROJECT AREA SHALL NOT BE CARRIED THROUGH CONSTRUCTION AS FURTHER PROMULGATED BY PROJECT SPECIAL PROVISIONS. THE CONTRACTOR SHALL ERECT WARNING SIGNS, FLASHING LIGHTS, AND BARRICADES IN COMPLIANCE WITH THE MANUAL ON UNIFORM TRAFFIC CONTROL DEVICES TO ENSURE SAFETY AS DIRECTED IN THE GENERAL CONDITIONS. THE CONTRACTOR SHALL LIMIT THE EXTENT OF TRENCH TO REMAIN OPEN OVERNIGHT AND WEEKENDS TO LESS THAN 50 FEET.
  - UNDERGROUND UTILITY SERVICE LINES AND OVERHEAD UTILITY POLE LINES ARE TO BE ADJUSTED AS NECESSARY BY OTHERS PRIOR TO CONSTRUCTION UNLESS THE PLANS SPECIFICALLY CALL FOR THEIR ADJUSTMENT BY THE CONTRACTOR OR UNLESS THE PLANS SPECIFICALLY IDENTIFY A UTILITY TO BE ADJUSTED BY ITS OWNER DURING CONSTRUCTION. EXISTING UTILITIES AND THEIR LOCATION, AS SHOWN ON THE PLANS, REPRESENT THE BEST INFORMATION OBTAINABLE FOR DESIGN. IT SHOULD BE NOTED THAT OTHER BURIED LINES AND CABLE MAY EXIST WHICH ARE NOT SHOWN ON THESE PLANS. THE CONTRACTOR SHALL EXERCISE EXTREME CAUTION DURING TRENCHING OPERATIONS TO AVOID DAMAGING THESE LINES AND CABLES. ANY UTILITIES DAMAGED SHALL BE REPLACED OR REPAIRED IMMEDIATELY AS DIRECTED BY THE ENGINEER AT THE CONTRACTOR'S EXPENSE. THE CONTRACTOR SHALL PROTECT FROM DAMAGE AND SUPPORT EXISTING UTILITIES THROUGH CONSTRUCTION AS APPROVED BY THE UTILITY OWNER AND THE ENGINEER AT THE CONTRACTOR'S EXPENSE. LOCATION INFORMATION HAS BEEN OBTAINED FROM THE VARIOUS UTILITY COMPANIES AND IS EITHER FROM COMPANY RECORD DRAWINGS OR COMPANY PROVIDED FIELD LOCATIONS. THE CONTRACTOR WILL BE REQUIRED TO WORK AROUND EXISTING UTILITIES WITHIN THE RIGHT-OF-WAY WHICH DO NOT CONFLICT WITH PROPOSED CONSTRUCTION.
  - RUBBLE FROM THE REMOVAL OF MISCELLANEOUS STRUCTURES AND EXCESS EXCAVATION WHICH IS TO BE WASTED SHALL BE DISPOSED OF ON SITES TO BE PROVIDED BY THE CONTRACTOR. THESE SITES SHALL BE APPROVED BY THE ENGINEER AS TO SUITABILITY, APPEARANCE AND SITE LOCATION. LOCATIONS, THAT IN THE OPINION OF THE ENGINEER, WILL LEAVE AN UNSIGHTLY APPEARANCE WILL NOT BE APPROVED. ALL DISPOSAL SITES MUST BE APPROVED BY THE KANSAS DEPARTMENT OF HEALTH AND ENVIRONMENT. MATERIAL EITHER STOCKPILED OR DISPOSED OF IN A FLOODPLAIN WOULD REQUIRE A KANSAS STATE BOARD OF AGRICULTURE PERMIT. ANY MATERIAL DUMPED IN WATERS OF THE UNITED STATES OR WETLANDS IS SUBJECT TO U.S. CORPS OF ENGINEERS PERMITTING REGULATIONS. ANY MATERIAL BURIED OR STOCKPILED BEYOND APPROVED CONSTRUCTION LIMITS WOULD REQUIRE ADDITIONAL ARCHAEOLOGICAL INVESTIGATIONS UNLESS BURIED IN A PREVIOUSLY APPROVED BORROW LOCATION.
  - PROPERTIES WITHIN THE PROJECT LIMITS MAY HAVE UNDERGROUND SPRINKLER SYSTEMS IN THE PUBLIC RIGHT-OF-WAY WHICH CONFLICT WITH NEW CONSTRUCTION. CONTRACTOR WILL BE REQUIRED TO REMOVE SUCH IMPROVEMENTS SHOULD THEY NOT BE REMOVED BY THEIR OWNER AT THE TIME OF CONSTRUCTION OF THE PROJECT. THE CONTRACTOR WILL BE REQUIRED TO SALVAGE ALL SPRINKLER HEADS AND/OR VALVES AND GIVE SUCH MATERIAL TO THEIR OWNER. PORTIONS OF UNDERGROUND SPRINKLER SYSTEMS NOT IN CONFLICT WITH NEW CONSTRUCTION SHALL BE PROTECTED FROM DAMAGE AND SHALL REMAIN IN PLACE. ALL WORK IN CONNECTION WITH UNDERGROUND SPRINKLER SYSTEMS SHALL BE CONSIDERED AS SUBSIDIARY TO THE CONTRACT PAY ITEMS OF WORK.
  - THE CONTRACTOR MUST EXAMINE THE CONSTRUCTION SITE PRIOR TO BIDDING AND BE SATISFIED AS TO THE WORK SHOWN FOR COMPLETION. AFTER BIDS HAVE BEEN RECEIVED, THE CONTRACTOR SHALL NOT ASSERT THAT THERE WAS A MISUNDERSTANDING OF THE QUANTITIES OF WORK OR OF THE NATURE FOR THE WORK TO BE COMPLETED.
  - THE CONTRACTOR SHALL NOTIFY THE INSPECTOR FOR THIS PROJECT 48 HOURS PRIOR TO BEGINNING CONSTRUCTION. THE CONTRACTOR SHALL NOT START WORK ON THE PROJECT UNTIL THE PROJECT INSPECTOR ASSIGNED TO THE PROJECT IS PRESENT ON SITE. ANY WORK DONE WITHOUT INSPECTION WILL BE REQUIRED TO BE UNCOVERED FOR INSPECTION.
  - THE CONTRACTOR SHALL GIVE ALL PROPERTY OWNERS AND/OR TENANTS OF DEVELOPED PROPERTY DIRECTLY ADJUTING THE CONSTRUCTION OF THIS PROJECT A MINIMUM OF TEN (10) DAYS ADVANCE NOTICE PRIOR TO START OF CONSTRUCTION.
  - THE CONTRACTOR SHALL BE RESPONSIBLE FOR PRESERVING PROPERTY IRONS. THE CONTRACTOR WILL BE REQUIRED TO REESTABLISH ANY PROPERTY IRONS WHICH ARE DAMAGED OR DESTROYED BY HIS CONSTRUCTION OPERATIONS SUCH IRONS SHALL BE REESTABLISHED BY A LICENSED LAND SURVEYOR IN ACCORDANCE WITH STATE LAWS.
  - SEEDING AND FERTILIZING OF ALL AREAS DISTURBED BY THE CONSTRUCTION OF THE WATERLINE & SANITARY SEWER AS SHOWN ON THE PLANS SHALL BE PAID FOR AS "SUBSIDIARY" TO "SITE CLEARING & RESTORATION".