

GENERAL GRADING NOTES:

1. A 6" (MAX. DEPTH) LAYER OF TOPSOIL SHALL BE STRIPPED TO A POINT AT LEAST 5' BEYOND THE AREA TO BE PAVED. TOPSOIL SHALL BE SEPARATELY STOCK PILED ON-SITE AT AN APPROVED LOCATION. TOPSOIL SHALL BE SPREAD IN PARKING LOT ISLANDS, AROUND BUILDINGS AND IN OTHER PLANTING AREAS AS DIRECTED BY LANDSCAPE ARCHITECT.
2. TOPSOIL SHALL BE REPLACED AT A DEPTH OF 6" UNLESS OTHERWISE NOTED. THE FINISHED GRADE INDICATES THE SURFACE ELEVATION AFTER THE TOPSOIL LAYER HAS BEEN PLACED.
3. THE CONTRACTOR SHALL BE RESPONSIBLE FOR PRESERVING PROPERTY IRONS. THE CONTRACTOR SHALL BE REQUIRED TO RE-ESTABLISH ANY PROPERTY IRONS WHICH ARE DAMAGED OR DESTROYED BY HIS CONSTRUCTION OPERATIONS. SUCH IRONS SHALL BE RE-ESTABLISHED BY A LICENSED LAND SURVEYOR IN ACCORDANCE WITH STATE LAWS.
4. CONTRACTOR SHALL NOTIFY UTILITY COMPANIES OF CONSTRUCTION SCHEDULING.
5. EXISTING UTILITIES AND THEIR LOCATIONS, AS SHOWN ON THE PLANS, REPRESENT THE BEST INFORMATION OBTAINABLE FOR DESIGN. LOCATION INFORMATION HAS BEEN OBTAINED FROM THE VARIOUS COMPANIES AND IS EITHER FROM COMPANY UTILITY DRAWINGS OR COMPANY PROVIDED FIELD LOCATIONS. THE PLAN LOCATIONS SHOWN ARE NOT GUARANTEED. ADDITIONAL EXISTING UTILITIES MAY ALSO BE ENCOUNTERED.

6. CONTRACTOR WILL BE REQUIRED TO PROVIDE A MINIMUM ADVANCE NOTICE OF SEVENTY-TWO (72) HOURS TO UTILITY COMPANIES PRIOR TO STARTING ANY EXCAVATION AS FOLLOWS:

KANSAS ONE-CALL 1-800-344-7233
or 687-2470 (LOCAL WICHITA)

THE CONTRACTOR MUST NOTIFY THE FOLLOWING IN CASE OF AN EMERGENCY:

SBC (TELEPHONE) 800-870-8390
COX COMMUNICATIONS (CABLE) 262-0661
KANSAS GAS SERVICE (GAS) 832-3101
CITY OF WICHITA WATER & SEWER 262-6000
WESTAR (ELECTRIC) 261-6512
AQUILA (GAS) 800-303-0357

7. RUBBLE FROM THE REMOVAL OF MISCELLANEOUS STRUCTURES AND EXCESS EXCAVATION WHICH IS TO BE WASTED SHALL BE DISPOSED OF ON SITES TO BE PROVIDED BY THE CONTRACTOR. THESE SITES SHALL BE APPROVED BY THE ENGINEER AS TO SUITABILITY, APPEARANCE AND SITE LOCATION. LOCATIONS THAT, IN THE OPINION OF THE ENGINEER, WILL LEAVE AN UNSIGHTLY APPEARANCE, WILL NOT BE APPROVED. ALL DISPOSAL SITES MUST BE APPROVED BY THE KANSAS DEPARTMENT OF HEALTH AND ENVIRONMENT. MATERIAL EITHER STOCKPILED OR DISPOSED OF IN A FLOOD PLAIN WOULD REQUIRE A KANSAS STATE BOARD OF AGRICULTURE PERMIT. ANY MATERIAL DUMPED IN WATERS OF THE UNITED STATES OR WETLANDS IS SUBJECT TO U.S. CORPS OF ENGINEERS PERMITTING REGULATIONS. ANY MATERIAL BURIED OR STOCKPILED BEYOND APPROVED CONSTRUCTION LIMITS WOULD REQUIRE ADDITIONAL ARCHAEOLOGICAL INVESTIGATIONS UNLESS BURIED IN A PREVIOUSLY APPROVED BORROW LOCATION.

8. ALL EXISTING TRASH/DEBRIS WITHIN THE CONSTRUCTION AREAS SHALL BE REMOVED AND DISPOSED OF ON SITES PROVIDED BY THE CONTRACTOR. THESE SITES SHALL BE APPROVED BY THE ENGINEER AND MEET THE REQUIREMENTS OF NOTE 7 ABOVE. THIS SHALL BE CONSIDERED SUBSIDIARY.

9. UNLESS OTHERWISE SPECIFIED, ALL CONSTRUCTION SHALL COMPLY WITH CITY OF WICHITA, KANSAS, STANDARD SPECIFICATIONS.

10. CONTRACTOR IS RESPONSIBLE FOR PROVIDING ALL SOILS TESTING AS REQUIRED BY THE CITY OF WICHITA.

11. FILL AREAS OUTSIDE OF AREAS TO BE PAVED ARE TO BE COMPACTED TO 90% STANDARD PROCTOR DENSITY.

12. ALL EXISTING TREES WITHIN AREAS TO BE PAVED SHALL BE REMOVED. EXISTING TREES OUTSIDE OF THE LIMITS OF PAVING SHALL BE SAVED AND PROTECTED FROM DAMAGE.

13. ALL DISTURBED AREAS TO BE SEEDDED WITH RYE GRASS AT A RATE OF 200 LBS. PER ACRE WITHIN 10 DAYS OF CONSTRUCTION. CONTRACTOR TO PREPARE GROUND PER CITY SPECIFICATIONS. COST IS SUBSIDIARY TO SITE PREPARATION AND RESTORATION.

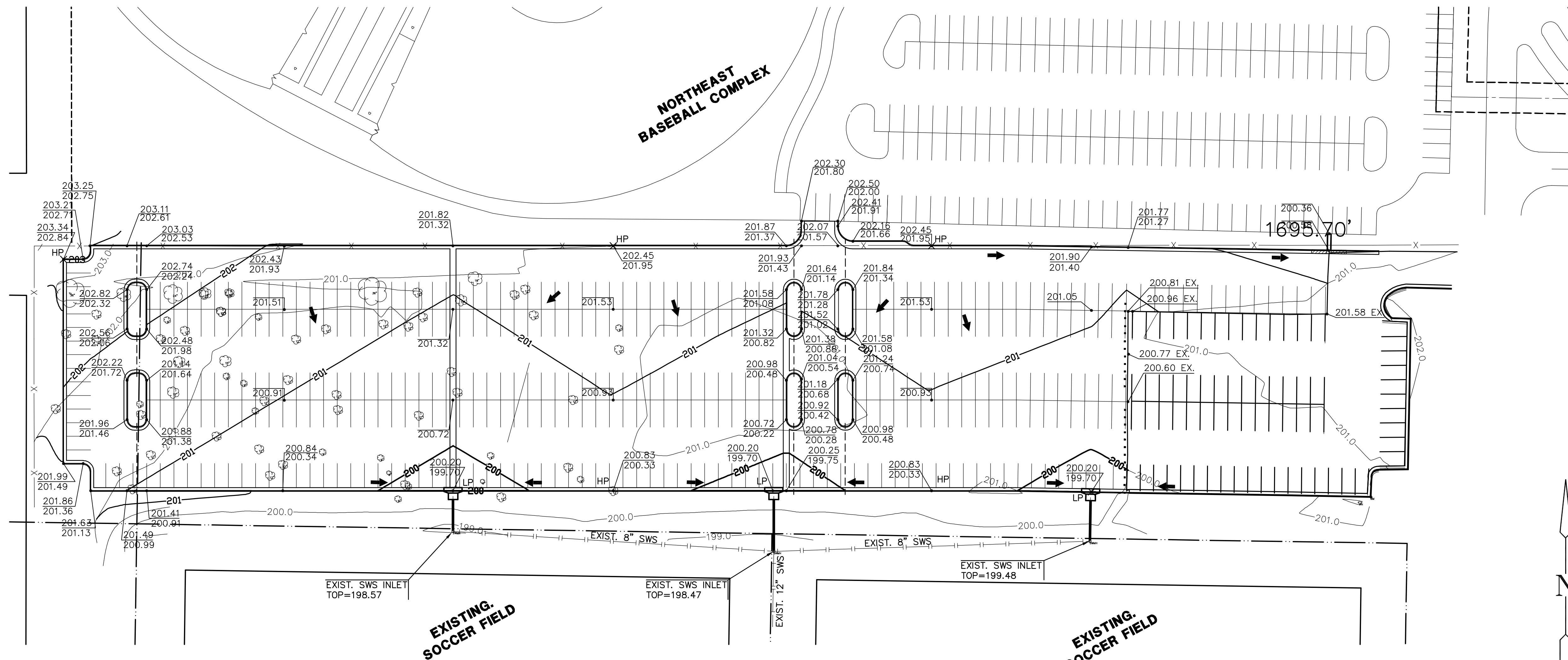

LEGEND

- | | | | |
|---|--|--|--|
| <ul style="list-style-type: none"> ● GM - GAS METER ⊙ 6IN - TREE AND DIAMETER ⊙ 3IN - TREE AND DIAMETER ⊙ SN - SIGN ⊙ IP - IRON BAR ○ - BUSH ■ PP - POWER POLE AND DEADMAN ■ KGE - ELECTRIC BOX | <ul style="list-style-type: none"> ● POLE - POLE ⊙ TRAF - TRAFFIC SIGNAL MANHOLE △ - SECTION CORNER ● LP - LIGHT POLE ● FH - FIRE HYDRANT ● WV - WATER VALVE ○ WM - WATER METER □ ICV - IRRIGATION CONTROL VALVE TR | <ul style="list-style-type: none"> — — — — — - EDGE OF TREES — — — — — - UNDERGROUND ELECTRIC LINE — x — x — - FENCE ⊙ BM - BENCHMARK ⊙ SWMH - STORM WATER MANHOLE ⊙ SSMH - SANITARY SEWER MANHOLE 200.83
200.33 - PROP. SPOT ELEVATION
TOP # INDICATES TOP OF FULL CURB (WHERE APPLICABLE)
BOTTOM # INDICATES FLOW LINE (WHERE APPLICABLE) | <ul style="list-style-type: none"> ⊞ - TELEPHONE RISER — — — — — - STORM SEWER PIPE — — — — — - WATER LINE — — — — — - SANITARY SEWER LINE — G — G — - GAS LINE — T — T — - TELEPHONE LINE □ - INLET ➔ - DIRECTION OF FLOW |
|---|--|--|--|

WEST PARKING LOT EXPANSION
STRYKER SOCCER COMPLEX
LOT 8, BLOCK 1 REGENCY PARK ADDITION

GRADING PLAN

07068

SRS

MKEC

MAB

CHECKED BY

ISSUED

JUNE 2007

REVISED

SHEET NO.

2 of 12