

STATE	PROJECT NO.	YEAR	SHEET NO.	TOTAL SHEETS
KANSAS	87 N-0357-01	2008	34	185

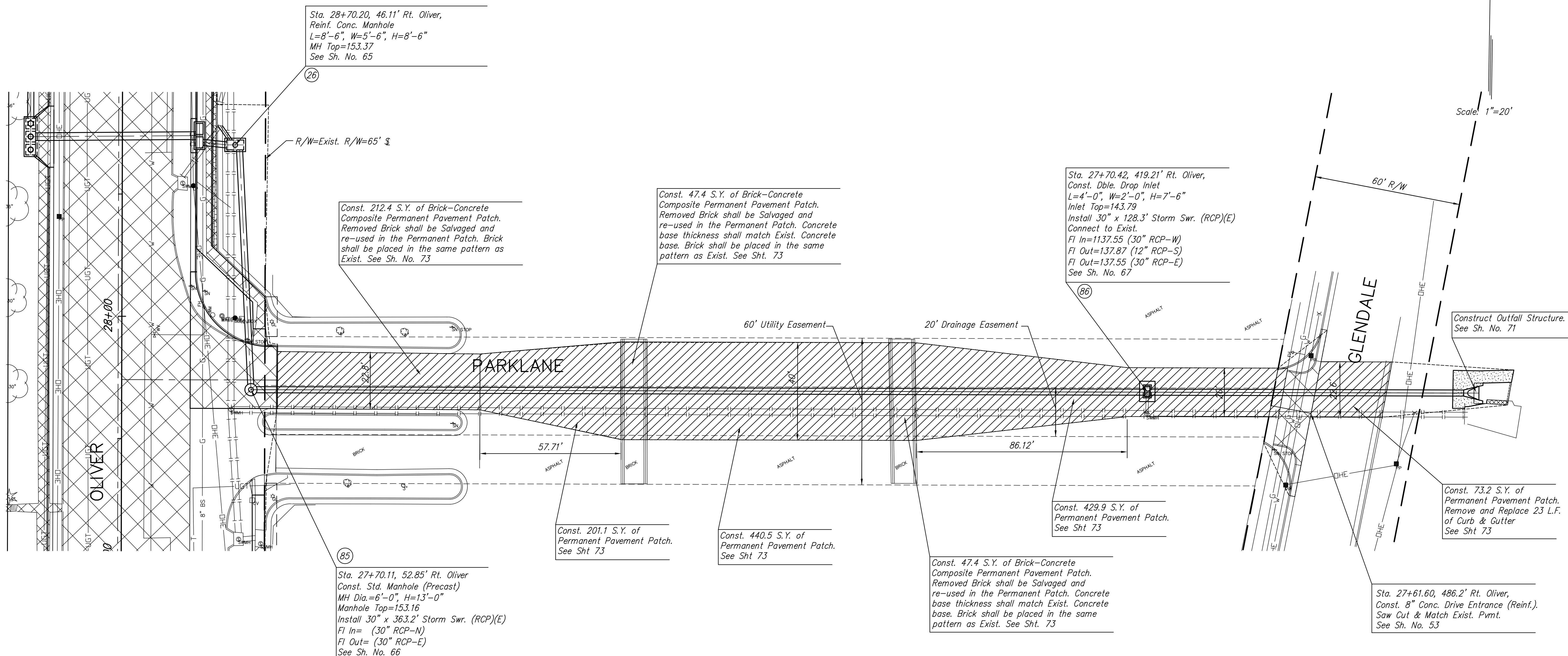

Sta. 28+70.20, 46.11' Rt. Oliver,  
Reinf. Conc. Manhole  
L=8'-6", W=5'-6", H=8'-6"  
MH Top=153.37  
See Sh. No. 65

(26)

R/W=Exist. R/W=65' §

Const. 212.4 S.Y. of Brick-Concrete  
Composite Permanent Pavement Patch.  
Removed Brick shall be Salvaged and  
re-used in the Permanent Patch. Brick  
shall be placed in the same pattern as  
Exist. See Sh. No. 73

Const. 47.4 S.Y. of Brick-Concrete  
Composite Permanent Pavement Patch.  
Removed Brick shall be Salvaged and  
re-used in the Permanent Patch. Concrete  
base thickness shall match Exist. Concrete  
base. Brick shall be placed in the same  
pattern as Exist. See Sht. 73

Sta. 27+70.42, 419.21' Rt. Oliver,  
Const. Dble. Drop Inlet  
L=4'-0", W=2'-0", H=7'-6"  
Inlet Top=143.79  
Install 30" x 128.3' Storm Swr. (RCP)(E)  
Connect to Exist.  
FI In=1137.55 (30" RCP-W)  
FI Out=137.87 (12" RCP-S)  
FI Out=137.55 (30" RCP-E)  
See Sh. No. 67

(86)

Scale: 1"=20'

Construct Outfall Structure.  
See Sh. No. 71

Const. 73.2 S.Y. of  
Permanent Pavement Patch.  
Remove and Replace 23 L.F.  
of Curb & Gutter  
See Sht 73

Sta. 27+61.60, 486.2' Rt. Oliver,  
Const. 8" Conc. Drive Entrance (Reinf.).  
Saw Cut & Match Exist. Pmnt.  
See Sh. No. 53

(85)

Sta. 27+70.11, 52.85' Rt. Oliver  
Const. Std. Manhole (Precast)  
MH Dia.=6'-0", H=13'-0"  
Manhole Top=153.16  
Install 30" x 363.2' Storm Swr. (RCP)(E)  
FI In= (30" RCP-N)  
FI Out= (30" RCP-E)  
See Sh. No. 66

Const. 201.1 S.Y. of  
Permanent Pavement Patch.  
See Sht 73

Const. 440.5 S.Y. of  
Permanent Pavement Patch.  
See Sht 73

Const. 47.4 S.Y. of Brick-Concrete  
Composite Permanent Pavement Patch.  
Removed Brick shall be Salvaged and  
re-used in the Permanent Patch. Concrete  
base thickness shall match Exist. Concrete  
base. Brick shall be placed in the same  
pattern as Exist. See Sht. 73

**LEGEND**

- Remove Tree
- Pavement Removal
- 2" Pavement Milling & Overlay
- Pavement Widening
- Permanent Pavement Patch

NOTE:  
Contractor to contact Parklane Shopping Center  
Owner prior to construction on Parklane Property.  
City to provide Contact information.

J:\Civil\04221\dwg\pav\04221\_e14.dwg 06/09/2008 04:49:58 PM CST  
KANSAS DEPARTMENT OF TRANSPORTATION  
**OLIVER IMPROVEMENTS  
PARKLANE STORM SEWER**  
PROJECT NO. 87 N-0357-01 SEDGWICK CO.  
**M K E C ENGINEERING CONSULTANTS, INC.**  
WICHITA, KANSAS

DESIGNED BY: LAC	CHECKED BY: JRA
DRAWN BY: WNJ	DATE: 4/07/05 SHEET 34 OF 185