

STATE	PROJECT NO.	YEAR	SHEET NO.	TOTAL SHEETS
KANSAS	87 N-0357-01	2008	41	185

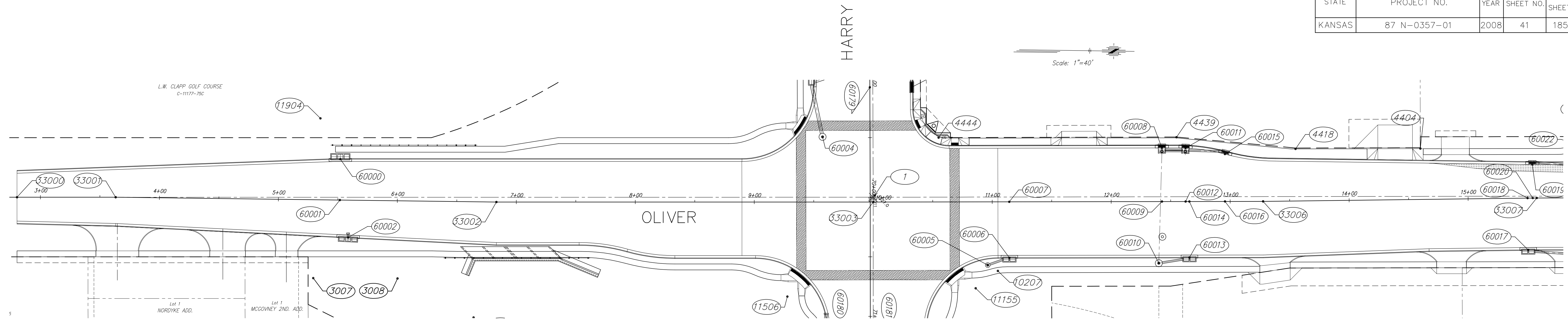

CONTROL TABLE

POINT NUMBER	STATION	OFFSET	NORTHING	EASTING	DESC
1	10+01.36/69+98.40	5.60' LT/1.38' LT	1678234.2200	1665529.6600	CALC
26	2+80.30	0.00	1683987.1700	1670704.4000	SD M.J.H.26
70	50+70.78 (HARRY)	51.10' RT	1678147.3400	1663610.2800	SD M.J.H.70
102	36+77.09	523.43' RT	1680918.2200	1666022.0900	SDMD
103	30+36.64	577.56' RT	1680278.4600	1666077.9100	SDMD
104	62+99.74	8.42' LT	1683531.4800	1665446.0500	SD 1/2" PEC
202	42+80.45	28.22' LT	1681511.5200	1665453.9100	SDMD
205	22+43.95	34.22' RT	1679477.2300	1665547.2200	SDMD
1000	36+09.02	554.00' RT	1680850.3600	1666048.7300	SD COW DISC
1001	60+78.33	35.38' RT	1683310.8080	1665493.4540	NAIL
1002	56+52.85	67.84' LT	1682883.7930	1665388.7420	BM 8
1077	59+45.57	47.72' RT	1683175.8180	1665502.0850	PKN
1317	56+07.62	50.91' LT	1682838.8430	1665406.4030	SD 5/8" GOEDEKE
1649	52+56.29	28.51' RT	1682488.8560	1665491.5320	NAIL
1787	51+27.55	49.71' LT	1682358.8540	1665415.4090	SD 1/2" BAR
1897	49+45.67	39.29' RT	1682178.4450	1665507.3630	NAIL
2045	49+93.15	52.51' LT	1682224.4250	1665414.8010	BM 7
2320	47+32.01	39.84' LT	1681963.5310	1665431.7170	SD 1" PIPE
2656	43+32.23	56.59' LT	1681561.9830	1665423.2620	BM 6
2758	40+37.66	25.46' RT	1681270.2680	1665516.0950	NAIL
2942	38+12.32	45.00' RT	1681045.0050	1665536.5160	SD 3/4" PIPE
2987	37+04.35	43.57' RT	1680937.5790	1665536.8340	BM 1 CITY
3321	33+70.95	30.64' RT	1680604.0310	1665525.7220	NAIL
3976	19+41.85	28.60' RT	1679175.0750	1665546.4010	NAIL
4404	14+60.42	42.68' LT	1678692.1390	1665483.8600	SD 1/2" SAVOY
4418	13+55.48	43.69' LT	1678587.2030	1665485.6510	SD 1/2" SAVOY
4439	12+54.97	53.98' LT	1678487.0260	1665477.2540	SD 1/2" SAVOY
4444	10+55.02	53.96' LT	1678287.1010	1665480.4540	NAIL
10206	16+10.40	32.26' LT	1678842.7000	1665490.8300	SDMD
10207	11+04.66	58.03' RT	1678338.5200	1665591.6400	SDMD
11123	75+67.41	35.39' RT	1678205.8600	1666099.1490	NAIL
11155	10+85.96	72.56' RT	1678320.0480	1665606.4630	NAIL
11506	9+27.84	79.37' RT	1678161.9290	1665615.6710	NAIL
11692	6+65.32	97.18' RT	1677898.4710	1665637.0180	NAIL
11763	4+12.59	33.79' RT	1677645.6300	1665574.0830	NAIL
11904	5+34.47	68.40' LT	1677767.3300	1665471.6720	NAIL
12168	64+58.27	1.67' RT	1678221.4890	1664989.6710	NAIL
12294	65+98.87	4.91' RT	1678220.7700	1665130.2980	NAIL
12331	67+75.40	57.06' RT	1678171.7900	1665307.7390	NAIL
22518	46+13.02	30.11' RT	1681845.6890	1665503.5900	NAIL
22545	44+55.75	24.72' RT	1681688.3600	1665500.7600	NAIL
22566	71+36.14	76.85' LT	1678311.7260	1665666.2690	NAIL
22568	49+92.98	26.25' RT	1682225.5440	1665493.5580	NAIL
80001	30+13.95	64.88' RT	1680247.6227	1665565.6319	BM 2
80002	20+57.23	65.45' RT	1679291.0352	1665581.4131	BM 3
80003	16+44.38	63.44' LT	1678876.1850	1665459.1000	BM 4

STORM SEWER TABLE

POINT NUMBER	STATION	OFFSET	NORTHING	EASTING	DESC
60000	5+51.65	34.36' LT	1677784.5710	1665505.6820	SWS
60001	5+51.65	0.00' LT	1677784.6324	1665540.0396	BL Proj
60002	5+59.01	31.33' RT	1677792.0476	1665571.3527	sws
60003	5+59.01	0.00' RT	1677791.9916	1665540.0265	BL Proj
60004	69+49.16	39.89' RT	1678189.5671	1665481.1896	sws-mh
60005	10+96.16	53.11' RT	1678329.9381	1665586.8563	sws-mh
60006	11+14.35	47.00' RT	1678348.0348	1665580.4554	sws
60007	11+14.35	0.00' RT	1678347.2876	1665533.4613	BL Proj
60008	12+42.68	45.00' LT	1678474.8847	1665486.4269	sws
60009	12+42.68	0.00' LT	1678475.6001	1665531.4212	BL Proj
60010	12+39.93	51.76' RT	1678473.6736	1665583.2147	sws-mh
60011	12+62.55	44.86' LT	1678494.7492	1665486.2478	sws
60012	12+62.55	0.00' LT	1678495.4624	1665531.1054	BL Proj
60013	12+65.72	47.00' RT	1678499.3808	1665578.0491	sws
60014	12+65.72	0.00' RT	1678498.6336	1665531.0550	BL Proj
60015	12+95.67	39.78' LT	1678527.9425	1665490.8021	sws
60016	12+95.67	0.00' LT	1678528.5749	1665530.5790	BL Proj
60017	15+49.98	43.50' RT	1678783.9686	1665567.6048	sws
60018	15+49.98	0.00' RT	1678782.8044	1665524.1205	BL Proj
60019	15+54.31	28.12' LT	1678786.3777	1665495.8916	sws
60020	15+54.31	0.00' LT	1678787.1304	1665524.0046	BL Proj
60021	16+11.85	26.00' LT	1678844.2568	1665497.0559	sws-mh
60022	16+12.06	38.75' LT	1678844.2566	1665484.3090	sws-mh

J:\Civil\04221\dwg\Sws\04221-BUBBLE-SWS.dwg 06/26/2007 02:28:14 PM CST

KANSAS DEPARTMENT OF TRANSPORTATION  
 OLIVER IMPROVEMENTS  
 STORM SEWER BUBBLE MAP  
 STA. 2+80 TO STA. 15+50  
 PROJECT NO. 87 N-0357-01 SEDGWICK CO.

M K E C ENGINEERING CONSULTANTS, INC.  
 WICHITA, KANSAS

DESIGNED BY: LAC	CHECKED BY: JRA
DRAWN BY: WNJ	DATE: 4/07/05 SHEET 41 OF 185