

NOTE: REMOVE EXISTING PAVEMENT AND FENCE AS REQUIRED FOR CONSTRUCTION.

**LINE 1**

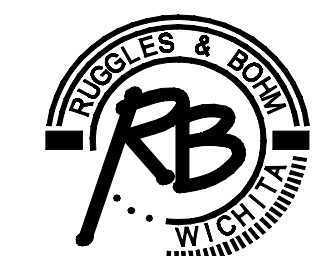
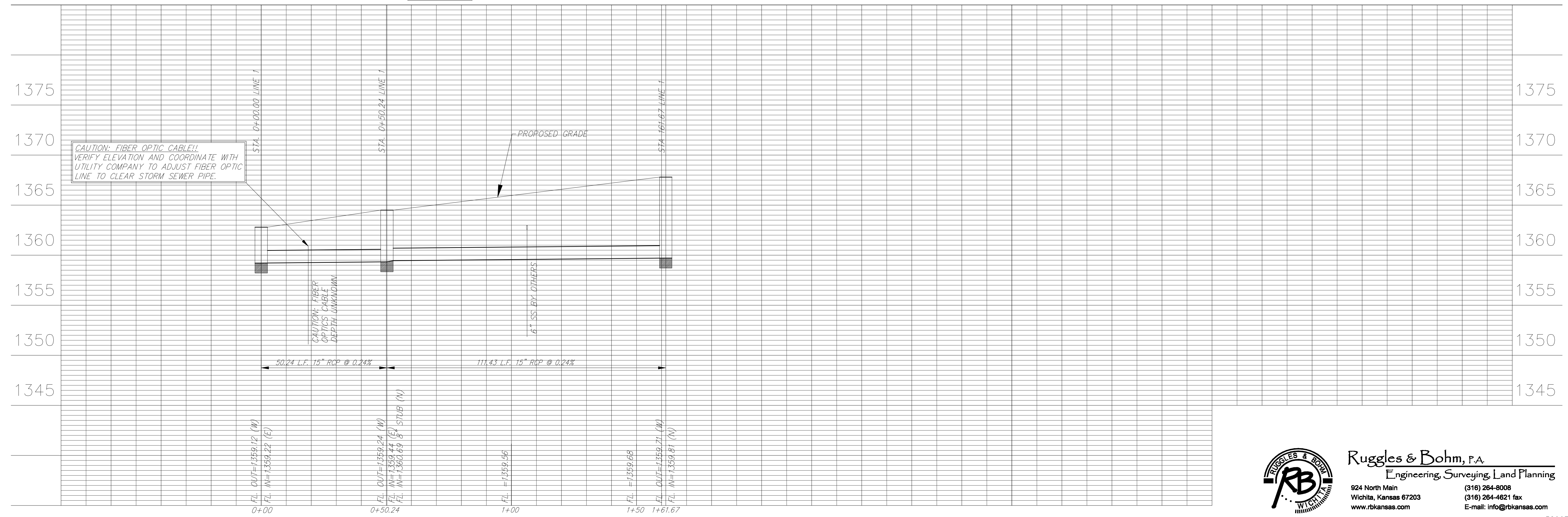

**Ruggles & Bohm, P.A.**  
 Engineering, Surveying, Land Planning  
 924 North Main  
 Wichita, Kansas 67203  
 www.rbkansas.com  
 (316) 264-8008  
 (316) 264-4621 fax  
 E-mail: info@rbkansas.com

**CONSULTING ENGINEERS**

**ELECTRICAL:**  
 TENNELL & ASSOCIATES  
 177 CHESTERFIELD AND PKWY  
 CHESTERFIELD, MISSOURI, 63005  
 C: DANA TENNELL  
 P: (636) 857-3999

**PLUMBING:**  
 RUGGLES & BOHM P.A.  
 WICHITA, KANSAS, 67203  
 C: TOM RUGGLES - P: (316) 264-8008  
 P: (316) 264-4621

**FIRE PROTECTION:**  
 TENNELL & ASSOCIATES  
 177 CHESTERFIELD AND PKWY  
 CHESTERFIELD, MISSOURI, 63005  
 C: DANA TENNELL  
 P: (636) 857-3999

**CONTRACTOR:**  
 CONROD & ASSOCIATES  
 CONSTRUCTION CO., INC.  
 WICHITA, KANSAS, 67277  
 P: (316) 692-0257

**ARCHITECT: GMA DESIGN GROUP INC.**  
 ARCHITECTURAL DESIGN SERVICES  
 A DIVISION OF ARCO NATIONAL CONSTRUCTION  
 1100 SOUTH WHERSTWOOD BLVD SUITE 807 ST. LOUIS, MISSOURI 63144  
 PHONE: 314-624-1771 FAX: 314-624-7278

PROPOSED BUILDING FOR:  
**FlightSafety<sup>®</sup>**  
 International  
 9720 EAST CENTRAL AVENUE  
 WICHITA, KANSAS

I CERTIFY TO THE BEST OF MY KNOWLEDGE THAT THE DRAWINGS & SPECIFICATIONS COMPLY WITH THE APPLICABLE MINIMUM BUILDING CODES.

JOB NO :  
 SJ0717  
 DRAWN BY :  
 PSB  
 ISSUE DATE :  
 3-3-08

REVISIONS	DATE
1	
2	
3	
4	
5	

SHEET NUMBER  
 PPS-2