

**GENERAL NOTES**

- ALL ELEVATIONS SHOWN ARE BASED ON NAVD88 DATUM.
- THE CONTRACTOR SHALL CONTACT THE FOLLOWING AT LEAST 72 HOURS PRIOR TO BEGINNING CONSTRUCTION:  
DOUG ARVIDSON  
FLOOD CONTROL/STORM WATER SUPERVISOR  
DEPARTMENT OF PUBLIC WORKS - CITY OF WICHITA  
1801 S. McLEAN BLVD.  
WICHITA, KANSAS 67213  
(316) 268-4090
- ALL CONSTRUCTION AND MATERIALS TO COMPLY WITH CITY OF WICHITA SPECIFICATIONS AND STANDARDS.
- AT LEAST 72 HOURS PRIOR TO BEGINNING EXCAVATION (EXCLUDING WEEKENDS AND HOLIDAYS), THE CONTRACTOR SHALL CONTACT THE KANSAS ONE-CALL SYSTEM, A UTILITY LOCATION SERVICE, AT (316) 687-2470 TO REQUEST THE LOCAL UTILITY COMPANIES TO LOCATE ANY EXISTING LINES WITHIN THE PROJECT AREA.
- THE CONTRACTOR SHALL NOT START WORK ON THE PROJECT UNTIL THE PROJECT INSPECTOR IS ASSIGNED TO THE PROJECT AND IS PRESENT ON THE SITE. ANY WORK DONE WITHOUT INSPECTION WILL BE REQUIRED TO BE UNCOVERED FOR INSPECTION.
- THE EXISTING UTILITIES (SEWER, ELECTRICAL, ETC.) AS LOCATED ON THE PLANS ARE APPROXIMATE LOCATIONS ONLY. OTHER BURIED LINES AND CABLES MAY EXIST THAT ARE NOT SHOWN ON THESE PLANS. THE CONTRACTOR SHALL EXERCISE EXTREME CAUTION DURING TRENCHING OPERATIONS TO AVOID DAMAGING THESE LINES. IF ANY LINES OR CABLES ARE DAMAGED BY THE CONTRACTOR, THEY SHALL BE REPLACED BY THE CONTRACTOR AT THE CONTRACTOR'S EXPENSE.
- THE CONTRACTOR SHALL CONTAIN HIS OPERATIONS TO PERMIT TRAFFIC THROUGH AND ACROSS CONSTRUCTION AT EXISTING ROADWAYS AT ALL TIMES. THE CONTRACTOR SHALL ERECT WARNING SIGNS, FLASHING LIGHTS, AND BARRICADES IN COMPLIANCE WITH THE MANUAL ON UNIFORM TRAFFIC CONTROL DEVICES TO ENSURE SAFETY AS DIRECTED IN THE GENERAL CONDITIONS. THE CONTRACTOR SHALL LIMIT THE EXTENT OF TRENCH TO REMAIN OPEN OVERNIGHT AND WEEKENDS TO LESS THAN 50 FEET.
- THE CONTRACTOR SHALL OBTAIN ALL LOCAL, COUNTY, STATE AND FEDERAL PERMITS AS REQUIRED.
- THE CONTRACTOR SHALL PROVIDE EROSION PROTECTION IN ACCORDANCE WITH THE CITY OF WICHITA BEST MANAGEMENT PRACTICES. COST SHALL BE SUBSIDIARY TO STORMWATER IMPROVEMENTS LUMP SUM BID.
- THE CONTRACTOR SHALL RESTORE ALL DITCHES, SWALES, ROAD SHOULDERS, AND BANKS TO THEIR ORIGINAL SLOPES AND GRADES. WHERE EXISTING ENTRANCE PIPE, DRAINAGE PIPE, SIGNS, FENCES, ETC., CONFLICT WITH THE PROPOSED WORK HEREIN, THEY SHALL BE REMOVED AND REPLACED OR RESET UNLESS OTHERWISE INDICATED ON THE PLANS. REPLACEMENT OF ALL THE AFOREMENTIONED ITEMS, INCLUDING SEEDING, FERTILIZER, AND MULCHING SHALL BE CONSIDERED SUBSIDIARY TO STORMWATER IMPROVEMENTS LUMP SUM BID.
- THE CONTRACTOR SHALL GIVE ALL PROPERTY OWNERS AND/OR TENANTS OF DEVELOPED PROPERTY ABUTTING THE CONSTRUCTION OF THIS PROJECT A MINIMUM OF TEN (10) DAYS ADVANCE NOTICE PRIOR TO START OF CONSTRUCTION.
- THE CONTRACTOR SHALL BE RESPONSIBLE FOR PRESERVING EXISTING PROPERTY LINES AND RIGHT-OF-WAY MONUMENTS. THE CONTRACTOR SHALL BE REQUIRED TO RE-ESTABLISH ANY PROPERTY IRONS OR RIGHT-OF-WAY MONUMENTS WHICH ARE DAMAGED OR DESTROYED BY HIS CONSTRUCTION OPERATIONS. SUCH IRONS OR MONUMENTS SHALL BE RE-ESTABLISHED BY A LICENSED LAND SURVEYOR IN ACCORDANCE WITH STATE LAW.
- WHERE REMOVAL OF EXISTING FENCES PARALLEL TO THE CONSTRUCTION IS DEEMED NECESSARY BY THE CONTRACTOR, THE CONTRACTOR SHALL COORDINATE REMOVAL WITH ADJACENT PROPERTY OWNERS. ALL REMOVAL AND RESETING OF FENCES WILL NOT BE PAID FOR SEPARATELY.
- SEEDING. ALL AREAS DISTURBED BY CONSTRUCTION SHALL BE REPLANTED PER CITY OF WICHITA STANDARD SPECIFICATIONS, WITH THE FOLLOWING MODIFICATIONS:  

SEED	APPLICATION RATE	FERTILIZER	APPLICATION RATE	MULCHING TYPE
K31 FESCUE	80 LBS PLS/ACRE	16-20-0	200 LBS/ACRE	HAY
SMOOTH BROMEGRASS	10 LBS PLS/ACRE	10-20-10	200 LBS/ACRE	HAY

SEEDING SEASON SHALL MATCH CITY OF WICHITA STANDARD SPECIFICATIONS FOR FESCUE SEED.
- POSITIVE DRAINAGE SHALL BE PROVIDED FOR ALL AREAS ON OR NEAR WASTE OR BORROW AREAS. NATURAL DRAINAGE WAYS SHALL BE MAINTAINED.
- EACH BIDDER SHALL VISIT THE SITE OF THE PROJECT BEFORE SUBMITTING THE PROPOSAL FOR THIS WORK SO THAT HE WILL BE FULLY INFORMED OF THE EXISTING FIELD CONDITIONS AND THE OBSTACLES WHICH MIGHT BE ENCOUNTERED. UPON AWARD OF THE CONTRACT, THE CONTRACTOR WILL NOT BE GRANTED ANY ADDITIONAL COMPENSATION WITH REGARDS TO TIME AND MONEY FOR CONDITIONS THAT MAY HAVE BEEN EVALUATED DURING INSPECTION OF THE SITE.

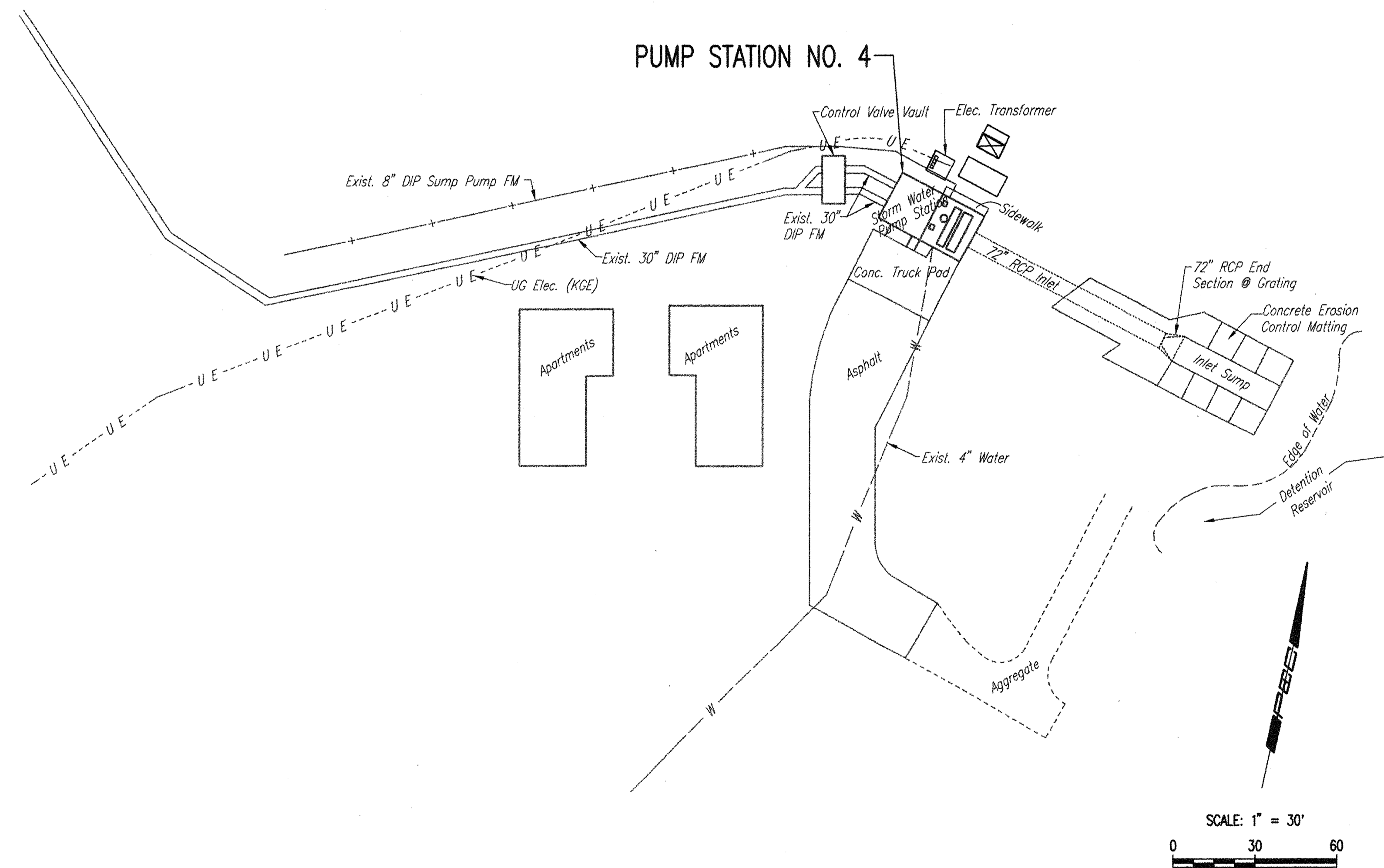
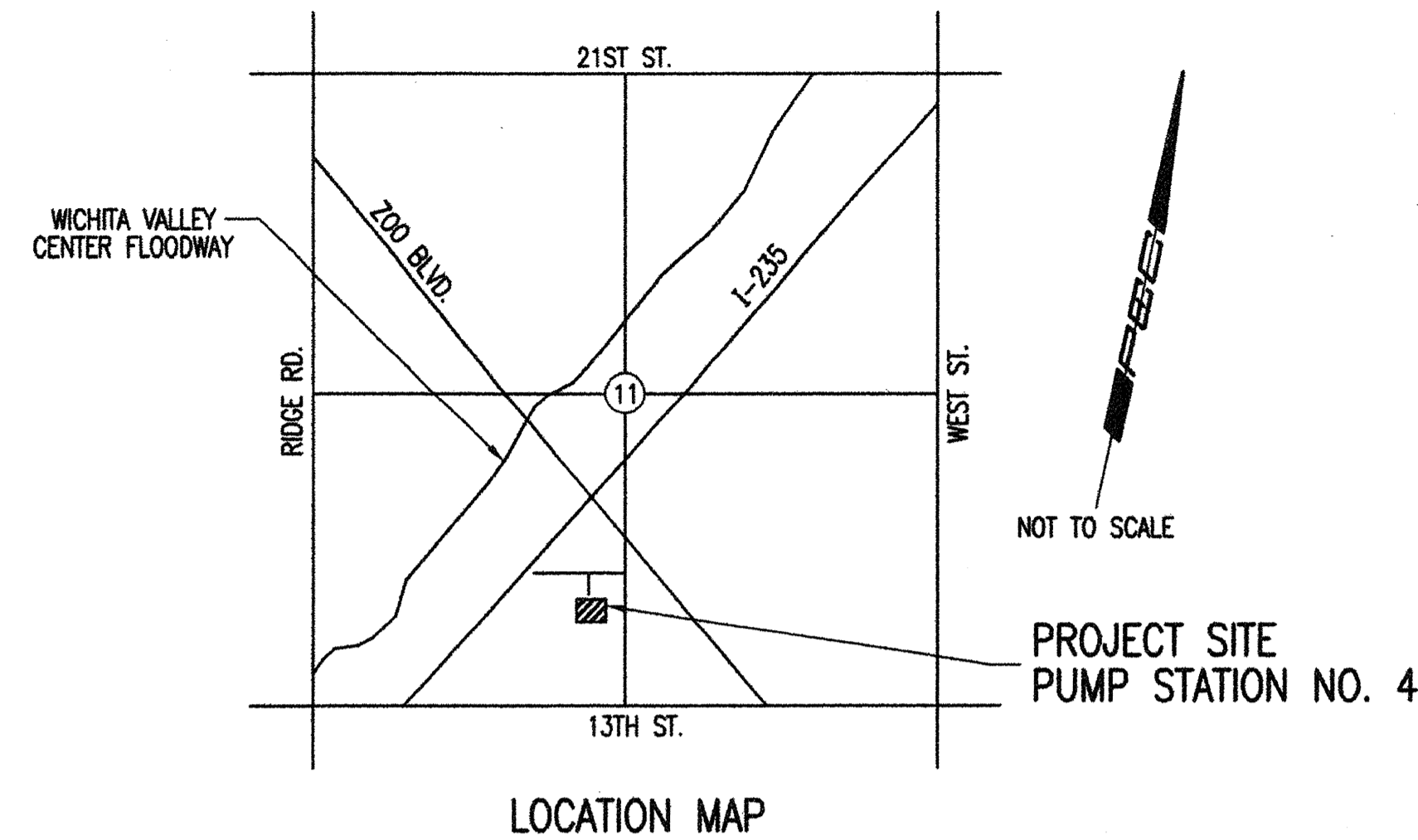

Saved: 09-09-2008 12:00:30 PM by CAL  
 Plot Scale: 1:30 09-11-2008 1:38:08 PM  
 C:\2008\06060\SW PS #4 Sept 09\06060-001-C1 Keymap.P54

	Revision		By	Date
	CITY OF WICHITA, KANSAS <b>PUMP STATION NO. 4</b> <b>KEYMAP AND GENERAL NOTES</b> STORMWATER SYSTEM IMPROVEMENTS			
	<b>Professional Engineering Consultants, P.A.</b> 303 S. TOPEKA • WICHITA, KANSAS 67202 316-262-2691 • FAX 316-262-3003			
	Designed by	KLR, EJJ	Job No.	34-06060-042
Drawn by	BB	Date	SEPTEMBER 2008	