

**THE MOORINGS TENTH ADDITION**

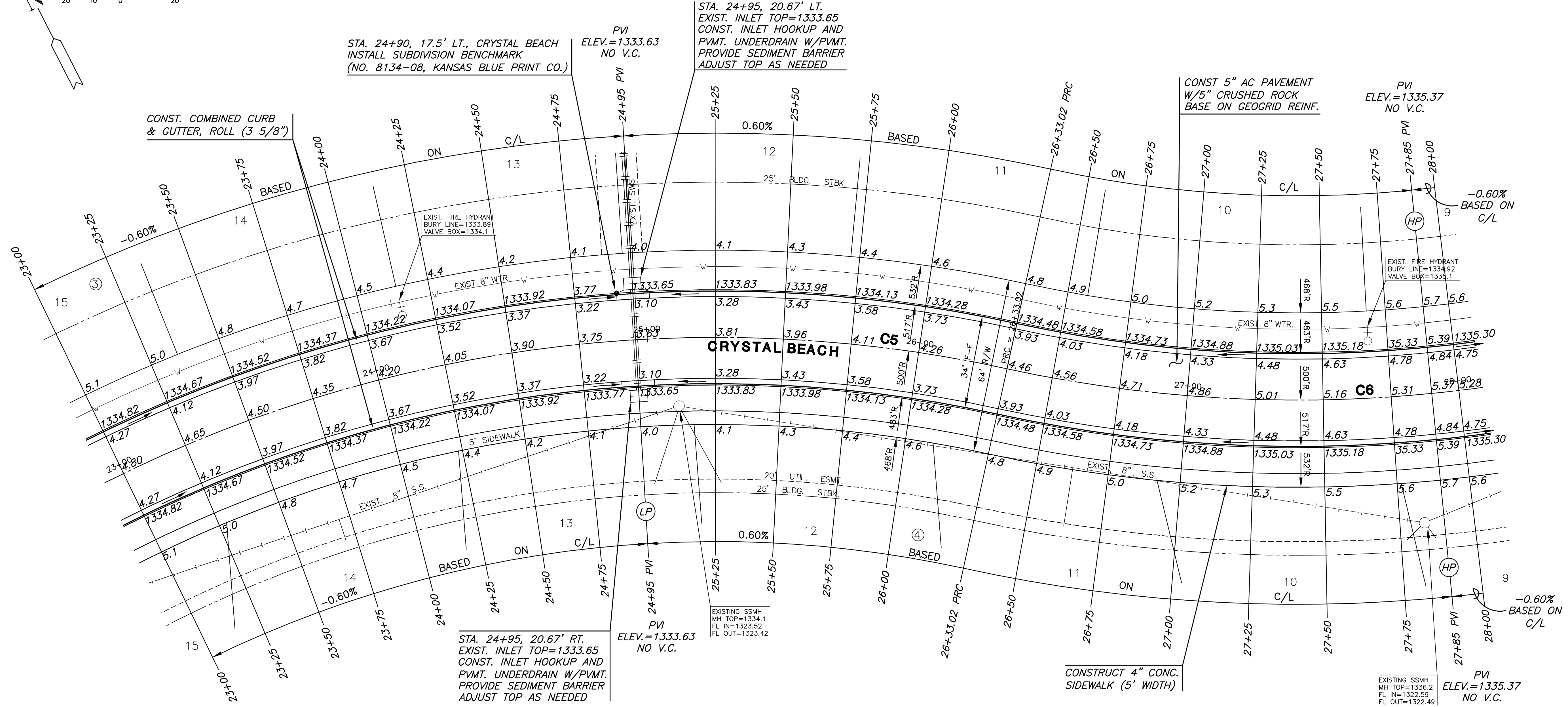
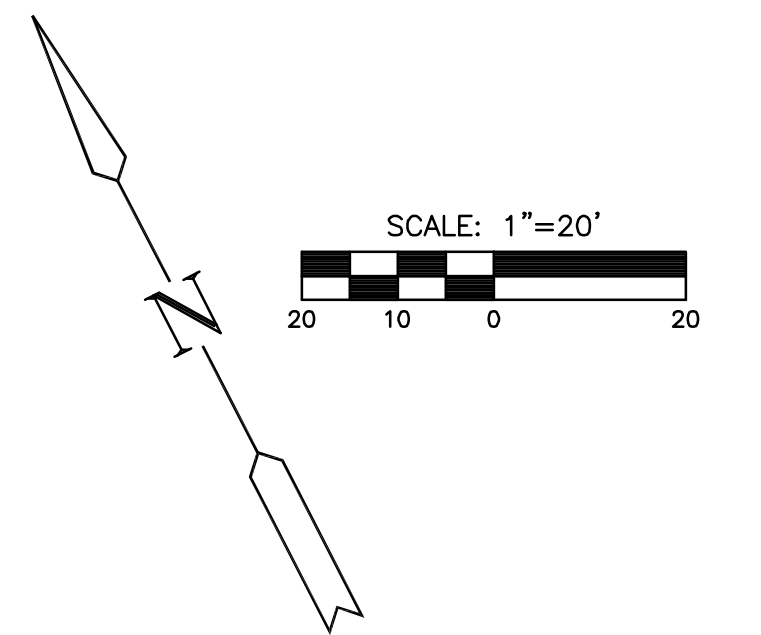

**THE MOORINGS TENTH ADDITION**

**CURVE TABLE - C5**

$\Delta = 42^{\circ}59'03''$  R = 500.00' T = 196.88' L = 375.11' LC = 366.37'

CURVE DATA BASED ON CENTERLINE  $\Delta / 2 = 21^{\circ}29'32''$

STATION	ARC	8' Off LtCb	8' Off RtCb	DEFLECTION	TOTAL DEFLECTION
22+57.91	-	-	-	00'00'00"	00'00'00"
22+75.00	17.09'	17.94'	16.23'	00'58'45"	00'58'45"
23+00.00	25.00'	26.25'	23.75'	01'25'57"	02'24'42"
23+25.00	25.00'	26.25'	23.75'	01'25'57"	03'50'38"
23+50.00	25.00'	26.25'	23.75'	01'25'57"	05'16'35"
23+75.00	25.00'	26.25'	23.75'	01'25'57"	06'42'32"
24+00.00	25.00'	26.25'	23.75'	01'25'57"	08'08'28"
24+25.00	25.00'	26.25'	23.75'	01'25'57"	09'34'25"
24+50.00	25.00'	26.25'	23.75'	01'25'57"	11'00'21"
24+75.00	25.00'	26.25'	23.75'	01'25'57"	12'26'18"
25+00.00	25.00'	26.25'	23.75'	01'25'57"	13'52'15"
25+25.00	25.00'	26.25'	23.75'	01'25'57"	15'18'11"
25+50.00	25.00'	26.25'	23.75'	01'25'57"	16'44'08"
25+75.00	25.00'	26.25'	23.75'	01'25'57"	18'10'05"
26+00.00	25.00'	26.25'	23.75'	01'25'57"	19'36'01"
26+25.00	25.00'	26.25'	23.75'	01'25'57"	21'01'58"
26+33.02	8.02'	8.42'	7.62'	00'27'34"	21'29'32"

Def/Ft = 3.43775 Min.

**CURVE TABLE - C6**

$\Delta = 44^{\circ}44'45''$  R = 500.00' T = 205.81' L = 390.48' LC = 380.63'

CURVE DATA BASED ON CENTERLINE  $\Delta / 2 = 22^{\circ}22'23''$

STATION	ARC	8' Off LtCb	8' Off RtCb	DEFLECTION	TOTAL DEFLECTION
26+33.02	-	-	-	00'00'00"	00'00'00"
26+50.00	16.98'	16.13'	17.83'	00'58'22"	00'58'22"
26+75.00	25.00'	23.75'	26.25'	01'25'57"	02'24'19"
27+00.00	25.00'	23.75'	26.25'	01'25'57"	03'50'16"
27+25.00	25.00'	23.75'	26.25'	01'25'57"	05'16'12"
27+50.00	25.00'	23.75'	26.25'	01'25'57"	06'42'09"
27+75.00	25.00'	23.75'	26.25'	01'25'57"	08'08'05"
28+00.00	25.00'	23.75'	26.25'	01'25'57"	09'34'02"
28+25.00	25.00'	23.75'	26.25'	01'25'57"	10'59'59"
28+50.00	25.00'	23.75'	26.25'	01'25'57"	12'25'55"
28+75.00	25.00'	23.75'	26.25'	01'25'57"	13'51'52"
29+00.00	25.00'	23.75'	26.25'	01'25'57"	15'17'49"
29+25.00	25.00'	23.75'	26.25'	01'25'57"	16'43'45"
29+50.00	25.00'	23.75'	26.25'	01'25'57"	18'09'42"
29+75.00	25.00'	23.75'	26.25'	01'25'57"	19'35'38"
30+00.00	25.00'	23.75'	26.25'	01'25'57"	21'01'35"
30+23.50	23.50'	22.32'	24.67'	01'20'47"	22'22'23"

Def/Ft = 3.43775 Min.

**LEGEND**

⊕ STREET SIGN & SIGN LOCATION  
(SEE SIGN ASSEMBLY TABLE  
FOR TYPE & STATION OF SIGN)

NOTE:  
TOP OF CURB ELEVATIONS SHOWN  
ARE FOR FULL CURB. CONSTRUCT  
CURB AND GUTTER AS NOTED.

PLOTTED: Tuesday, November 25, 2008 @ 09:23AM

J:\CIVIL\06608\DWG\PAV\MOORINGS\_10TH\06608E4.DWG