

UNLESS OTHERWISE NOTED, ELEVATIONS SHOWN ARE TO TOP OF PIPE

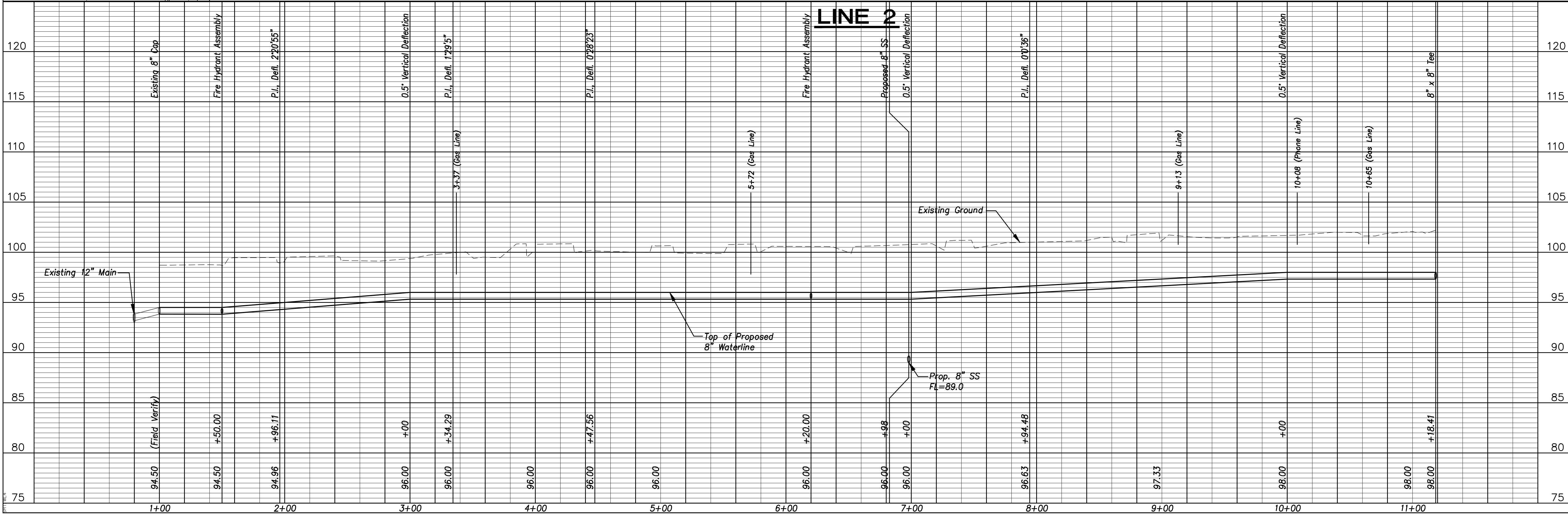

DATE: _____ BY: _____ APPROVED: _____
 OATVILLE ADDITION
 WATER DISTRIBUTION SYSTEM IMPROVEMENTS
 LINE 2
 CITY OF WICHITA, KANSAS
 JAMES ARMOUR, P.E. - CITY ENGINEER
 Proj.# 448-90072 O.C.A.# 73264

FINAL
 Designed By: J. Dickman
 Drawn By: M. Tucker
 P.O. Job No.: 1805A
 Date: May 2008
 Sheet 7 of 15

POE & ASSOCIATES, INC.
 CONSULTING ENGINEERS
 5940 E. Central, Suite 200 • Wichita, KS 67208-4242
 Phone 316/685-4114 • FAX 316/685-4444