

# PRIVATE FIRE SERVICE

## TO SERVE GREAT PLAINS TRANSPORTATION MUSEUM

### PRIVATE PROJECT NUMBER 1281 PPW (607853)

#### GENERAL NOTES

1. Contractor will be required to provide a minimum notice of 48 hours to utility companies prior to starting any excavation as follows:
 

Kansas One-Call	687-2470
-----------------	----------

The Contractor must notify the following in case of an emergency:

Cox Communications	262-0661
Kansas Gas Service	383-8600
Westar Energy	383-8600
Aquila Energy	1-800-303-0357
AT&T	1-800-286-8313
City of Wichita Water Utility	268-6000
2. All water mains and appurtenances shall be installed in accordance with City of Wichita, Kansas, Standard Specifications for the Construction of City Projects.
3. Opening and closing water valves shall be done slowly to prevent damage to the water distribution system from water hammer. All valves closed by the Contractor must be reopened as new construction permits. Project inspector must ascertain that any valve closed by the Contractor is reopened. Contractor will be permitted to operate water valves only when the project inspector assigned to the project is present.
4. The Contractor shall give all property owners and/or tenants of developed property directly abutting the construction of this project a minimum of ten (10) days advance notice prior to start of construction.
5. Traffic Control to be coordinated with Railroad Corridor Project.
6. All water pipe on this project to be D.I.C.L.
7. This project includes installation of a steel casing pipe for future 1" domestic service.



#### INDEX OF SHEETS

1. INDEX SHEET
2. LINE 1 PLAN & PROFILE
3. WATER ASSEMBLY DETAILS
4. WATERLINE BUBBLE MAP

#### BENCHMARKS

BM #1 CHISELED SQUARE ON THE TOP OF CURB 20'± S. AND 42'± W. OF THE S.W. CORNER OF BUILDING N 20089.60 E 19772.10 140 N. MOSLEY ELEV. = 1296.28 (M.S.L.) **NGVD29**

ON-SITE BENCH MARK: CHISELED SQUARE ON THE TOP OF A 1.1' WIDE PIECE OF CONCRETE ON THE EAST SIDE OF THE RAILROAD BRIDGE OVER DOUGLAS, 6.0' W. OF THE S.W. CORNER OF BUILDING 700 E. DOUGLAS N 20104.29 E 19549.49 ELEV. = 1298.17 (NGVD 29)

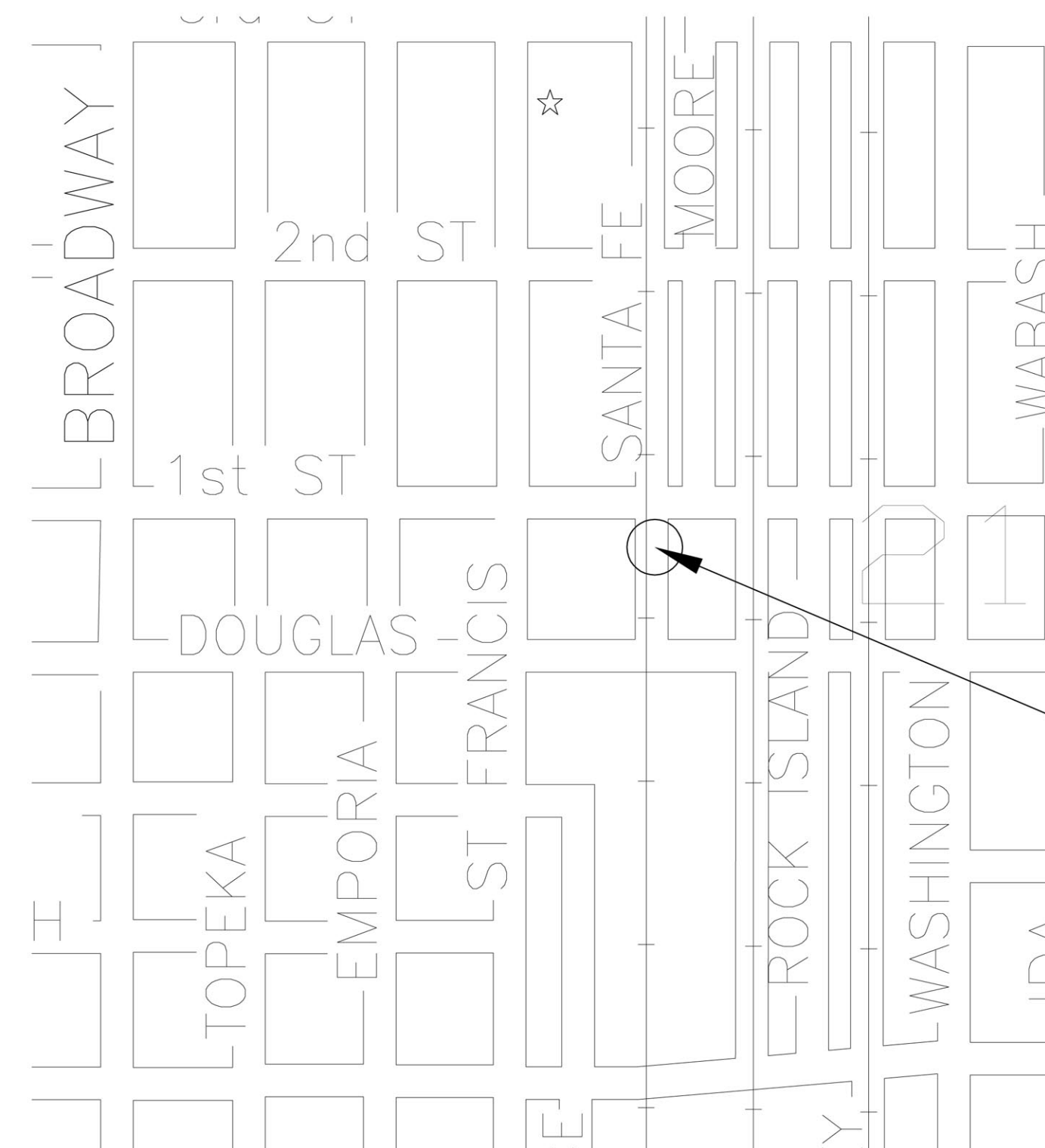

PROJECT LOCATION

APPROVED AS NOTED  
BY CITY OF WICHITA

Public Works	<i>[Signature]</i>	12/27/08
Water & Sewer	<i>[Signature]</i>	12/24/08
Fire Dept.	<i>[Signature]</i>	12-23-08

NOTE TO CONTRACTORS

**PUBLIC PROPERTY:**  
Inspection and testing for the waterline is to be provided by a Licensed consulting Engineering Firm under contract with the Owner/Developer. Said inspection to be in accordance with the City of Wichita standard construction engineering practices and certified by a Licensed Professional Engineer. No work shall be performed in dedicated easements or public right-of-way by the Contractor without such inspection nor shall any work be commenced without written authorization by the City Engineer. All Construction and Materials shall comply with the City of Wichita Specifications and Standards (on file and available in the City Engineer's Office).

**PRIVATE PROPERTY:**  
Installation, inspection and testing for the fire protection line is to be performed by a City of Wichita certified fire protection contractor in accordance with the fire codes as adopted by the City of Wichita. All materials and construction practices for the fire protection line shall comply with the fire codes as adopted by the City of Wichita (available from the City of Wichita Fire Department). The contractor shall not commence work without notification of and approval of the Wichita Fire Department.



**CONTRACTOR:** Dondlinger & Sons  
**INSPECTOR:** Tim Kelly, Ruggles & Bohm, P.A.  
**PDFs:** Matt Perez, Ruggles & Bohm, P.A.

01-15-09

**Ruggles & Bohm, P.A.**  
 Engineering, Surveying, Land Planning

924 North Main (316) 264-8008  
 Wichita, Kansas 67203 (316) 264-4621 fax  
 www.rbkansas.com E-mail: info@rbkansas.com

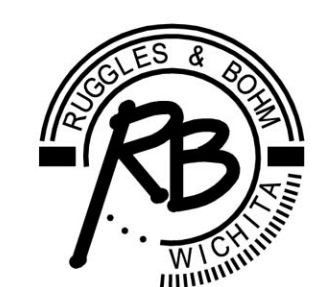

## CITY OF WICHITA, KANSAS

### JAMES L. ARMOUR, P.E., CITY ENGINEER