

SCADA SYSTEM DETAIL

- Notes:
1. Maximum tower height is 30 feet.
 2. 6" copper ground rod shall be provided for the tower.
 3. Anchor bolt sizes and lengths shall be per the tower manufacturers recommendations.
 4. Contact Mike Hughes with the City of Wichita Water & Sewer Department at 269-4764 prior to SCADA connection.

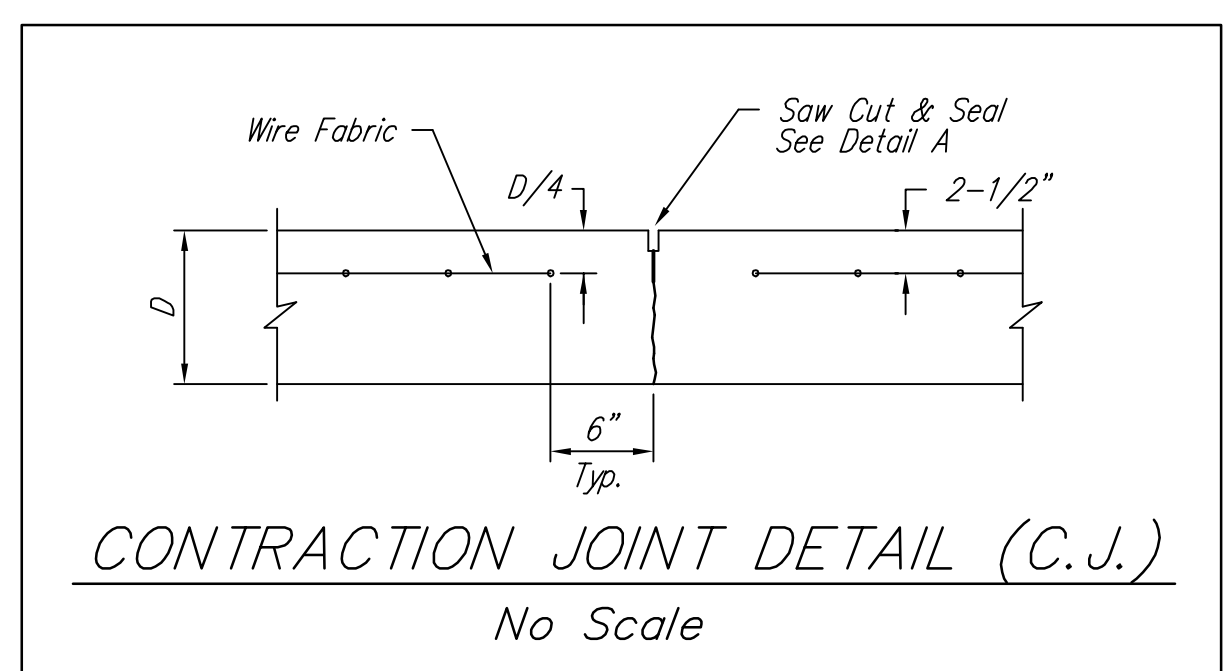
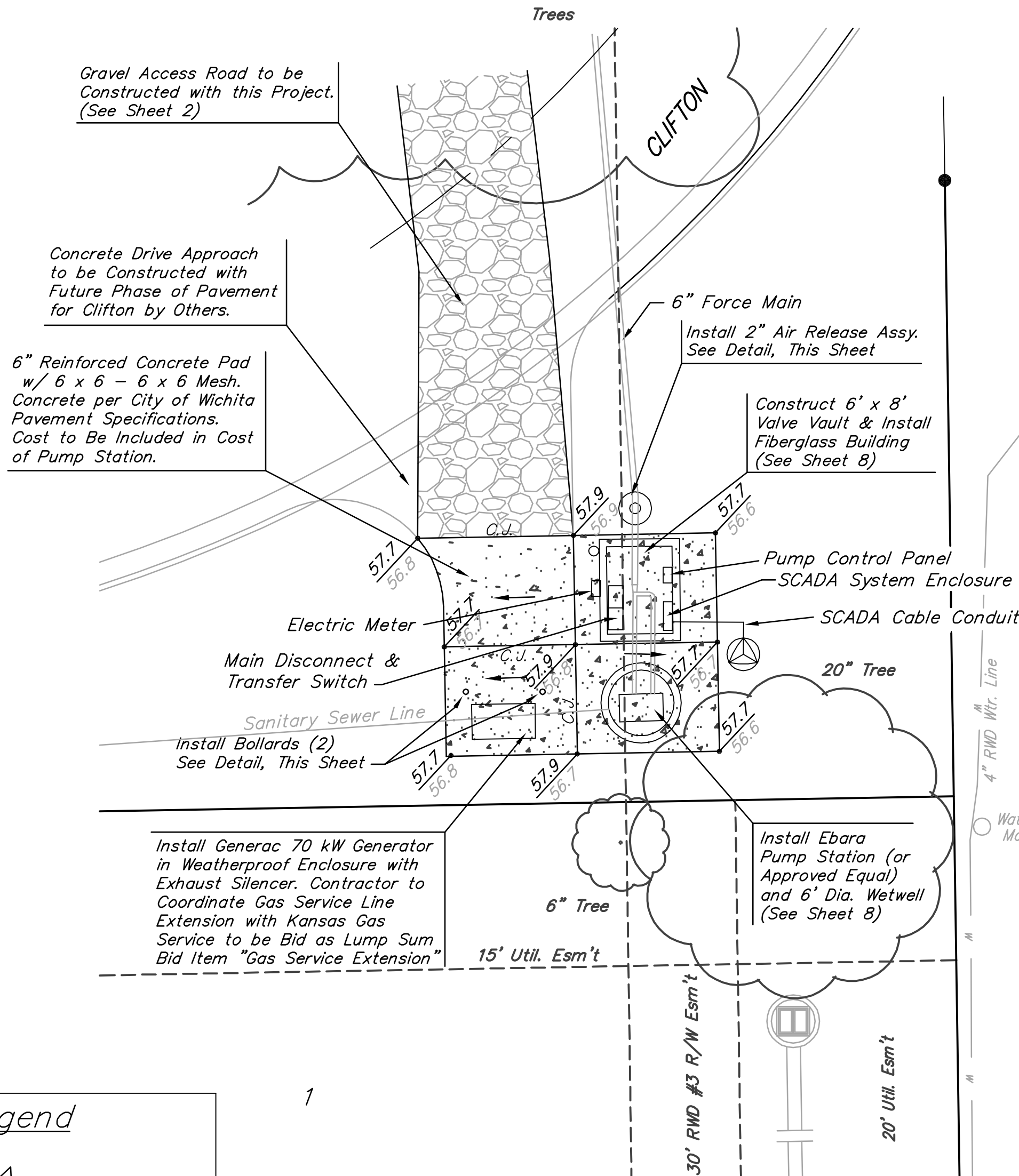

Notes:
The Price Bid for Furnishing and Installing the Wet Well Mounted Pump Station With Standby Emergency Power and Miscellaneous Appurtenances Complete in Place Shall Include All Costs for Furnishing and Installing the Pump Station as Indicated Complete in Place and in Operation. This Price Shall Include the Cost of Constructing and/or Installing Compacted Subgrade, Concrete Pad, Power Pole, Electrical Conduit, Electrical Wiring, Disconnect Switch, Primary and Secondary Electrical Power Supply, Reinforced Concrete Valve Vault, Fiberglass Building, Pig Recovery System, Finished Grading, and any Other Incidentals Necessary to Complete the Work.

The Contractor Shall be Responsible for Arrangements with the Gas Company for Extension of Gas Service to the Lift Station Site and For Payment of Costs of such Extension and Meter Setting. Location of Meter to be Acceptable to Gas Service Company and to City of Wichita Sewer Maintenance Department. Please Contact Mike Pruitt with Kansas Gas Service at 832-3187 to coordinate.

The Contractor Shall Coordinate with the Electric Company to Extend 3Ø Electrical Service to the Lift Station Site. Cost of 3Ø Electrical Service Shall be Included in Lump Sum Pump Station Cost. Please Contact Shane Price with Westar at 261-6315 to coordinate.

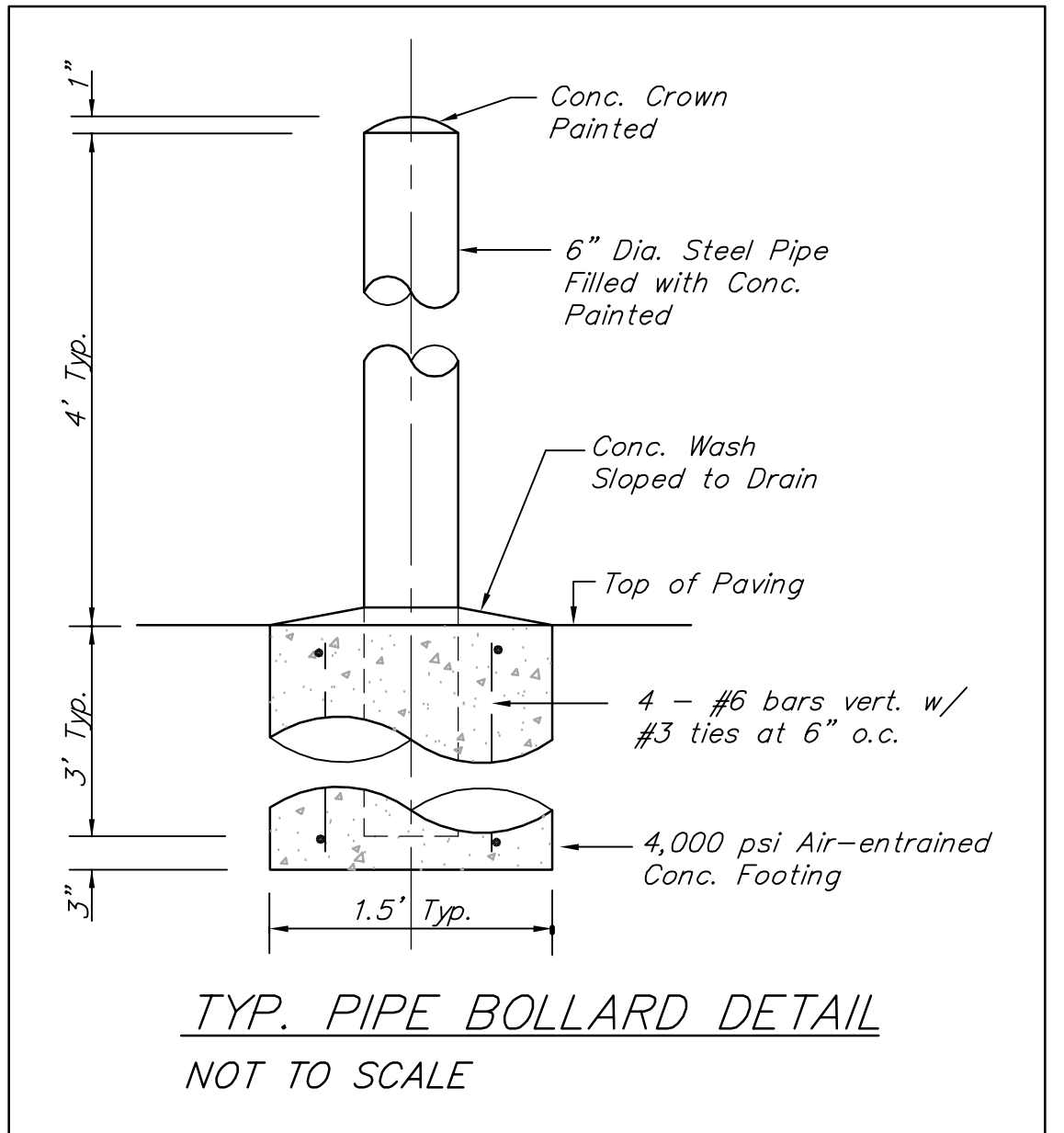
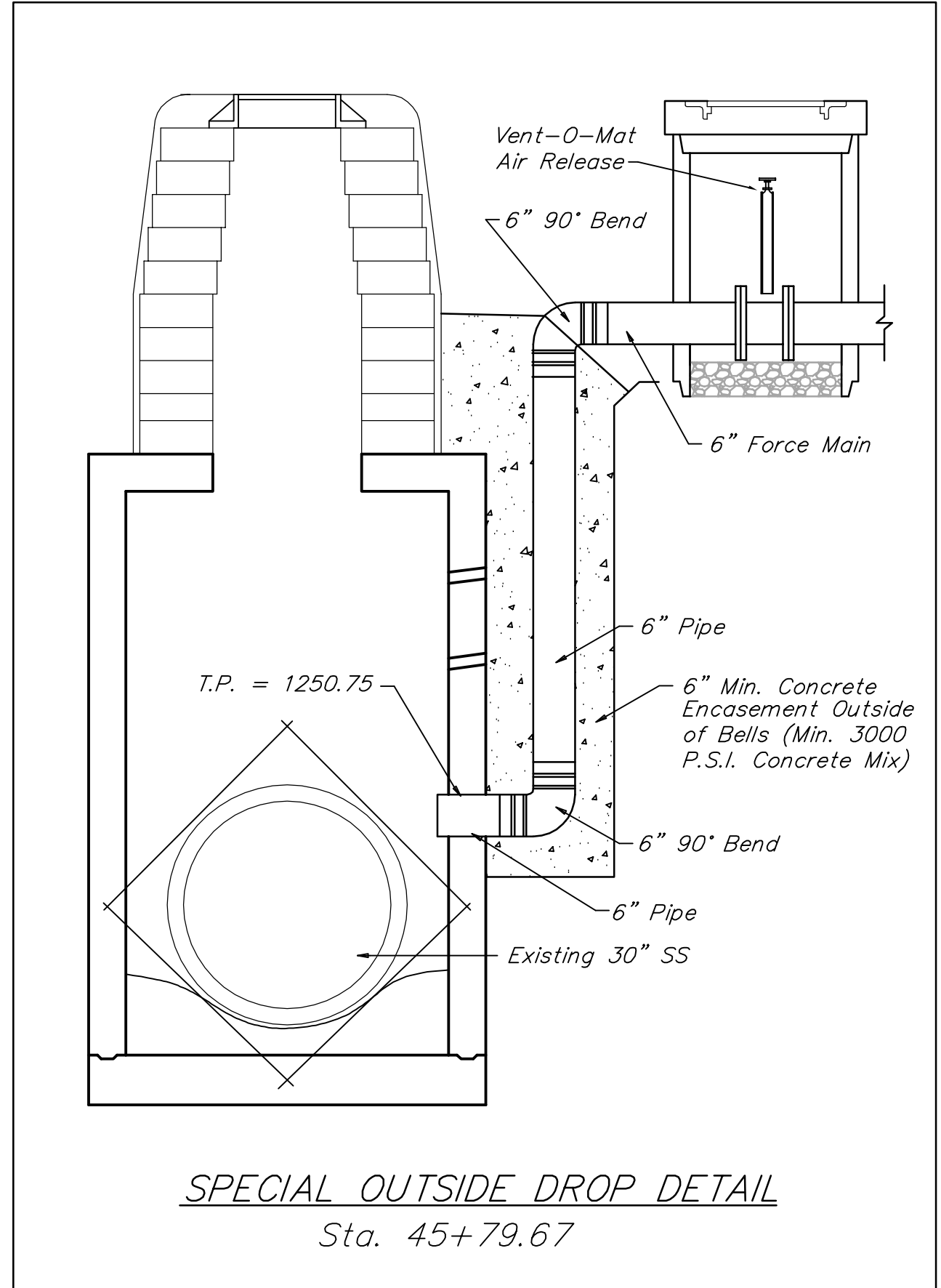

Pump Station Information

	Pump	Flow	TDH	Motor HP	RPM	Elec. Serv. Req.
No. 1	100DLMF611	375 gpm	73'	15	1800	208V, 3 Phase
No. 2	100DLMF611	375 gpm	73'	15	1800	208V, 3 Phase

Baughman CLIFTON COVE ADDITION
SITE PLAN
MAIN 1, BOEING SEWER

Baughman Company, P.A. 315 Ellis St. Wichita, KS 67211 P 316-262-7271 F 316-262-0149
ENGINEERING | SURVEYING | PLANNING | LANDSCAPE ARCHITECTURE

PROJECT NUMBER 468-84022	DESIGN DMV	DRAWN DMV
REVISIONS:	APPROVED	DATE 09/06
SCALE NOTED		SHEET 7 OF 12