

CITY OF WICHITA

GYP SUM CREEK CHANNEL IMPROVEMENTS

(WICHITA DRAINAGE CANAL TO HILLSIDE AVE.)

PROJECT NO. 468-82473

OCA NO. 660803

JAMES ARMOUR, P.E., CITY ENGINEER

August, 2007

INDEX TO DRAWINGS

- 1. TITLE SHEET
- 2. GENERAL NOTES
- 3. KEY SHEET
- 4. TYPICAL SECTIONS
- 5.-6. CONTOUR MAP & FENCING PLANS
- 7.-8. PLAN & PROFILE
- 9. ACCESS RAMP PLAN & PROFILE
- 10.-12. PAVEMENT DETAILS
- 13. INLET DETAILS
- 14. DITCH LINING
- 15. RETAINING WALL DETAIL
- 16. CONCRETE HEADWALL
- 17. FLAP GATE (AUTOMATIC)
- 18.-25. JOYLAND DRAINAGE STRUCTURE
- 26. SUPPORTS AND SPACERS FOR REINFORCING STEEL
- 27. FENCING DETAILS
- 28. SUMMARY OF QUANTITY SHEET
- 29. EROSION CONTROL PLAN
- 30.-34. TEMPORARY PROJECT WATER POLLUTION CONTROL
- 35. PROJECT CONSTRUCTION SIGN LAYOUT
- 36.-37. LANDSCAPE PLANS
- 38.-44. CROSS SECTIONS
- 45.-46. CROSS SECTIONS ACCESS RAMP

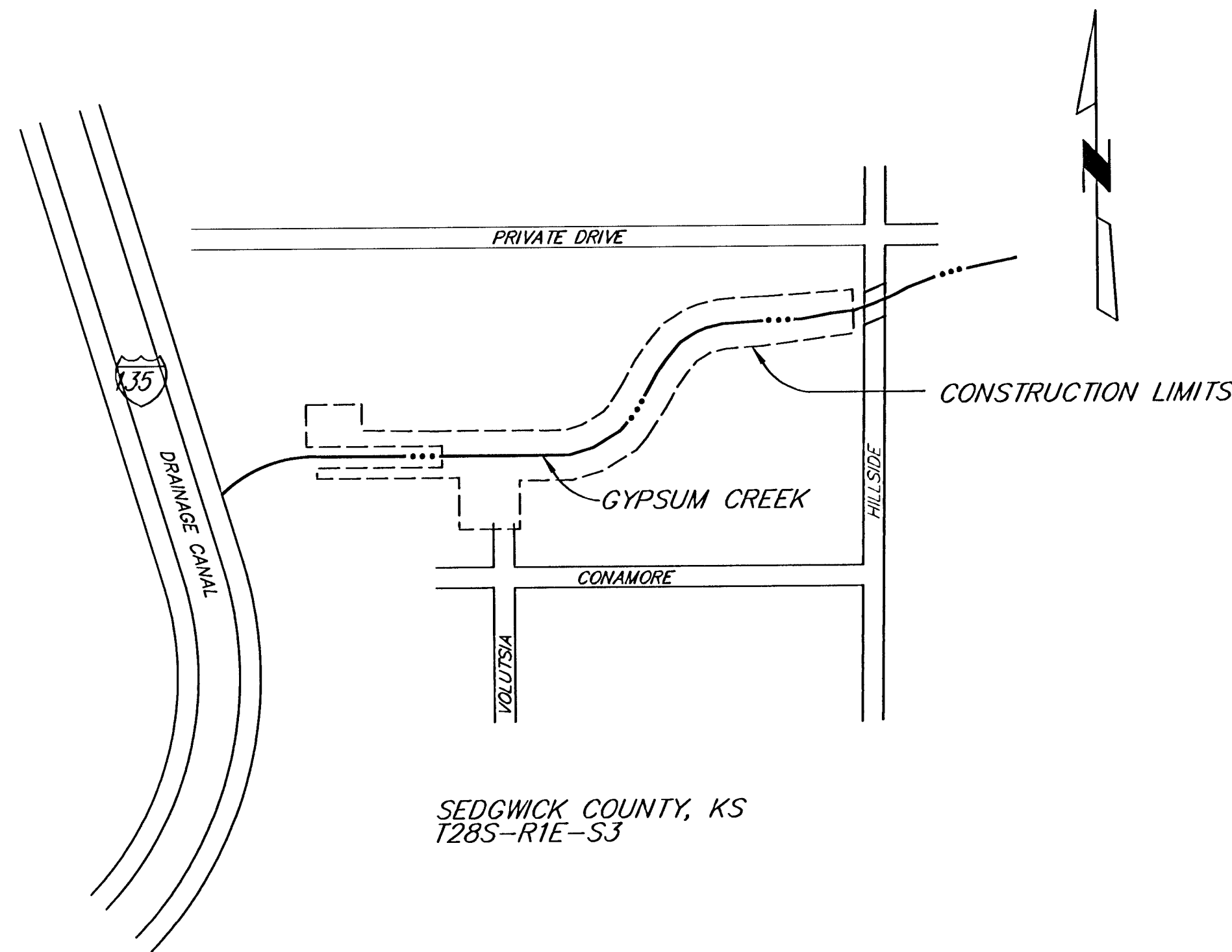

Prepared By



PROJECT LENGTH
1,651.37 L.F. = 0.31 MILES

JIM ARMOUR, P.E.
CITY ENGINEER
CITY OF WICHITA, KS

APPROVAL DATE

K:\32158A\Cadd\Sheets\Drainage\0175.dgn SURV. JG. CP. PLOT CADD DES. DR. TR. CKD. APP.