

PLAN	CHECKED	BY	DATE
	CHECKED		

Unless noted otherwise, elevations shown are top of pipe

Remove and Replace Existing FH as necessary for Construction. Cost Shall be Considered Subsidiary to "Site Clearing" and "Site Restoration".

WATERLINE NO. 1

D.I. - 310.00 L.F. RJ Pipe
PCCP - 310.00 L.F. RJ Pipe

Install Erosion Control 45 L.F. Silt Fence

PROFILE	CHECKED	BY	DATE
	CHECKED		

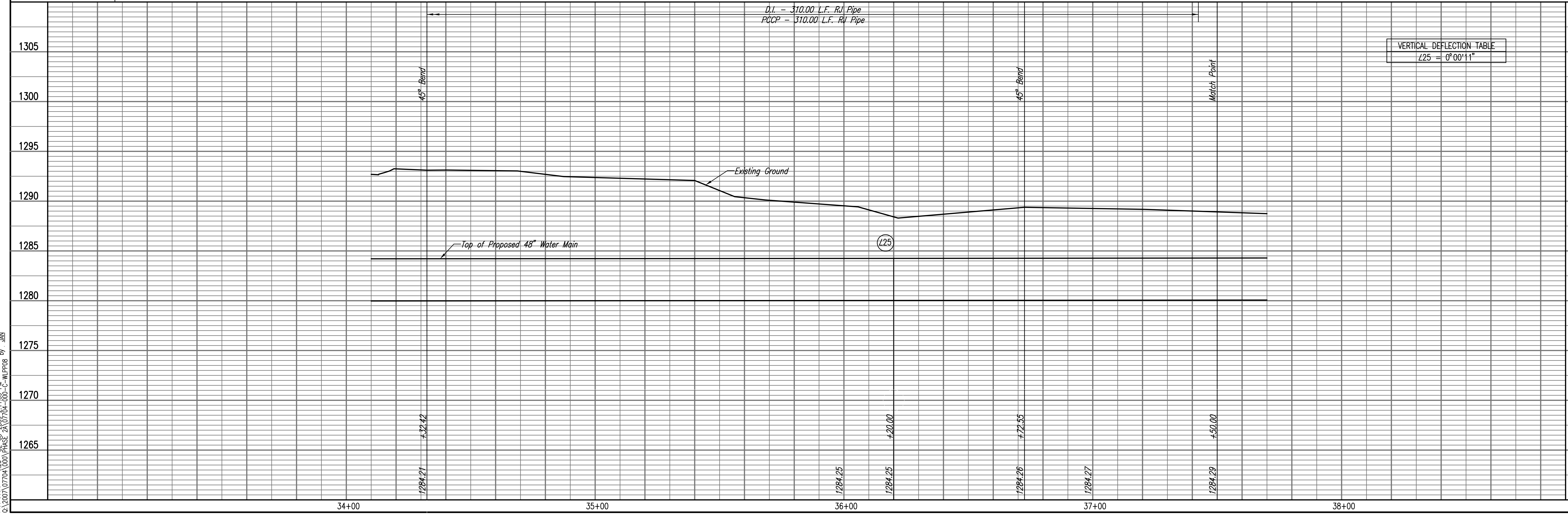

VERTICAL DEFLECTION TABLE
L25 = 0°00'11"

Saved: 01-29-2009 4:36:38 PM by: JAW
Plot Scale: 1/20 02-03-2009 2:11:59 PM
C:\2007\07704\000\PHASE 2A\07704-000-C-WLPROP.dwg

Professional Engineering Consultants, P.A.
603 S. TOPICKA AVENUE, WICHITA, KANSAS 67202
316-262-2691 • FAX 316-262-3003

Designed By: MDK, EJB
Drawn By: JAN

Job No.: 55-07704-000
Date: March 2008

SOUTHEAST 48" WATERLINE - PHASE 2A
LEWIS/IDA TO LEWIS/GREEN

WATERLINE NO. 1

JAMES L. ARMOUR, P.E. - CITY ENGINEER
CITY OF WICHITA PROJECT NO. 448-90417

Sheet 15 of 38