

Unless otherwise noted, elevations shown are to top of pipe.

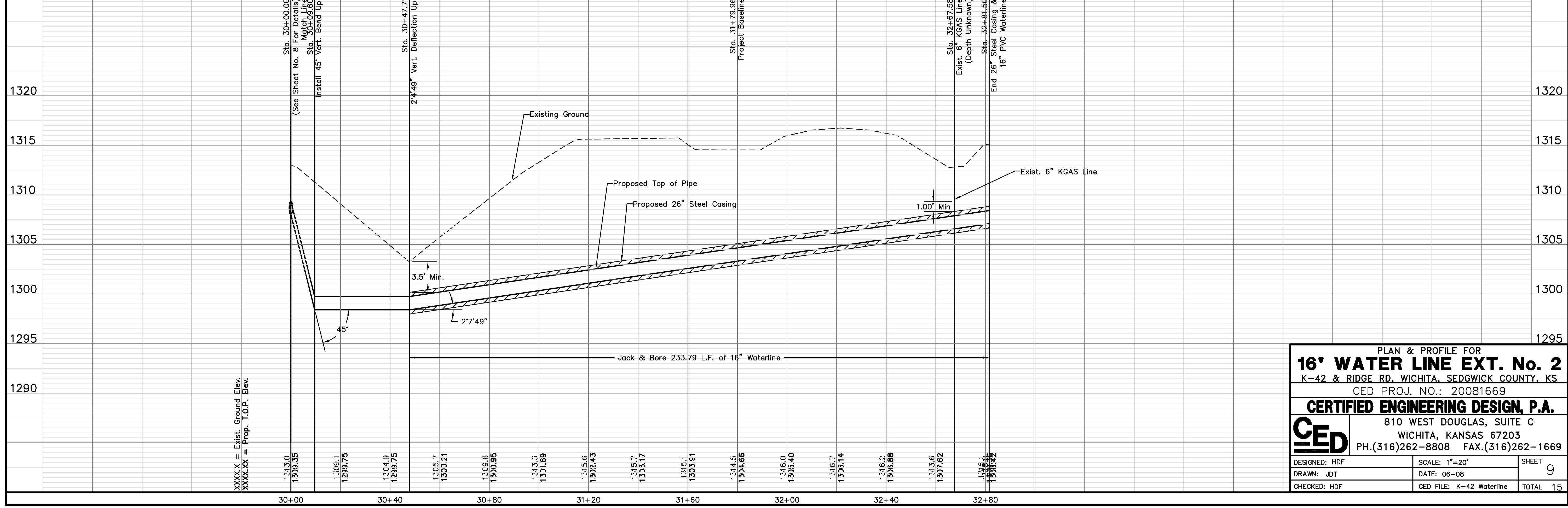

PLAN & PROFILE FOR
16" WATER LINE EXT. No. 2
 K-42 & RIDGE RD, WICHITA, SEDGWICK COUNTY, KS
 CED PROJ. NO.: 20081669
CERTIFIED ENGINEERING DESIGN, P.A.
 810 WEST DOUGLAS, SUITE C
 WICHITA, KANSAS 67203
 PH.(316)262-8808 FAX.(316)262-1669

DESIGNED: HDF	SCALE: 1"=20'	SHEET
DRAWN: JDT	DATE: 06-08	9
CHECKED: HDF	CED FILE: K-42 Waterline	TOTAL 15