

G:\01\106-0021 Wichita-KS\5 Drawings\Civil\316 City SWS.dwg - Grading Jul 30, 2008 9:07am

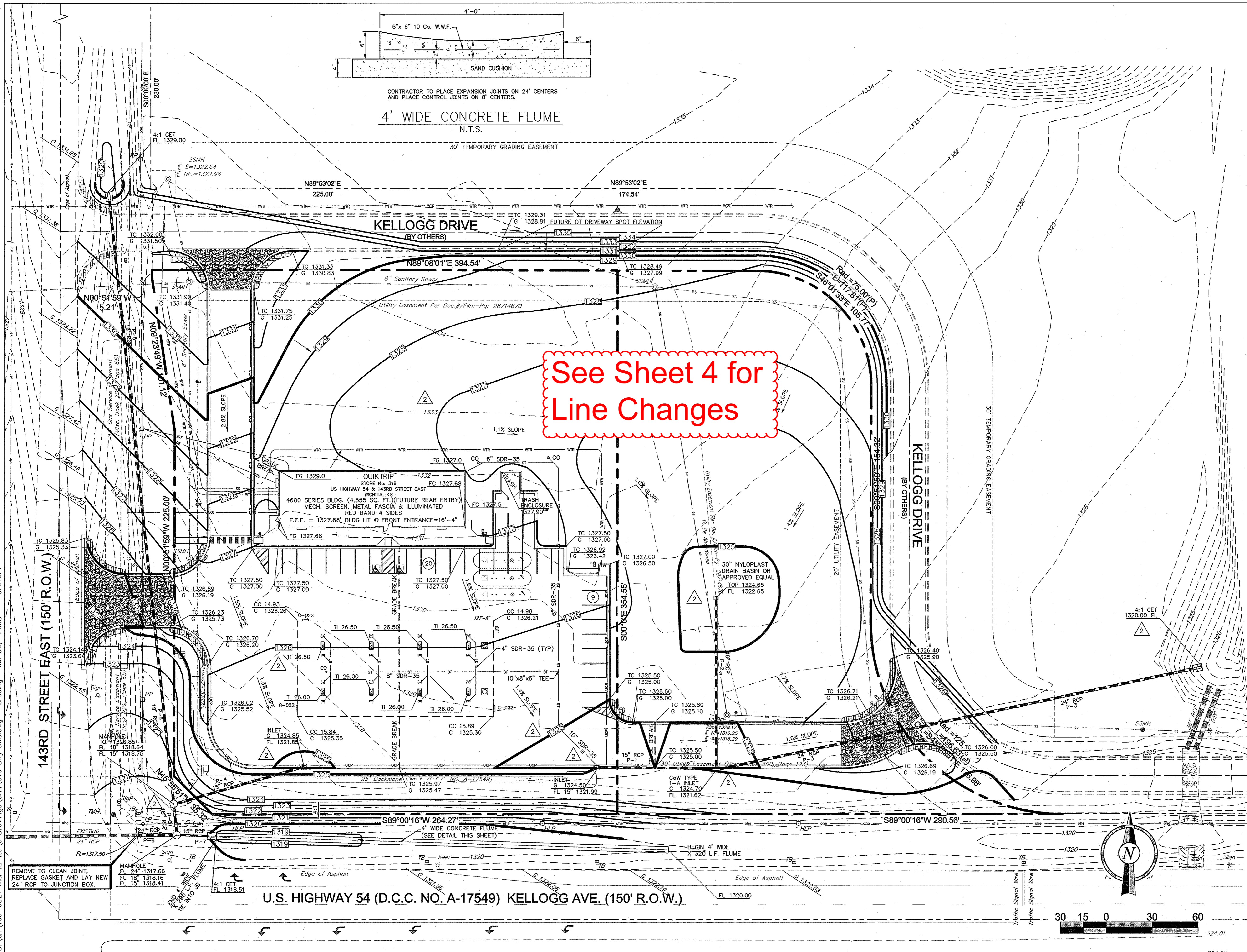

GRADING AND DRAINAGE LEGEND	
ST	STORM PIPE (10" AND SMALLER)
ST	STORM PIPE (12" AND LARGER)
2% SLOPE	SLOPE PERCENTAGE (RISE/RUN)
4:1	SLOPE RATIO (RUN:RISE)
1330	MAJOR CONTOUR (NEW)
1331	MINOR CONTOUR (NEW)
1330	MAJOR CONTOUR (EXISTING)
1331	MINOR CONTOUR (EXISTING)
TC 1335.50 G 1335.00	SPOT ELEVATION (NEW)
TC 1335.50 G 1335.00	SPOT ELEVATION (EXISTING)
[Symbol]	STORM GRATE (NEW)
[Symbol]	CRUSHED STONE
UCP	UNDER CURB DRAIN PIPE
[Symbol]	JUNCTION BOX (STD. CITY OF WICHITA REINFORCED CONCRETE MANHOLE)

1. GAS CANOPY INSTALLER SHALL INSTALL THE CANOPY COLUMN DRAIN PIPE AND OVERFLOW FITTING. THE STORM WATER INSTALLER SHALL CONNECT THEIR PIPING TO THE GAS INSTALLER'S OVERFLOW FITTING.
2. REFER TO ARCHITECTURAL PLANS FOR ADDITIONAL TANK INFORMATION.
3. TOP OF ISLAND ELEVATION SHALL BE 0.42' ABOVE FINISH GRADE.
4. SEE SHEET C4 FOR DRAINAGE AREAS AND STORM SEWER INFORMATION.

**IMPERVIOUS AREA**  
 PRE-CONSTRUCTION: 0 SF  
 POST-CONSTRUCTION: 53,291.8 SF  
 NET INCREASE: 53,291.8 SF

**SITE BENCHMARK**  
 "a" Chisled on Traffic Signal Light Pole  
 at NW corner of 143rd St & Kellogg Ave.  
 Elevation=1318.61 (NGVD 29)

See Sheet 4 for Line Changes

Revision	Date	By
1	05/07/08	J. Bradford
2	05/07/08	J. Bradford
3	05/07/08	J. Bradford
4	05/07/08	J. Bradford

QuikTrip 316  
 GRADING PLAN  
 CITY OF WICHITA, KANSAS  
 JIM ARMOUR, P.E. - CITY ENGINEER

BSW INTERNATIONAL ENGINEERS, P.C.  
 ONE WEST THIRD ST., STE. 600  
 TULSA, OK 74103-3620  
 PHONE (918) 245-4271  
 FAX (918) 581-3594  
 CERTIFICATE OF AUTHORITY NO. E-510  
 EXPIRATION DATE 12/31/2008

Designed By: J. Crisp  
 Drawn By: J. Bradford  
 BSW Job No.: 106-0021  
 Date: 07/30/08

Sheet  
 2 of 9