

COMBINED CURB & GUTTER (TYPE I) (MODIFIED)

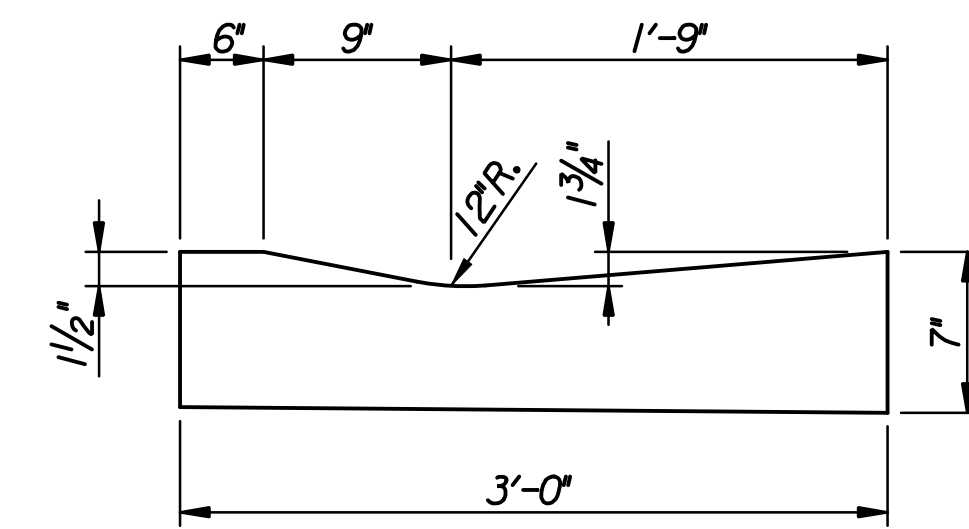

COMBINED CURB & GUTTER (TYPE II) (MODIFIED)

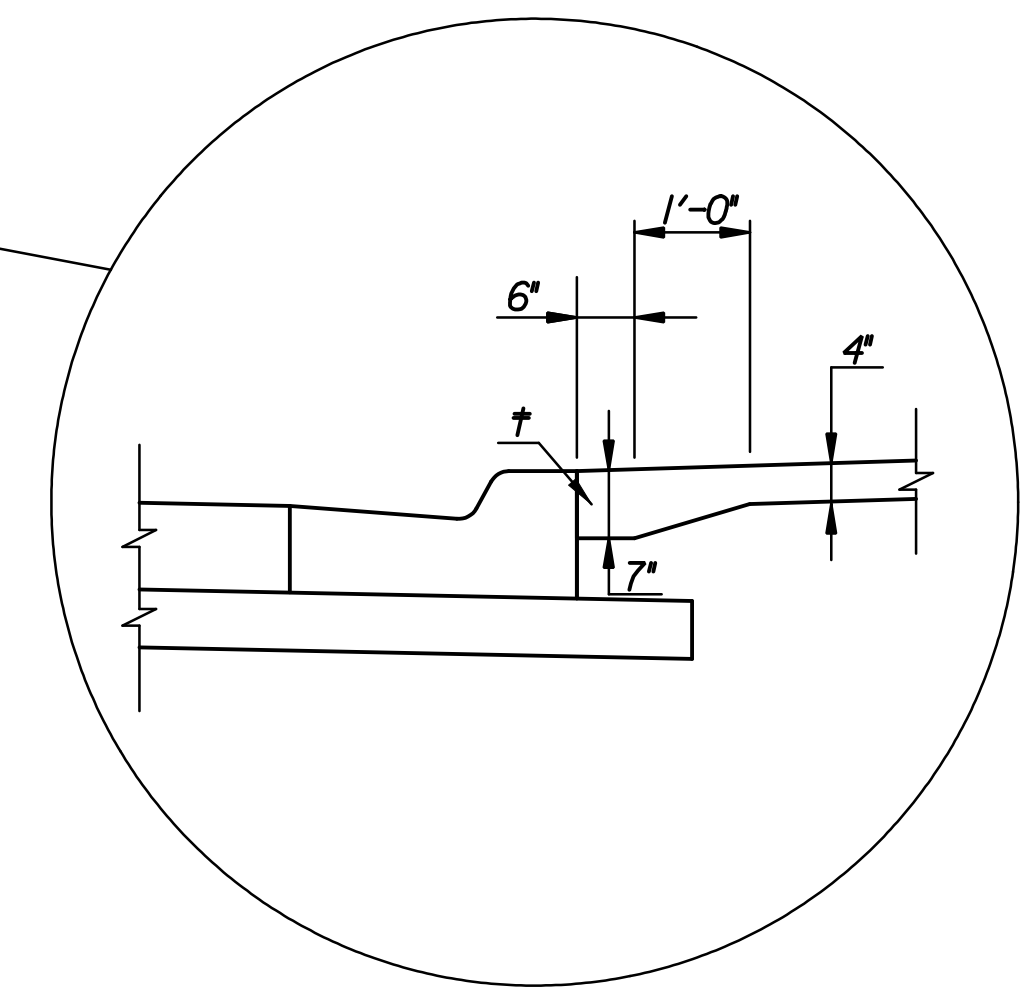

CONCRETE SIDEWALK THICKENED EDGE DETAIL (TYP.)

- ① Profile Grade is the theoretical top of pavement elevation.
  - ② Backfill behind curb. Quantities for this work are included in the Earthwork Summary Table.
  - ③ Slope Varies from 3/8"/ft. at Sta. 603+75 to 1.5% at Sta. 604+30. Slope Varies from 1.5% at Sta. 605+00 to 3/8"/ft. at Sta. 605+60. Slope Varies from 3/8"/ft. at Sta. 608+40 to 1.0% at Sta. 609+00.
  - ④ See Emporia and William Intersection Detail for lane locations.
  - ⑤ Slope Varies from 0.56% at Sta. 700+22 to 3/8"/ft. at Sta. 700+50. Slope Varies from 3/8"/ft. at Sta. 702+80 to 1.5% at Sta. 703+30. Slope Varies from 1.5% at Sta. 703+30 to 0.84% at Sta. 703+50. Slope Varies from 0.84% at Sta. 703+90 to 1.5% at Sta. 704+10. Slope Varies from 1.5% at Sta. 704+10 to 3/8"/ft. at Sta. 704+50.
  - ⑥ Slope Varies from 3/8"/ft. at Sta. 702+80 to 1.5% at Sta. 703+30. Slope Varies from 1.5% at Sta. 703+30 to 0.84% at Sta. 703+50. Slope Varies from 0.84% at Sta. 703+90 to 1.5% at Sta. 704+10. Slope Varies from 1.5% at Sta. 704+10 to 3/8"/ft. at Sta. 704+30.
- \* Slope Varies. See Intersection Details for Spot Elevations.
- \* See Plans for Proposed sidewalk locations to be constructed as part of this project.
- † The additional thickness of concrete adjacent to combined Curb & Gutter will not be paid for directly but is considered Subsidiary to the bid item "Sidewalk Concrete Pavement".

CRUSHED ROCK GRADATION REQUIREMENTS

PERCENT OF AGGREGATE RETAINED	
2-1/2"	0
3/4"	20-60
#4	50-80
#40	80-94
#200	90-98

Rock quality shall conform to the requirements specified by the KDOT 2007 Edition Standard Specification Subsection 1102 for Durability Class I.

Plotted By: svb Date: 2/28/2009 10:03:04 AM  
 FILE: I:\2008\08456\Typical\08456-TypSec1.dgn

No.	Revision	By	Date
EMPORIA STREET, WILLIAM STREET, AND ST. FRANCIS STREET			
<b>TYPICAL SECTIONS</b>			
JAMES L. ARMOUR, P.E. - CITY ENGINEER CITY OF WICHITA PROJECT NO. 472-84744			
<b>Professional Engineering Consultants, P.A.</b> 303 S. TOPEKA • WICHITA, KANSAS 67202 316-262-2691 • FAX 316-262-3003			
Designed by	JPS	Job No.	08456
Drawn by	AKL	Date	Feb., 2009
			Sht. R2 of R78