

DSNR: DRM OPER: SVB SCALE: I:/2008/08456/STANDARDS/08456-MISCDTL.DGN LAST REV: 3-9-2009 BY: svb

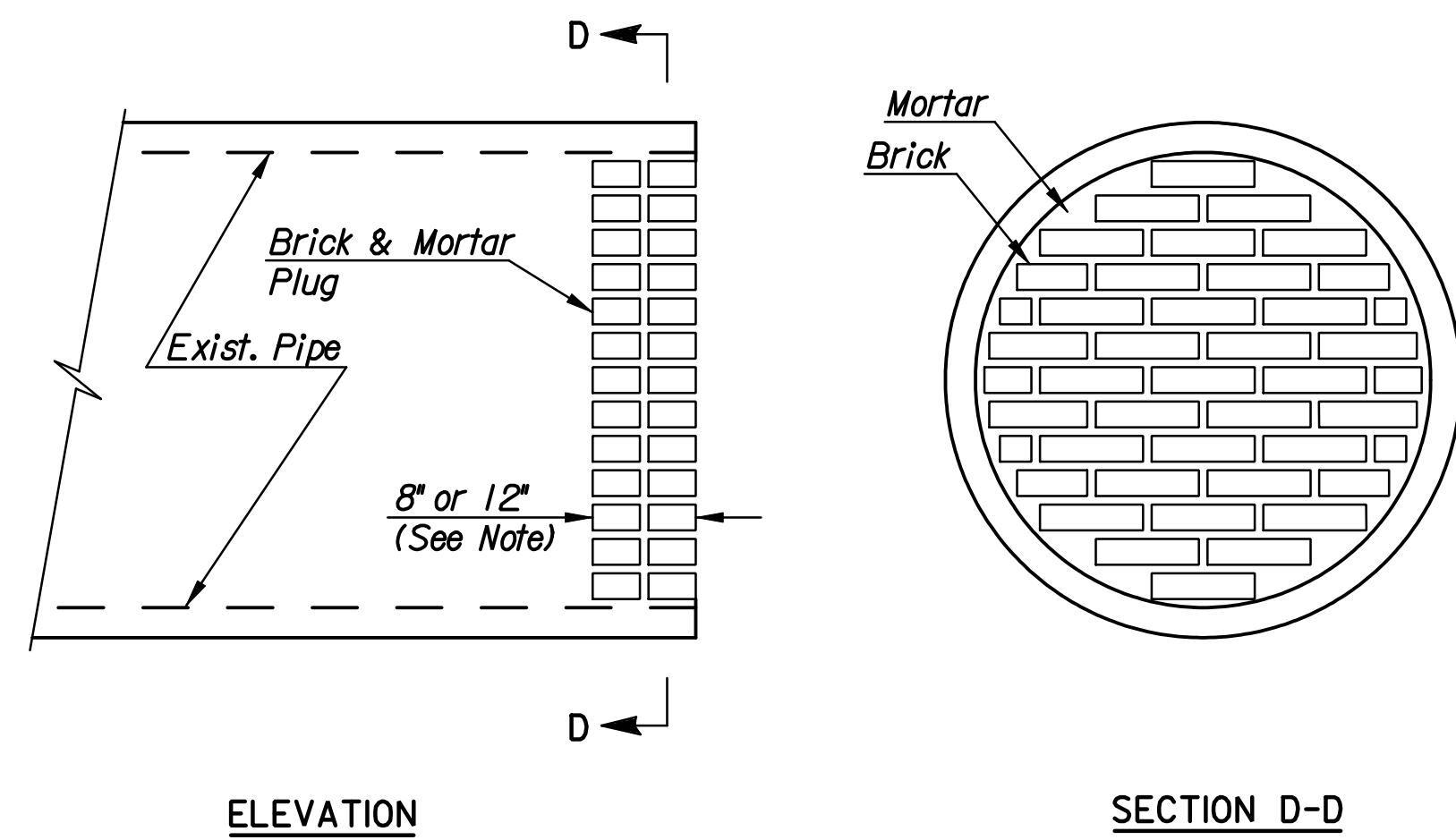

PIPE PLUGGING DETAIL

NOTE: PIPE PLUGS SHALL BE CONSTRUCTED OF BRICK MASONRY, WITH CONSTRUCTION REQUIREMENTS AND MATERIALS CONFORMING TO THE SAME REQUIREMENTS AS SPECIFIED FOR MANHOLE CONSTRUCTION ON SH. NO. 13. PIPES HAVING DIAMETERS OF 18" OR SMALLER SHALL BE PLUGGED WITH 8" THICK PLUGS. PIPES HAVING DIAMETERS LARGER THAN 18" SHALL BE PLUGGED WITH 12" THICK PLUGS. THE CONSTRUCTION OF PIPE PLUGS SHALL NOT BE PAID FOR DIRECTLY, BUT SHALL BE CONSIDERED SUBSIDIARY.

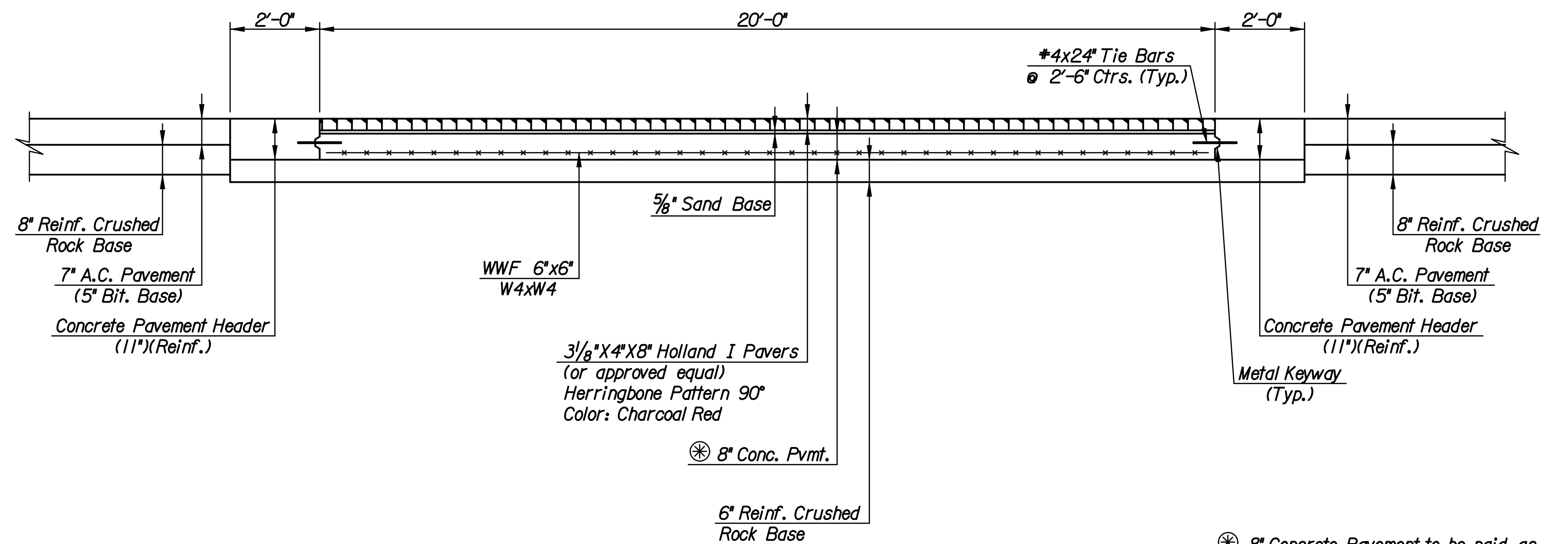

CROSSWALK BRICK PAVER DETAIL
(Sta. 607+37)

⊗ 8" Concrete Pavement to be paid as "Concrete Pavement (9" Uniform)".

| | | | |
|---|----------|---------|-----------------|
| No. | Revision | By | Date |
| EMPORIA STREET, WILLIAM STREET, AND ST. FRANCIS STREET | | | |
| MISCELLANEOUS DETAILS | | | |
| JAMES L. ARMOUR, P.E.—CITY ENGINEER CITY OF WICHITA PROJECT NO. 472-84744 | | | |
| Professional Engineering Consultants, P.A. 303 S. TOPEKA • WICHITA, KANSAS 67202 316-262-2691 • FAX 316-262-3003 | | | |
| Designed by | JPS | Job No. | 08456 |
| Drawn by | SVB | Date | Feb., 2009 |
| | | | Sht. R22 of R78 |