

FHWA REGION NO.	STATE	PROJECT NUMBER	FISCAL YEAR	SHEET NUMBER	TOTAL SHEETS
7	KANSAS	87N-0245-01	2007	32	55

ALL UTILITY LINES EXPOSED DURING CONSTRUCTION SHALL BE SUPPORTED WHILE EXPOSED. METHOD TO BE APPROVED BY FIELD ENGINEER.

STA. 0+00.00 LINE 1
 STA. 0+51.50 LINE 2
 BL STA. 3+23.04, 17.93' LT.
 REMOVE EXISTING MANHOLE.
 CONSTRUCT SPECIAL SHALLOW TYPE 'P' MANHOLE.
 TOP ELEV = 1304.47
 FLOWLINE NORTH = 1299.45
 FLOWLINE SOUTH = 1299.45
 FLOWLINE EAST = 1299.49
 FLOWLINE WEST = 1299.50

STA. 2+51.40 LINE 1
 BL STA. 5+74.44, 19.00' LT.
 REMOVE EXISTING MANHOLE.

STA. 3+56.63, 15.98' LT. LINE 1
 BL STA. 6+79.54, 19.98' LT.
 INSTALL NEW RING & COVER AND ADJUST MH TOP
 EXISTING RIM ELEV = 1303.83
 PROPOSED RIM ELEV = 1303.40

Installed Reducer
 C-900 thru storm box
 sewer pipe north to MH

Cascade connection
 42" piece of PVC north from MH
 clay south from MH

Installed Reducer
 C-900 thru storm box
 sewer pipe north to MH

STA. 1+57 LINE 1
 BL STA. 4+80, 18.5' LT.
 CONSTRUCT CONCRETE ENCASEMENT
 AS PER CITY OF WICHITA SPECIFICATIONS

STA. 3+56.63 LINE 1
 STA 0+00.00 LINE 3
 BL STA. 6+79.54, 19.98' LT.
 REMOVE EXISTING MANHOLE.
 CONSTRUCT SPECIAL SHALLOW TYPE 'P' MANHOLE.
 SEE SHEET 35.
 TOP ELEV = 1303.79
 FLOWLINE NORTH = 1300.03
 FLOWLINE SOUTH = 1299.98
 FLOWLINE WEST = 1299.94

Remove pavement, construct temporary pavement.
 Note: Permanent pavement will be installed with Street Project.



SCALE 1"=20'

REVISED: 12/14/07

Krugger & Bohm, P.A.
 Engineering, Surveying, Land Planning
 525 North Main
 Wichita, Kansas 67203
 Phone: 316.261.0000
 Fax: 316.261.0001
 Email: info@krugger.com

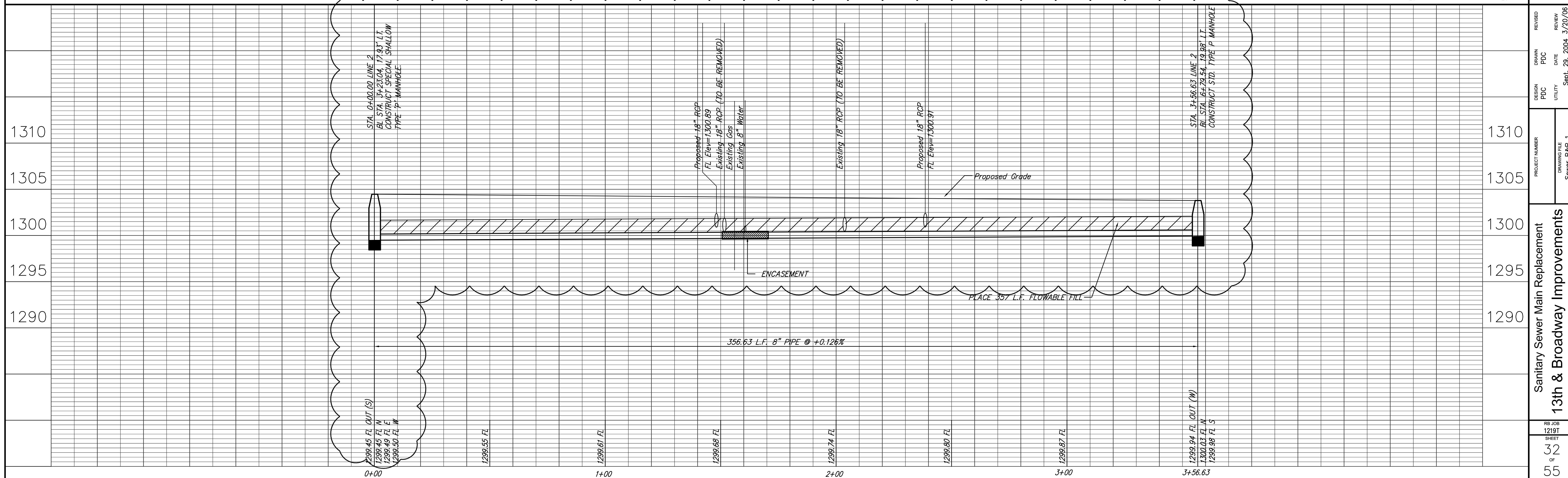
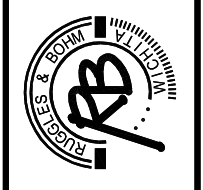

REVISION	DATE	BY	CHKD	DESCRIPTION
1	09/29/04	PDC	PDC	UTILITY
2	03/20/06	PDC	PDC	REVIEW

PROJECT NUMBER	DRAWING FILE
Sanitary Sewer Main Replacement 13th & Broadway Improvements	Sewer P&P 1

32	55
----	----