

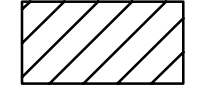
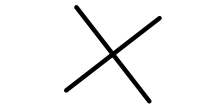

LEGEND

-  PAVEMENT DEMOLITION
-  TREE REMOVAL
-  DEMOLITION BY OTHERS
-  EXISTING UTILITY DEMOLITION

Demolish Existing Asphalt and Concrete Pavement, Sidewalk, and Curb & Cutter to limits shown. Base material under pavement shall be removed off site.

Remove SWS under existing pavement. Remaining SWS within the median will be extended in order to minimize damage to mature trees.

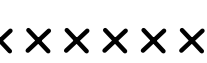
Remove Existing Light Pole and Riser

Remove Tree (Typ. of 6)

Remove SWS under existing pavement. Remaining SWS within the median will be extended in order to minimize damage to mature trees.

Demolish Existing Asphalt and Concrete Pavement, Sidewalk, and Curb & Gutter to limits shown. Base material under pavement shall be removed off site.

Demo by others.

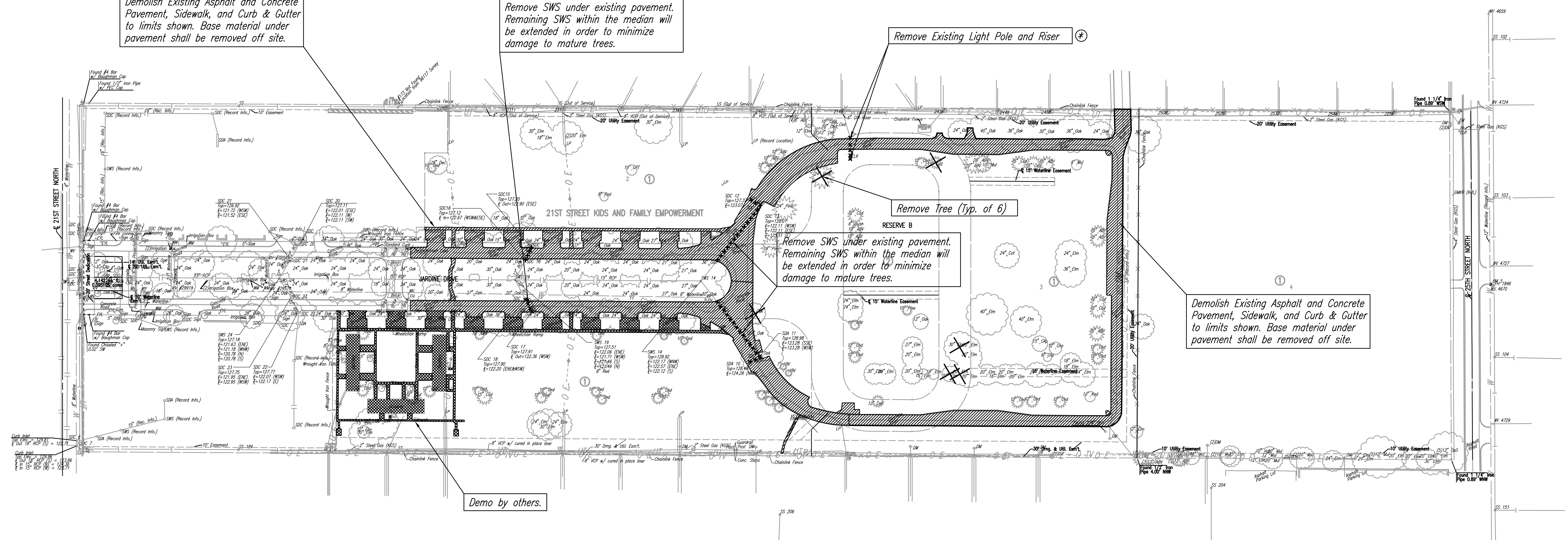

REMOVAL OF EXISTING LIGHT POLE AND RISER SHALL BE COORDINATED WITH WESTAR ENERGY (MR. RANDY TRUITT 261-6512). ALL REMOVED MATERIALS BECOME PROPERTY OF THE CONTRACTOR AND SHALL BE REMOVED FROM THE SITE.

THE BID ITEM "PAVEMENT REMOVAL" SHALL INCLUDE REMOVAL AND DISPOSAL OF ALL PAVEMENT TYPES INCLUDING ASPHALT, CONCRETE, SIDEWALK, AND COMBINED CURB & GUTTER.

Served 12-20-2005 3:39:34 PM by BLS
 Plot Scale 1:100 12-21-2005 7:31:02 AM by GSS
 J:\SENTOUT\2005\05416\2005-12-20 to City\ paving and Drain\DWG\04-DEMOLITION PLAN

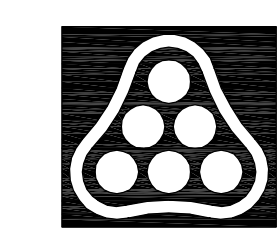

No.	Revision	By	Date
21ST STREET KIDS AND FAMILY EMPOWERMENT			
DEMOLITION PLAN			
JAMES L. ARMOUR, P.E.—CITY ENGINEER CITY OF WICHITA PROJECT NO. 472-84282 Professional Engineering Consultants, P.A. 303 S. TOPEKA • WICHITA, KANSAS 67202 316-262-2691 • FAX 316-262-3003			
Designed by	BLB, BDB	Job No.	35-05416-000
Drawn by	SAW	Date	OCTOBER 2005
			Sht. 4 of 53