

**PAVING AND INCIDENTAL DRAINAGE PLANS**  
**FOX RIDGE ADDITION**  
**CONNECTOR PHASE - PART 2**

**GRADING PLAN**  
SHEET TITLE  
472-84421  
PROJECT NUMBER

DBG  
DESIGN BY  
DBG  
DRAWN BY  
JAG  
CHECKED BY

ISSUED  
September 2006  
REVISED

SHEET NO.  
17 of 31

**EARTHWORK SUMMARY**

BERM / RESERVE GRADING	560 C.Y.
EXCAVATION	3,000 C.Y.
COMPACTED FILL (90% DENSITY)	

NOTE: 20% HAS BEEN ADDED TO FILL QUANTITIES TO ALLOW FOR COMPACTION AND HANDLING.

**LEGEND**

- WATER LINE
- SAN. SEWER LINE
- 1355 - - - - - EXIST. CONTOURS
- 1355 - - - - - PROP. CONTOURS
- - - - - LIMITS OF GRADING

**KEY**

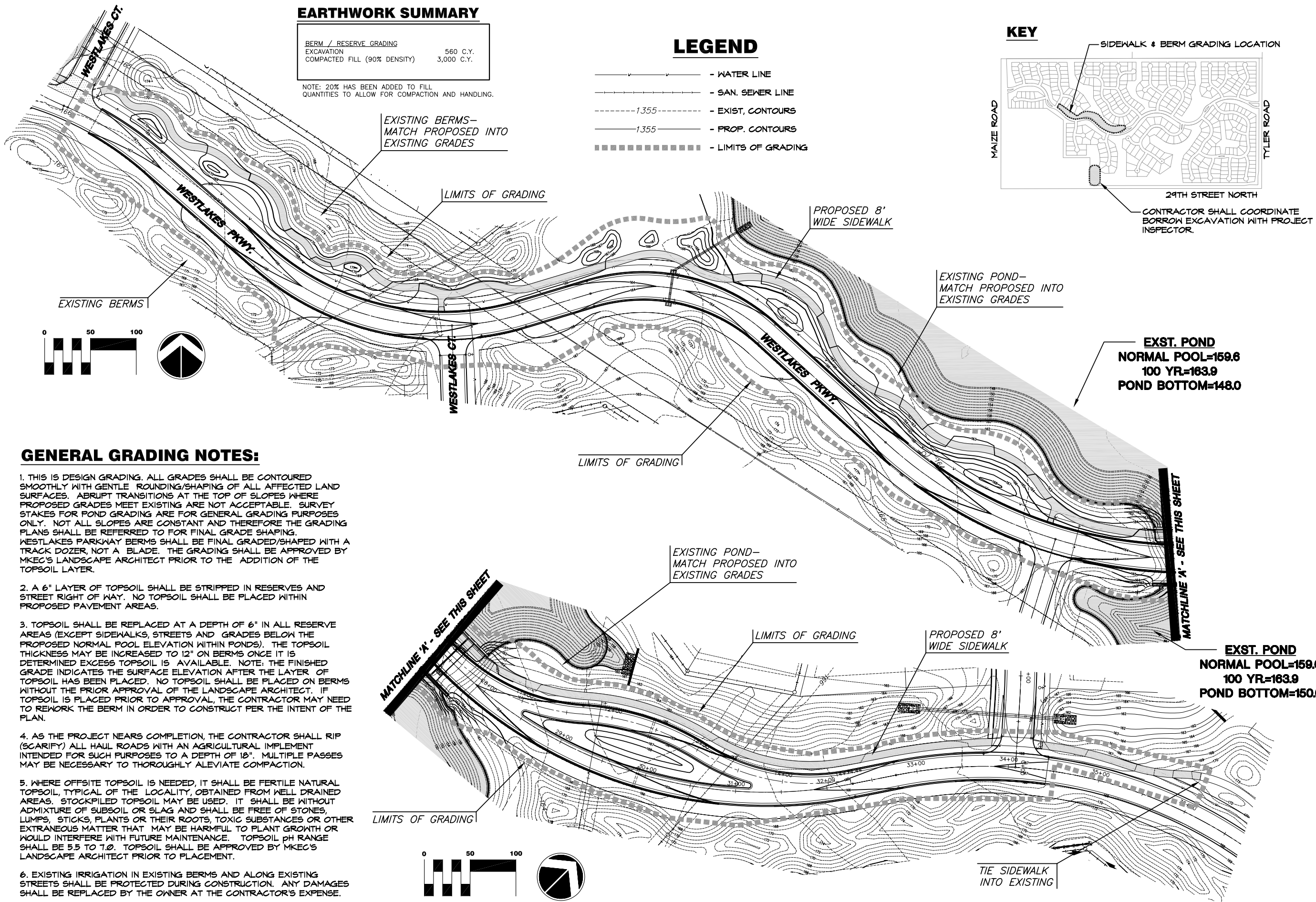
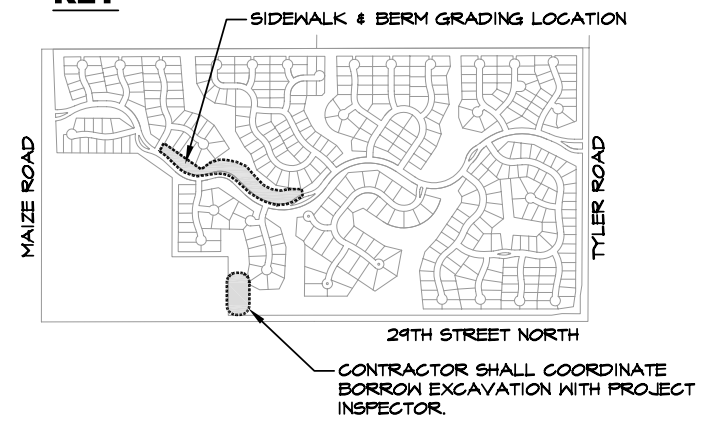

**GENERAL GRADING NOTES:**

1. THIS IS DESIGN GRADING. ALL GRADES SHALL BE CONTOURED SMOOTHLY WITH GENTLE ROUNDING/SHAPING OF ALL AFFECTED LAND SURFACES. ABRUPT TRANSITIONS AT THE TOP OF SLOPES WHERE PROPOSED GRADES MEET EXISTING ARE NOT ACCEPTABLE. SURVEY STAKES FOR POND GRADING ARE FOR GENERAL GRADING PURPOSES ONLY. NOT ALL SLOPES ARE CONSTANT AND THEREFORE THE GRADING PLANS SHALL BE REFERRED TO FOR FINAL GRADE SHAPING. WESTLAKES PARKWAY BERMS SHALL BE FINAL GRADED/SHAPED WITH A TRACK DOZER, NOT A BLADE. THE GRADING SHALL BE APPROVED BY MKEC'S LANDSCAPE ARCHITECT PRIOR TO THE ADDITION OF THE TOPSOIL LAYER.
2. A 6" LAYER OF TOPSOIL SHALL BE STRIPPED IN RESERVES AND STREET RIGHT OF WAY. NO TOPSOIL SHALL BE PLACED WITHIN PROPOSED PAVEMENT AREAS.
3. TOPSOIL SHALL BE REPLACED AT A DEPTH OF 6" IN ALL RESERVE AREAS (EXCEPT SIDEWALKS, STREETS AND GRADES BELOW THE PROPOSED NORMAL POOL ELEVATION WITHIN PONDS). THE TOPSOIL THICKNESS MAY BE INCREASED TO 12" ON BERMS ONCE IT IS DETERMINED EXCESS TOPSOIL IS AVAILABLE. NOTE: THE FINISHED GRADE INDICATES THE SURFACE ELEVATION AFTER THE LAYER OF TOPSOIL HAS BEEN PLACED. NO TOPSOIL SHALL BE PLACED ON BERMS WITHOUT THE PRIOR APPROVAL OF THE LANDSCAPE ARCHITECT. IF TOPSOIL IS PLACED PRIOR TO APPROVAL, THE CONTRACTOR MAY NEED TO RENORM THE BERM IN ORDER TO CONSTRUCT PER THE INTENT OF THE PLAN.
4. AS THE PROJECT NEARS COMPLETION, THE CONTRACTOR SHALL RIP (SCARIFY) ALL HAUL ROADS WITH AN AGRICULTURAL IMPLEMENT INTENDED FOR SUCH PURPOSES TO A DEPTH OF 18". MULTIPLE PASSES MAY BE NECESSARY TO THOROUGHLY ABLIATE COMPACTION.
5. WHERE OFFSITE TOPSOIL IS NEEDED, IT SHALL BE FERTILE NATURAL TOPSOIL, TYPICAL OF THE LOCALITY, OBTAINED FROM WELL DRAINED AREAS. STOCKPILED TOPSOIL MAY BE USED. IT SHALL BE WITHOUT ADMIXTURE OF SUBSOIL OR SLAG AND SHALL BE FREE OF STONES, LUMPS, STICKS, PLANTS OR THEIR ROOTS, TOXIC SUBSTANCES OR OTHER EXTRANEOUS MATTER THAT MAY BE HARMFUL TO PLANT GROWTH OR WOULD INTERFERE WITH FUTURE MAINTENANCE. TOPSOIL pH RANGE SHALL BE 5.5 TO 7.0. TOPSOIL SHALL BE APPROVED BY MKEC'S LANDSCAPE ARCHITECT PRIOR TO PLACEMENT.
6. EXISTING IRRIGATION IN EXISTING BERMS AND ALONG EXISTING STREETS SHALL BE PROTECTED DURING CONSTRUCTION. ANY DAMAGES SHALL BE REPLACED BY THE OWNER AT THE CONTRACTOR'S EXPENSE.

PLOTED: Wednesday, September 13, 2006 @ 01:27PM

G:\CIVIL\99118\DWG\PAV\CONN PH PART 2\99118GDI.DWG