

**37TH STREET IMPROVEMENTS
FROM
MAIZE ROAD TO TYLER ROAD**

**CROSS SECTIONS
STA. 29+35.33
TO
STA. 31+50.00**

SHEET TITLE
472-84693
PROJECT NUMBER

DESIGN BY **JRA**
DRAWN BY **DPG**
CHECKED BY **JRA**

ISSUED **March 24, 2009**
REVISED

SHEET NO.
111 of 133

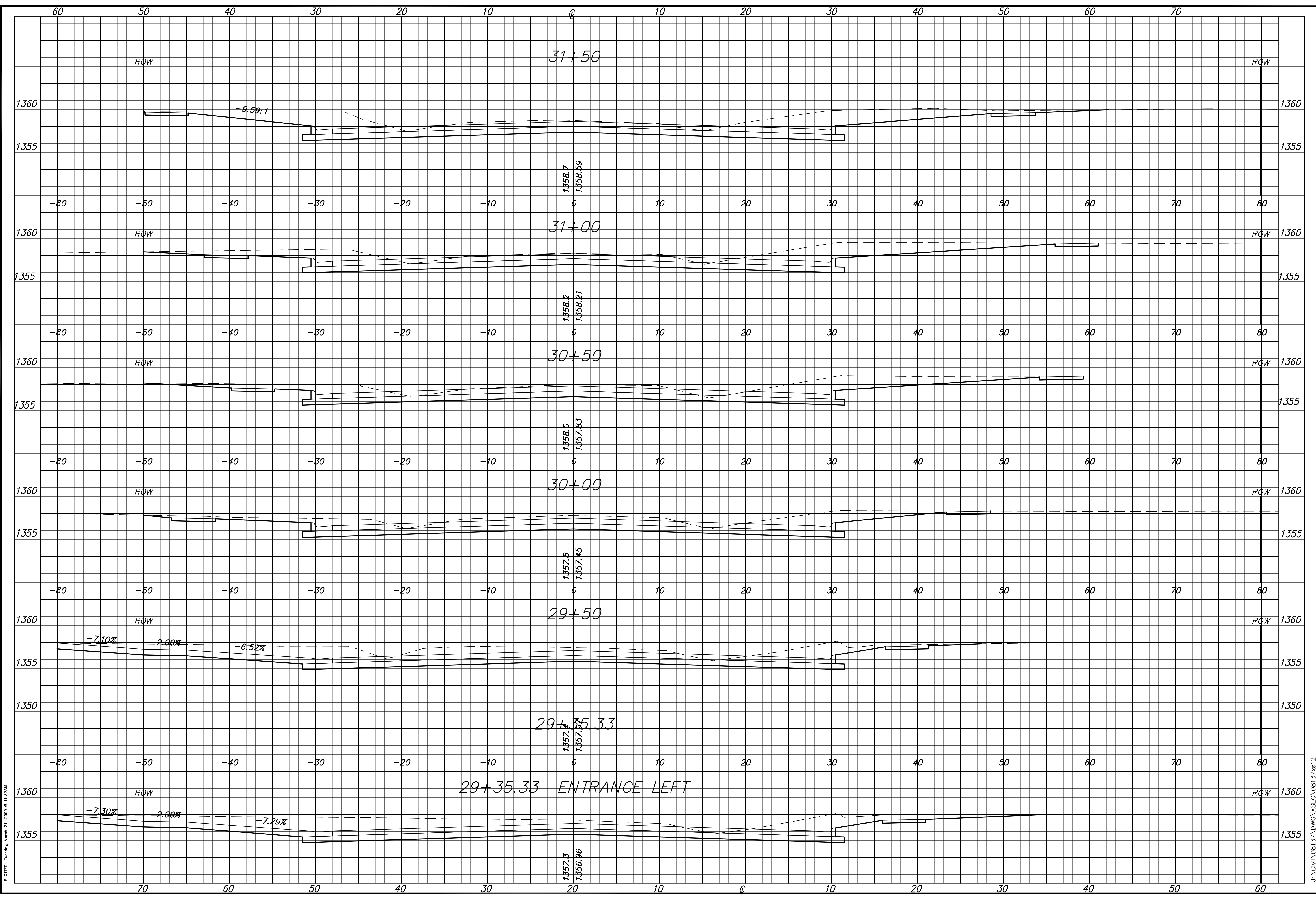

PLOTTED: Tuesday, March 24, 2009 @ 10:37AM

J:\Civil\08137.DWG\XSEC\08137x612