

**37TH STREET IMPROVEMENTS
FROM
MAIZE ROAD TO TYLER ROAD**

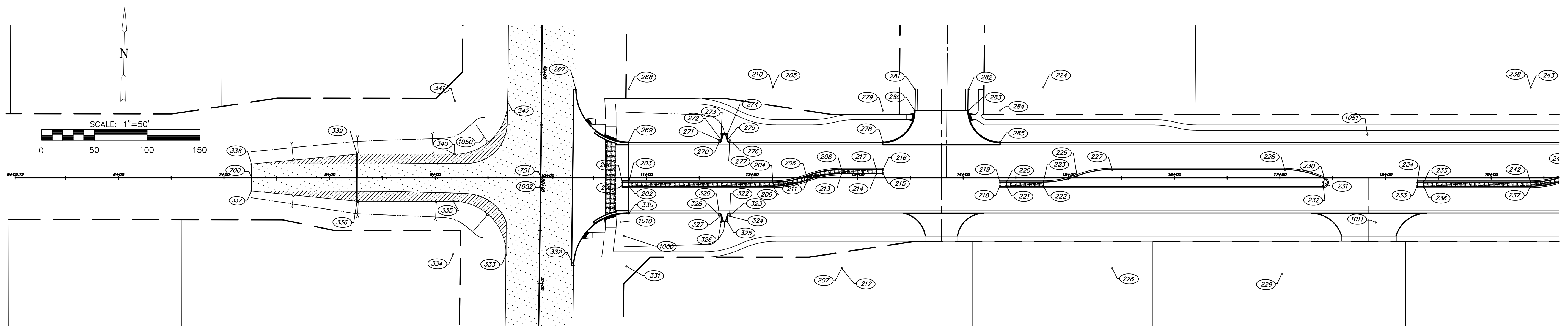

BASE LINE TABLE

POINT NUMBER	STATION	OFFSET	NORTHING	EASTING	DESC
700	7+25.94	0.00 RT	1709280.6661	1612092.1383	BL CTL PTS
701	10+00.00	0.00 RT	1709289.0390	1612366.0703	BL CTL-SECCORNER
702	36+38.66	0.00 RT	1709369.6536	1615003.4890	BL CTL-SECCORNER
703	60+59.07	0.00 LT	1709444.0189	1617422.7700	BL CTL PTS
704	44+79.01	0.00 LT	1709809.9117	1612354.6734	BL CTL PTS MAIZE
705	61+18.98	0.00 RT	1708170.2145	1612384.1641	BL CTL PTS MAIZE

CONTROL POINTS TABLE

POINT NUMBER	STATION	OFFSET	NORTHING	EASTING	DESC
1000	10+79.12	55.00 RT	1709236.4777	1612446.8380	SD 1000
1001	9+61.94	2646.80 RT	1706642.3204	1612408.8954	SC 1
1002	10+00.00	0.00 RT	1709289.0390	1612366.0703	SC 2 Inter
1003			1709211.8107	1609724.1553	SC 3
1004	10+22.90	2638.74 LT	1711927.2445	1612308.3453	SC 4
1005	36+38.66	0.00 RT	1709369.6537	1615003.4938	SC 5
1007	62+69.37	0.00 RT	1709450.4800	1617632.9642	SC 7
1010	10+75.60	41.92 RT	1709249.4511	1612442.9150	SDMD 10
1011	17+90.72	42.17 RT	1709271.0418	1613157.7083	SDMD 11
1012	24+64.54	40.46 RT	1709293.3395	1613831.1641	SDMD 12
1013	33+21.98	41.51 RT	1709318.4864	1614688.2304	SDMD 13
1014	41+90.33	40.34 RT	1709346.2859	1615556.1431	SDMD 14
1015	49+31.40	39.35 RT	1709370.0457	1616296.8240	SDMD 15
1016	54+89.32	41.87 RT	1709384.6635	1616854.5649	SDMD 16
1017	61+72.08	43.79 RT	1709403.7158	1617537.0688	SDMD 17
1050	9+46.10	39.11 LT	1709325.4800	1612311.0310	BM 50
1051	17+82.81	40.81 LT	1709353.7468	1613147.2690	BM 51
1052	23+95.69	45.44 RT	1709286.2633	1613762.4947	BM 52
1053	32+97.21	39.26 LT	1709398.4641	1614661.0057	BM 53
1054	42+07.52	43.98 RT	1709343.1698	1615573.4395	BM 54
1055	49+11.66	102.46 RT	1709306.3512	1616279.0502	BM 55
1056	55+25.64	44.62 RT	1709383.0280	1616890.9569	BM 56
1057	61+84.21	33.97 RT	1709413.9070	1617548.8882	BM 57
1201	10+70.07	2902.83 RT	1706389.7061	1612524.7923	PKN 201

PAVING POINTS TABLE

POINT NUMBER	STATION	OFFSET	NORTHING	EASTING	DESC
200	10+77.27	4.50 RT	1709286.9019	1612443.4465	BC
201	10+77.27	7.50 RT	1709283.9033	1612443.5381	BC
202	10+83.27	7.50 RT	1709284.0867	1612449.5353	BC
203	10+83.27	4.50 RT	1709287.0853	1612449.4437	BC
204	12+19.82	4.50 RT	1709291.2568	1612585.9218	PC
205	12+19.82	85.50 LT	1709381.2148	1612583.1722	RP
206	12+51.87	1.40 LT	1709298.1350	1612617.7807	PCC
207	12+84.99	85.50 RT	1709212.2859	1612653.5428	RP
208	12+84.99	7.50 LT	1709305.2424	1612650.7015	PT
209	12+19.81	7.50 RT	1709288.2580	1612586.0075	PC
210	12+19.81	85.50 LT	1709381.2146	1612583.1663	RP
211	12+52.93	1.40 RT	1709295.3655	1612618.9283	PCC
212	12+84.99	85.50 RT	1709212.2857	1612653.5368	RP
213	12+84.99	4.50 LT	1709302.2437	1612650.7872	PT
214	13+17.94	4.50 LT	1709303.2503	1612683.7207	BC
215	13+23.94	4.50 LT	1709303.4336	1612689.7179	BC

PAVING POINTS TABLE

POINT NUMBER	STATION	OFFSET	NORTHING	EASTING	DESC
216	13+23.94	7.50 LT	1709306.4322	1612689.6262	BC
217	13+17.94	7.50 LT	1709306.2489	1612683.6290	BC
218	14+34.94	7.50 RT	1709294.8304	1612801.0326	BC
219	14+34.94	4.50 RT	1709297.8290	1612800.9409	BC
220	14+40.94	4.50 RT	1709298.0123	1612806.9381	BC
221	14+40.94	7.50 RT	1709295.0137	1612807.0298	BC
222	14+75.94	7.50 RT	1709296.0830	1612842.0134	BC
223	14+75.94	4.50 RT	1709299.0816	1612841.9218	PC
224	14+75.94	85.50 LT	1709389.0396	1612839.1721	RP
225	15+07.99	1.40 LT	1709305.9598	1612873.7806	PCC
226	15+41.11	85.50 LT	1709220.1107	1612909.5427	RP
227	15+41.11	7.50 LT	1709313.0673	1612906.7014	PT
228	17+04.72	7.50 LT	1709318.0658	1613070.2358	PC
229	17+01.67	90.70 RT	1709219.8150	1613070.1824	RP
230	17+42.40	1.29 RT	1709310.4285	1613108.1595	PCC
231	17+41.05	4.25 RT	1709307.4311	1613106.9032	RP
232	17+41.05	7.50 RT	1709304.1826	1613107.0025	PT
233	18+30.05	7.50 RT	1709306.9017	1613195.9609	BC
234	18+30.05	4.50 RT	1709309.9003	1613195.8692	BC
235	18+36.05	4.50 RT	1709310.0836	1613201.8664	BC
236	18+36.05	7.50 RT	1709307.0850	1613201.9581	BC
237	19+37.33	7.50 RT	1709310.1792	1613303.1895	PC
238	19+37.33	85.50 LT	1709403.1358	1613300.3483	RP
239	19+70.45	1.40 RT	1709317.2867	1613336.1103	PCC
240	20+02.50	85.50 RT	1709234.2068	1613370.7188	RP
241	20+02.50	4.50 LT	1709324.1648	1613367.9692	PCC
242	19+37.33	4.50 RT	1709313.1780	1613303.1038	PT
243	19+37.33	85.50 LT	1709403.1360	1613300.3542	RP
244	19+69.39	1.40 LT	1709320.0562	1613334.9627	PCC
245	20+02.51	85.50 RT	1709234.2070	1613370.7248	RP
246	20+02.51	7.50 LT	1709327.1636	1613367.8835	PT
247	21+16.50	7.50 LT	1709330.6463	1613481.8244	BC
248	21+16.50	4.50 LT	1709327.6477	1613481.9160	BC
249	21+22.51	4.50 LT	1709327.8311	1613487.9148	BC
250	21+22.51	7.50 LT	1709330.8297	1613487.8259	BC
251	33+60.27	4.25 LT	1709365.3966	1614725.1067	BC
252	33+60.27	4.25 RT	1709356.9006	1614725.3664	BC
253	33+66.27	4.25 RT	1709357.0839	1614731.3636	BC
254	33+66.27	4.25 LT	1709365.5799	1614731.1039	BC
255	43+39.33	4.25 LT	1709395.4294	1615703.7111	BC
256	43+39.33	4.25 RT	1709386.9334	1615703.9722	BC
257	43+45.33	4.25 RT	1709387.1178	1615709.9694	BC
258	43+45.33	4.25 LT	1709395.6138	1615709.7082	BC
259	50+94.00	4.25 LT	1709418.6159	1616458.0209	BC
260	50+94.00	4.25 RT	1709410.1199	1616458.2821	BC
261	51+00.00	4.25 RT	1709410.3042	1616464.2793	BC
262	51+00.00	4.25 LT	1709418.8002	1616464.0181	BC
263	53+44.00	4.25 LT	1709426.2969	1616707.9029	BC
264	53+44.00	4.25 RT	1709417.8009	1616708.1641	BC
265	53+50.00	4.25 RT	1709417.9853	1616714.1612	BC
266	53+50.00	4.25 LT	1709426.4812	1616713.9001	BC

PAVING POINTS TABLE

POINT NUMBER	STATION	OFFSET	NORTHING	EASTING	DESC
267	10+33.28	83.41 LT	1709373.4252	1612396.7824	PC
268	10+83.27	83.75 LT	1709375.2941	1612446.7475	RP
269	10+83.27	33.75 LT	1709325.3174	1612448.2751	PT
270	11+68.90	33.75 LT	1709327.9351	1612533.8553	PC
271	11+68.89	35.75 LT	1709329.9342	1612533.7942	RP
272	11+70.89	35.75 LT	1709329.9954	1612535.7932	PT
273	11+70.91	41.76 LT	1709335.9925	1612535.6098	FLUME
274	11+76.86	41.73 LT	1709336.1760	1612541.6070	FLUME
275	11+76.89	35.75 LT	1709330.1788	1612541.7904	PC
276	11+78.89	35.75 LT	1709330.2399	1612543.7895	RP
277	11+78.89	33.75 LT	1709328.2409	1612543.8506	PT
278	13+23.94	33.75 LT	1709332.6700	1612688.8242	PC
279	13+23.94	63.75 LT	1709362.6559	1612687.9077	RP
280	13+53.94	63.75 LT	1709363.5725	1612717.8937	PT
281	13+54.20	83.75 LT	1709383.5695	1612717.5484	BC
282	14+05.20	83.73 LT	1709385.1066	1612768.5253	BC
283	14+04.94	63.75 LT	1709365.1306	1612768.8699	PC
284	14+34.94	63.75 LT	1709366.0418	1612798.8560	RP
285	14+34.94	33.75 LT	1709336.0558	1612799.7725	PT
322	11+78.90	33.75 RT	1709260.7703	1612545.9145	PC
323	11+78.90	33.75 RT	1709258.7712	1612545.9756	RP
324	11+76.90	35.75 RT	1709258.7101	1612543.9766	PT
325	11+76.90	41.75 RT	1709252.7129	1612544.1600	FLUME
326	11+70.90	41.75 RT	1709252.5294	1612538.1628	FLUME
327	11+70.90	35.75 RT	1709258.5266	1612537.9794	PC
328	11+68.90	35.75 RT	1709258.4655	1612535.9803	RP
329	11+68.90	33.75 RT	1709260.4648	1612535.9191	PT
330	10+83.27	33.75 RT	1709257.8489	1612450.3373	PC
331	10+81.16	83.75 RT	1709207.8076	1612449.7484	RP
332	10+31.16	82.95 RT	1709207.0784	1612399.7537	BC
333	9+67.16	72.84 RT	1709215.2275	1612335.4749	Edge-Pvmt
334	9+17.17	72.18 RT	1709214.3653	1612285.4823	Edge-Pvmt RP
335	9+17.19	22.18 RT	1709264.3427	1612283.9783	Edge-Pvmt pt
336	8+25.94	22.13 RT	1709261.5977	1612192.7628	Edge-Pvmt
337	7+25.94	12.45 RT	1709268.2267	1612092.5181	Edge-Pvmt
338	7+25.95	13.05 LT	1709293.7068	1612091.7512	Edge-Pvmt
339	8+25.96	22.37 LT	1709306.0775	1612191.4242	Edge-Pvmt
340	9+18.62	22.32 LT	1709308.8648	1612284.0435	Edge-Pvmt PC
341	9+18.64	72.32 LT	1709358.8422	1612282.5394	Edge-Pvmt RP
342	9+68.64	71.76 LT	1709359.8020	1612332.5302	Edge-Pvmt PT

LEGEND
PC-Point of Curve
PCC-Point on Compound Curve
RP-Radius Curve
BC-Back of Curb
EP-Edge of Pavement
PT-Point on Tangent

**PAVING BUBBLE
MAP**
Sta. 7+25.94
to Sta. 19+50
SHEET TITLE
472-84693
PROJECT NUMBER

DESIGN BY _____
DRAWN BY _____
CHECKED BY _____
ISSUED
March 24, 2009
REVISED _____
SHEET NO.
20 of 133

PLOTTED: Tuesday, March 24, 2009 @ 11:19 AM
J:\Civil\08137.DWG\PAV\08137PAV-BUBBLE-1