

**37TH STREET IMPROVEMENTS
FROM
MAIZE ROAD TO TYLER ROAD**

EROSION CONTROL PLAN
SHEET TITLE
472-84693
PROJECT NUMBER

DESIGN BY
DRAWN BY
CHECKED BY

ISSUED
March 24, 2009
REVISED

SHEET NO.
70 of 133

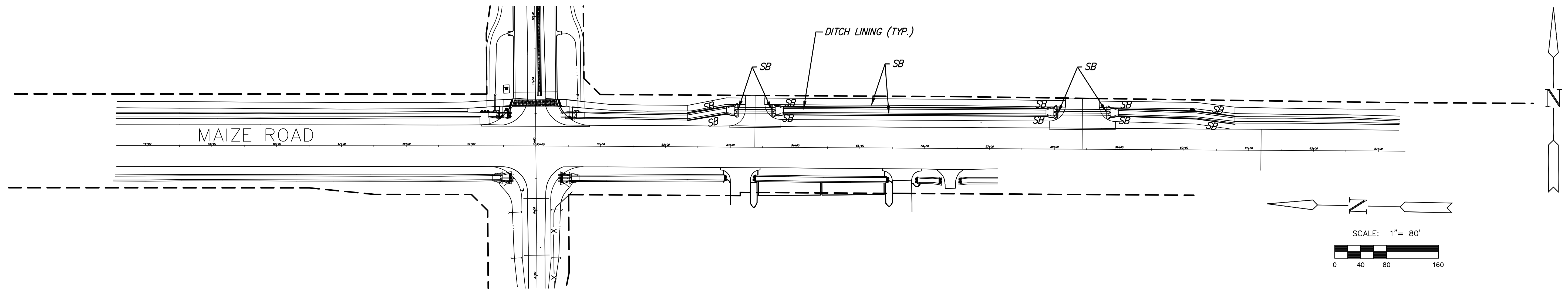
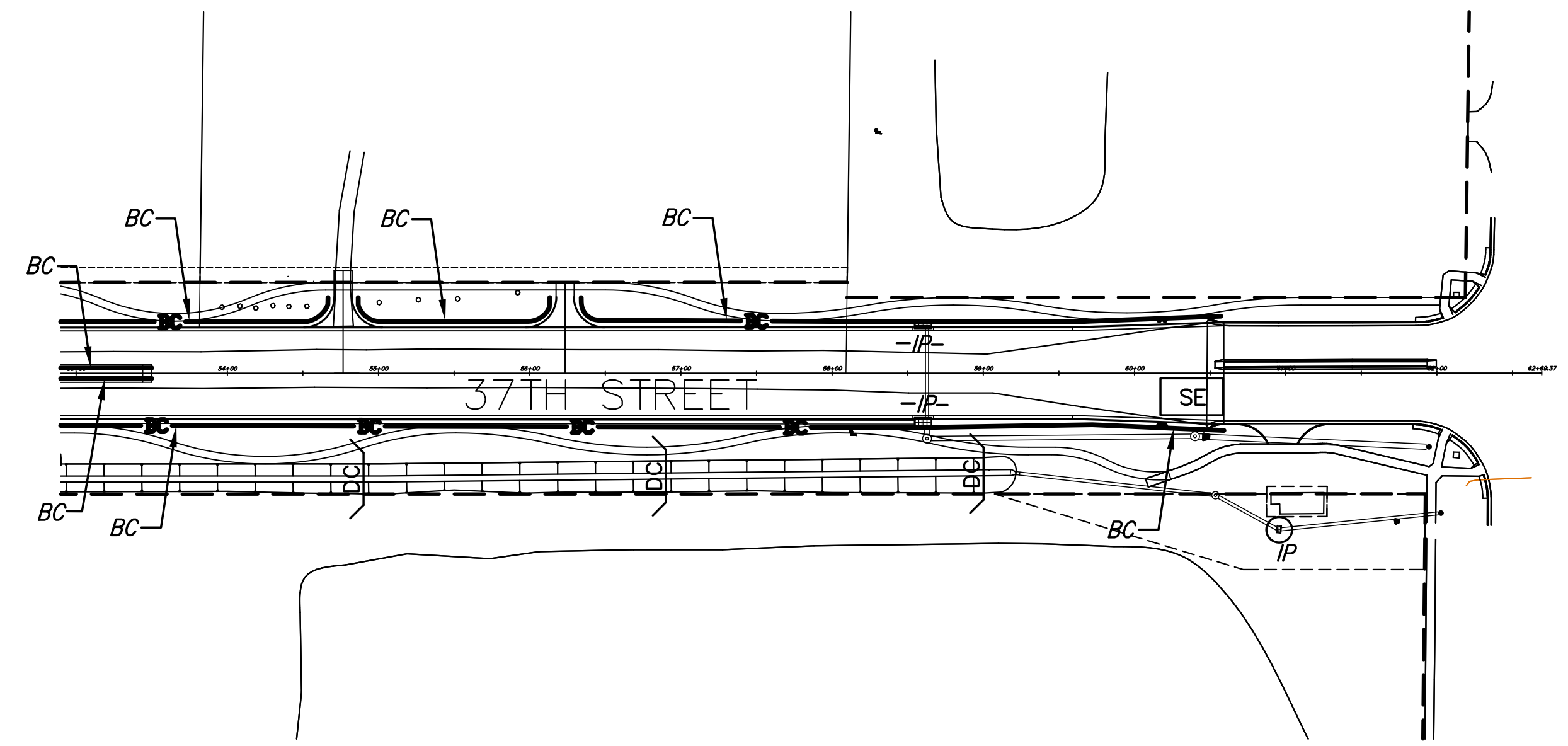

LEGEND

- | | | | |
|----|-------------------------------|----|---------------------------------|
| SE | STABILIZED ENTRANCE | SB | SILT BARRIER |
| SE | STABILIZED ENTRANCE REMOVED | SB | SILT BARRIER REMOVED |
| IP | AREA INLET PROTECTION | BC | BACK OF CURB PROTECTION |
| IP | AREA INLET PROTECTION REMOVED | BC | BACK OF CURB PROTECTION REMOVED |
| IP | CURB INLET PROTECTION | DC | DITCH CHECK PROTECTION |
| IP | CURB INLET PROTECTION REMOVED | DC | DITCH CHECK PROTECTION REMOVED |
| | DRAINAGE FLOW DIRECTION | | CONSTRUCTION LIMITS |

EROSION CONTROL BMP SUMMARY		
ITEMS	QUANTITY	UNIT
Erosion Control BMP (Back of Curb Protection)	13068	L.F.
Erosion Control BMP (Curb Inlet Protection)	18	Each
Erosion Control BMP (Area Inlet Protection)	1	Each
Erosion Control BMP (Stabilization Entrances)	3	Each
Erosion Control BMP (Silt Barrier)	1459	L.F.
Erosion Control BMP (Ditch Check Protection)	7	Each

RECAPITULATION		
BID ITEMS	TOTAL	UNIT
Erosion Control BMP (Back of Curb Protection)	13068	L.F.
Erosion Control BMP (Curb Inlet Protection)	17	Each
Erosion Control BMP (Area Inlet Protection)	1	Each
Erosion Control BMP (Stabilization Entrances)	3	Each
Erosion Control BMP (Silt Barrier)	1459	L.F.
Erosion Control BMP (Ditch Check Protection)	7	Each

PLOTTED: Tuesday, March 24, 2009 @ 11:30AM

J:\Civil\08137.DWG\EROSION\08137Erosion Control#2