

**37TH STREET IMPROVEMENTS
FROM
MAIZE ROAD TO TYLER ROAD**

**PLAN SHEET
STA 14+0.00
TO
STA 19+0.00**
SHEET TITLE
472-84693
PROJECT NUMBER

DESIGN BY
DRAWN BY
CHECKED BY

ISSUED
March 24, 2009
REVISED

SHEET NO.
7 of 133

WYN-WOOD ADD.
Reserve

SW 1/4 Sec. 29, T26S, R1W

WYN-WOOD ADD.
Lot 12, Block 4
Lane & Reed Walker
Investments, LLC

P.V.I.
Elev. = 1353.55
No. V.C.

Sta. 16+10, Install 32 L.F.
of 4" PVC (Sch. 40)
Irrigation Sleeve, Lt.

Sta. 17+80 Remove 6 L.F. of 18"
RCP, Concrete Pad Lt. Abandon
Remaining Pipe in place.

P.V.I.
Elev. = 1352.67
V.C. = 100'

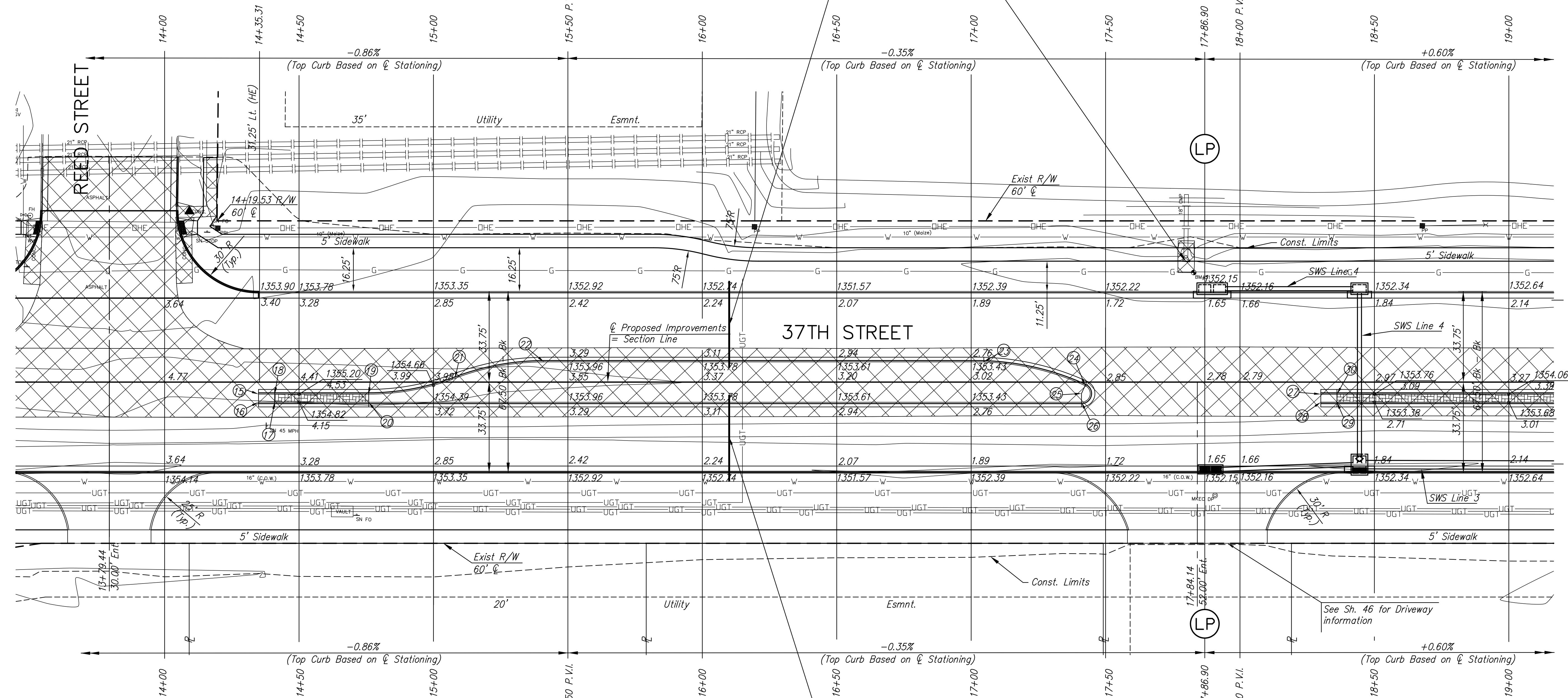
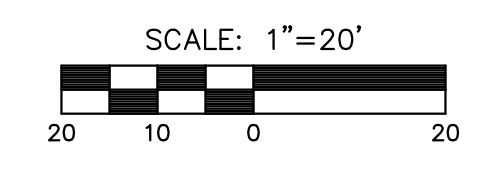

MEDIAN LOCATION				
Point No.	Station	Offset to Back	Flowline Elevation	Top Curb Elevation
15	14+34.94	4.50' Rt.	1354.66	1354.68
16	14+34.94	7.50' Rt.	1354.28	1354.30
17	14+40.94	7.50' Rt.	1354.23	1354.90
18	14+40.94	4.50' Rt.	1354.61	1355.28
19	14+75.94	4.50' Rt.	1354.31	1354.98
20	14+75.94	7.50' Rt.	1353.93	1354.60
21	15+07.99	1.40' Lt.	1353.85	1354.52
22	15+41.11	7.50' Lt.	1353.37	1354.04
23	17+04.67	7.50' Lt.	1352.75	1353.42
24	17+42.40	1.29' Lt.	1352.89	1353.56
25	17+41.05	4.25' Rt.		Radius Point
26	17+41.05	7.50' Rt.	1352.62	1353.29
27	18+30.05	4.50' Rt.	1352.99	1353.01
28	18+30.05	7.50' Rt.	1352.61	1352.63
29	18+36.05	7.50' Rt.	1352.64	1353.31
30	18+36.05	4.50' Rt.	1353.02	1353.69

Sta. 16+10, Install 32 L.F.
of 4" PVC (Sch. 40)
Irrigation Sleeve, Rt.

Lot 7, Block 1
STONEBRIDGE COMMERCIAL ADD.
NW 1/4 Sec. 32, T26S, R1W

P.V.I.
Elev. = 1352.67
V.C. = 100'

LEGEND

- Pavement Removal
- 2" Asphalt Milling & Overlay
- Asphalt Pavement Widening
- Brick Pavers
- Construct Wheelchair Ramp See Sh. No. 49