

Sta 25+99.53 BL A
Construct 12.0' Commercial Drive Ent (8" Reinf Concrete). Remove Exstg Parking Pvmnt and Walk to PL. New Drive Pvmnt to Match @ PL.

Sta 26+60.21 BL A
Construct 12.0' Commercial Drive Ent (8" Reinf Concrete) to PL. Replace w/ 6" Conc Parking Pvmnt. Match Exstg @ Saw Cut.

Sta 27+28.00 BL A
Construct 24.0' Commercial Drive Ent (8" Reinf Concrete). New Drive Pvmnt to Match @ PL.

Sta 28+73.80 BL A
Construct 8" Reinf Concrete) to PL. Saw & Remove Exstg Conc Parking Pvmnt as shown and Replace w/ 8" Conc Parking Pvmnt. Match Exstg @ Saw Cut.

Construct 9" NRDJ Concrete Pavement on 6" Crushed Stone Subgrade on Geogrid Reinforcement

Sta 29+89.98 BL A
Construct 40.0' Commercial Drive Ent (8" Reinf Concrete) to PL. Saw & Remove Exstg Conc Parking Pvmnt as shown and Replace w/ 8" Conc Parking Pvmnt. Match Exstg @ Saw Cut.

Transition Curb from 34.25' SL-Bc to 30.5' SL-Bc in 150.00'.

Construct Std Comb Curb & Gutter (Type I)(AE)

Construct 5.0' Conc Walk. (4"thk)

Construct 5.0' Conc Walk. (4"thk)

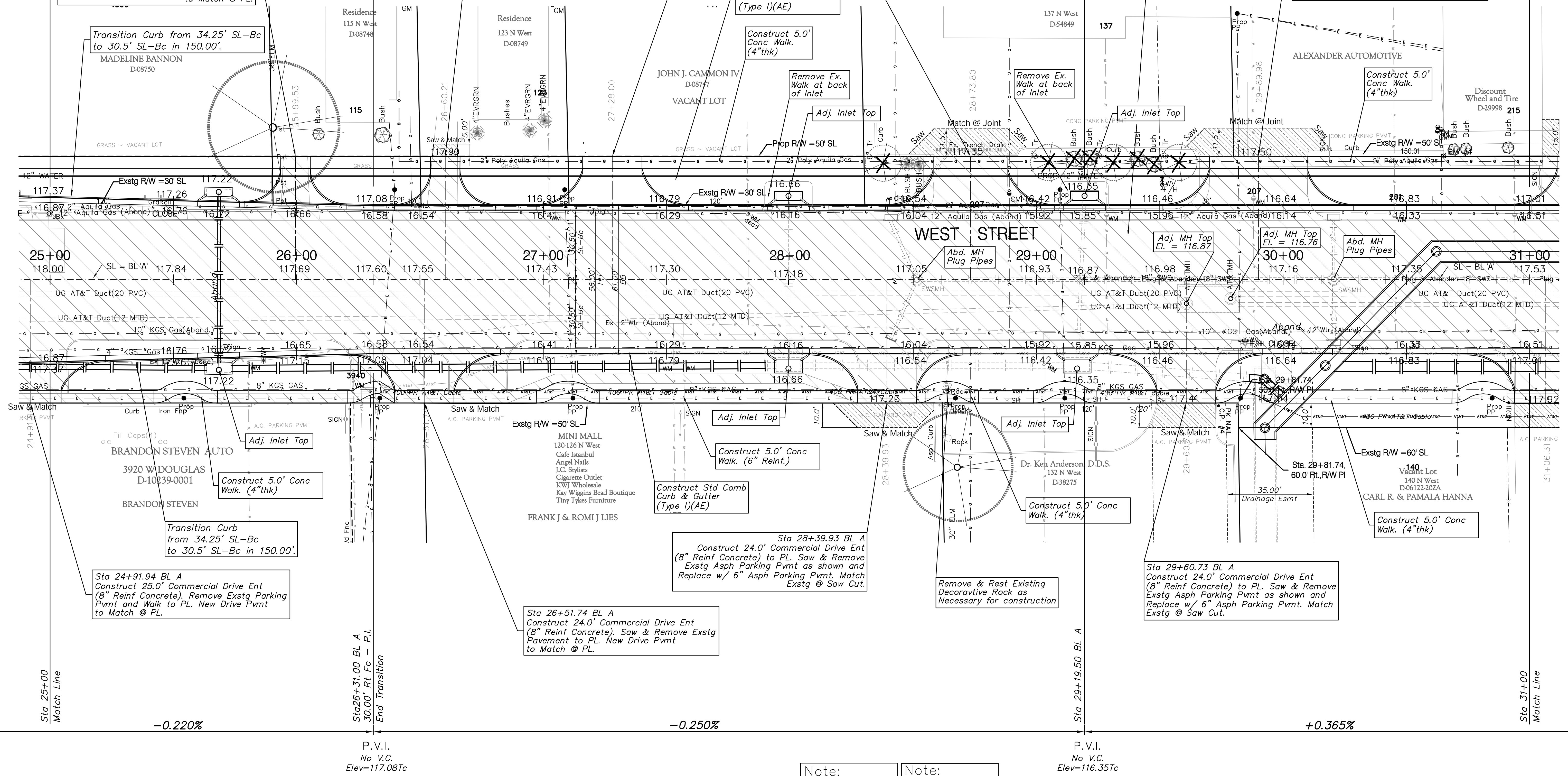

Sta 24+91.94 BL A
Construct 25.0' Commercial Drive Ent (8" Reinf Concrete). Remove Exstg Parking Pvmnt and Walk to PL. New Drive Pvmnt to Match @ PL.

Sta 26+51.74 BL A
Construct 24.0' Commercial Drive Ent (8" Reinf Concrete). Saw & Remove Exstg Pavement to PL. New Drive Pvmnt to Match @ PL.

Sta 28+39.93 BL A
Construct 24.0' Commercial Drive Ent (8" Reinf Concrete) to PL. Saw & Remove Exstg Asp Parking Pvmnt as shown and Replace w/ 6" Asp Parking Pvmnt. Match Exstg @ Saw Cut.

Sta 29+60.73 BL A
Construct 24.0' Commercial Drive Ent (8" Reinf Concrete) to PL. Saw & Remove Exstg Asp Parking Pvmnt as shown and Replace w/ 6" Asp Parking Pvmnt. Match Exstg @ Saw Cut.

Note:
Trees/Shrubs to be removed are marked thus:

Note:
Pavement, Sidewalks, and Etc. To Be Removed Are Indicated By:

Drawing File: E:\Eng\West Street Paving New\Land\dwg\Bass
Project No. 0404.E859 CAPITAL IMPROVEMENT PROJECT
Design: T. Azire
Drawn: Sonny
Approved: J. F. Bradley
Scale: 1:20
WEST STREET PAVING
Sta 25+00 BL A to Sta 31+00 BL A
PAVEMENT, STORM WATER SEWER, TRAFFIC CONTROL IMPROVEMENTS

Baughman Baughman Company, P.A.
315 Ellis St. Wichita, KS 67211 P 316-262-7271 F 316-262-0149
ENGINEERING | SURVEYING | PLANNING | LANDSCAPE ARCHITECTURE

November 2008
SHEET
OF
11
131