

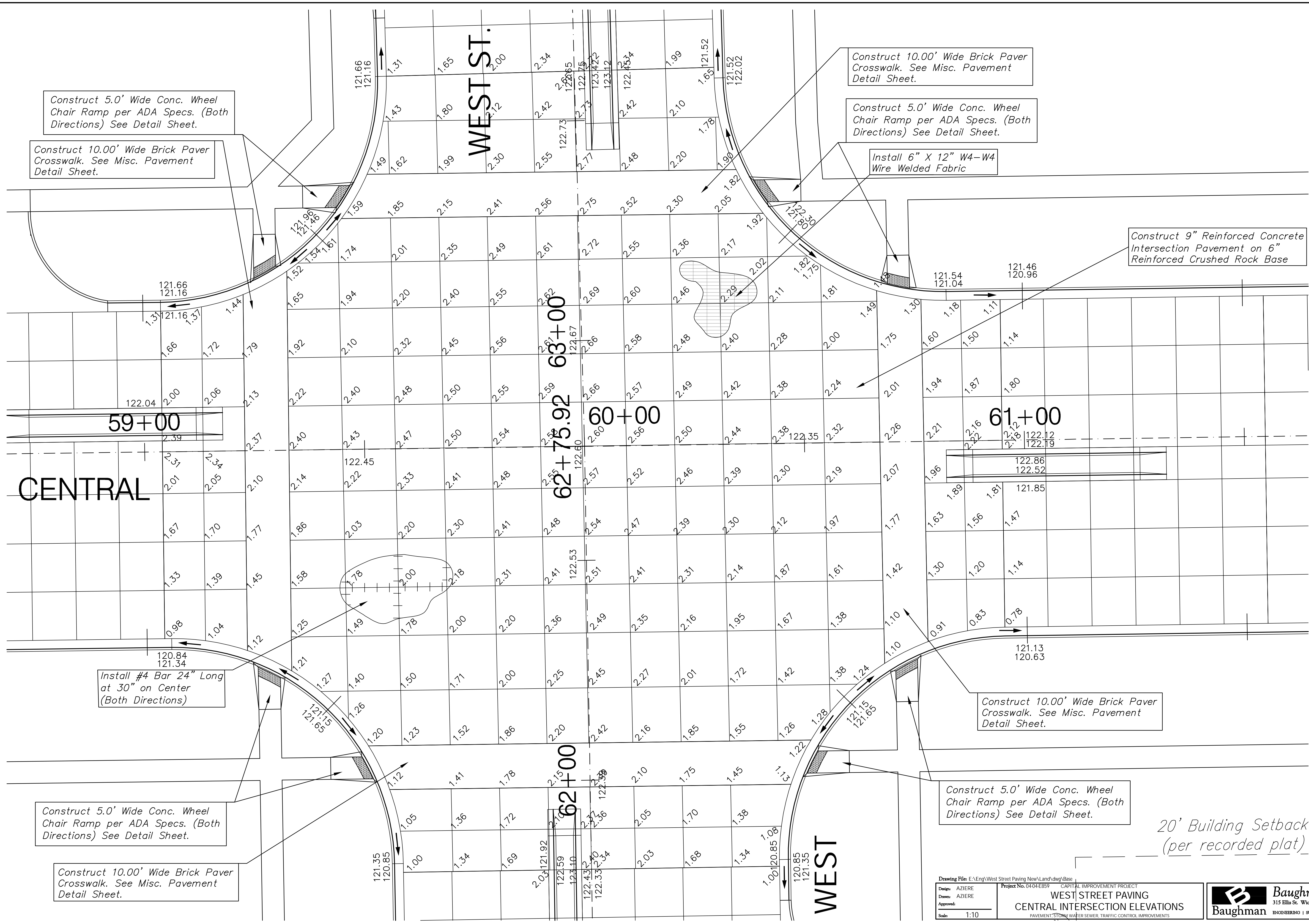

Scale: 1" = 10'



Construct 5.0' Wide Conc. Wheel Chair Ramp per ADA Specs. (Both Directions) See Detail Sheet.

Construct 10.00' Wide Brick Paver Crosswalk. See Misc. Pavement Detail Sheet.

Construct 10.00' Wide Brick Paver Crosswalk. See Misc. Pavement Detail Sheet.

Construct 5.0' Wide Conc. Wheel Chair Ramp per ADA Specs. (Both Directions) See Detail Sheet.

Install 6" X 12" W4-W4 Wire Welded Fabric

Construct 9" Reinforced Concrete Intersection Pavement on 6" Reinforced Crushed Rock Base

59+00

CENTRAL

63+00

62+75.92

60+00

61+00

Install #4 Bar 24" Long at 30" on Center (Both Directions)

Construct 5.0' Wide Conc. Wheel Chair Ramp per ADA Specs. (Both Directions) See Detail Sheet.

Construct 10.00' Wide Brick Paver Crosswalk. See Misc. Pavement Detail Sheet.

Construct 10.00' Wide Brick Paver Crosswalk. See Misc. Pavement Detail Sheet.

Construct 5.0' Wide Conc. Wheel Chair Ramp per ADA Specs. (Both Directions) See Detail Sheet.

20' Building Setback (per recorded plat)

WEST

Drawing File: E:\Eng\West Street Paving New\Land\dwg\Bass  
Design: AZIERE  
Drawn: AZIERE  
Approved:  
Scale: 1:10

CAPITAL IMPROVEMENT PROJECT  
WEST STREET PAVING  
CENTRAL INTERSECTION ELEVATIONS  
PAVEMENT, STORM WATER SEWER, TRAFFIC CONTROL IMPROVEMENTS



Baughman Company, P.A.  
315 Ellis St. Wichita, KS 67211 P 316-262-7271 F 316-262-0149  
ENGINEERING | SURVEYING | PLANNING | LANDSCAPE ARCHITECTURE

November 2008  
SHEET  
OF  
33  
131