

CAUTION
Existing
GSL
Crossing

W.L. Sta. 35+41.54 Line 1 =
B.L. 1 Sta. 43+50.00 =
Match Point.
Install 500.00 L.F. 12" Pipe

CAUTION
Existing
GSL
Crossing

CAUTION
Existing
OHE
Crossing

CAUTION
Existing
UGAT&T
Crossing

Note:
See Water Meter
Table For Service
Locations.

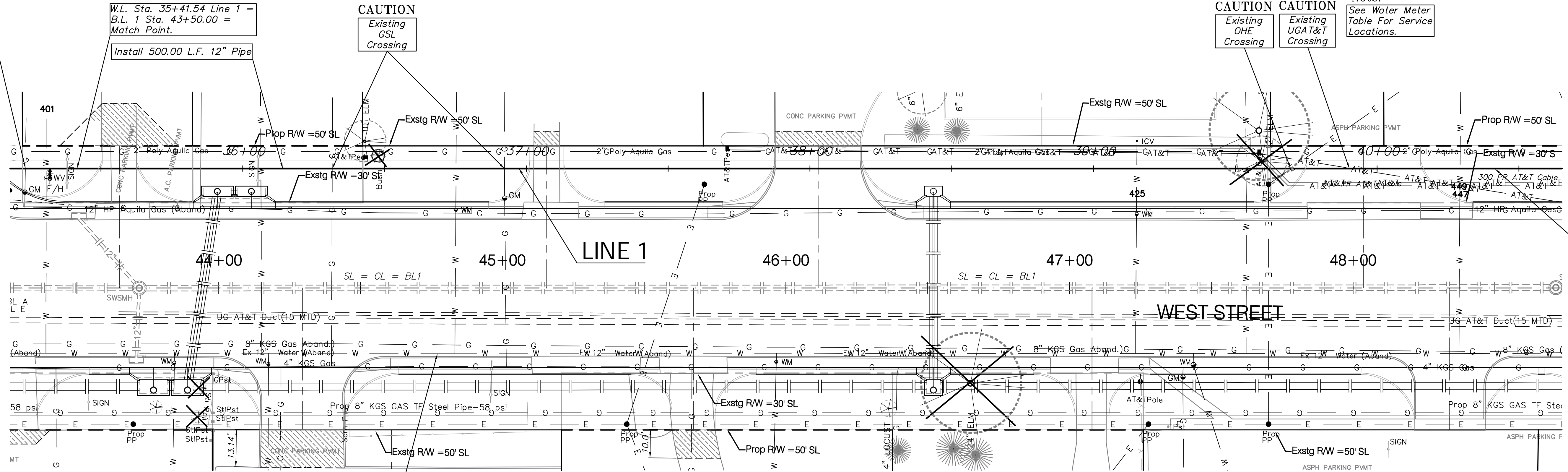
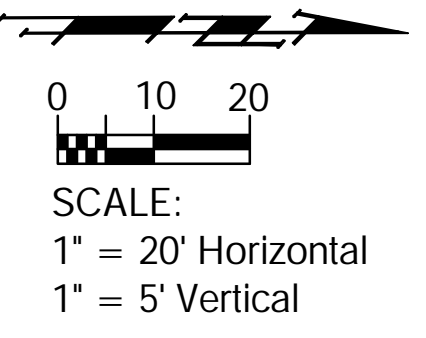

W.L. Sta. 40+41.54, Line 1 =
B.L. 1 Sta. 48+50.00 =
Match Point.

Abandon Existing 12" Water Line in
Place in Accordance with City of
Wichita Specs. Seal Both Ends.
All Services Must Be Connected To
New Main Prior to Abandonment.

LINE 1

Benchmark
BM #6 - "I" on Concrete Walk 2.0' E. of the N.E. Step at
the S.E. Corner Bldg. #341 (West St.)
Elev. = 121.40' City Datum
BM #7 - "I" on Top of Walk 8.0' W. of the N.E. Corner
Bldg. #540 (West St.)
Elev. = 121.78' City Datum

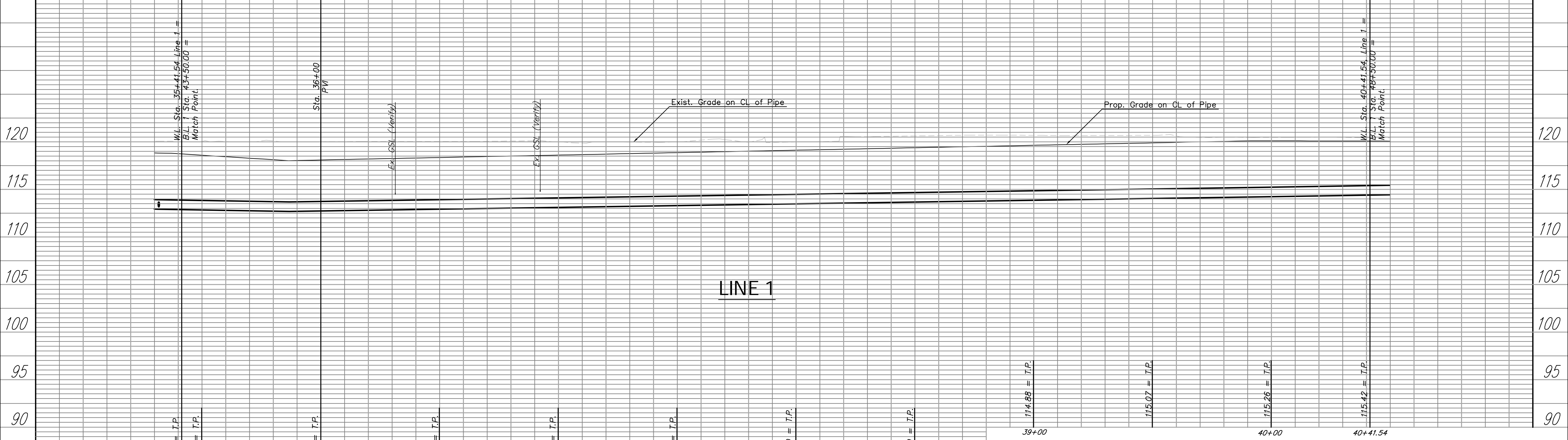

39+00	114.88 = T.P.	40+00	115.07 = T.P.	40+41.54	115.42 = T.P.
35+41.54	114.11 = I.P.	36+00	113.75 = T.P.	37+00	114.13 = T.P.
36+00	114.06 = T.P.	37+00	113.94 = T.P.	38+00	114.31 = T.P.
37+00	114.06 = T.P.	38+00	114.50 = T.P.	39+00	114.69 = T.P.

Design: T. Azlere
Drawn: Sonny
Approved: J. F. Bradley
Scale: 1:20
Project No. 04-04-E880 CAPITAL IMPROVEMENT PROJECT
WEST STREET WATER MAIN REPLACEMENT
Line 1, W.L. Sta. 35+36.35 to W.L. Sta 40+41.54
WEST STREET, SOUTH OF MAPLE TO SOUTH OF CENTRAL.

Baughman Company, P.A.
315 Ellis St. Wichita, KS 67211 P 316-262-7271 F 316-262-0149
ENGINEERING | SURVEYING | PLANNING | LANDSCAPE ARCHITECTURE