

FHWA REGION NO.	STATE	PROJECT NO.	FISCAL YEAR	SHEET NO.	TOTAL SHEETS
7	KANSAS	87N-0459-01	2009	7	32

Fed. Aid # HSIP-N045(901)

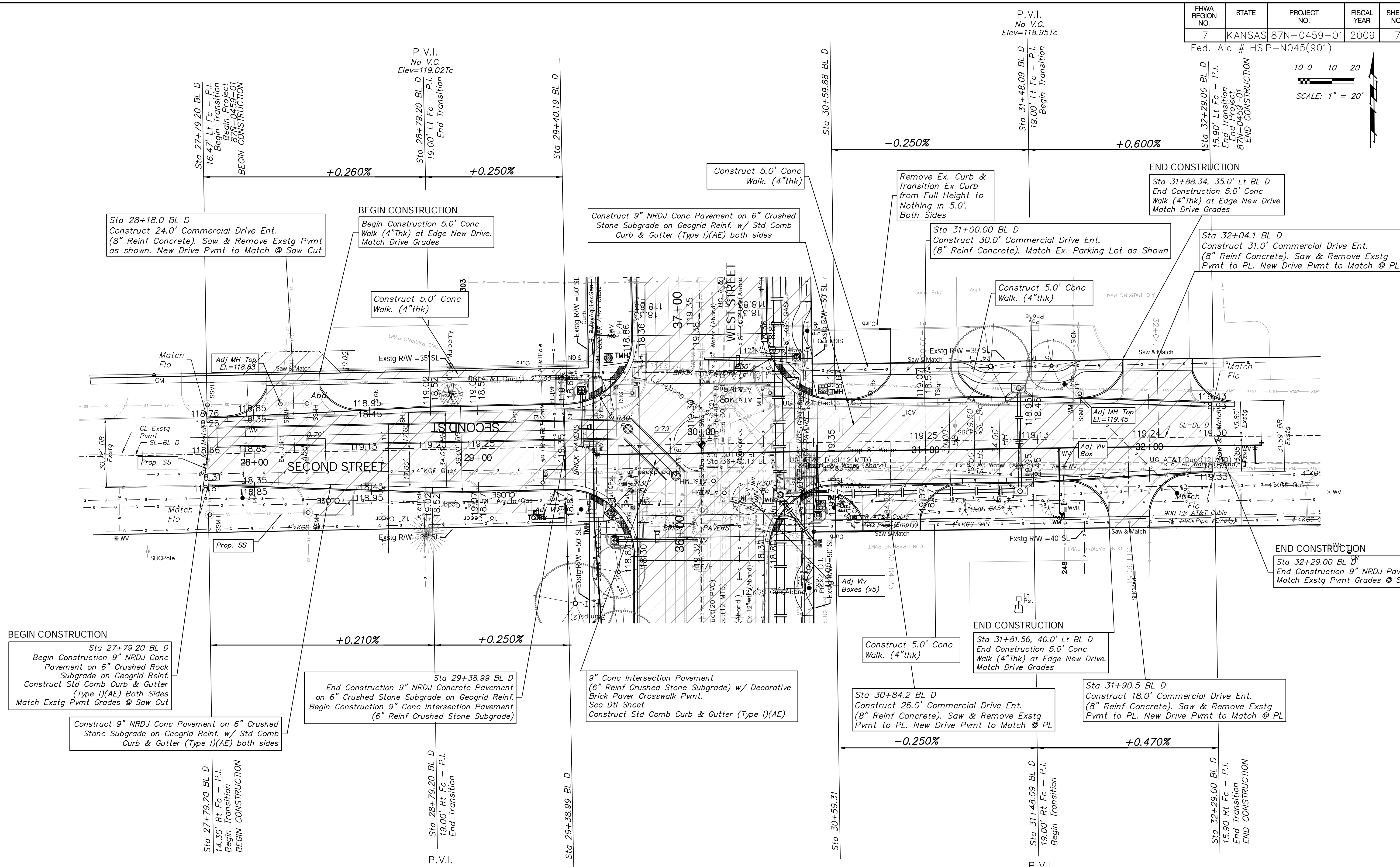
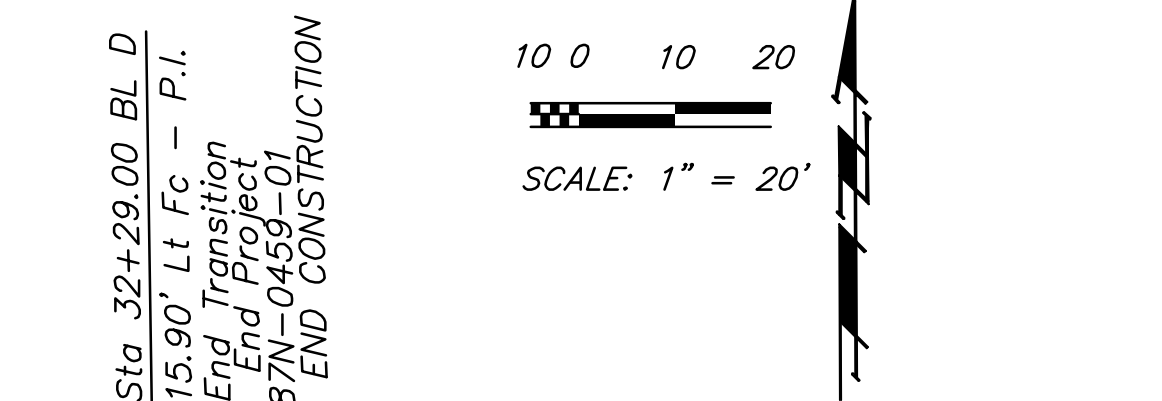
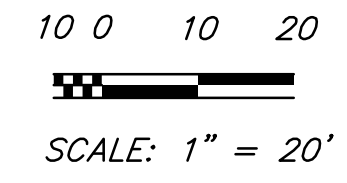

BEGIN CONSTRUCTION

Sta 27+79.20 BL D  
Begin Construction 9" NRDJ Conc Pavement on 6" Crushed Rock Subgrade on Geogrid Reinf. Construct Std Comb Curb & Gutter (Type I)(AE) Both Sides Match Exstg Pvmnt Grades @ Saw Cut

Construct 9" NRDJ Conc Pavement on 6" Crushed Stone Subgrade on Geogrid Reinf. w/ Std Comb Curb & Gutter (Type I)(AE) both sides

Sta 29+38.99 BL D  
End Construction 9" NRDJ Concrete Pavement on 6" Crushed Stone Subgrade on Geogrid Reinf. Begin Construction 9" Conc Intersection Pavement (6" Reinf Crushed Stone Subgrade)

9" Conc Intersection Pavement (6" Reinf Crushed Stone Subgrade) w/ Decorative Brick Paver Crosswalk Pvmnt. See Dtl Sheet Construct Std Comb Curb & Gutter (Type I)(AE)

Construct 5.0' Conc Walk (4"thk)

Sta 30+84.2 BL D  
Construct 26.0' Commercial Drive Ent. (8" Reinf Concrete). Saw & Remove Exstg Pvmnt to PL. New Drive Pvmnt to Match @ PL

Sta 31+90.5 BL D  
Construct 18.0' Commercial Drive Ent. (8" Reinf Concrete). Saw & Remove Exstg Pvmnt to PL. New Drive Pvmnt to Match @ PL

END CONSTRUCTION  
Sta 32+29.00 BL D  
End Construction 9" NRDJ Pavement Match Exstg Pvmnt Grades @ Saw Cut

Note:  
Trees/Shrubs to be removed are marked thus:

Note:  
Pavement, Sidewalks, and Etc. To Be Removed Are Indicated By:

Drawing File: E:\Eng\West Street Paving NewLand.dwg;Bass.dwg  
Project No. 0404E859 CAPITAL IMPROVEMENT PROJECT  
Design: T. Azire  
Drawn: Sonny  
Approved: J. F. Bradley  
Scale: 1:20

SECOND ST PAVING  
Sta 27 + 29.20 BL D to Sta 32 + 29.00 BL D  
WEST STREET PAVING - 2nd & West St.

**Baughman Company, P.A.**  
315 Ellis St. Wichita, KS 67211 P 316-262-7271 F 316-262-0149  
ENGINEERING | SURVEYING | PLANNING | LANDSCAPE ARCHITECTURE

November 2008  
SHEET 7 OF 32