

University St.

Sta. 0+00.0, Begin Line 1
 Connect to exist. storm water sewer
 and begin 15" RCP (W). Construct 4'
 Dia. Manhole over existing 30" SWS.
 Remove top half of pipe and install
 invert. Coring, grouting, reshaping,
 etc. shall be incidental to cost of "15"
 RCP". Contractor to verify elevation
 and location prior to construction.

Moved MH 8' South

NOTE: 15" RCP May be Lowered
 in Field to Miss Water & Gas as
 Needed. Verify With Engineer

CAUTION!
 Prop. 3" Waterline

CAUTION!
 Prop. 3" Gas Line

CAUTION!
 Exist. 4" Waterline

CAUTION!
 Exist. 3" Gas Line

Sta. 0+28.49, Line 1 =
 Sta. 0+00, Begin Line 1A
 Construct Std. Shallow Manhole
 (4' Dia.) with Grated Lid (Neenah
 R-2501 or equivalent).
 Top Elev. = 1295.50

Sta. 0+64.14, Line 1A
 Construct 1- 6" Roof Drain
 Connection

Sta. 0+91.10, Line 1A
 Construct 1- 6" Roof Drain
 Connection

Wye connection
 Sta. 1+07.76, End Line 1
 Construct ADS Junction-Box
 Top Elev. = 1295.84
 1 - 6" Roof Drain Connection

Glenn St.

3" Kansas Gas Service Gas Line

Approximate Location of 4" City of
 Wichita Water Line (not field verified)

Sta. 1+18.98, End Line 1A
 Construct ADS Junction-Box Wye connection
 Top Elev. = 1295.73
 1 - 6" Roof Drain Connection

Sta. 1+03.92, Line 1A
 Construct 1- 6" Roof Drain
 Connection

Sta. 0+87.71, Line 1A
 Construct 1- 6" Roof Drain
 Connection

Proposed Building
 FFE = 1298.30

Sta. 0+44.49, Line 1A
 Construct 1- 6" Roof Drain
 Connection

Sta. 0+72.61, Line 1A
 Construct 1- 6" Roof Drain
 Connection

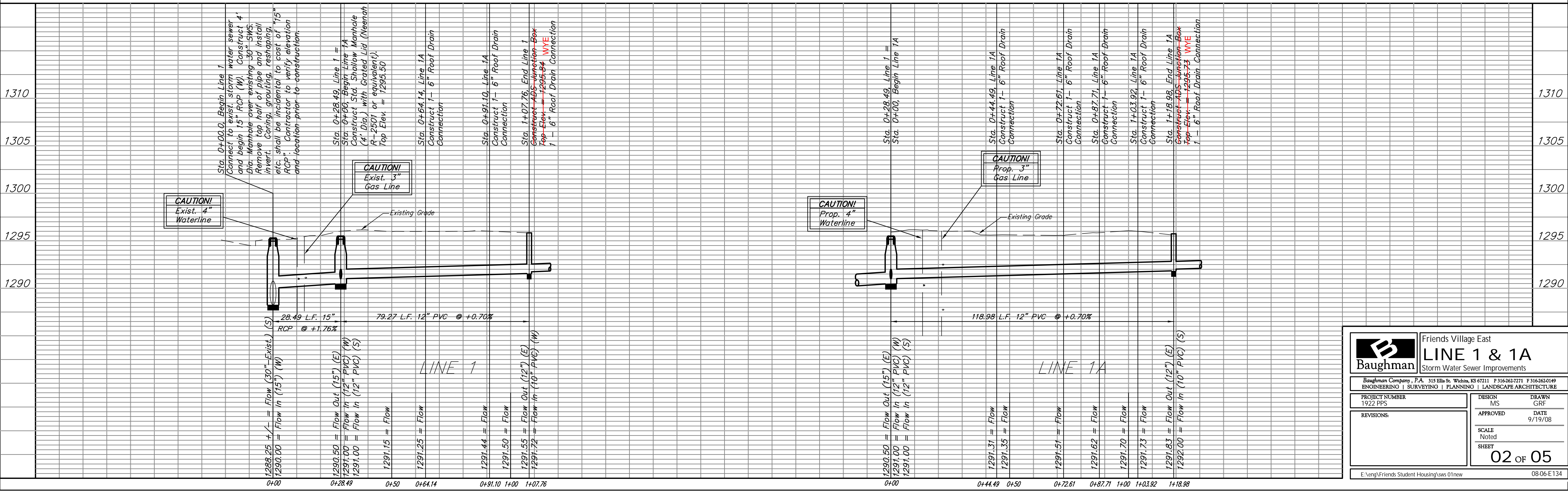

		Friends Village East	
		LINE 1 & 1A	
		Storm Water Sewer Improvements	
<small>Baughman Company, P.A. 315 Ellis St. Wichita, KS 67211 P 316-262-7771 F 316-262-0149 ENGINEERING SURVEYING PLANNING LANDSCAPE ARCHITECTURE</small>			
PROJECT NUMBER 1922 PPS	DESIGN MS	DRAWN GRF	APPROVED DATE 9/19/08
REVISIONS:	SCALE Noted	SHEET 02 OF 05	
E:\eng\Friends Student Housing\sws 01new			08-06-E134